

STATE OF NEW MEXICO
ENERGY AND MINERALS DEPARTMENT

OIL CONSERVATION DIVISION

P. O. BOX 2088
SANTA FE, NEW MEXICO 87501

30-805-61567
Form C-101
Revised 10-1-78

NO. OF COPIES RECEIVED	
DISTRIBUTION	
SANTA FE	
FILE	
U.S.G.S.	
LAND OFFICE	
OPERATOR	

NOV 30 '87

5A. Indicate Type of Lease
STATE ☐ FEE ☒

5. State Oil & Gas Lease No.

APPLICATION FOR PERMIT TO DRILL, DEEPEN, OR PLUG BACK

1a. Type of Work DRILL <input checked="" type="checkbox"/> DEEPEN <input type="checkbox"/> PLUG BACK <input type="checkbox"/>		7. Unit Agreement Name	
b. Type of Well OIL WELL <input checked="" type="checkbox"/> GAS WELL <input type="checkbox"/> OTHER <input type="checkbox"/>		8. Farm or Lease Name Alma Shields	
2. Name of Operator N. Dale Nichols		9. Well No. 7	
3. Address of Operator P.O. Box 1972 Midland, Texas 79702		10. Field and Pool, or Wildcat ACME (San Andres)	
4. Location of Well UNIT LETTER N LOCATED 990 FEET FROM THE South LINE AND 1650 FEET FROM THE West LINE OF SEC. 33 TWP. 7S RGE. 28E NMPM		12. County Chaves	
19. Proposed Depth 1980'		19A. Formation San Andres	20. Rotary or C.T. Rotary
21. Elevations (show whether DF, KT, etc.) 4001 GL	21A. Kind & Status Plug. Bond Blanket	21B. Drilling Contractor Self	22. Approx. Date Work will start 11-30-87

23.

PROPOSED CASING AND CEMENT PROGRAM

SIZE OF HOLE	SIZE OF CASING	WEIGHT PER FOOT	SETTING DEPTH	SACKS OF CEMENT	EST. TOP
9 7/8"	7 5/8"	26.40	300	125	Circulate
6 3/4"	5 1/2"	17.00	1920'	100	1450'
4 3/4"	Open-Hole	-	1920 to 1980		

11-30-87

11-30-87

IN ABOVE SPACE DESCRIBE PROPOSED PROGRAM: IF PROPOSAL IS TO DEEPEN OR PLUG BACK, GIVE DATA ON PRESENT PRODUCTIVE ZONE AND PROPOSED NEW PRODUCTIVE ZONE. GIVE BLOWOUT PREVENTER PROGRAM, IF ANY.

I hereby certify that the information above is true and complete to the best of my knowledge and belief.

Signed N. Dale Nichols Title Operator Date 11-27-87

(This space for State Use)

Original Signed By
Mike Williams

NOV 30 1987

APPROVED BY _____ TITLE _____ DATE _____

CONDITIONS OF APPROVAL, IF ANY

All distances must be from the outer boundaries of the Section

Operator N. DALE NICHOLS			Lessee ALMA SHIELDS		Well No. 7
Unit Letter N	Section 33	Township 7S	Range 27E	County CHAVES	
Actual Wellbore Location of Well: 990 feet from the SOUTH line and 1650 feet from the WEST line					
Ground Level Elev. 4001	Producing Formation San Andres	Pool ACME (San Andres)		Dedicated Acreage: 40.0 Acres	

1. Outline the acreage dedicated to the subject well by colored pencil or hatchure marks on the plat below.
2. If more than one lease is dedicated to the well, outline each and identify the ownership thereof (both as to working interest and royalty).
3. If more than one lease of different ownership is dedicated to the well, have the interests of all owners been consolidated by communitization, unitization, force-pooling, etc?

☐ Yes ☐ No If answer is "yes," type of consolidation _____

If answer is "no," list the owners and tract descriptions which have actually been consolidated. (Use reverse side of this form if necessary.) _____

No allowable will be assigned to the well until all interests have been consolidated (by communitization, unitization, forced-pooling, or otherwise) or until a non-standard unit, eliminating such interests, has been approved by the Division

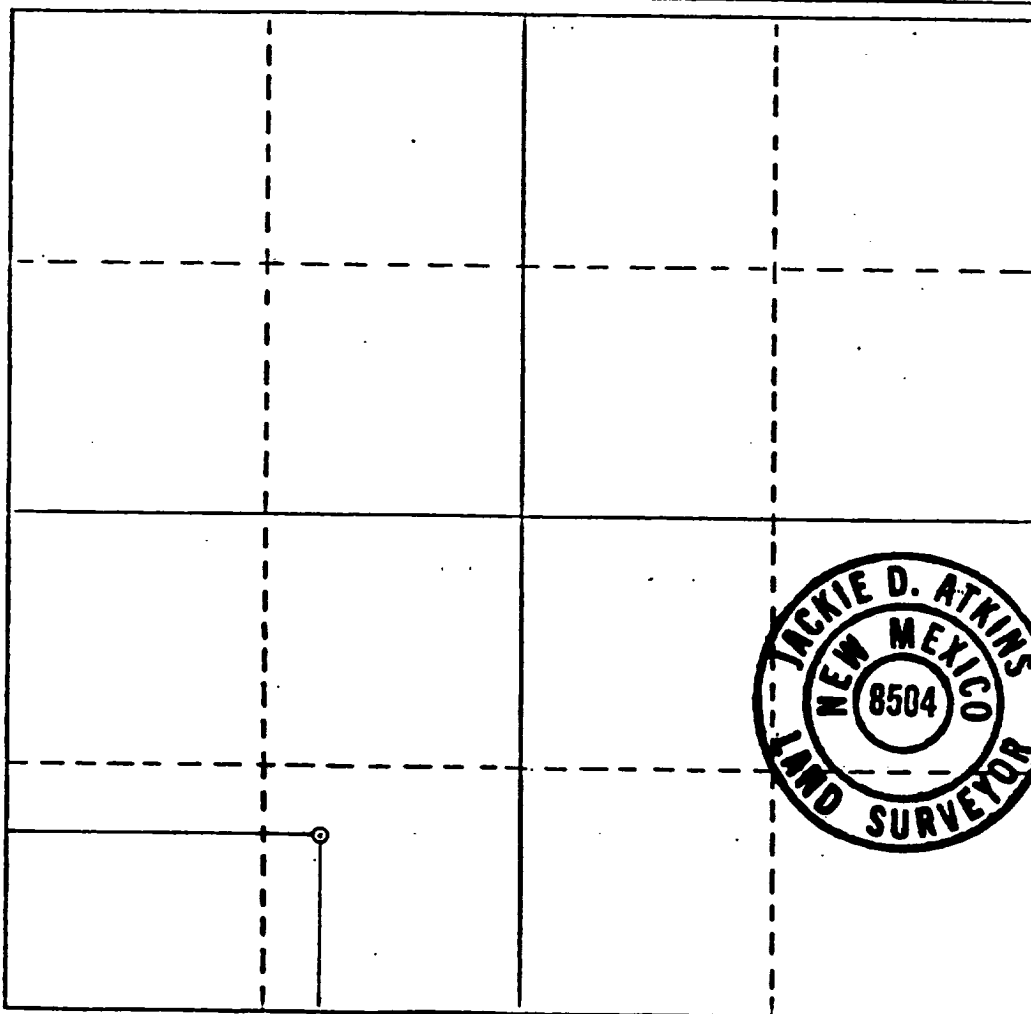

CERTIFICATION

I hereby certify that the information contained herein is true and complete to the best of my knowledge and belief.

N. Dale Nichols

Name

Operator

Position

N. Dale Nichols

Company

11-27-87

Date

I hereby certify that the well location shown on this plat was plotted from field notes of actual surveys made by me or under my supervision, and that the same is true and correct to the best of my knowledge and belief.

NOV. 16, 1987

Date Signed

Jackie D. Atkins

Registered Professional Engineer and/or Land Surveyor

Certificate No.

PE-6403 LS-8504

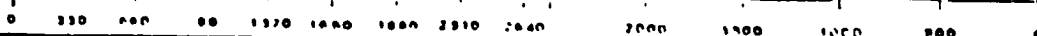

N. DALE NICHOLS

BOX 1972
MIDLAND, TEXAS 79702

REGAN BLOWOUT PREVENTOR

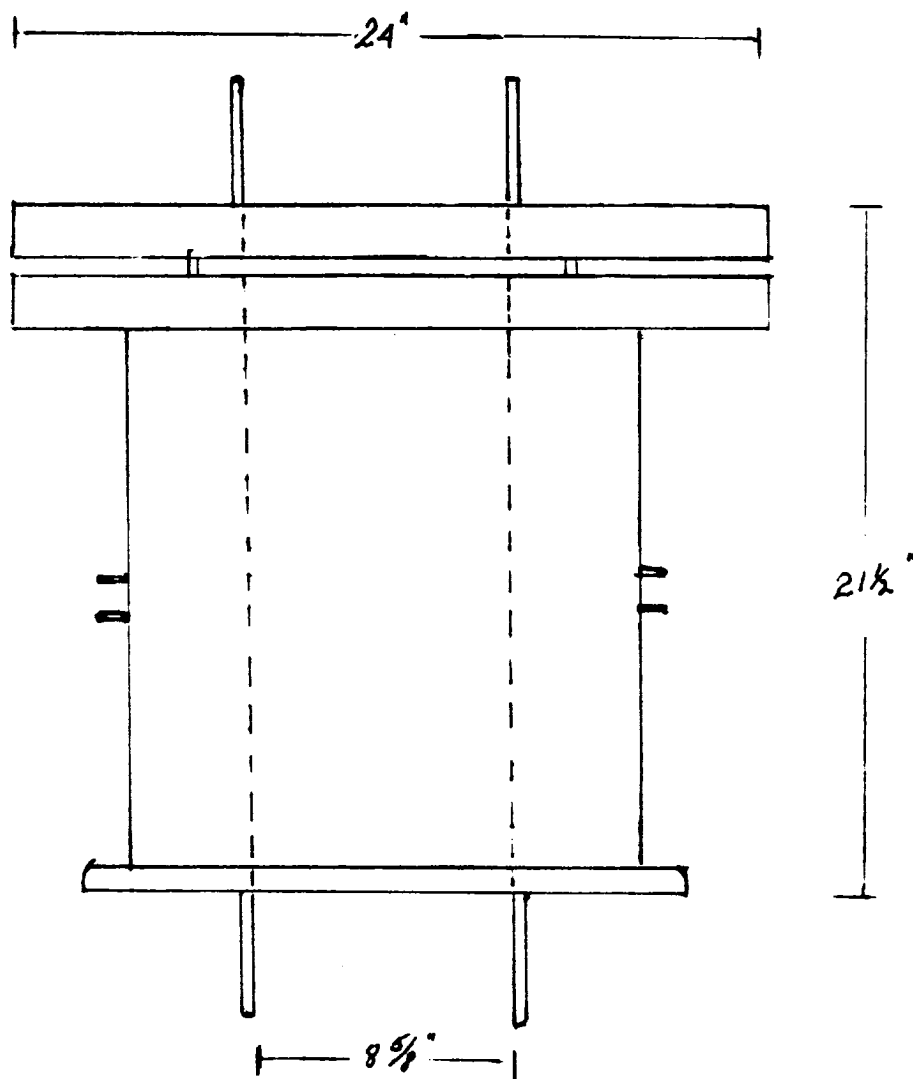
3000 # TestOperator N. Dale NicholsLease Alma ShieldsWell 7