

STATE OF NEW MEXICO
ENERGY AND MINERALS DEPARTMENT

OIL CONSERVATION DIVISION

P. O. BOX 2088
SANTA FE, NEW MEXICO 87501

30-805-61582

Form C-101
Revised 10-1-78

NO. OF COPIES RECEIVED	
DISTRIBUTION	
SANTA FE	
FILE	
U.S.G.S.	
LAND OFFICE	
OPERATOR	

JAN 05 1988

5A. Indicate Type of Lease
STATE ☒ FEE ☐

5. State Oil & Gas Lease No.
LG-4920

APPLICATION FOR PERMIT TO DRILL, DEEPEN, OR PLUG BACK

1a. Type of Work DRILL <input checked="" type="checkbox"/> DEEPEN <input type="checkbox"/> PLUG BACK <input type="checkbox"/>		7. Unit Agreement Name	
b. Type of Well OIL WELL <input type="checkbox"/> GAS WELL <input checked="" type="checkbox"/> OTHER <input type="checkbox"/>		8. Farm or Lease Name Ibis XU State Com	
2. Name of Operator Yates Petroleum Corporation		9. Well No. 2	
3. Address of Operator 105 South Fourth Street - Artesia, NM 88210		10. Field and Pool, or Wildcat Wildcat Penn	
4. Location of Well UNIT LETTER C LOCATED 660 FEET FROM THE North LINE AND 1980 FEET FROM THE West LINE OF SEC. 25 TWP. 9S RGE. 26E NMPM		12. County Chaves	
19. Proposed Depth 6100'		19A. Formation Penn	
20. Rotary or C.T. Rotary			
21. Elevations (show whether DF, HT, etc.) 3805.7' GR		21A. Kind & Status Plug. Bond Blanket	
21B. Drilling Contractor Undesignated		22. Approx. Date Work will start ASAP	

23.

PROPOSED CASING AND CEMENT PROGRAM

SIZE OF HOLE	SIZE OF CASING	WEIGHT PER FOOT	SETTING DEPTH	SACKS OF CEMENT	EST. TOP
12-1/4"	8-5/8"	24# J-55	Approx. 950'	750 sacks	Circulate
7-7/8"	4-1/2"	9.5# J-55	TD	300 sacks	

We propose to drill and test the Penn and intermediate formations. Approximately 950' of surface casing will be set and cement circulated. If commercial, production casing will be run and cemented with adequate cover, perforated and stimulated as needed for production.

MUD PROGRAM: FW gel/LCM to 950', cut brine to 4450', SW gel/starch to TD

BOP PROGRAM: BOP's will be installed at the offset and tested daily

GAS NOT DEDICATED

IN ABOVE SPACE DESCRIBE PROPOSED PROGRAM; IF PROPOSAL IS TO DEEPEN OR PLUG BACK, GIVE DATA ON PRESENT PRODUCTIVE ZONE AND PROPOSED NEW PRODUCTIVE ZONE. GIVE BLOWOUT PREVENTER PROGRAM, IF ANY.

I hereby certify that the information above is true and complete to the best of my knowledge and belief.

Signed Cliff R. May Title Regulatory Agent Date January 5, 1988

(This space for State Use)

Original Signed By

APPROVED BY Mike Williams TITLE Oil & Gas Inspector DATE JAN 06 1988

CONDITIONS OF APPROVAL, IF ANY

**NEW MEXICO OIL CONSERVATION COMMISSION
WELL LOCATION AND ACREAGE DEDICATION PLAT**

Form C-102
Supersedes C-128
Effective 1-1-65

All distances must be from the outer boundaries of the Section.

Operator YATES PETROLEUM CORPORATION			Lease Ibis "XU" State Com		Well No. 2
Unit Letter "C"	Section 25	Township 9 South	Range 26 East	County Chaves County,	
Actual Footage Location of Well: <div style="display: flex; justify-content: space-between;"> 660 feet from the North line and 1980 feet from the West line </div>					
Ground Level Elev. 3805.7	Producing Formation PENN	Pool WILDCAT PENN		Dedicated Acreage: 320 Acres	

1. Outline the acreage dedicated to the subject well by colored pencil or hachure marks on the plat below.
2. If more than one lease is dedicated to the well, outline each and identify the ownership thereof (both as to working interest and royalty).
3. If more than one lease of different ownership is dedicated to the well, have the interests of all owners been consolidated by communization, unitization, force-pooling, etc?

☒ Yes ☐ No If answer is "yes," type of consolidation TO BE COMMUNITIZED

If answer is "no," list the owners and tract descriptions which have actually been consolidated. (Use reverse side of this form if necessary.) _____

No allowable will be assigned to the well until all interests have been consolidated (by communization, unitization, forced-pooling, or otherwise) or until a non-standard unit, eliminating such interests, has been approved by the Commission.

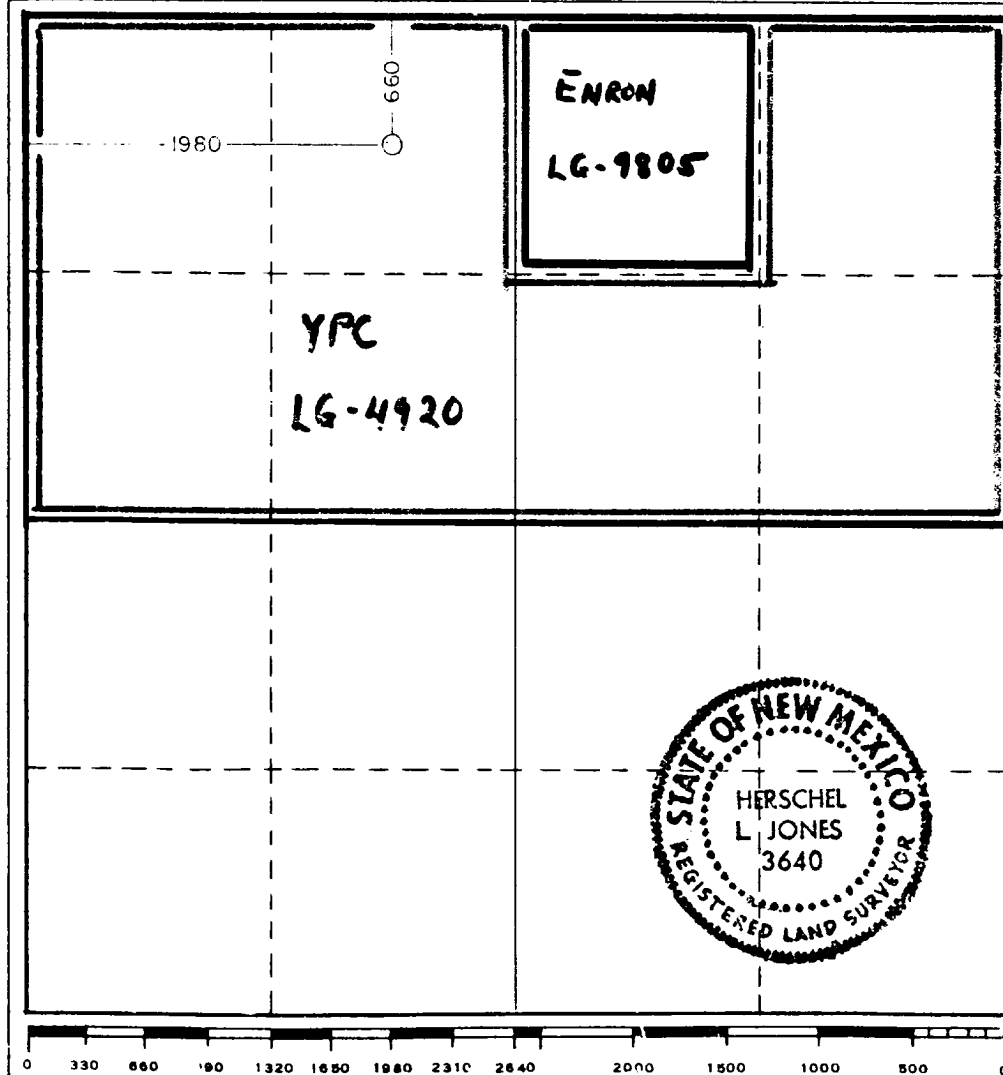

CERTIFICATION

I hereby certify that the information contained herein is true and complete to the best of my knowledge and belief.

Clifton R. May
Name
Clifton R. May

Position
Regulatory Agent

Company
Yates Petroleum Corporation

Date
January 5, 1988

I hereby certify that the well location shown on this plat was plotted from field notes of actual surveys made by me or under my supervision, and that the same is true and correct to the best of my knowledge and belief.

Date Surveyed
January 2, 1988

Registered Professional Engineer and/or Land Surveyor

Herschel L. Jones
Certificate No. 3640

EXHIBIT B

BDP DIAGRAM

RATED 3000[#]

