

STATE OF NEW MEXICO
ENERGY AND MINERALS DEPARTMENT

OIL CONSERVATION DIVISION

P. O. BOX 2088

SANTA FE, NEW MEXICO 87501

RECEIVED

FEB 17 '88

30-005-61589

Form C-101
Revised 10-1-78

NO. OF COPIES RECEIVED	
DISTRIBUTION	
SANTA FE	/
FILE	/
U.S.G.S.	/
LAND OFFICE	/
OPERATOR	/

APPLICATION FOR PERMIT TO DRILL, DEEPEN, OR PLUG BACK

1a. Type of Work DRILL <input checked="" type="checkbox"/> DEEPEN <input type="checkbox"/> O. C. D. <input type="checkbox"/> PLUG BACK <input type="checkbox"/>		7. Unit Agreement Name
b. Type of Well OIL WELL <input type="checkbox"/> GAS WELL <input checked="" type="checkbox"/> OTHER <input type="checkbox"/> SINGLE ZONE <input type="checkbox"/> MULTIPLE ZONE <input type="checkbox"/>		8. Farm or Lease Name McConkey HX
2. Name of Operator Yates Petroleum Corporation		9. Well No. 3
3. Address of Operator 105 South Fourth Street - Artesia, NM 88210		10. Field and Pool or Wildcat Pecos Abo
4. Location of Well UNIT LETTER L LOCATED 1980 FEET FROM THE South LINE AND 660 FEET FROM THE West LINE OF SEC. 10 TWP. 9S RGE. 26E NMPM		12. County Chaves
19. Proposed Depth 5200'		19A. Formation Abo
20. Rotary or C.T. Rotary		
21. Elevations (Show whether DF, KT, etc.) 3812.5' GR	21A. Kind & Status Plug. Bond Blanket	21B. Drilling Contractor Undesignated
22. Approx. Date Work will start ASAP		

23.

PROPOSED CASING AND CEMENT PROGRAM

SIZE OF HOLE	SIZE OF CASING	WEIGHT PER FOOT	SETTING DEPTH	SACKS OF CEMENT	EST. TOP
12-1/4"	8-5/8"	24# J-55	Approx. 1000'	550 sacks	Circulate
7-7/8"	4-1/2"	9.5# J-55	TD	300 sacks	

We propose to drill and test the Abo and intermediate formations. Approximately 1000' of surface casing will be set and cement circulated. If commercial, production casing will be run and cemented with adequate cover, perforated and stimulated as needed for production.

MUD PROGRAM: FW gel/LCM to 1000', brine to 4400', starch to TD

BOP PROGRAM: BOP's will be installed at the offset and tested daily

GAS NOT DEDICATED

POST 10#1
MLA API
2-19-88
7-18-88

IN ABOVE SPACE DESCRIBE PROPOSED PROGRAM; IF PROPOSAL IS TO DEEPEN OR PLUG BACK, GIVE DATA ON PRESENT PRODUCTIVE ZONE AND PROPOSED NEW PRODUCTIVE ZONE. GIVE BLOWOUT PREVENTER PROGRAM, IF ANY.

I hereby certify that the information above is true and complete to the best of my knowledge and belief.

Signed Cy Cowan Title Regulatory Agent Date February 17, 1988

(This space for State Use)

Original Signed By

Mike Williams

APPROVED BY

CONDITIONS OF APPROVAL, IF ANY

DATE

FEB 18 1988

**NEW MEXICO OIL CONSERVATION COMMISSION
WELL LOCATION AND ACREAGE DEDICATION PLAT**

Form C-102
Supersedes C-128
Effective 1-1-65

All distances must be from the outer boundaries of the Section.

Operator YATES PETROLEUM CORPORATION			Lease McCONKEY "HX"		Well No. 3
Unit Letter "L"	Section 10	Township 9 South	Range 26 East	County Chaves	
Actual Footage Location of Well: 1980 feet from the South line and 660 feet from the West line					
Ground Level Elev. 3812.5	Producing Formation ABO		Pool 5. Pecos Slope ABO		Dedicated Acreage: 160 Acres

1. Outline the acreage dedicated to the subject well by colored pencil or hachure marks on the plat below.
2. If more than one lease is dedicated to the well, outline each and identify the ownership thereof (both as to working interest and royalty).
3. If more than one lease of different ownership is dedicated to the well, have the interests of all owners been consolidated by communitization, unitization, force-pooling, etc?

☐ Yes ☒ No If answer is "yes," type of consolidation _____

If answer is "no," list the owners and tract descriptions which have actually been consolidated. (Use reverse side of this form if necessary.) _____

No allowable will be assigned to the well until all interests have been consolidated (by communitization, unitization, forced-pooling, or otherwise) or until a non-standard unit, eliminating such interests, has been approved by the Commission.

CERTIFICATION

I hereby certify that the information contained herein is true and complete to the best of my knowledge and belief.

Cy Cowan
Name
Cy Cowan

Position
Regulatory Agent

Company
Yates Petroleum Corporation

Date
February 17, 1988

I hereby certify that the well location shown on this plat was plotted from field notes of actual surveys made by me or under my supervision, and that the same is true and correct to the best of my knowledge and belief.

Date Surveyed
February 16, 1988

Registered Professional Engineer and/or Land Surveyor

[Signature]
Certificate No. **3640**

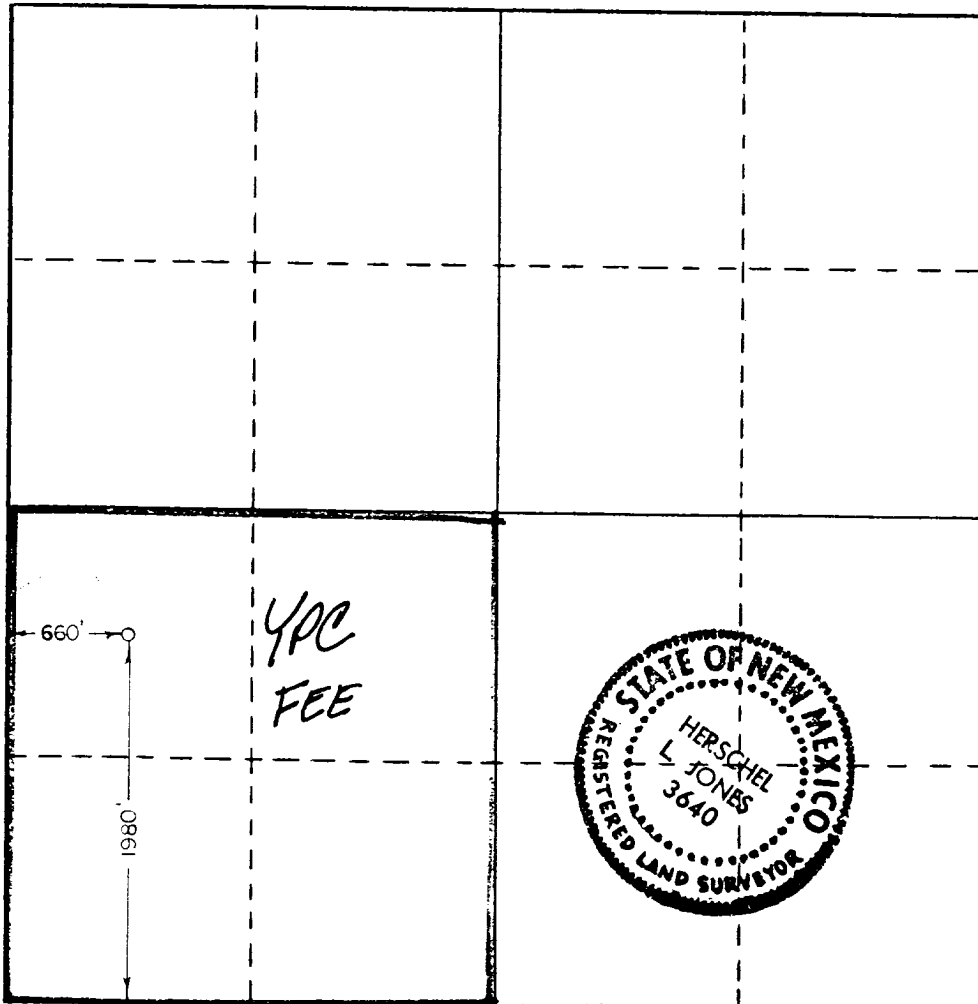

EXHIBIT B

BDP DIAGRAM

RATED 3000[#]

