

STATE OF NEW MEXICO
ENERGY AND MINERALS DEPARTMENT

OIL CONSERVATION DIVISION

P. O. BOX 2088

SANTA FE, NEW MEXICO 87501

RECEIVED

FEB 17 '88

30-405-63590
Form C-101
Revised 10-1-78

NO. OF COPIES RECEIVED	
DISTRIBUTION	
SANTA FE	✓
FILE	✓
U.S.G.S.	✓
LAND OFFICE	✓
OPERATOR	✓

5A. Indicate Type of Lease	
STATE <input checked="" type="checkbox"/>	FEE <input type="checkbox"/>
5. State Oil & Gas Lease No.	
LG-4919	

APPLICATION FOR PERMIT TO DRILL, DEEPEN, OR PLUG BACK

1a. Type of Work		ARTESIA OFFICE	
b. Type of Well			
DRILL <input checked="" type="checkbox"/>	DEEPEN <input type="checkbox"/>	PLUG BACK <input type="checkbox"/>	
OIL WELL <input type="checkbox"/>	GAS WELL <input checked="" type="checkbox"/>	OTHER <input type="checkbox"/>	
2. Name of Operator		7. Unit Agreement Name	
Yates Petroleum Corporation			
3. Address of Operator		8. Farm or Lease Name	
105 South Fourth Street - Artesia, NM 88210		Night Owl AFG State Com	
4. Location of Well		9. Well No.	
UNIT LETTER G LOCATED 1650 FEET FROM THE North LINE		1	
AND 1980 FEET FROM THE East LINE OF SEC. 22 TWP. 9S RGE. 26E NMPM		10. Field and Pool Name	
		Undes. Poor Ranch Wolf Camp	
		12. County	
		Chaves	
		19. Proposed Depth	
		5200'	
		19A. Formation	
		Abo	
		20. Rotary or C.T.	
		Rotary	
21. Elevations (show whether DF, KI, etc.)		21B. Drilling Contractor	
3775.2' GR		Undesignated	
21A. Kind & Status Plug. Bond		22. Approx. Date Work will start	
Blanket		ASAP	

PROPOSED CASING AND CEMENT PROGRAM

SIZE OF HOLE	SIZE OF CASING	WEIGHT PER FOOT	SETTING DEPTH	SACKS OF CEMENT	EST. TOP
12-1/4"	8-5/8"	24# J-55	Approx. 1000'	600 sacks	Circulate
7-7/8"	4-1/2"	9.5# J-55	TD	300 sacks	

We propose to drill and test the Abo and intermediate formations. Approximately 1000' of surface casing will be set and cement circulated. If commercial, production casing will be run and cemented with adequate cover, perforated and stimulated as needed for production.

MUD PROGRAM: FW gel/LCM to 1000', brine to 4300', starch to TD

BOP PROGRAM: BOP's will be installed at the offset and tested daily

GAS NOT DEDICATED

POST 10#1
N.L. API
2-19-88

APPROVED BY Mike Williams
DATE 2-12-88
UNIT 1000'

IN ABOVE SPACE DESCRIBE PROPOSED PROGRAM; IF PROPOSAL IS TO DEEPEN OR PLUG BACK, GIVE DATA ON PRESENT PRODUCTIVE ZONE AND PROPOSED NEW PRODUCTIVE ZONE. GIVE BLOWOUT PREVENTER PROGRAM, IF ANY.

I hereby certify that the information above is true and complete to the best of my knowledge and belief.

Signed Cy Cowan Title Regulatory Agent Date February 17, 1988

(This space for State Use)

Original Signed By
Mike Williams

APPROVED BY _____ TITLE _____

CONDITIONS OF APPROVAL, IF ANY: Oil & Gas Inspector

DATE FEB 18 1988

**NEW MEXICO OIL CONSERVATION COMMISSION
WELL LOCATION AND ACREAGE DEDICATION PLAT**

Form C-102
Supersedes C-128
Effective 1-1-65

All distances must be from the outer boundaries of the Section.

Operator YATES PETROLEUM CORPORATION				Lease NIGHT OWL "AFG" State Com.		Well No. 1
Unit Letter "G"	Section 22	Township 9 South	Range 26 East	County Chaves		

Actual Footage Location of Well:

1650 feet from the North line and 1980 feet from the East line	Ground Level Elev. 3775.2	Producing Formation ABO	Pool Pecos Slope ABO	Dedicated Acreage: 160 Acres
--	-------------------------------------	-----------------------------------	--------------------------------	--

1. Outline the acreage dedicated to the subject well by colored pencil or hatchure marks on the plat below.
2. If more than one lease is dedicated to the well, outline each and identify the ownership thereof (both as to working interest and royalty).
3. If more than one lease of different ownership is dedicated to the well, have the interests of all owners been consolidated by communitization, unitization, force-pooling, etc?

☒ Yes ☐ No If answer is "yes," type of consolidation **Communitization**

If answer is "no," list the owners and tract descriptions which have actually been consolidated. (Use reverse side of this form if necessary.)

No allowable will be assigned to the well until all interests have been consolidated (by communitization, unitization, forced-pooling, or otherwise) or until a non-standard unit, eliminating such interests, has been approved by the Commission.

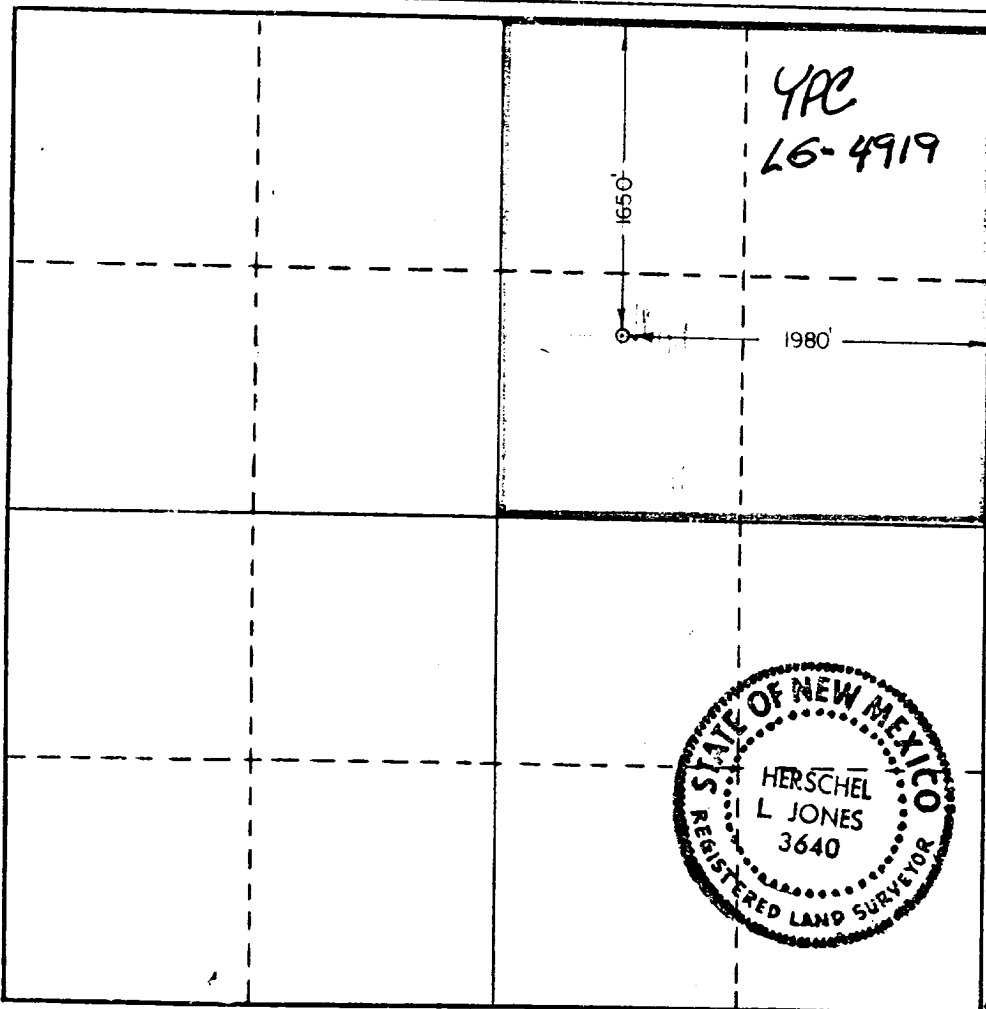

CERTIFICATION

I hereby certify that the information contained herein is true and complete to the best of my knowledge and belief.

Cy Cowan
Name
Cy Cowan

Regulatory Agent
Position

Yates Petroleum Corporation
Company

February 17, 1988
Date

I hereby certify that the well location shown on this plat was plotted from field notes of actual surveys made by me or under my supervision, and that the same is true and correct to the best of my knowledge and belief.

February 16, 1988
Date Surveyed

Registered Professional Engineer and/or Land Surveyor

Herschel L Jones
Certificate No. **3640**



EXHIBIT B
BDP DIAGRAM
RATED 3000[#]

