

32-065-62593  
Form C-101  
Revised 10-1-78

NO. OF COPIES RECEIVED	
DISTRIBUTION	
SANTA FE	✓
FILE	✓
U.S.G.S.	✓
LAND OFFICE	✓
OPERATOR	✓

RECEIVED

MAR 07 '88

O. C. D.

3A. Indicate Type of Lease  
STATE ☒ FEDERAL ☐

5. State Oil & Gas Lease No.  
LG-9056

APPLICATION FOR PERMIT TO DRILL, DEEPEN, OR PLUG BACK

1a. Type of Work  
DRILL ☒ DEEPEN ☐ PLUG BACK ☐  
b. Type of Well  
OIL WELL ☐ GAS WELL ☒ OTHER ☐  
2. Name of Operator  
ELK OIL COMPANY  
3. Address of Operator  
Post Office Box 310, Roswell, New Mexico 88202  
4. Location of Well  
UNIT LETTER EH LOCATED 1980 FEET FROM THE North LINE  
AND 660 FEET FROM THE East LINE OF SEC. 14 TWP. 9S RGE. 26E WMPM

7. Unit Agreement Name  
8. Farm or Lease Name  
Aikman State Comm  
9. Well No.  
2  
10. Field and Pool, or Wildcat  
Und. Foor Ranch Wolfcamp  
12. County  
Chaves

19. Proposed Depth  
5400  
19A. Formation  
Wolfcamp  
20. Rotary or C.T.  
Rotary  
21. Elevations (Show whether DF, RT, etc.)  
3814 Gr.  
21A. Kind & Status Plug. Bond  
Blanket  
21B. Drilling Contractor  
Walters  
22. Approx. Date Work will start  
3/15/88

PROPOSED CASING AND CEMENT PROGRAM

SIZE OF HOLE	SIZE OF CASING	WEIGHT PER FOOT	SETTING DEPTH	SACKS OF CEMENT	EST. TOP
12 1/4	8 5/8	23#	1000	350	Circ.
7 7/8	4 1/2	11.6#	5400	150	3800

Propose to drill to the Wolfcamp and test and evaluate all intermediate zones.

Mud Program:

- 0 - 1450 Fresh water, native mud
- 1450 - 4500 Fresh water, native mud
- 4500 - 5400 SW gel, flo seal, Vis. 31-35

POST 10#1  
NL-API  
3-11-88

Blowout prevention diagram attached.

180 DAYS  
9/8/88

ABOVE SPACE DESCRIBE PROPOSED PROGRAM; IF PROPOSAL IS TO DEEPEN OR PLUG BACK, GIVE DATA ON PRESENT PRODUCTIVE ZONE AND PROPOSED NEW PRODUCTIVE ZONE. GIVE BLOWOUT PREVENTER PROGRAM, IF ANY.

I hereby certify that the information above is true and complete to the best of my knowledge and belief.

Signed [Signature] Title President Date March 3, 1988

(This space for State Use)

Original Signed By Mike Williams TITLE Oil & Gas Inspector DATE MAR 8 1988

CONDITIONS OF APPROVAL, IF ANY

## OIL CONSERVATION DIVISION

STATE OF NEW MEXICO  
ENERGY AND MINERALS DEPARTMENTP. O. BOX 2088  
SANTA FE, NEW MEXICO 87501Form C-102  
Revised 10-1-78

All distances must be from the outer boundaries of the Section.

Operator ELK OIL CO.			Lease AIKMAN STATE COM			Well No. #2		
Unit Letter H	Section 14	Township 9 SOUTH	Range 26 EAST	County CHAVES				
Actual Footage Location of Well: 1980 feet from the NORTH line and 660 feet from the EAST line								
Ground Level Elev. 3814	Producing Formation Wolfcamp		Pool Und. Foor Ranch Wolfcamp		Dedicated Acreage 320 Acres			

1. Outline the acreage dedicated to the subject well by colored pencil or hatchure marks on the plat below.
2. If more than one lease is dedicated to the well, outline each and identify the ownership thereof (both as to working interest and royalty).
3. If more than one lease of different ownership is dedicated to the well, have the interests of all owners been consolidated by communitization, unitization, force-pooling, etc?

☒ Yes ☐ No If answer is "yes," type of consolidation Communitization

If answer is "no," list the owners and tract descriptions which have actually been consolidated. (Use reverse side of this form if necessary.)

No allowable will be assigned to the well until all interests have been consolidated (by communitization, unitization, forced-pooling, or otherwise) or until a non-standard unit, eliminating such interests, has been approved by the Division.

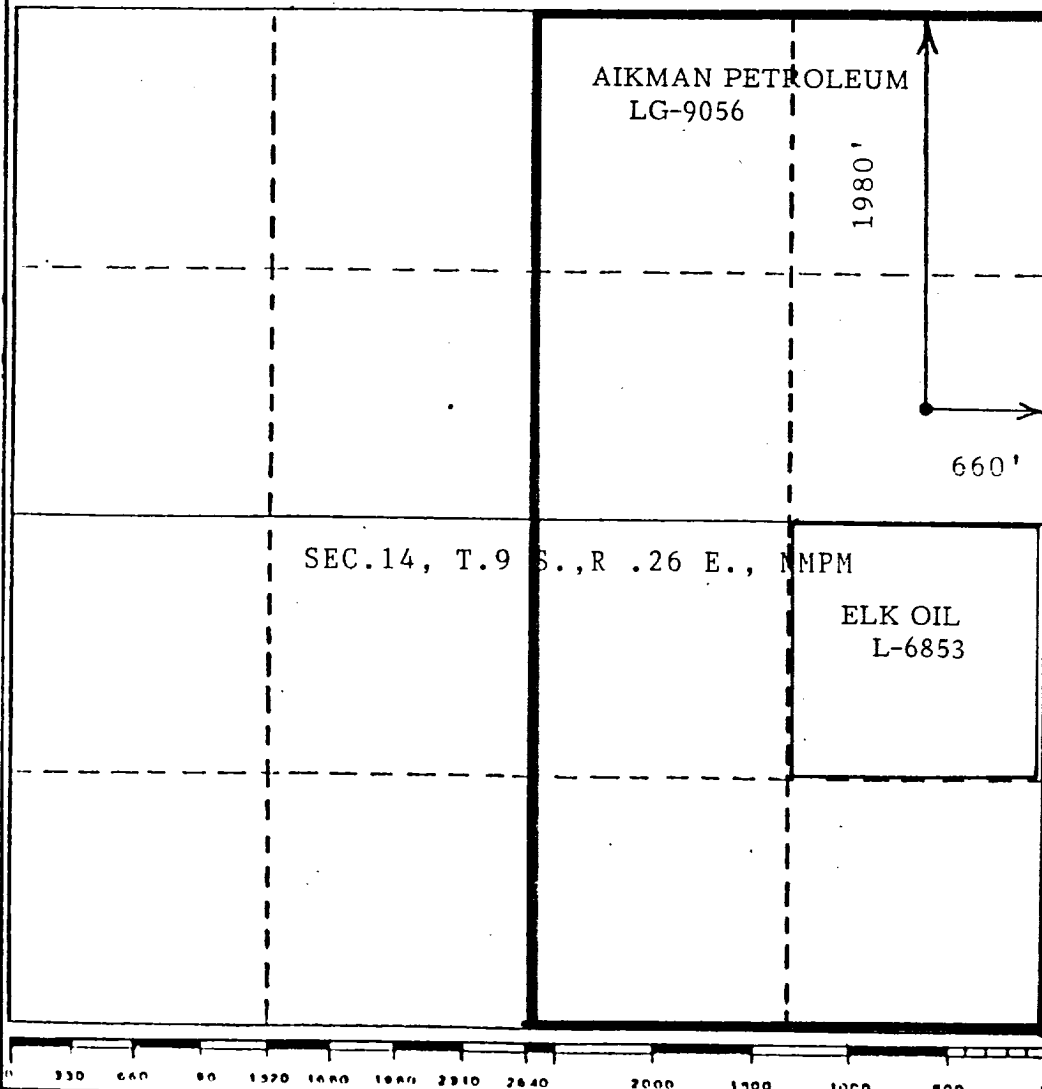

## CERTIFICATION

I hereby certify that the information contained herein is true and complete to the best of my knowledge and belief.

Name  
Joseph J. Kelly  
Position  
President  
Company  
ELK OIL COMPANY  
Date  
March 3, 1988

I hereby certify that the well location shown on this plat was plotted from field notes of actual surveys made by me or under my supervision, and that the same is true and correct to the best of my knowledge and belief.

Date Surveyed  
MARCH 3, 1988  
Registered Professional Engineer  
and/or Land Surveyor  
JOHN D. JACQUES  
L.S.  
Certificate No. 110 PROFESSIONAL ENGINEER

ELK OIL COMPANY  
Aikman State Comm #2  
1980 FNL, 660 FEL  
Section 14-9S-26E  
Chaves County, New Mexico

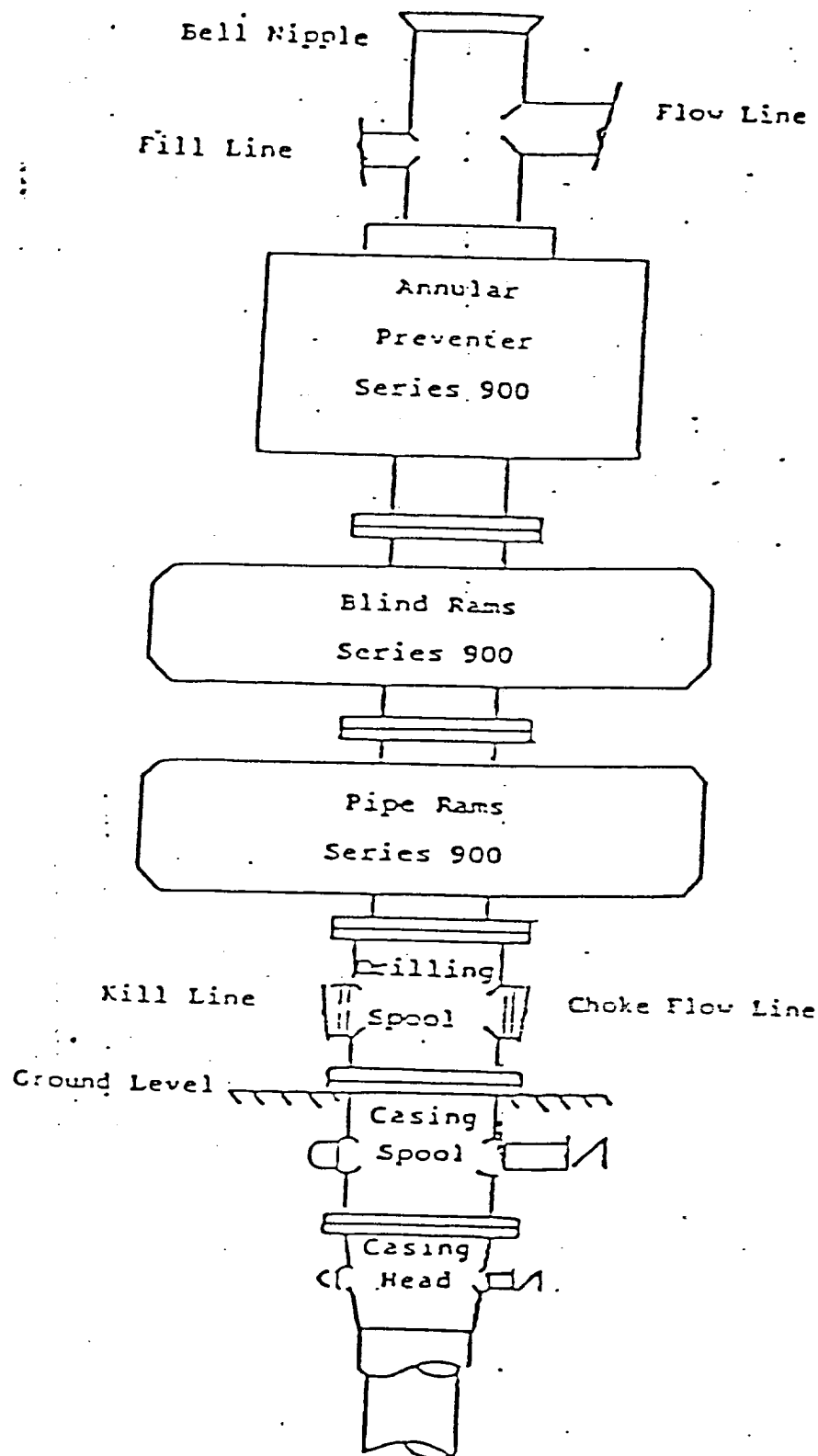

BLOWOUT PREVENTER STACK  
3000# WD