

NO. OF COPIES RECEIVED	
DISTRIBUTION	
ANTA FE	✓
FILE	✓
U.S.G.S.	✓
LAND OFFICE	✓
OPERATOR	✓

RECEIVED
NEW MEXICO OIL CONSERVATION COMMISSION

MAR 16 '88

O. C. D.
ARTESIA OFFICE

30-005-62597
Form C-101
Revised 1-1-65

5A. Indicate Type of Lease	
STATE <input type="checkbox"/>	FEE <input checked="" type="checkbox"/>

5. State Oil & Gas Lease No.

APPLICATION FOR PERMIT TO DRILL, DEEPEN, OR PLUG BACK

1a. Type of Work				7. Unit Agreement Name	
b. Type of Well DRILL <input checked="" type="checkbox"/> DEEPEN <input type="checkbox"/> PLUG BACK <input type="checkbox"/> OIL WELL <input checked="" type="checkbox"/> GAS WELL <input type="checkbox"/> OTHER <input type="checkbox"/> SINGLE ZONE <input type="checkbox"/> MULTIPLE ZONE <input type="checkbox"/>				8. Farm or Lease Name MILLER & OLSEN	
2. Name of Operator STEVENS OPERATING CORPORATION				9. Well No. 1	
3. Address of Operator P.O. BOX 2408, ROSWELL, NEW MEXICO 88202				Field and Pool of Well UNDESIGNATED	
4. Location of Well UNIT LETTER B LOCATED 660 FEET FROM THE NORTH LINE AND 1980 FEET FROM THE EAST LINE OF SEC. 3 TWP. 8S RGE. 28E NMPM				12. County CHAVES	
				19. Proposed Depth 2710	
				19A. Formation SAN ANDRES	
				20. Rotary or C.T. ROTARY	
21. Elevations (Show whether DF, RT, etc.) 3984		21A. Kind & Status Plug. Bond STATEWIDE OK		21B. Drilling Contractor UNITED DRILLING	
				22. Approx. Date Work will start 3/18/88	

23.

PROPOSED CASING AND CEMENT PROGRAM

SIZE OF HOLE	SIZE OF CASING	WEIGHT PER FOOT	SETTING DEPTH	SACKS OF CEMENT	EST. TOP
12 1/4	8 5/8	24.0#	210'	Circ to Surface	
7 7/8	4 1/2	9.5#	2700'	500' Above pay zone	

Propose to drill to a total depth of 2700'. All potential zones will be evaluated. If commercial production is indicated, well will be selectively perforated and treated. Adequate blowout preventers will be used.

Post ID#1

NL & API
3-18-88

APPROVED FOR 180 DAYS
9/17/88
AND UNDERWAY

IN ABOVE SPACE DESCRIBE PROPOSED PROGRAM: IF PROPOSAL IS TO DEEPEN OR PLUG BACK, GIVE DATA ON PRESENT PRODUCTIVE ZONE AND PROPOSED NEW PRODUCTIVE ZONE. GIVE BLOWOUT PREVENTER PROGRAM, IF ANY.

I hereby certify that the information above is true and complete to the best of my knowledge and belief.

Signed Mike Williams Title GENERAL MANAGER Date 3/16/88

(This space for State Use)

Original Signed By

APPROVED BY Mike Williams TITLE

DATE MAR 17 1988

CONDITIONS OF APPROVAL, Oil & Gas Inspector

**N. MEXICO OIL CONSERVATION COMMISSION
WELL LOCATION AND ACREAGE DEDICATION PLAT**

Form C-102
Supersedes C-128
Effective 1-1-65

All distances must be from the outer boundaries of the Section.

Operator STEVENS OPERATION COMPANY			Lease Miller and Olsen		Well No. 1
Unit Letter B	Section 3	Township 8 South	Range 28 East	County chevas	
Actual Footage Location of Well: 660 feet from the north line and 1980 feet from the east line					
Ground Level Elev. 3984.	Producing Formation SAN ANDRES		Pool UNDESIGNATED RAILROAD MT. S.A	Dedicated Acreage: 40 Acres	

1. Outline the acreage dedicated to the subject well by colored pencil or hachure marks on the plat below.
2. If more than one lease is dedicated to the well, outline each and identify the ownership thereof (both as to working interest and royalty).
3. If more than one lease of different ownership is dedicated to the well, have the interests of all owners been consolidated by communitization, unitization, force-pooling, etc?

☐ Yes ☐ No If answer is "yes," type of consolidation _____

If answer is "no," list the owners and tract descriptions which have actually been consolidated. (Use reverse side of this form if necessary.) _____

No allowable will be assigned to the well until all interests have been consolidated (by communitization, unitization, forced-pooling, or otherwise) or until a non-standard unit, eliminating such interests, has been approved by the Commission.

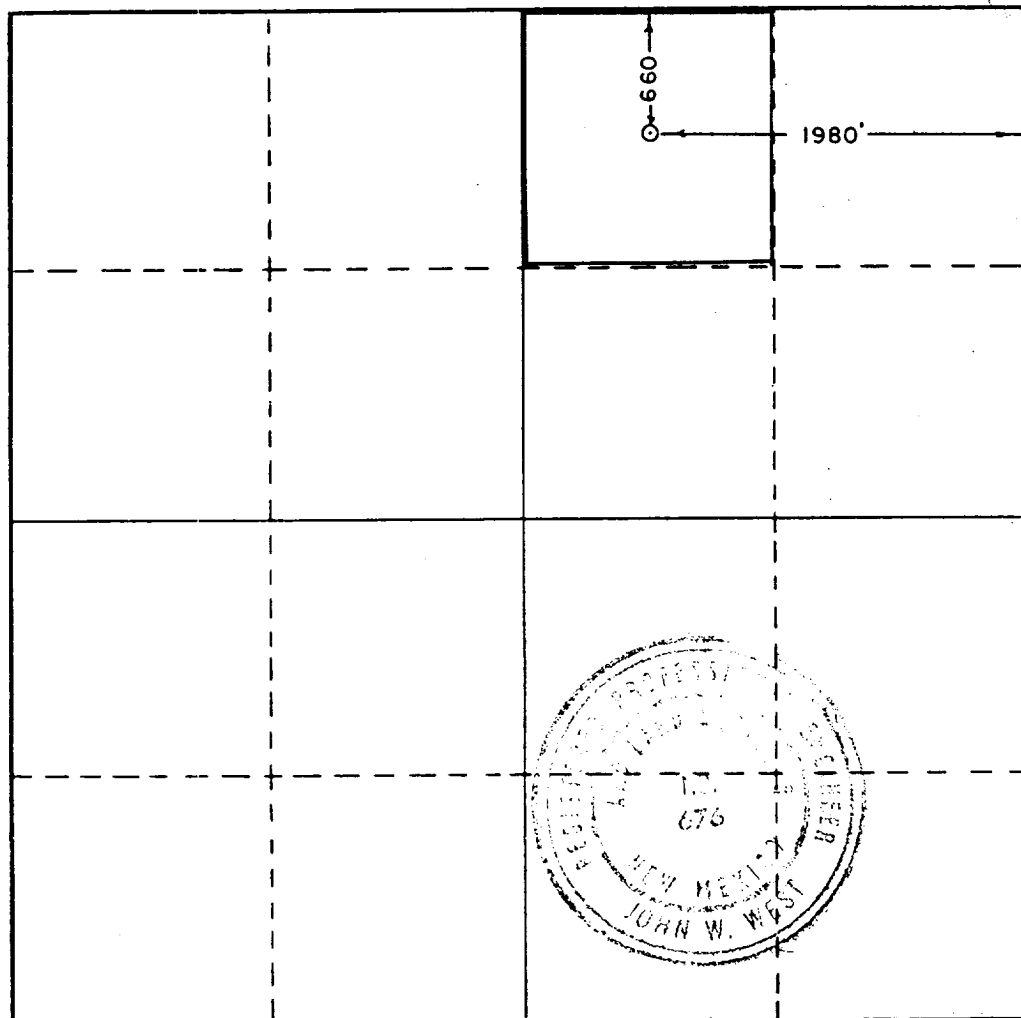

CERTIFICATION

I hereby certify that the information contained herein is true and complete to the best of my knowledge and belief.

Patricia Greenwade
 Name
Patricia Greenwade
 Position
General Manager
 Company
Stevens Operating Corporation
 Date
3/16/88

I hereby certify that the well location shown on this plat was plotted from field notes of actual surveys made by me or under my supervision, and that the same is true and correct to the best of my knowledge and belief.

March 15, 1988
 Date Surveyed

Registered Professional Engineer
and/or Land Surveyor

John W. West
 Certificate No. **JOHN W. WEST 676**
RONALD J. EIDSON, 3239