

NO. OF COPIES RECEIVED	
DISTRIBUTION	
SANTA FE	<input checked="" type="checkbox"/>
FILE	<input checked="" type="checkbox"/>
U.S.G.S.	<input checked="" type="checkbox"/>
LAND OFFICE	<input checked="" type="checkbox"/>
OPERATOR	<input checked="" type="checkbox"/>

MAR 21 '88

O. C. D.
ARTESIA, OFFICE5A. Indicate Type of Lease
STATE ☒ FEE ☐5. State Oil & Gas Lease No.
LG-5242

APPLICATION FOR PERMIT TO DRILL, DEEPEN, OR PLUG BACK

1a. Type of Work b. Type of Well OIL WELL <input checked="" type="checkbox"/> GAS WELL <input type="checkbox"/> OTHER <input type="checkbox"/> DEEPEN <input checked="" type="checkbox"/> PLUG BACK <input type="checkbox"/> SINGLE ZONE <input type="checkbox"/> MULTIPLE ZONE <input type="checkbox"/>		7. Unit Agreement Name
2. Name of Operator Yates Petroleum Corporation		8. Farm or Lease Name Brunner Pan American
3. Address of Operator 105 South Fourth Street - Artesia, NM 88210		9. Well No. A&K State 1
4. Location of Well UNIT LETTER 0 LOCATED 330 FEET FROM THE South LINE AND 2310 FEET FROM THE East LINE OF SEC. 9 TWP. 10S RGE. 27E NMPM		10. Field and Pool, or Wildcat Undes. Diablo San Andres
11. Elevations (show whether DF, KT, etc.) 3866.5' GR		12. County Chaves
21A. Kind & Status Plug. Bond Blanket	19. Proposed Depth 2200'	19A. Formation San Andres
21B. Drilling Contractor Roy Collins Drilling	20. Rotary or C.T. Cable Tool	22. Approx. Date Work will start ASAP

PROPOSED CASING AND CEMENT PROGRAM

SIZE OF HOLE	SIZE OF CASING	WEIGHT PER FOOT	SETTING DEPTH	SACKS OF CEMENT	EST. TOP
12-1/2"	8-5/8"	24# J-55	Approx. 425'	250 sacks	Circulate
8"	5-1/2"	14# J-55	TD	300 sacks	

We propose to drill and test the San Andres formation. Approximately 425' of surface casing will be set and cement circulated. If commercial, production casing will be run and cemented with adequate cover, perforated and stimulated as needed for production.

POST ID#1
NL & API
3-25-88180
9/22/88

IN ABOVE SPACE DESCRIBE PROPOSED PROGRAM IF PROPOSAL IS TO DEEEN OR PLUG BACK, GIVE DATA ON PRESENT PRODUCTIVE ZONE AND PROPOSED NEW PRODUCTIVE ZONE. GIVE BLOWOUT PREVENTER PROGRAM, IF ANY.

I hereby certify that the information above is true and complete to the best of my knowledge and belief.

Signed Cy Cowan Title Permit Agent Date March 21, 1988

(This space for State Use)

Original Signed By

Mike Williams

APPROVED BY

Oil & Gas Inspector

DATE MAR 22 1988

CONDITIONS OF APPROVAL, IF ANY

**NEW MEXICO OIL CONSERVATION COMMISSION
WELL LOCATION AND ACREAGE DEDICATION PLAT**

Form C-102
Supersedes C-128
Effective 1-1-65

All distances must be from the outer boundaries of the Section.

Operator YATES PETROLEUM CORPORATION			Lease BRUNNER PAN AMERICAN AEK STATE		Well No. 1
Unit Letter 0	Section 9	Township 10S	Range 27E	County CHAVES	
Actual Footage Location of Well: 330 feet from the South line and 2310 feet from the East line					
Ground Level Elev. 3866.5'	Producing Formation SAN ANDRES		Pool UNORS DIABLO SAN ANDRES		Dedicated Acreage: 40 Acres

1. Outline the acreage dedicated to the subject well by colored pencil or hachure marks on the plat below.
2. If more than one lease is dedicated to the well, outline each and identify the ownership thereof (both as to working interest and royalty).
3. If more than one lease of different ownership is dedicated to the well, have the interests of all owners been consolidated by communitization, unitization, force-pooling, etc?

☐ Yes ☐ No If answer is "yes," type of consolidation _____

If answer is "no," list the owners and tract descriptions which have actually been consolidated. (Use reverse side of this form if necessary.) _____

No allowable will be assigned to the well until all interests have been consolidated (by communitization, unitization, forced-pooling, or otherwise) or until a non-standard unit, eliminating such interests, has been approved by the Commission.

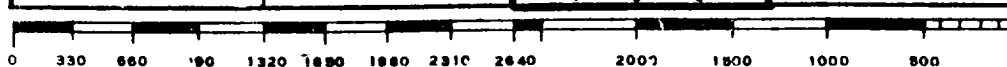
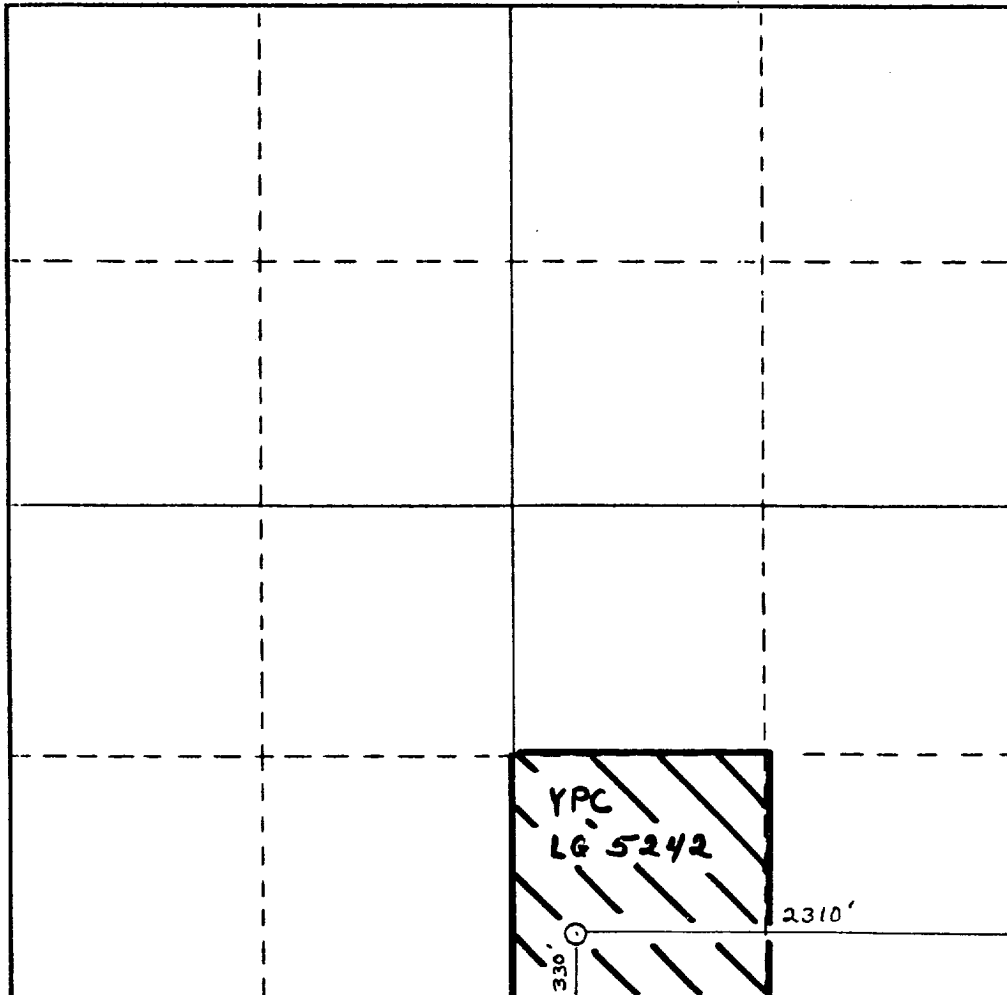

CERTIFICATION

I hereby certify that the information contained herein is true and complete to the best of my knowledge and belief.

Clifton R. May
Name

Clifton R. May

Position

Permit Agent

Company

Yates Petroleum Corporation

Date

March 21, 1988

I hereby certify that the well location shown on this plat was plotted from field notes of actual surveys made by me or under my supervision, and that the same is true and correct to the best of my knowledge and belief.

Date Surveyed

Registered Professional Engineer and/or Land Surveyor

[Signature]
3640

Certificate No. _____