

STATE OF NEW MEXICO
ENERGY AND MINERALS DEPARTMENT

CONSERVATION DIVISION
P. O. BOX 2088
SANTA FE, NEW MEXICO 87501

38-085-62601
Form C-101
Revised 10-1-78

NO. OF COPIES RECEIVED	
DISTRIBUTION	
SANTA FE	<input checked="" type="checkbox"/>
FILE	<input checked="" type="checkbox"/>
U.S.G.S.	<input checked="" type="checkbox"/>
LAND OFFICE	<input checked="" type="checkbox"/>
OPERATOR	<input checked="" type="checkbox"/>

MAR 22 '88

O. C. D.

APPLICATION FOR PERMIT TO DRILL, DEEPEN, OR PLUG BACK

1a. Type of Work DRILL <input checked="" type="checkbox"/> DEEPEN <input type="checkbox"/> PLUG BACK <input type="checkbox"/>		7. Unit Agreement Name
b. Type of Well OIL WELL <input type="checkbox"/> GAS WELL <input checked="" type="checkbox"/> OTHER <input type="checkbox"/>		8. Farm or Lease Name Lucky Com
2. Name of Operator McKay Oil Corporation		9. Well No. 1
3. Address of Operator P.O. Box 2014, Roswell, New Mexico 88201		10. Field and Pool, or Wildcat W. Pecos Slope Abo
4. Location of Well UNIT LETTER J LOCATED 1650 FEET FROM THE south LINE AND 1980 FEET FROM THE East LINE OF SEC. 17 TWP. 6 south REC. 22 E NMPM		12. County Chaves
19. Proposed Depth 3400'		19A. Formation ABO
20. Rotary or C.T. Rotary		
21. Elevations (show whether DF, RT, etc.) 4330GL	21A. Kind & Status Plug. Bond statewide blanket	21B. Drilling Contractor Grande Drilling
22. Approx. Date Work will start asap		

23. PROPOSED CASING AND CEMENT PROGRAM

SIZE OF HOLE	SIZE OF CASING	WEIGHT PER FOOT	SETTING DEPTH	SACKS OF CEMENT	EST. TOP
12 1/4"	8 5/8"	24.0# J-55	850'+-	450 sx	surface
7 7/8"	4 1/2"	9.5# j-55	TD	150 sx	600' above t/pay

1. Drill 12 1/4 " hole to 850' and run 8 5/8" casing and cement to surface.
2. Wait on cement for 18 hours.
3. Nipple up on 8 5/8" casing using a double ram Blow Out preventer and pressure test caing to 1000 psi for 30 minutes.
4. Drill 7 7/8" hole to 3,400' to adequately test the Abo Formation.
5. Run 4 1/2 casing if warranted and cement to 600' above top of pay section and or to isolate all oil, gas and water zones

POST 10#1
NL & API
3-25-88

180
9/23/88

IN ABOVE SPACE DESCRIBE PROPOSED PROGRAM; IF PROPOSAL IS TO DEEPEN OR PLUG BACK, GIVE DATA ON PRESENT PRODUCTIVE ZONE AND PROPOSED NEW PRODUCTIVE ZONE. GIVE BLOWOUT PREVENTER PROGRAM, IF ANY.

I hereby certify that the information above is true and complete to the best of my knowledge and belief.

Signed [Signature] Title Landman Date March 21, 1988

(This space for State Use)

Original Signed By

APPROVED BY Mike Williams TITLE Oil & Gas Inspector

CONDITIONS OF APPROVAL, IF ANY

MAR 23 1988

OIL CONSERVATION DIVISION

STATE OF NEW MEXICO
ENERGY AND MINERALS DEPARTMENTP. O. BOX 2088
SANTA FE, NEW MEXICO 87501Form C-102
Revised 10-1-78

All distances must be from the outer boundaries of the Section.

Operator McKAY OIL CORP.		Lease LUCKY COM		Well No. #1
Unit Letter J	Section 17	Township 6 SOUTH	Range 22 EAST	County CHAVES
Actual Footage Location of Well: 1650 feet from the SOUTH line and 1980 feet from the EAST line				
Ground Level Elev. 4330	Producing Formation ABO	Pool UND. W. Pecos Slope Abo	Dedicated Acreage: 160.0 Acres	

1. Outline the acreage dedicated to the subject well by colored pencil or hatchure marks on the plat below.
2. If more than one lease is dedicated to the well, outline each and identify the ownership thereof (both as to working interest and royalty).
3. If more than one lease of different ownership is dedicated to the well, have the interests of all owners been consolidated by communitization, unitization, force-pooling, etc?

☒ Yes ☐ No If answer is "yes," type of consolidation Communitization Agreement

If answer is "no," list the owners and tract descriptions which have actually been consolidated. (Use reverse side of this form if necessary.)

No allowable will be assigned to the well until all interests have been consolidated (by communitization, unitization, forced-pooling, or otherwise) or until a non-standard unit, eliminating such interests, has been approved by the Division.

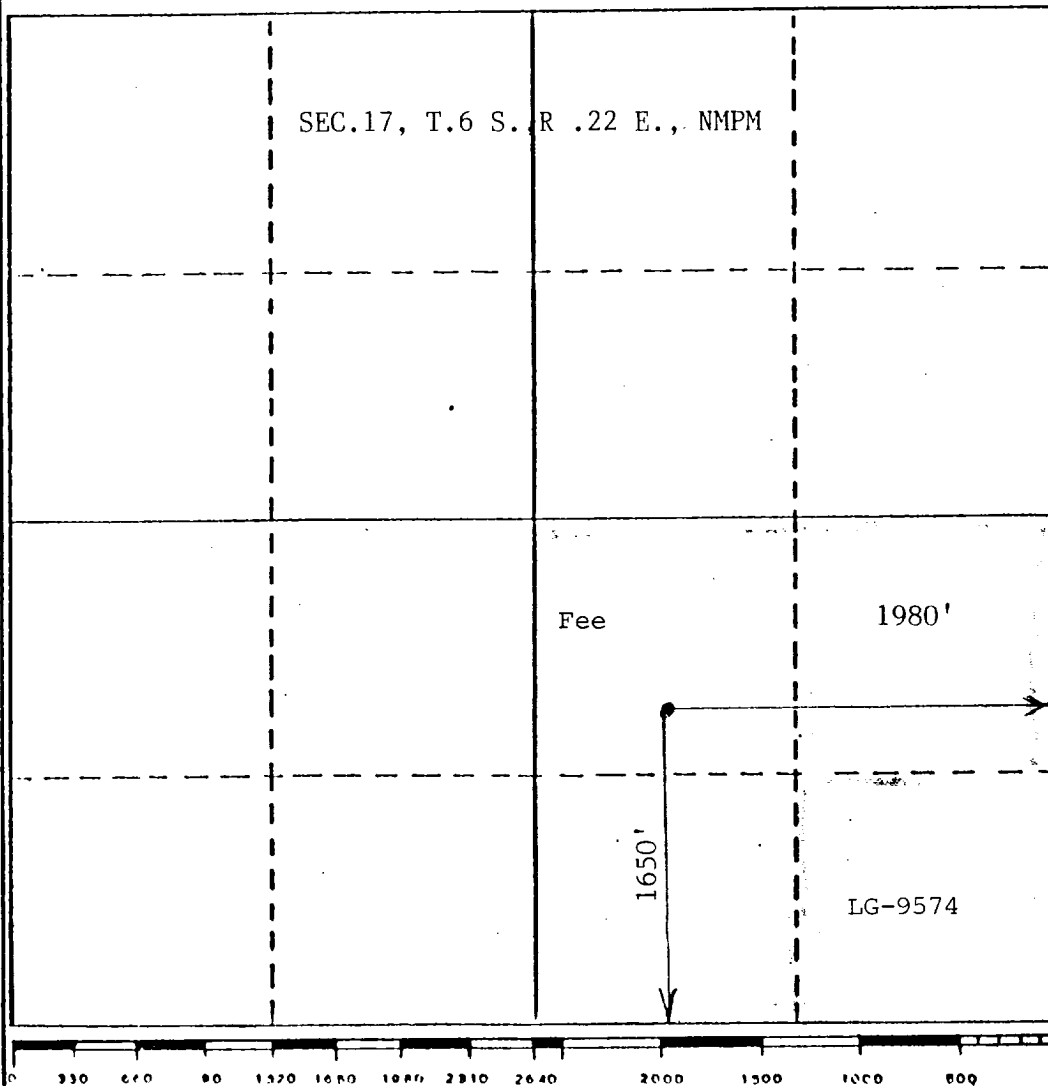

CERTIFICATION

I hereby certify that the information contained herein is true and complete to the best of my knowledge and belief.

Sam L. Shackelford

Name

Landman

Position

McKay Oil Corp.

Company

March 21, 1988

Date

I hereby certify that the well location shown on this plat was plotted from field notes of actual surveys made by me or under my supervision, and that the same is true and correct to the best of my knowledge and belief.

Date Surveyed

MARCH 20, 1988

Registered Professional Engineer
and/or Land Surveyor

John D. Jaques, P.E. & L.S.

Certificate No. 6280

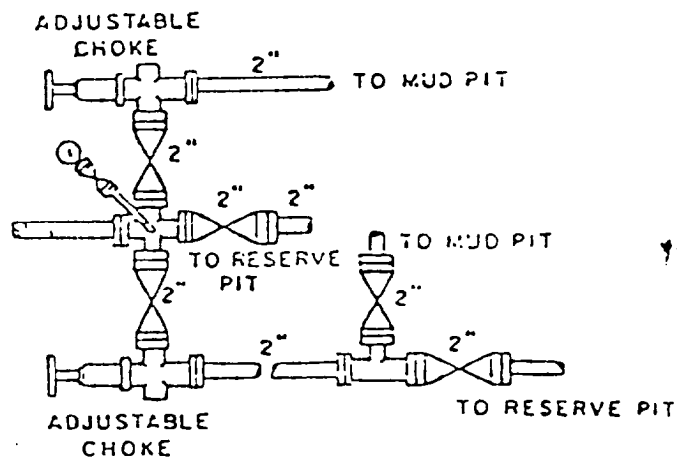
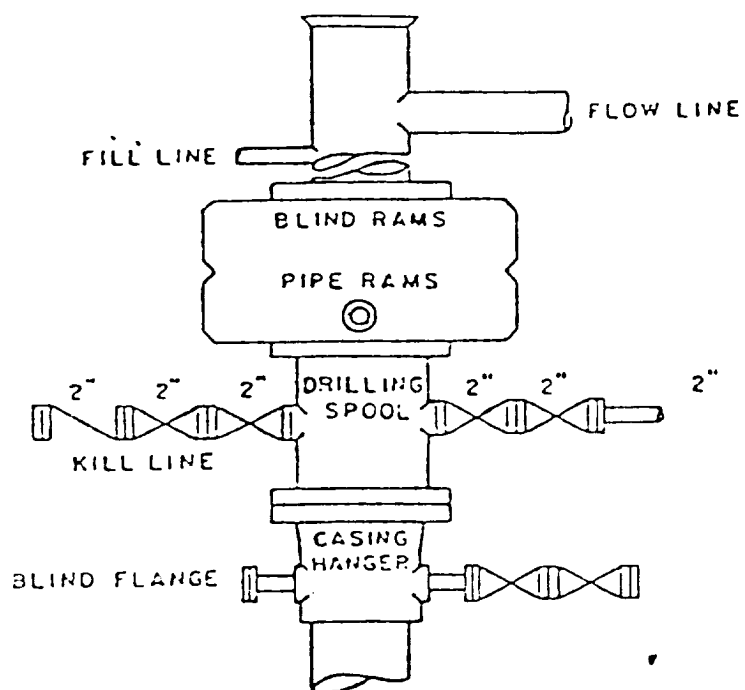

BOP DIAGRAM

3000# Working Pressure
Rams Operated Daily