

NO. OF COPIES RECEIVED	
DISTRIBUTION	
SANTA FE	<input checked="" type="checkbox"/>
FILE	<input checked="" type="checkbox"/>
U.S.G.S.	<input checked="" type="checkbox"/>
LAND OFFICE	<input checked="" type="checkbox"/>
OPERATOR	<input checked="" type="checkbox"/>

MAR 30 '88

5A. Indicate Type of Lease
STATE ☐ FEE ☒

5. State Oil & Gas Lease No.

APPLICATION FOR PERMIT TO DRILL, DEEPEN, OR PLUG BACK C. D.

1a. Type of Work ARTESIA, OFFICE		7. Unit Agreement Name
b. Type of Well DRILL <input checked="" type="checkbox"/> DEEPEN <input type="checkbox"/> PLUG BACK <input type="checkbox"/> OIL WELL <input checked="" type="checkbox"/> GAS WELL <input type="checkbox"/> OTHER <input type="checkbox"/> SINGLE ZONE <input checked="" type="checkbox"/> MULTIPLE ZONE <input type="checkbox"/>		8. Farm or Lease Name Alma Shields
2. Name of Operator N. Dale Nichols		9. Well No. 9
3. Address of Operator P.O. Box 1972, Midland, Texas 79702		10. Field and Pool, or Wildcat ACME(San Andres)
4. Location of Well UNIT LETTER M LOCATED 990 FEET FROM THE South LINE AND 330 FEET FROM THE West LINE OF SEC. 33 TWP. 7S RGE. 27E NMPM		12. County Chaves
19. Proposed Depth 1980		19A. Formation San Andres
20. Rotary or C.T. Rotary		
11. Elevations (Show whether DF, KT, etc.) 4015 GL	21A. Kind & Status Plug. Bond Blanket	21B. Drilling Contractor SELF
22. Approx. Date Work will start 4-1-88		

23.

PROPOSED CASING AND CEMENT PROGRAM

SIZE OF HOLE	SIZE OF CASING	WEIGHT PER FOOT	SETTING DEPTH	SACKS OF CEMENT	EST. TOP
9 7/8"	7 5/8"	26.40	300'	125	Circulate
6 3/4"	5 1/2"	17.00	1920'	100	1450'
4 3/4"	Open Hole	-	1920 to 1980		

POST ID#1
NL & API
4-8-88

180
10/1/88

IN ABOVE SPACE DESCRIBE PROPOSED PROGRAM: IF PROPOSAL IS TO DEEPEN OR PLUG BACK, GIVE DATA ON PRESENT PRODUCTIVE ZONE AND PROPOSED NEW PRODUCTIVE ZONE. GIVE BLOWOUT PREVENTER PROGRAM, IF ANY.

I hereby certify that the information above is true and complete to the best of my knowledge and belief.

Signed For E. McArthur Title Production Technician Date 3-29-88

(This space for State Use)

Original Signed By

Mike Williams

APPROVED BY Oil & Gas Inspector TITLE DATE APR 1 1988

CONDITIONS OF APPROVAL, IF ANY

All distances must be from the outer boundaries of the Section

Operator N. DALE NICHOLS		Lessee ALMA SHIELDS		Well No. 9
Unit Letter M	Section 33	Township 7S	Range 27E	County CHAVES
Actual Postage Location of Well: 990 feet from the SOUTH line and 330 feet from the WEST line				
Ground Level Elev. 4015	Producing Formation San Andres	Pool ACHIE	Dedicated Acreage: 40.0 Acres	

1. Outline the acreage dedicated to the subject well by colored pencil or hatchure marks on the plat below.
2. If more than one lease is dedicated to the well, outline each and identify the ownership thereof (both as to working interest and royalty). **NO**
3. If more than one lease of different ownership is dedicated to the well, have the interests of all owners been consolidated by communitization, unitization, force-pooling, etc?

☐ Yes ☐ No If answer is "yes," type of consolidation _____

If answer is "no," list the owners and tract descriptions which have actually been consolidated. (Use reverse side of this form if necessary.) _____

No allowable will be assigned to the well until all interests have been consolidated (by communitization, unitization, forced-pooling, or otherwise) or until a non-standard unit, eliminating such interests, has been approved by the Division

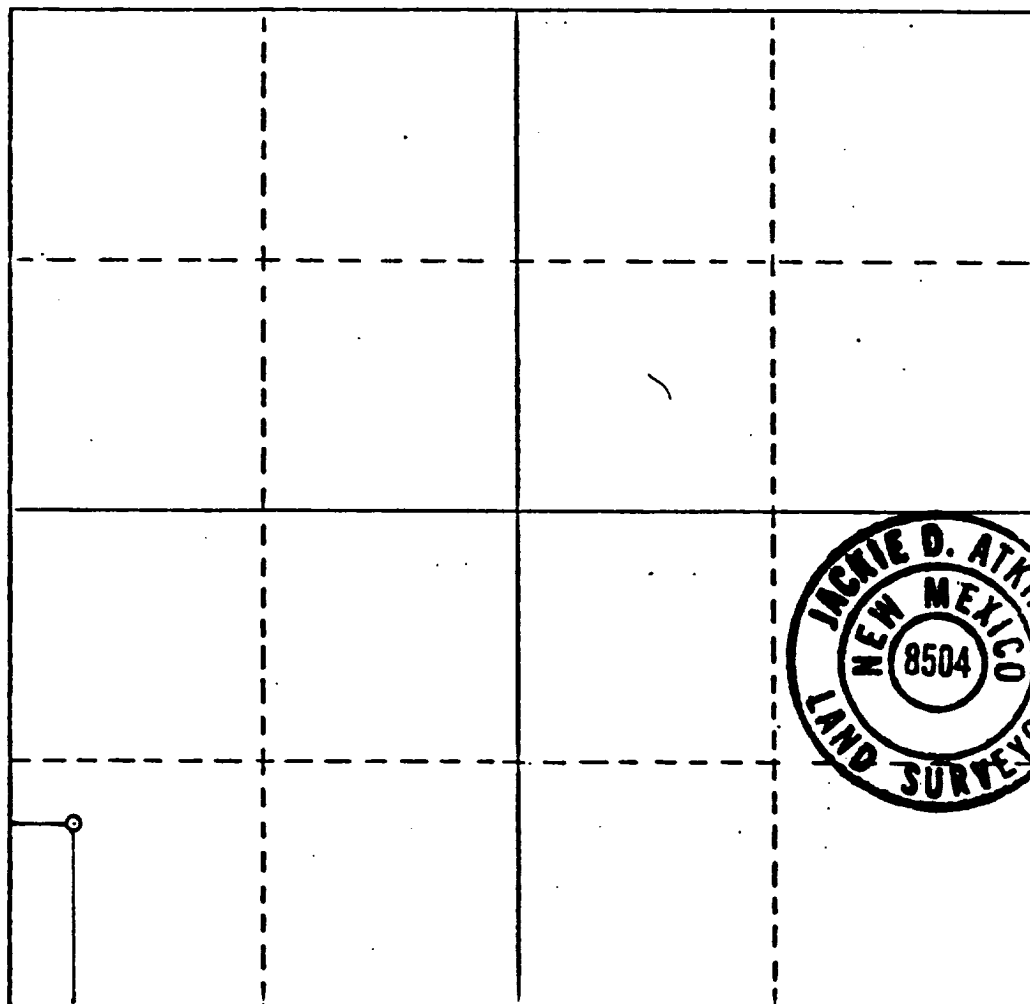

CERTIFICATION

I hereby certify that the information contained herein is true and complete to the best of my knowledge and belief.

Name
John E. Nichols
Position
Production Technician
Company
N. Dale Nichols
Date
3-29-88

I hereby certify that the well location shown on this plat was plotted from field notes of actual surveys made by me or under my supervision, and that the same is true and correct to the best of my knowledge and belief.

NOV. 16, 1987

Date Surveyed
James D. Atkins
Registered Professional Engineer
and/or Land Surveyor

Certificate No.
PE-6403 LS-8504

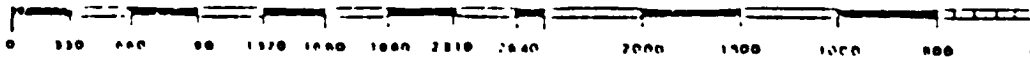

N. DALE NICHOLS

BOX 1972
MIDLAND, TEXAS 79702

REGAN BLOWOUT PREVENTOR

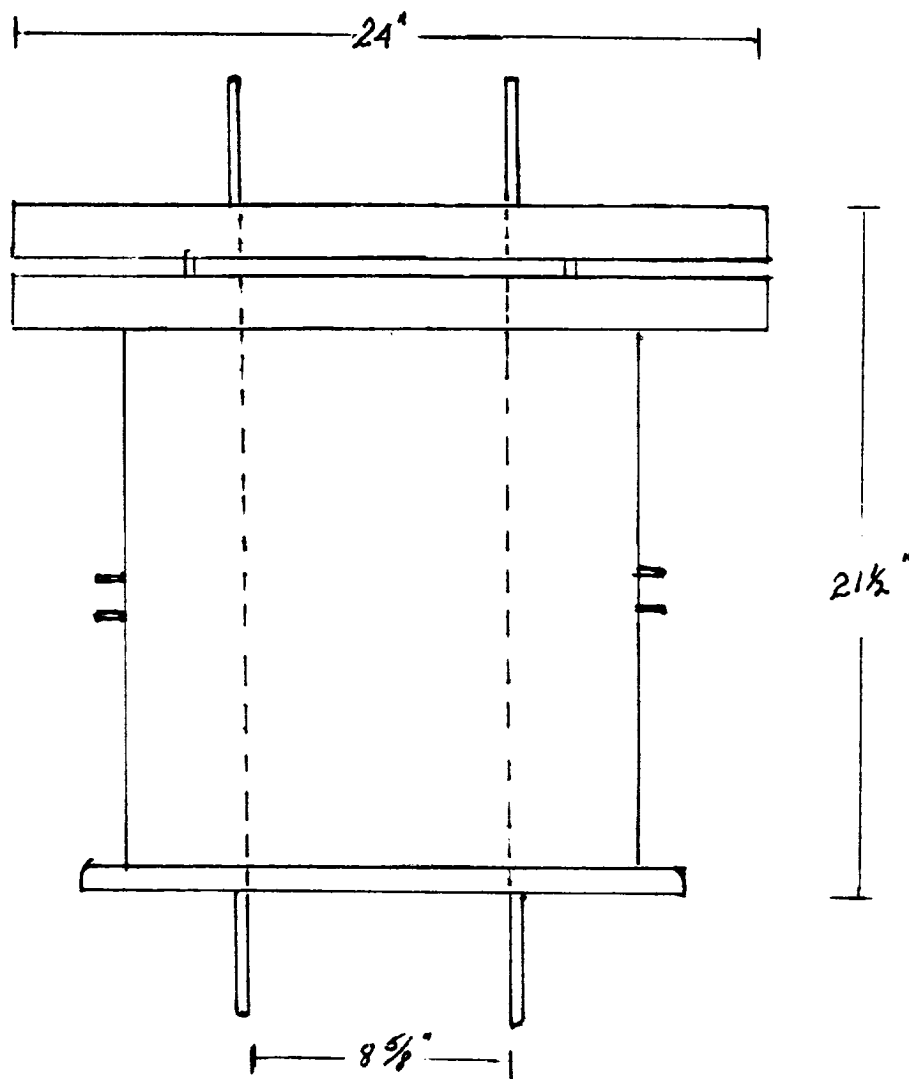
Operator N. Dale NicholsLease Alma ShieldsWell 9