

Form 3160-3  
(November 1983)  
(formerly 9-331C)

NM Oil Cons. mission

Drawer DD

Artesia, NM UNITED STATES

SUBMIT IN TRIPLICATE\*  
(Other instructions on  
reverse side)

30-805-62611  
Form approved.  
Budget Bureau No. 1004-0136  
Expires August 31, 1985

DEPARTMENT OF THE INTERIOR

BUREAU OF LAND MANAGEMENT

APPLICATION FOR PERMIT TO DRILL, DEEPEN, OR PLUG BACK

1a. TYPE OF WORK

DRILL ☒

DEEPEN ☐

PLUG BACK ☐

b. TYPE OF WELL

OIL  
WELL ☐

GAS  
WELL ☒

OTHER

SINGLE  
ZONE ☐

MULTIPLE  
RECEIVED ☐

2. NAME OF OPERATOR

McClellan Oil Corporation

3. ADDRESS OF OPERATOR

P. O. DR. 730 Roswell, NM 88202

APR 14 '88

4. LOCATION OF WELL (Report location clearly and in accordance with any State requirements\*)

At surface

1980' FSL & 660' FEL

At proposed prod. zone

Same

14. DISTANCE IN MILES AND DIRECTION FROM NEAREST TOWN OR POST OFFICE\*

15 miles northeast of Roswell, NM

15. DISTANCE FROM PROPOSED\*

LOCATION TO NEAREST  
PROPERTY OR LEASE LINE, FT.  
(Also to nearest drlg. unit line, if any)

660'

16. NO. OF ACRES IN LEASE

1514.68

17. NO. OF ACRES ASSIGNED  
TO THIS WELL

160

18. DISTANCE FROM PROPOSED LOCATION\*  
TO NEAREST WELL, DRILLING, COMPLETED,  
OR APPLIED FOR, ON THIS LEASE, FT.

3960'

19. PROPOSED DEPTH

4820'

20. ROTARY OR CABLE TOOLS

Rotary

21. ELEVATIONS (Show whether DF, RT, GR, etc.)

3782' GL

22. APPROX. DATE WORK WILL START\*

ASAP after approval

23.

PROPOSED CASING AND CEMENTING PROGRAM

SIZE OF HOLE	SIZE OF CASING	WEIGHT PER FOOT	SETTING DEPTH	QUANTITY OF CEMENT
12 1/4"	8 5/8"	23#	900'	450 sx class "C" circulated
7 7/8"	4 1/2"	10.5#	4820'	350 sx class "C"

Mud Program: Drill to top of Abo with fresh and native mud. Will mud up 100' above Abo with 9.5 lb/gal. wt./ 40 viscosity mud and 15 cc water loss.

BOP Specification: Will install and test daily a 3000# wp Shaffer Type E double hydraulic BOP with 4" pipe and blind rams with koomeg closing unit.

Gas is dedicated.



IN ABOVE SPACE DESCRIBE PROPOSED PROGRAM: If proposal is to deepen or plug back, give data on present productive zone and proposed new productive zone. If proposal is to drill or deepen directionally, give pertinent data on subsurface locations and measured and true vertical depths. Give blowout preventer program, if any.

24.

SIGNED

*George Smith*

TITLE

Agent for:

McClellan Oil Corporation

DATE

March 15, 1988

(This space for Federal or State office use)

PERMIT NO.

APPROVAL DATE

APPROVED BY

S/Phil Kirk

TITLE

Area Manager

MAR 29 1988

CONDITIONS OF APPROVAL, IF ANY:

APPROVAL OF THIS APPLICATION DOES NOT WARRANT OR CERTIFY THAT THE APPLICANT HOLDS LEGAL OR EQUITABLE TITLE TO THOSE RIGHTS IN THE SUBJECT LEASE WHICH WOULD ENTITLE THE APPLICANT TO CONDUCT OPERATIONS THEREON.

PLEASE BE ADVISED THAT THERE WILL BE NO EXCAVATION OF FEDERALLY OWNED MINERAL MATERIAL FOR CONSTRUCTION OF THE ACCESS ROAD OR PAD WITHOUT PAYMENT IN ADVANCE.

Title 18 U.S.C. Section 1001, makes it a crime for any person knowingly and willfully to make to any department or agency of the United States any false, fictitious or fraudulent statements or representations as to any matter within its jurisdiction.



All distances must be from the outer boundaries of the Section.

Operator <b>McClellan Oil Corporation</b>			Lease <b>Penjack Federal</b>			Well No. <b>7</b>		
Unit Letter <b>I</b>	Section <b>7</b>	Township <b>10 South</b>	Range <b>26 East</b>	County <b>Chaves</b>				
Actual Postage Location of Well:								
1980 feet from the		South line and		660 feet from the		East line		
Ground Level Elev. <b>3782</b>		Producing Formation <b>Abo</b>		Pool <b>UND. SOUTH</b> <b>Pecos Slope Abo</b>			Dedicated Acreage: <b>160</b> Acres	

1. Outline the acreage dedicated to the subject well by colored pencil or hatchure marks on the plat below.
2. If more than one lease is dedicated to the well, outline each and identify the ownership thereof (both as to working interest and royalty).
3. If more than one lease of different ownership is dedicated to the well, have the interests consolidated by communitization, unitization, force-pooling, etc?

☐ Yes ☐ No If answer is "yes," type of consolidation \_\_\_\_\_

If answer is "no," list the owners and tract descriptions which have actually been consolidated. (Use reverse side of this form if necessary.) \_\_\_\_\_

No allowable will be assigned to the well until all interests have been consolidated (by communitization, unitization, forced-pooling, or otherwise) or until a non-standard unit, eliminating such interests, has been approved by the Division.

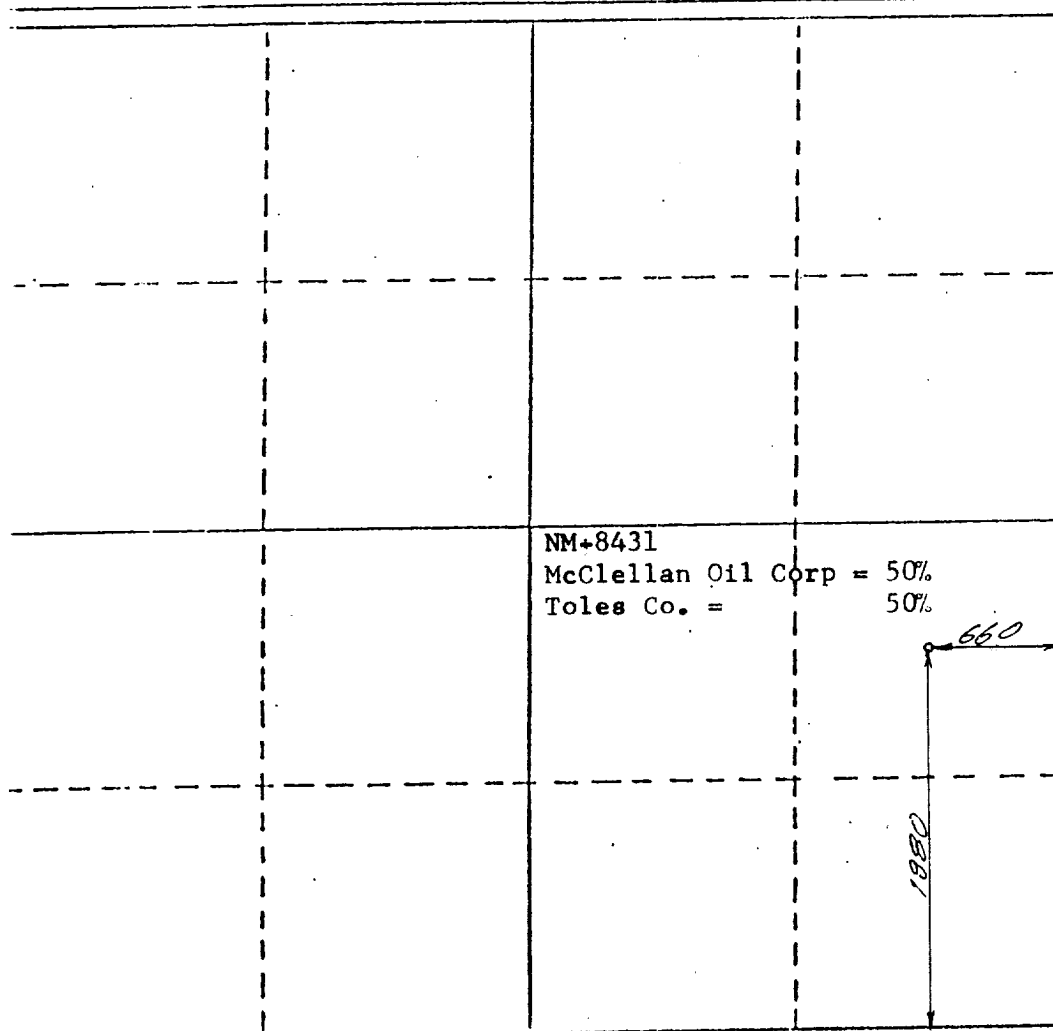
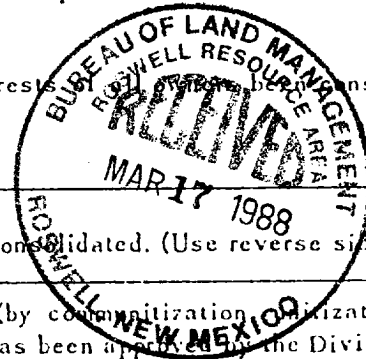

#### CERTIFICATION

I hereby certify that the information contained herein is true and complete to the best of my knowledge and belief.

*George R. Smith*

Name  
**George R. Smith**

Position  
**Agent for:**

Company  
**McClellan Oil Corporation**

Date  
**March 15, 1988**

I hereby certify that the well location shown on this plat was plotted from field notes of actual surveys made by me or under my supervision, and that the same is true and correct to the best of my knowledge and belief.

**1 March 1988**

Date Surveyed  
**P. R. Patton**

Registered Professional Geologist  
and/or Land Surveyor

**8112**

Certificate No.

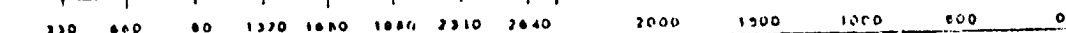
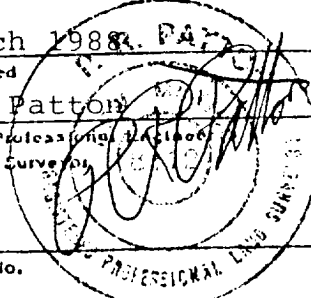



# BLOWOUT PREVENTER SPECIFICATION

WEK DRILLING CO., INC. - Rig 1 & 3



EXHIBIT "E"

McCLELLAN OIL CORPORATION  
Penjack Federal, Well No. 7  
BOP Specifications

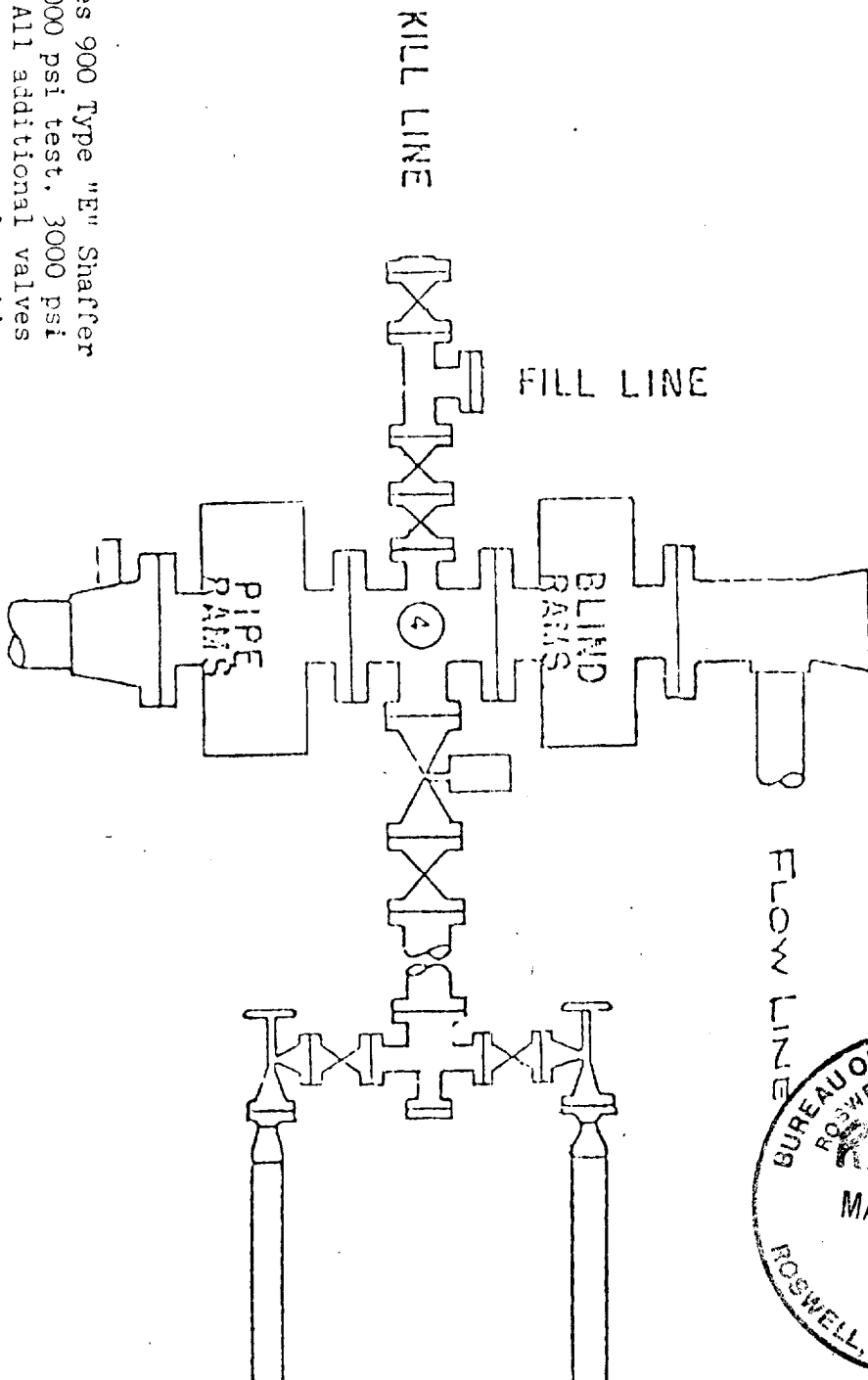

BOP's are 10" Series 900 Type "E" Shaffer Double Hydraulic 6000 psi test, 3000 psi working pressure. All additional valves & connections are the same test & working pressures.



APPLICATION FOR DRILLING

McCLELLAN OIL CORPORATION  
Penjack Federal, Well No. 7  
1980' FSL & 660' FEL, Sec. 7-T10S-R26E  
Chaves County, New Mexico  
Lease No.: NM-8431  
(Development Well)

In conjunction with Form 3160-3, Application for Permit to Drill subject well, McClellan Oil Corporation submits the following items of pertinent information in accordance with BLM requirements:

1. The geologic surface formation is recent Permian with quaternary alluvium and other surficial deposits.
2. The estimated tops of geologic markers are as follows:

San Andres	850'	Abo	4240'
Glorieta	1990'	T.D.	4820'
Tubb	3475'		

3. The estimated depths at which water, oil or gas formations are anticipated to encountered:

Water: Surface water between 100' to 300'.

Oil: None expected.

Gas: In the Abo below 4240'.

4. Proposed Casing Program: See Form 3160-3.
5. Pressure Control Equipment: See Form 3160-3 and Exhibit "E".
6. Mud Program: See Form 3160-3.
7. Auxiliary Equipment: Blowout preventer, gas detector, kelly cock, pit level monitor, flow sensors and stabbing valve.
8. Testing, Logging, and Coring Program:  
  
Drill Stem Tests: None planned.  
  
Logging: From surface Casing to T.D.: G/R, CNL-LDT, DLL,  
  
Coring: None planned.
9. No abnormal pressures or temperatures are anticipated. In the event abnormal pressures are encountered the proposed mud program will be modified.
10. Anticipated starting date: ASAP after approval.  
Anticipated completion of drilling operations: Approximately 35 days.







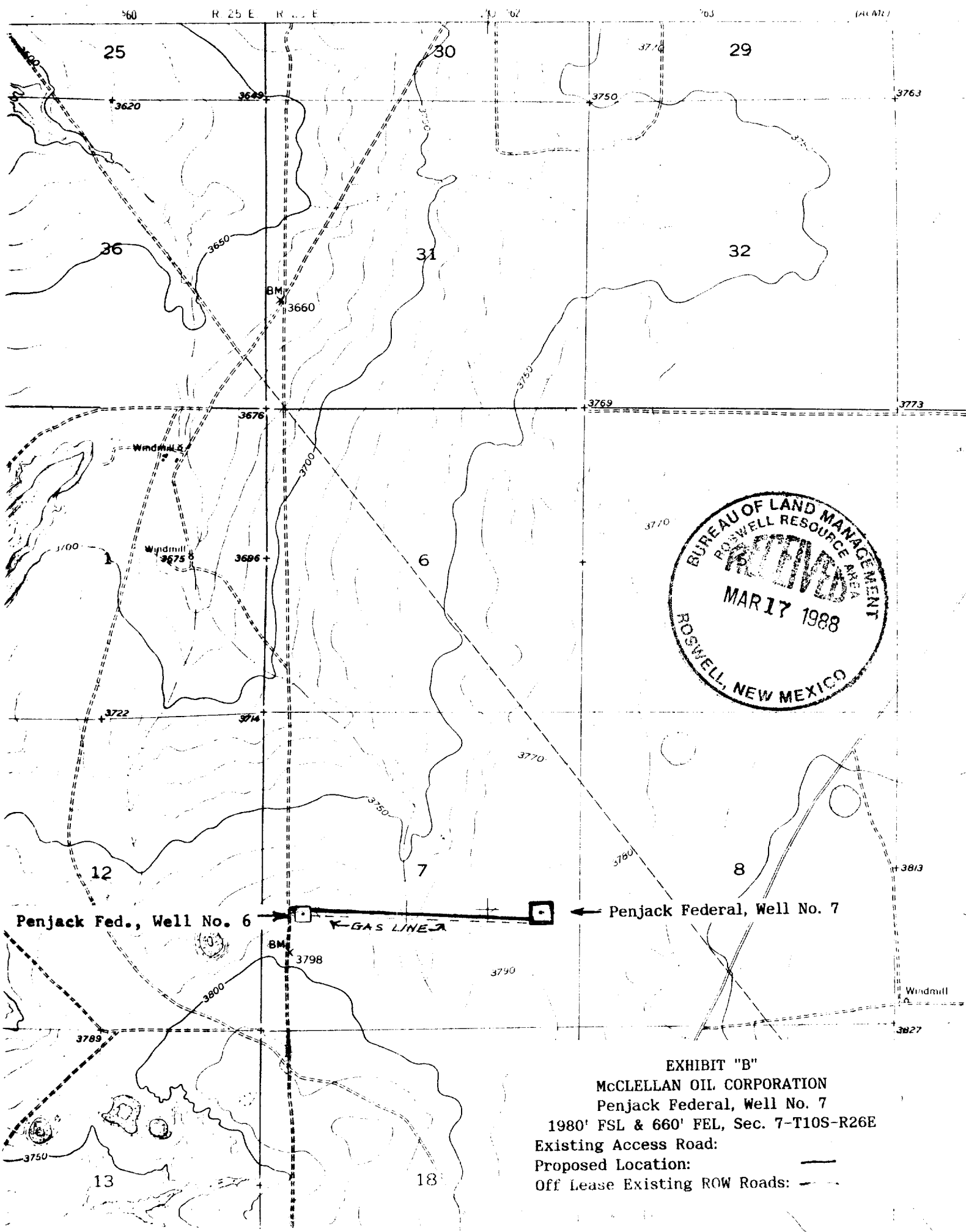

Penjack Fed., Well No. 6

Penjack Federal, Well No. 7

GAS LINE

EXHIBIT "B"

McCLELLAN OIL CORPORATION

Penjack Federal, Well No. 7

1980' FSL & 660' FEL, Sec. 7-T10S-R26E

Existing Access Road:

Proposed Location:

Off Lease Existing ROW Roads:



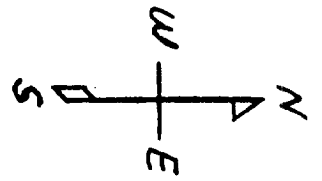

BURN PIT

SUCTION PIT

SHALE PIT

RESERVE  
PITS

CELLAR TO BE 5'x5'x5'  
IF REQUIRED

1-18-83

ACCESS  
ROAD



PLAT LAYOUT RIG 1  
WEEK DRILLING

STINGER

EXHIBIT "D"  
McCLELLAN OIL CORPORATION  
Penjack Federal, A-1, No. 1  
Rig Layout

