

N. M. Oil Cons. Commission

811 S. 1ST ST.

ARTESIA, NM 88210-2834

CLSF

Form 3160-5
June 1990

UNITED STATES
DEPARTMENT OF THE INTERIOR
BUREAU OF LAND MANAGEMENT

FORM APPROVED
Budget Bureau No. 1004-0135
Expires: March 31, 1993

SUNDRY NOTICES AND REPORTS ON WELLS

Do not use this form for proposals to drill or to deepen or reentry to a different reservoir.
Use "APPLICATION FOR PERMIT—" for such proposals

SUBMIT IN TRIPLICATE

RECEIVED

AUG 27 1996

OIL CON. DIV.

POST. 2

5. Lease Designation and Serial No.
NM-28162

6. If Indian, Allottee or Tribe Name

7. Unit or CA, Agreement Designation

8. Well Name and No.
Thorpe MI Fed. Com. #12

9. API Well No.
30-005-163045

10. Field and Pool, or Exploratory Area
Pecos Slope Abo

11. County or Parish, State
Chaves Co. NM

1. Type of Well
 Oil Well Gas Well Other

2. Name of Operator
Yates Petroleum Corporation

3. Address and Telephone No.
105 South Fourth Street, Artesia, NM 88210 (505) 748-1471

4. Location of Well (Footage, Sec., T., R., M., or Survey Description)
1980' FNL and 660' FWL, Unit Letter E
Section 10-T7S-R25E

CHECK APPROPRIATE BOX(S) TO INDICATE NATURE OF NOTICE, REPORT, OR OTHER DATA

TYPE OF SUBMISSION	TYPE OF ACTION
<input type="checkbox"/> Notice of Intent	<input type="checkbox"/> Abandonment
<input type="checkbox"/> Subsequent Report	<input type="checkbox"/> Recompletion
<input type="checkbox"/> Final Abandonment Notice	<input type="checkbox"/> Plugging Back
	<input type="checkbox"/> Casing Repair
	<input type="checkbox"/> Altering Casing
	<input type="checkbox"/> Other Amend Surface Use Plan
	<input type="checkbox"/> Change of Plans
	<input type="checkbox"/> New Construction
	<input type="checkbox"/> Non-Routine Fracturing
	<input type="checkbox"/> Water Shut-Off
	<input type="checkbox"/> Conversion to Injection
	<input type="checkbox"/> Dispose Water

(Note: Report results of multiple completion on Well Completion or Recompletion Report and Log form.)

3. Describe Proposed or Completed Operations (Clearly state all pertinent details, and give pertinent dates, including estimated date of starting any proposed work. If well is directionally drilled, give subsurface locations and measured and true vertical depths for all markers and zones pertinent to this work.)*

Yates Petroleum Corporation wishes to amend the surface use plan to include a 3" steel pipeline on the surface to a tie-in point on the Thorpe MI Fed. Com. #4 located in the NWNW of Section 10-T7S-R25E. An archaeological survey will be conducted.



4. I hereby certify that the foregoing is true and correct

Signed Chifton R. May Title Regulatory Agent Date 7-11-96

(This space for Federal or State office use)

Approved by J. L. Keegan Title Area Manager Date 8/22/96

Conditions of approval, if any:

Title 18 U.S.C. Section 1001, makes it a crime for any person knowingly and willfully to make to any department or agency of the United States any false, fictitious or fraudulent statements or representations as to any matter within its jurisdiction.

*See Instruction on Reverse Side

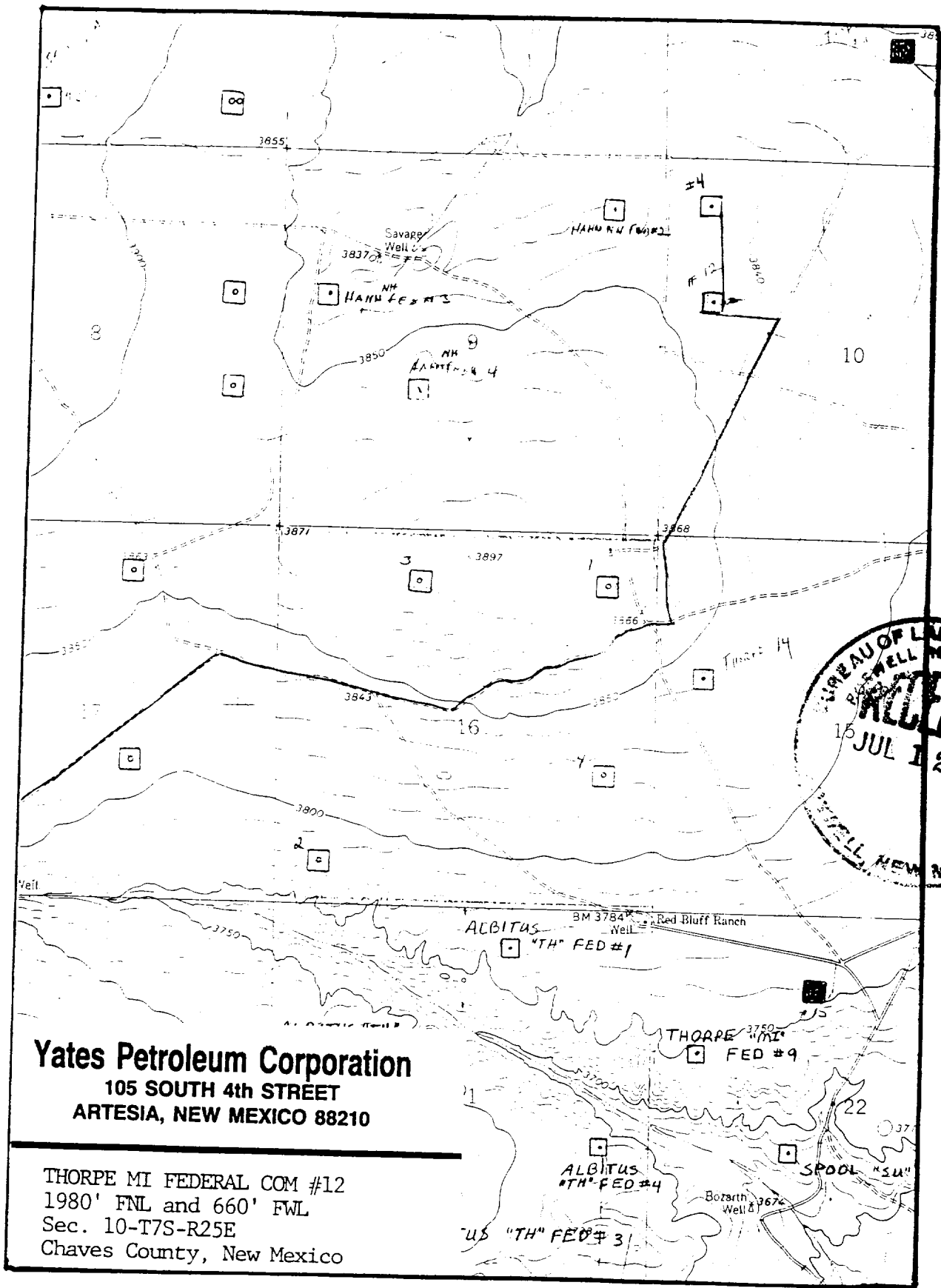

Yates Petroleum Corporation
 105 SOUTH 4th STREET
 ARTESIA, NEW MEXICO 88210

THORPE MI FEDERAL COM #12
 1980' FNL and 660' FWL
 Sec. 10-T7S-R25E
 Chaves County, New Mexico