

NEW MEXICO
OIL CONSERVATION COMMISSION

Form C-128

Well Location and/or Gas Proration Plat

Date April 16, 1957

Operator Intex Oil Company Lease Featherstone-Federal

Well No. 1 Section 25 Township 15S Range 28E NMPM

Located 1980 Feet From North Line, 1980 Feet From East Line,

Chaves County, New Mexico. G. L. Elevation 3598'

Name of Producing Formation _____ Pool wildcat Dedicated Acreage 40

(Note: All distances must be from outer boundaries of Section)

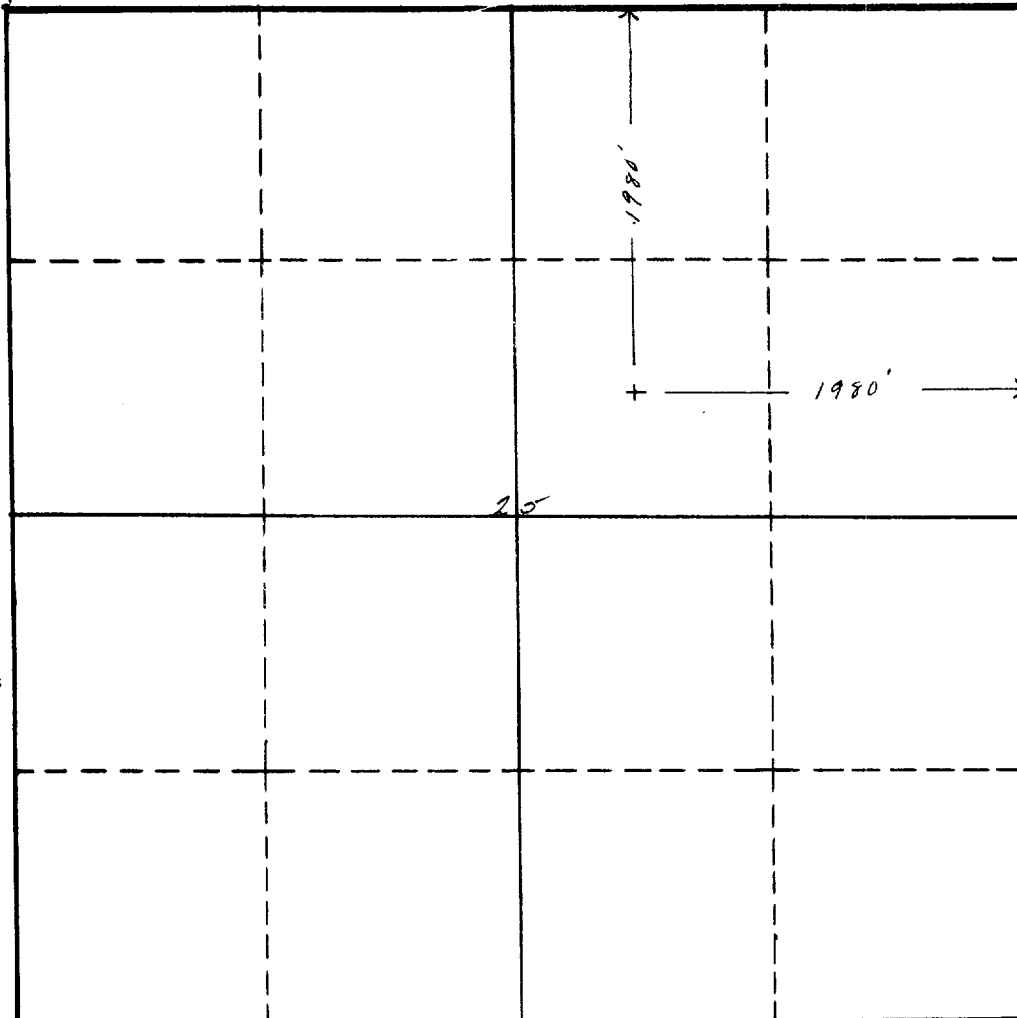

NOTE

This section of
form is to be
used for gas
wells only.



SCALE: 1"=1000'

1. Is this Well a Dual Comp. ? Yes ___ No ___.
2. If the answer to Question 1 is yes, are there any other dually completed wells within the dedicated acreage? Yes ___ No ___.

Name _____
Position _____
Representing _____
Address _____

This is to certify that the above plat was prepared from field notes of actual surveys made by me or under my supervision and that the same are true and correct to the best of my knowledge and belief.

Date Surveyed April 16, 1957

W. P. Shearer
Registered Professional Engineer and/or
Land Surveyor