

UNITED STATES
DEPARTMENT OF THE INTERIOR
GEOLOGICAL SURVEY

APPLICATION FOR PERMIT TO DRILL, DEEPEN, OR PLUG BACK

1a. TYPE OF WORK

DRILL ☐DEEPEN ☐PLUG BACK ☐

b. TYPE OF WELL

OIL

WELL ☒

GAS

WELL ☐OTHER Re-enter ☐

2. NAME OF OPERATOR

McClellan Oil Corporation

3. ADDRESS OF OPERATOR

P.O. Drawer 730, Roswell, NM 88202

4. LOCATION OF WELL (Report location clearly and in accordance with any State requirements.)

At surface

686' FSL & 1995' FWL *

At proposed prod. zone

* Resurveyed loc. - Actual Footage

14. DISTANCE IN MILES AND DIRECTION FROM NEAREST TOWN OR POST OFFICE*

14 miles north of Loco Hills, NM

15. DISTANCE FROM PROPOSED*

LOCATION TO NEAREST

PROPERTY OR LEASE LINE, FT.

(Also to nearest drlg. unit line, if any)

686'

18. DISTANCE FROM PROPOSED LOCATION*

TO NEAREST WELL, DRILLING, COMPLETED,
OR APPLIED FOR, ON THIS LEASE, FT.

NA

21. ELEVATIONS (Show whether DF, RT, GR, etc.)

3811' G.L.

23.

PROPOSED CASING AND CEMENTING PROGRAM

SIZE OF HOLE	SIZE OF CASING	WEIGHT PER FOOT	SETTING DEPTH	QUANTITY OF CEMENT
17-1/2"	13-3/8"	54 lbs.	342'	125 sx (In Hole)
12-1/4"	8-5/8"	24 lbs.	3303'	In Hole - No cmt. record
* 7-7/8"	4-1/2"	10.5 lbs.	3500'	350 sx

Propose to re-enter this well in order to test the Queen and San Andres formations. If production is indicated, will attempt completion in the 8-5/8" casing.

*If the 8-5/8" is not present, will run 4-1/2" casing.

Former: E. J. McCurdy
Mullis #1
P&H 10-11-56
OTD-12,153

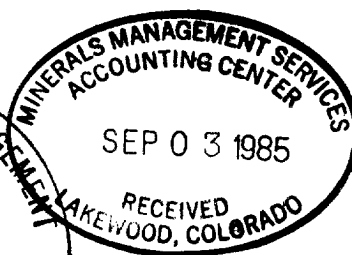
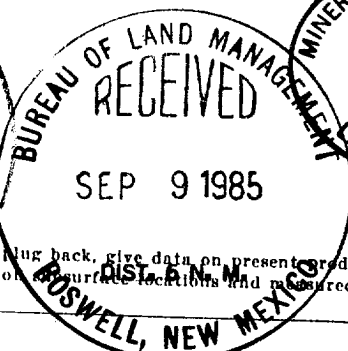
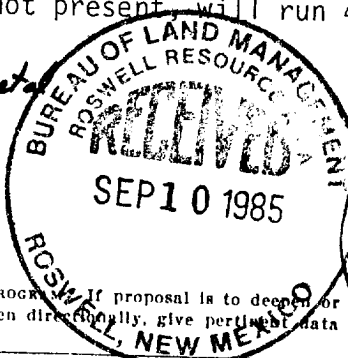

IN ABOVE SPACE DESCRIBE PROPOSED PROGRAM. If proposal is to deepen or plug back, give data on present productive zone and proposed new productive zone. If proposal is to drill or deepen directionally, give pertinent data on accurate locations and measured and true vertical depths. Give blowout preventer program, if any.

SIGNED

Mark McClellan

TITLE

Geologist

DATE

8/29/85

(This space for Federal or State office use)

PERMIT NO.

APPROVAL DATE

APPROVED BY

S/Phil Kirk

Area Manager

CONDITIONS OF APPROVAL, IF ANY:

TITLE

DATE

9-18-85

All distances must be from the outer boundaries of the Section.

Operator McClellan Oil Corp.			Lease MOC Mullis Federal			Well No. #1
Uplift Letter N	Section 21	Township 15 South	Range 29 East	County Chaves		
Actual Postage Location of Well						
1995	feet from the	West	line and	686	feet from the	South
Ground Level Elev. 3811'	Producing Formation San Andres		Pool Wildcat		Dedicated Acreage 40	

1. Outline the acreage dedicated to the subject well by colored pencil or hachure marks on the plat below.
2. If more than one lease is dedicated to the well, outline each and identify the ownership thereof (both as to working interest and royalty).
3. If more than one lease of different ownership is dedicated to the well, have the interests of all owners been consolidated by communitization, unitization, force-pooling, etc?

☐ Yes ☐ No If answer is "yes," type of consolidation _____

If answer is "no," list the owners and tract descriptions which have actually been consolidated. (Use reverse side of this form if necessary.) _____

No allowable will be assigned to the well until all interests have been consolidated (by communitization, unitization, force-pooling, or otherwise) or until a non-standard unit, eliminating such interests, has been approved by the Division

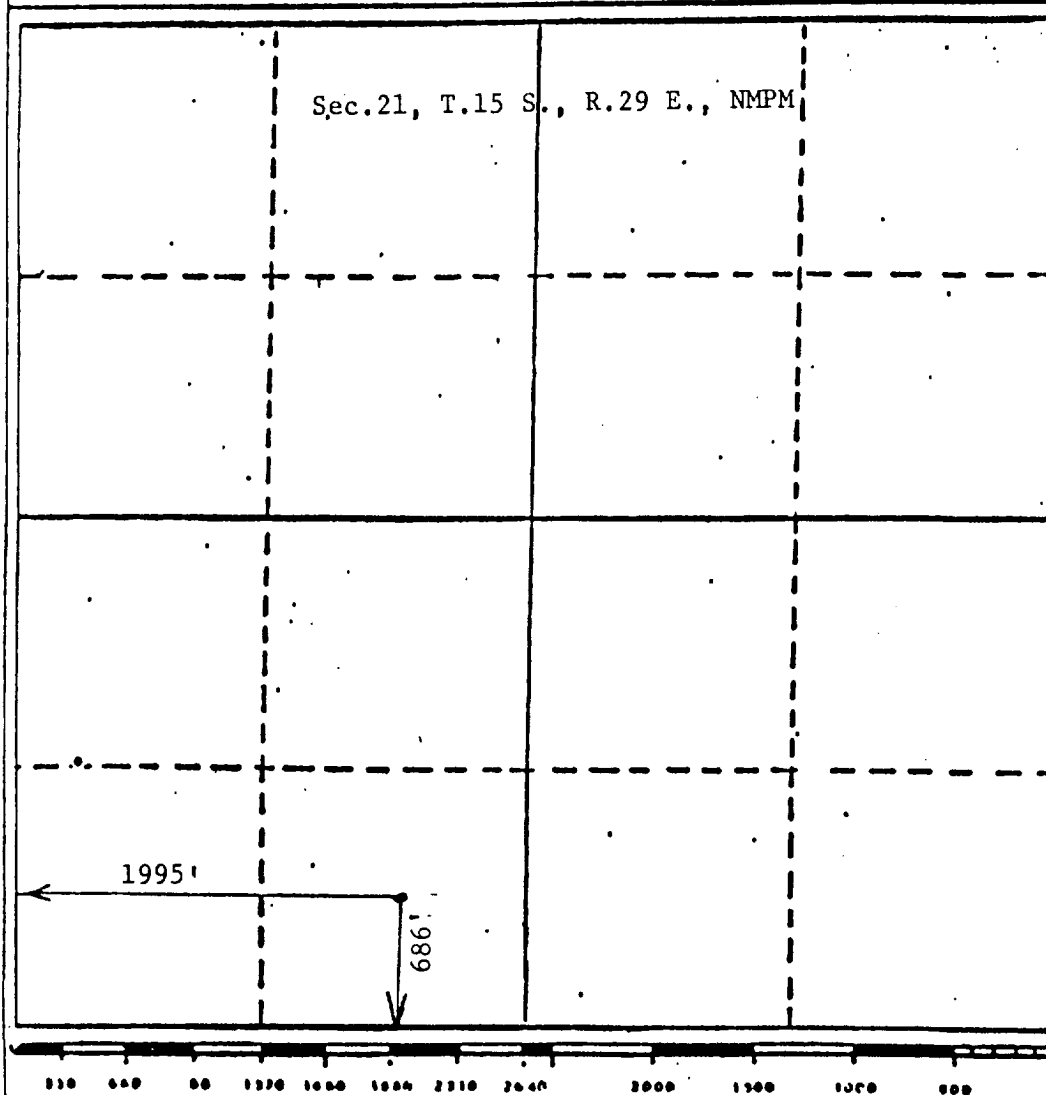

CERTIFICATION

I hereby certify that the information contained herein is true and complete to the best of my knowledge and belief.

Mark McClellan

Name

Mark McClellan

Position

Geologist

Company

McClellan Oil Corp.

Date

8/29/85

I hereby certify that the well location shown on this plat was plotted from field notes of actual surveys made by me or under my supervision, and that the same is true and correct to the best of my knowledge and belief.

Date Surveyed

August 28, 1985

Registered Professional Engineer and/or Land Surveyor

John D. Sanders, P.E. & L.S.

Certification No. 6290 PROFESSIONAL ENGINEER

McClellan Oil Corp.

REQUIREMENTS
(NTL-6)

1. Location: 686' FSL & 1995' FWL of Sec. 21-T15S-R29E
2. Elevation: 3811' G.L.
3. Geologic name of surface formation: Recent
4. Type of drilling rig and associated equipment: Cable Tool Drilling Rig
5. Proposed drilling depth and objective formation: 3500', San Andres
6. Estimated tops of geologic markers:

Yates	<u>945'</u>	San Andres	<u>2365'</u>	Abo	<u> </u>
7-Rivers	<u>1483'</u>	Glorieta	<u> </u>	Wolfcamp	<u> </u>
Queen	<u>1680'</u>	Tubb	<u> </u>		
7. Estimated depths of any oil, water, or gas: Possible gas @ 1680'.
Possible oil @ 3030'.
- 8-9. Proposed casing program:

<u>13-3/8"</u>	@	<u>342'</u>	Grade	<u>J-55</u>	Wt.	<u>54 lb.</u>	Type Cement	<u>In Hole</u>
<u>8-5/8"</u>	@	<u>3303'</u>	Grade	<u>J-55</u>	Wt.	<u>24 lb.</u>	Type Cement	<u>In Hole-No cmt</u>
								<u>rcd.</u>
* <u>4-1/2"</u>	@	<u>3500'</u>	Grade	<u>J-55</u>	Wt.	<u>10.5 lb.</u>	Type Cement	<u>Class "C"</u>
10. Specifications for pressure control equipment and testing procedures:
Cable Tool Control Head
11. Type and characteristics of drilling fluids: Natural mud used by adding fresh water as well is being drilled.
12. Testing, logging, and coring programs: No coring is anticipated.
Natural tests will be taken as a result of cable tool operations. Will run Gamma Ray-Neutron Log.
13. Anticipated abnormal pressures or temperature: None anticipated
14. Anticipated commencement and completion date:
9/10/85

* If the 8-5/8" casing is not present, will run 4-1/2" casing.

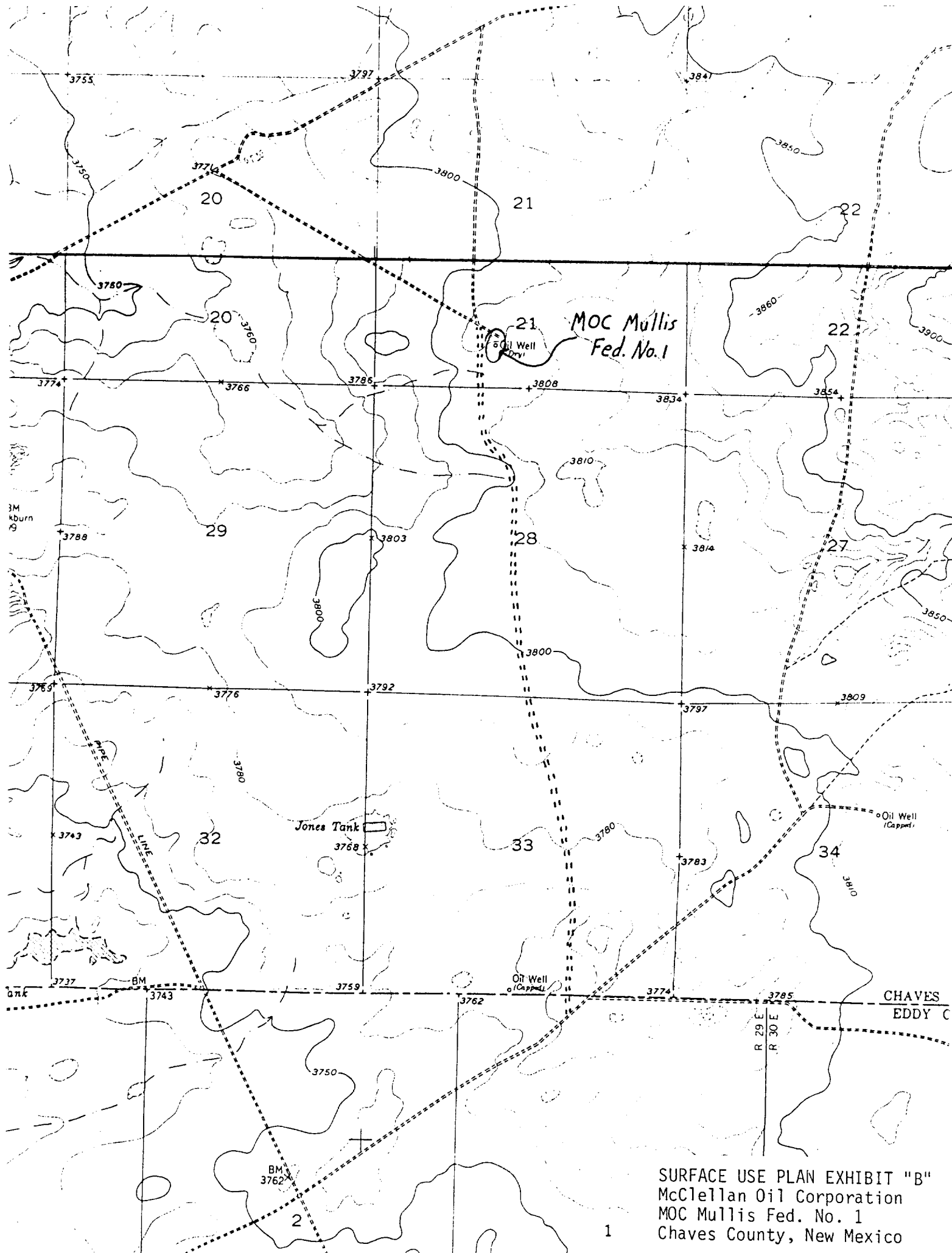

SURFACE USE PLAN EXHIBIT "B"
McClellan Oil Corporation
MOC Mullis Fed. No. 1
Chaves County, New Mexico



McClellan Oil Corporation
Box 848
Roswell, New Mexico 88201

WELL MOC Mullis Fed No. 1
LOCATION SE, SW of Sec 21 Σ
T155-R29E, Chaves Co. \uparrow

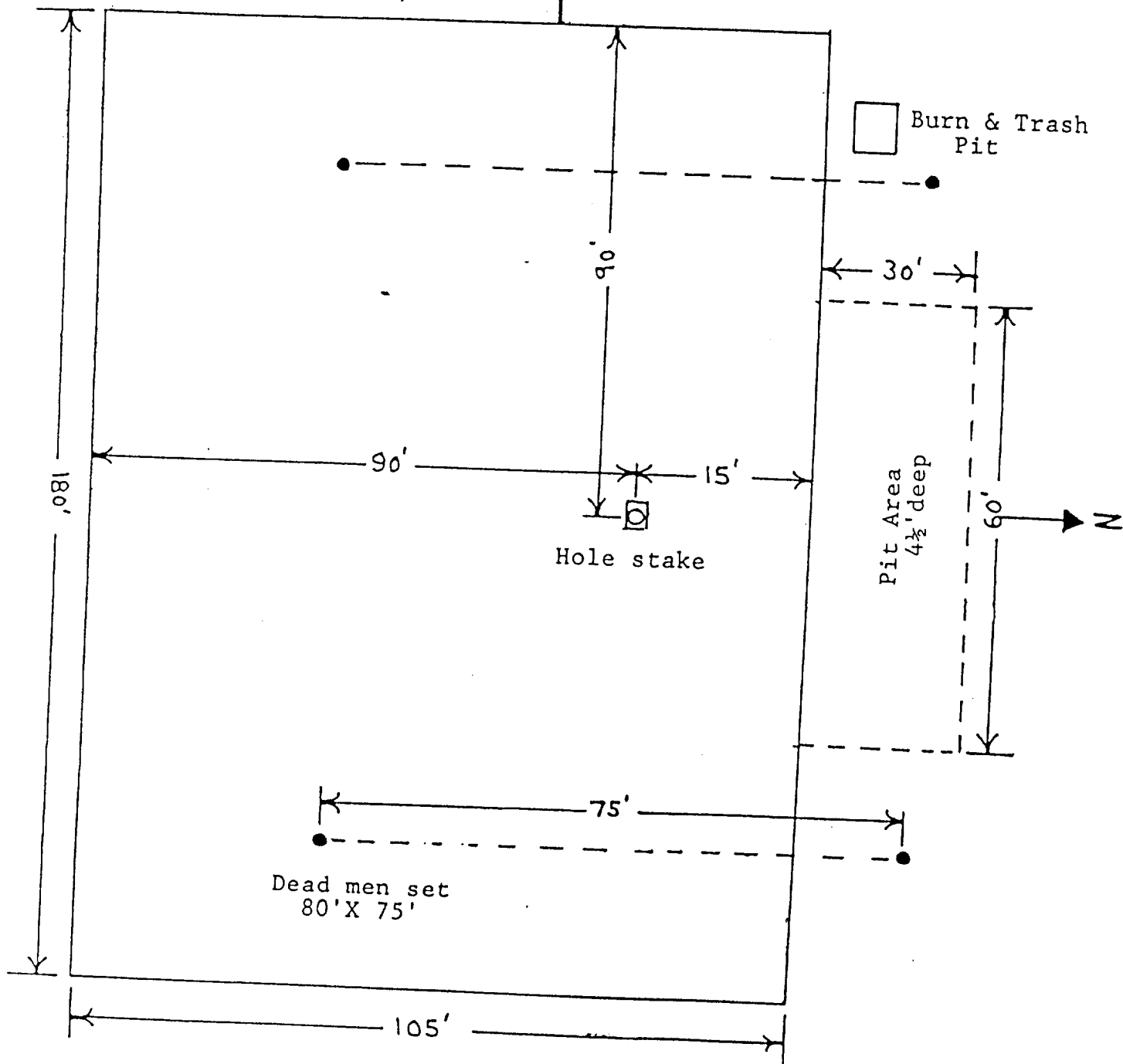

CABLE TOOL LOCATION PLAT

SURFACE USE PLAN EXHIBIT "D"
McClellan Oil Corporation
MOC Mullis Fed. No. 1
Chaves County, New Mexico