

UNITED STATES  
DEPARTMENT OF THE INTERIOR  
GEOLOGICAL SURVEY

APPLICATION FOR PERMIT TO DRILL, DEEPEN, OR PLUG BACK

1a. TYPE OF WORK

DRILL ☐ *Re-entry* DEEPEN ☐ PLUG BACK ☒

5. LEASE DESIGNATION AND SERIAL NO.

NM-4434

6. IF INDIAN, ALLOTTEE OR TRIBE NAME

7. UNIT AGREEMENT NAME

8. FARM OR LEASE NAME

Christine Federal

9. WELL NO.

2

10. FIELD AND POOL, OR WILDCAT

Round Tank, Queen

11. SEC., T., R., M., OR BLK. AND SURVEY OR AREA

30-15S-29E

12. COUNTY OR PARISH

Chaves

13. STATE

N.M.

1b. TYPE OF WELL

OIL WELL ☒

GAS WELL ☐

OTHER ☐

SINGLE ZONE ☒

MULTIPLE ZONE ☐

2. NAME OF OPERATOR

ELK OIL COMPANY

3. ADDRESS OF OPERATOR

BOX 310, ROSWELL, NEW MEXICO 88201

4. LOCATION OF WELL (Report location clearly and in accordance with any State requirements.)\*

At surface

660' from North 1980' from East Sec 30-15S-29E

At proposed prod. zone

660' from North 1980' from East Sec 30-15S-29E

14. DISTANCE IN MILES AND DIRECTION FROM NEAREST TOWN OR POST OFFICE

15. DISTANCE FROM PROPOSED\*

LOCATION TO NEAREST PROPERTY OR LEASE LINE, FT. (Also to nearest drlg. unit line, if any)

660 feet

16. NO. OF ACRES IN LEASE

281.29

18. DISTANCE FROM PROPOSED LOCATION\* TO NEAREST WELL, DRILLING, COMPLETED, OR APPLIED FOR, ON THIS LEASE, FT.

19. PROPOSED DEPTH

1600

21. ELEVATIONS (Show whether DF, RT, GR, etc.)

3738 Ground

23.

PROPOSED CASING AND CEMENTING PROGRAM

SIZE OF HOLE	SIZE OF CASING	WEIGHT PER FOOT	SETTING DEPTH	QUANTITY OF CEMENT
11	8 5/8	24	322	150
7 7/8	4 1/2	10.7	1600	150

Well was originally drilled by Max Pray as Pray Federal #1 to a total depth of 3115'.

Well was plugged by M.C. Sandy with 4 1/2" casing shot off at 1100' and 8 5/8" casing left in hole at 322 ft. We propose to re-enter and drill out to 1600 ft., set 4 1/2" casing with 150 sack cement, then perforate Queen Zone from 1520 to 1535 feet and complete as an oil well.

RECEIVED

JUN 16 1975

RECEIVED

JUN 13 1975

IN ABOVE SPACE DESCRIBE PROPOSED PROGRAM: If proposal is to deepen or plug back, give data on present productive zone and proposed new productive zone. If proposal is to drill or deepen directionally, give pertinent data on subsurface conditions and measured and true vertical depths. Give blowout preventer program, if any.

24.

SIGNED

TITLE

President

DATE

6/12/75

(This space for Federal or State office use)

PERMIT NO.

APPROVED BY

CONDITIONS OF APPROVAL, IF ANY:

JUN 12 1975

ACTING DISTRICT ENGINEER

APPROVAL IS EXTENDED IF OPERATIONS ARE COMMENCED WITHIN 3 MONTHS. EXPIRES SEP 13 1975

\*See Instructions On Reverse Side

## Instructions

**General:** This form is designed for submitting proposals to perform certain well operations, as indicated, on all types of lands and leases for appropriate action by either a Federal or a State agency, or both, pursuant to applicable Federal and/or State laws and regulations. Any necessary special instructions concerning the use of this form and the number of copies to be submitted, particularly with regard to local, area, or regional procedures and practices, either are shown below or will be issued by, or may be obtained from, the local Federal and/or State office.

**Item 1:** If the proposal is to redrill to the same reservoir at a different subsurface location or to a new reservoir, use this form with appropriate notations. Consult applicable State or Federal regulations concerning subsequent work proposals or reports on the well.

**Item 4:** If there are no applicable State requirements, locations on Federal or Indian land should be described in accordance with Federal requirements. Consult local State or Federal office for specific instructions.

**Item 14:** Needed only when location of well cannot readily be found by road from the land or lease description. A plat, or plats, separate or on this reverse side, showing the roads to, and the surveyed location of, the well, and any other required information, should be furnished when required by Federal or State agency offices.

**Items 15 and 18:** If well is to be, or has been directionally drilled, give distances for subsurface location of hole in any present or objective production zone.

**Item 22:** Consult applicable Federal or State regulations, or appropriate officials, concerning approval of the proposal before operations are started.

NEW MEXICO OIL CONSERVATION COMMISSION  
WELL LOCATION AND ACREAGE DEDICATION PLAT

Form C-102  
Supersedes C-128  
Effective 1-1-65

All distances must be from the outer boundaries of the Section.

Operator <b>ELK OIL COMPANY</b>			Lease <b>EXISTING FEDERAL</b>		Well No. <b>2</b>
Unit Letter <b>D</b>	Section <b>30</b>	Township <b>15E</b>	Range <b>29E</b>	County <b>CLAY</b>	
Actual Footage Location of Well: <b>660</b> feet from the <b>North</b> line of <b>1940</b> feet from the <b>East</b> line					
Ground Level Elev. <b>3736</b>	Producing Formation <b>Queen</b>		Pool <b>Round Tank</b>		Dedicated Acreage: <b>40</b> Acres

1. Outline the acreage dedicated to the subject well by colored pencil or hachure marks on the plat below.
2. If more than one lease is dedicated to the well, outline each and identify the ownership thereof (both as to working interest and royalty).
3. If more than one lease of different ownership is dedicated to the well, have the interests of all owners been consolidated by communitization, unitization, force-pooling, etc?

☐ Yes ☒ No If answer is "yes," type of consolidation \_\_\_\_\_

If answer is "no," list the owners and tract descriptions which have actually been consolidated. (Use reverse side of this form if necessary.) \_\_\_\_\_

No allowable will be assigned to the well until all interests have been consolidated (by communitization, unitization, forced-pooling, or otherwise) or until a non-standard unit, eliminating such interests, has been approved by the Commission.

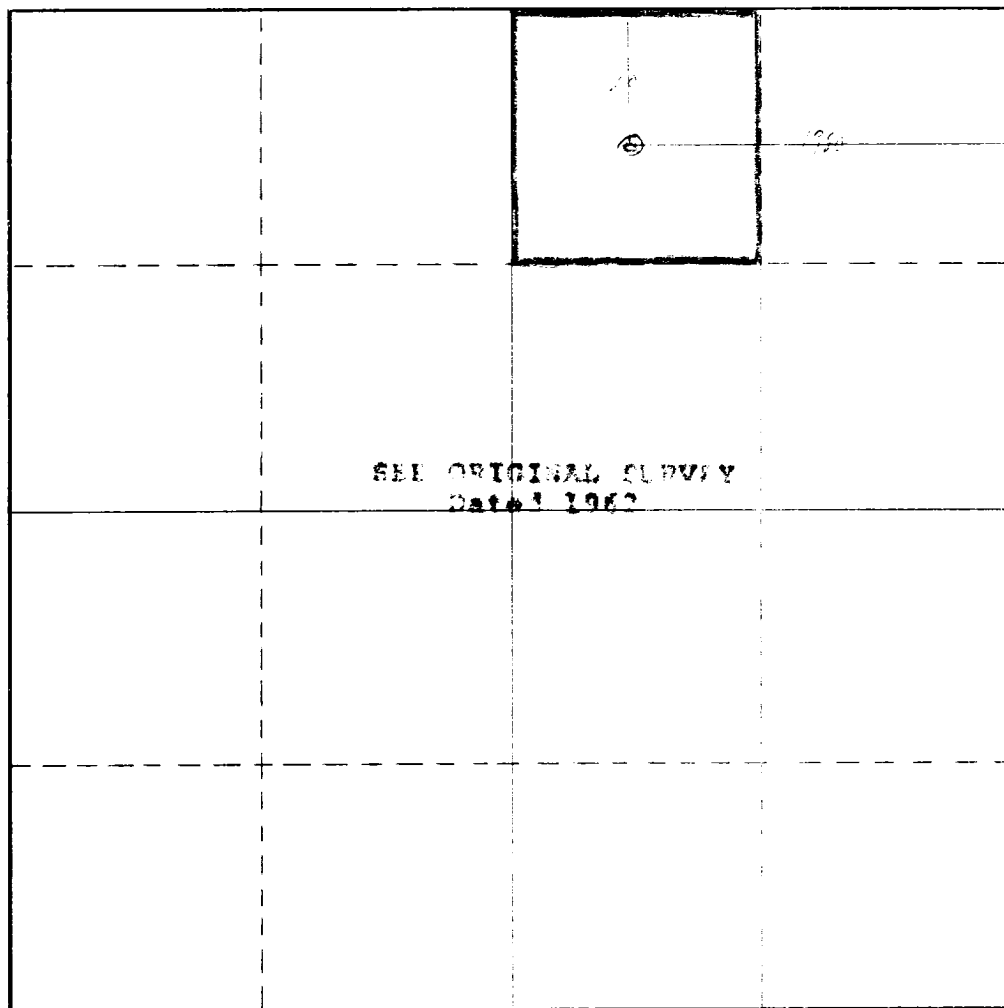

CERTIFICATION

I hereby certify that the information contained herein is true and complete to the best of my knowledge and belief.

Name **Joseph J. Kelly**

Position **President**

Company **ELK Oil Company**

Date **6/12/75**

I hereby certify that the well location shown on this plat was plotted from field notes of actual surveys made by me or under my supervision, and that the same is true and correct to the best of my knowledge and belief.

Date Surveyed \_\_\_\_\_

Registered Professional Engineer and/or Land Surveyor

Certificate No. \_\_\_\_\_

