

Form 9-331a  
(Feb. 1951)

Budget Bureau No. 42-R358.4.  
Form Approved.

(SUBMIT IN TRIPLICATE)

UNITED STATES  
DEPARTMENT OF THE INTERIOR  
GEOLOGICAL SURVEY

Land Office New Mexico  
Lease No. NM 051623  
Unit I

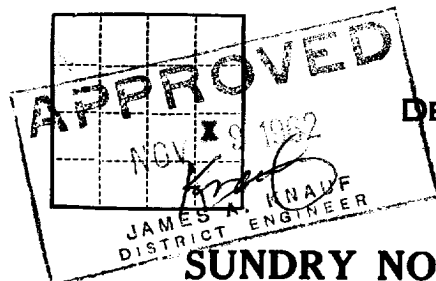

SUNDRY NOTICES AND REPORTS ON WELLS

NOTICE OF INTENTION TO DRILL	<input checked="" type="checkbox"/>	SUBSEQUENT REPORT OF WATER SHUT-OFF	
NOTICE OF INTENTION TO CHANGE PLANS		SUBSEQUENT REPORT OF SHOOTING OR ACIDIZING	
NOTICE OF INTENTION TO TEST WATER SHUT-OFF		SUBSEQUENT REPORT OF ALTERING CASING	
NOTICE OF INTENTION TO RE-DRILL OR REPAIR WELL		SUBSEQUENT REPORT OF RE-DRILLING OR REPAIR	
NOTICE OF INTENTION TO SHOOT OR ACIDIZE		SUBSEQUENT REPORT OF ABANDONMENT	
NOTICE OF INTENTION TO PULL OR ALTER CASING		SUPPLEMENTARY WELL HISTORY	
NOTICE OF INTENTION TO ABANDON WELL			

(INDICATE ABOVE BY CHECK MARK NATURE OF REPORT, NOTICE, OR OTHER DATA)

November 8, 1962

USA-Mohuriz NM 051623

Well No. 2 is located 1980 ft. from S line and 660 ft. from E line of sec. 24

NE/4 SE/4 Sec. 24

15-S

28-E

NMPM

(1/4 Sec. and Sec. No.)

(Twp.)

(Range)

(Meridian)

Undesignated

Chaves

New Mexico

(Field)

(County or Subdivision)

(State or Territory)

The elevation of ground level above sea level is 3710 ft. Est.

DETAILS OF WORK

(State names of and expected depths to objective sands; show sizes, weights, and lengths of proposed casings; indicate mudding jobs, cementing points, and all other important proposed work)

See Prognosis and Plate attached.

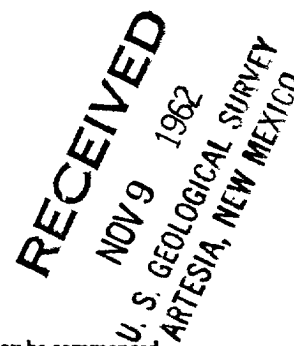

I understand that this plan of work must receive approval in writing by the Geological Survey before operations may be commenced.

Company Tenneco Corporation by its Managing Agent Tenneco Oil Company

Address Box 307

Hobbs, New Mexico

By A.W. Lang

Title District Production Superintendent

TENNECO OIL COMPANY  
PROGNOSIS TO DRILL AND COMPLETE

Area No 051623

Well No.: 2

Field: Round Tank-San Andres

Lease: 60' FEL & 660' FEL, Sec. 24, T-15-S, R-28-E, Chaves County, New Mexico

Horizon: San Andres

Estimated TD: 3150'

Estimated Elevation: 3710'

Drilling, Casing, and Cement:

1. Drill 12 $\frac{1}{4}$ " hole to 300'.
2. Set 8 5/8", 24#, J-55 csg @ approx 300' w/insert float collar in top of shoe joint. Place a cement basket on casing above lost circulation zone. Cmt w/200 sx of Incor High Early Portland cmt containing 2% HA-5. If cmt does not circulate, spot cmt around csg at the surface. Slurry wt should be 14.85#/gal. Pumping time is 1 hr 12 mins. Record the following data:
  - A. Volume of cmt slurry (cubic ft).
  - B. Brand name of cmt and additives, percent additives used, and sequence of placement.
  - C. Approx temp of cmt slurry when mixed.
  - D. Actual time cmt in place prior to testing csg.
3. If float valve holds, release pressure after WOC 4 hrs, nipple up and displace wtr w/air.
4. WOC a total of 8 hrs and pressure test csg w/1000 psi for 30 mins and drill out cmt.

NOTE: The weight on the bit should not exceed 20,000#, and rotary speed should not exceed 60 rpm until top of DC is below base of the csg.
5. Drill 7 7/8" hole to approx 3150'. Exact TD will be determined by wellsite Exploitation Engineer.
6. Load hole w/brine wtr.
7. Set 5 1/2", 17#, J-55 csg @ TD. Use an insert float collar and float shoe in string. Cmt w/150 sx of 50-50 Pozmix "S" w/2% gel (slurry wt 15#/gal); and 50 sx reg cmt containing latex (slurry wt 14.5#/gal to 15.1#/gal). Spot a 75 sk plug across Queen Sand using a wtr spacer.

NOTE: Prior to laying down drill pipe, add two sx of sodium bichromate to mud system and circulate.
8. If float valve holds, release rig when top plug is down.
9. WOC 8 hrs and run temp survey.
10. After WOC 18 hrs, RUDDU, run tbg, displace wtr w/oil and pressure test csg w/1500 psi for 30 mins.

Drilling Fluid:

1. Drill surface hole w/aerated wtr.
2. Drill w/air from base of surface pipe to TD

RECEIVED  
NOV 1963  
TENNOCO OIL COMPANY

Drilling Time:

1. Record 1' drlg time from surface to TD w/a geolograph or equivalent recorder.

Drill Pipe Measurements:

1. Tally DP on last trip prior to reaching TD.
2. Tally DP under company supervision at all csg points and at TD.

Samples:

1. Catch 10' samples from 1000' to TD, or as specified by company Exploitation Engineer. Label and tie in bundles of 100'.

Blowout Preventer:

1. Double ram w/manual and remote hydraulic or air controls are required. BOP will be tested daily.
2. A rotating pack off head is required while drlg w/air.

Hole Deviation:

1. Run slope test every 100' on surface hole. Max allowable deviation in surface hole is 1 1/2 degrees.
2. Run slope test every 500' from base of surface to TD.
3. If hole deviation changes more than 1 1/2 degrees in any 100' interval, a string reamer will be run to wipe out dog leg.
4. If hole deviation changes more than 2 degrees in any 100' interval, the hole will be plugged back and straightened.
5. Max allowable hole deviation from base of surface csg to TD is 4 degrees.

Surveys:

1. Run Gamma Ray Sonic w/detailed sections as required.
2. Run Laterolog as desired.
3. Run Gamma Ray Correlation Log for perforating control.

Completion:

1. To be determined at TD.

APPROVED:

C. W. Nance

APPROVED:

A. W. Lang

NEW MEXICO OIL CONSERVATION COMMISSION  
WELL LOCATION AND ACREAGE DEDICATION PLAT

FORM C-128  
Revised 5/1/57

SEE INSTRUCTIONS FOR COMPLETING THIS FORM ON THE REVERSE SIDE

SECTION A

Operator <b>TENNECO OIL COMPANY</b>		Lease <b>USA MEMURIN IN 051623</b>		Well No. <b>2</b>
Unit Letter <b>1</b>	Section <b>24</b>	Township <b>15 SOUTH</b>	Range <b>28 EAST</b>	County <b>CHAVES</b>
Actual Footage Location of Well: <b>1980</b> feet from the <b>SOUTH</b> line and <b>660</b> feet from the <b>EAST</b> line				
Ground Level Elev. <b>3720 Hgt.</b>	Producing Formation <b>San Andres</b>	Pool <b>Undesignated</b>	Dedicated Acreage: <b>40</b> Acres	

1. Is the Operator the only owner in the dedicated acreage outlined on the plat below? YES ☒ NO \_\_\_\_ ("Owner" means the person who has the right to drill into and to produce from any pool and to appropriate the production either for himself or for himself and another. (65-3-29 (e) NMSA 1935 Comp.)
2. If the answer to question one is "no," have the interests of all the owners been consolidated by communitization agreement or otherwise? YES \_\_\_\_ NO \_\_\_\_ . If answer is "yes," Type of Consolidation \_\_\_\_
3. If the answer to question two is "no," list all the owners and their respective interests below:

Owner	Land Description

SECTION B

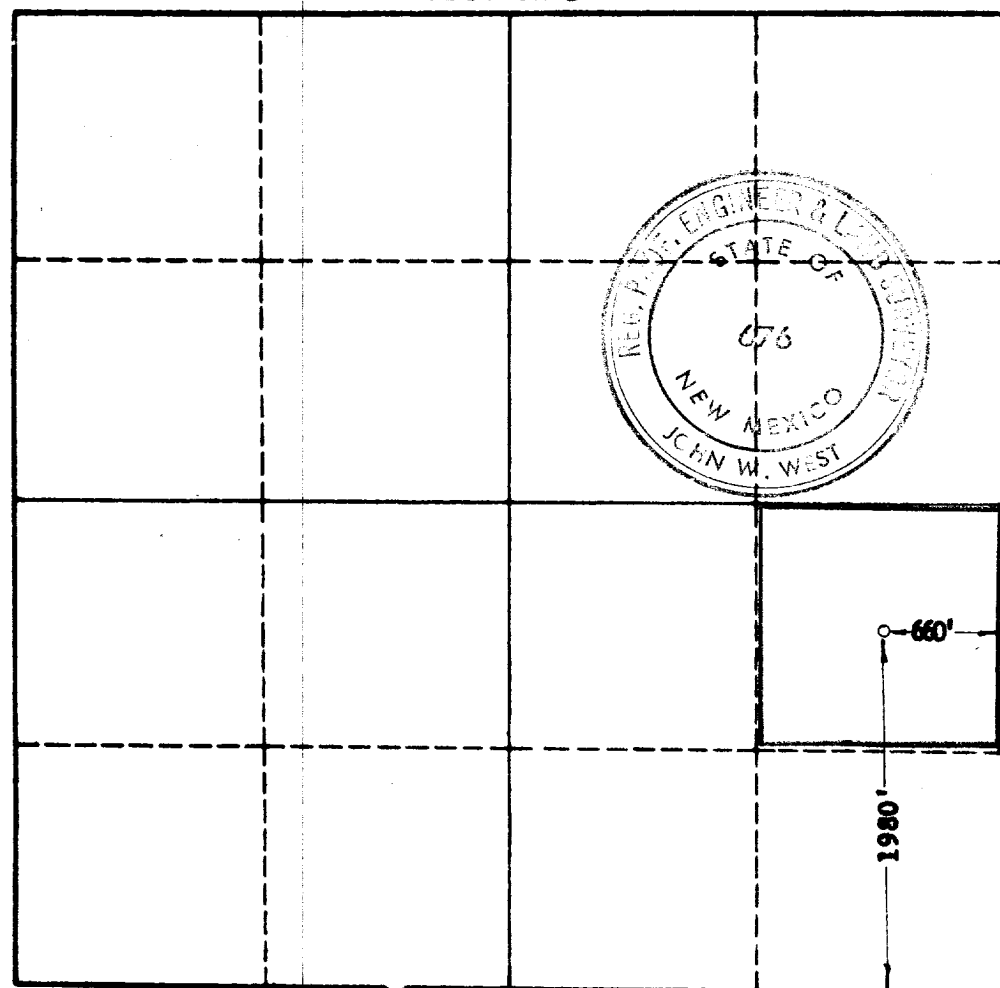

CERTIFICATION

I hereby certify that the information in SECTION A above is true and complete to the best of my knowledge and belief.

Name	<b>Al W. Lang A.W. Lang</b>
Position	<b>Dist. Prod. Superintendent</b>
Company	<b>Tenneco Oil Company</b>
Date	<b>November 5, 1962</b>

I hereby certify that the well location shown on the plat in SECTION B was plotted from field notes of actual surveys made by me or under my supervision, and that the same is true and correct to the best of my knowledge and belief.

Date Surveyed	<b>11-3-62</b>
Registered Professional Engineer and/or Land Surveyor, <b>JOHN W. WEST</b>	
<b>John W. West</b>	
Certificate No.	<b>N.M. - P.E. &amp; L.S. NO. 676</b>

0 330 660 990 1320 1650 1980 2310 2640 2000 1500 1000 500 0