

607026

Humble Lso. No. \_\_\_\_\_ NEW MEXICO OIL CONSERVATION COMMISSION  
State Lso. No. \_\_\_\_\_ WELL LOCATION AND ACREAGE DEDICATION PLATForm C-102  
Supersedes C-128  
Effective 1-1-65

Federal Lso. No. \_\_\_\_\_ All distances must be from the outer boundaries of the Section.

|  |                              |                                 |                                |                  |
|--|------------------------------|---------------------------------|--------------------------------|------------------|
| Operator<br>Humble Oil & Refining Co.  |                              | Lease<br>Florence B. Lusk       |                                | Well No.<br>4    |
| Unit Letter<br>F   | Section<br>6                 | Township<br>15 South            | Range<br>30 East               | County<br>Chaves |
| Actual Footage Location of Well:<br>2310 feet from the North line and 2265 feet from the West line |                              |                                 |                                |                  |
| Ground Level Elev.<br>Later  | Producing Formation<br>Queen | Pool<br>Double L Queen (Chaves) | Dedicated Acreage:<br>40 Acres |                  |

1. Outline the acreage dedicated to the subject well by colored pencil or hatchure marks on the plat below.
2. If more than one lease is dedicated to the well, outline each and identify the ownership thereof (both as to working interest and royalty).
3. If more than one lease of different ownership is dedicated to the well, have the interests of all owners been consolidated by communitization, unitization, force-pooling, etc?

☐ Yes ☐ No If answer is "yes," type of consolidation \_\_\_\_\_

If answer is "no," list the owners and tract descriptions which have actually been consolidated. (Use reverse side of this form if necessary.) \_\_\_\_\_

No allowable will be assigned to the well until all interests have been consolidated (by communitization, unitization, forced-pooling, or otherwise) or until a non-standard unit, eliminating such interests, has been approved by the Commission.

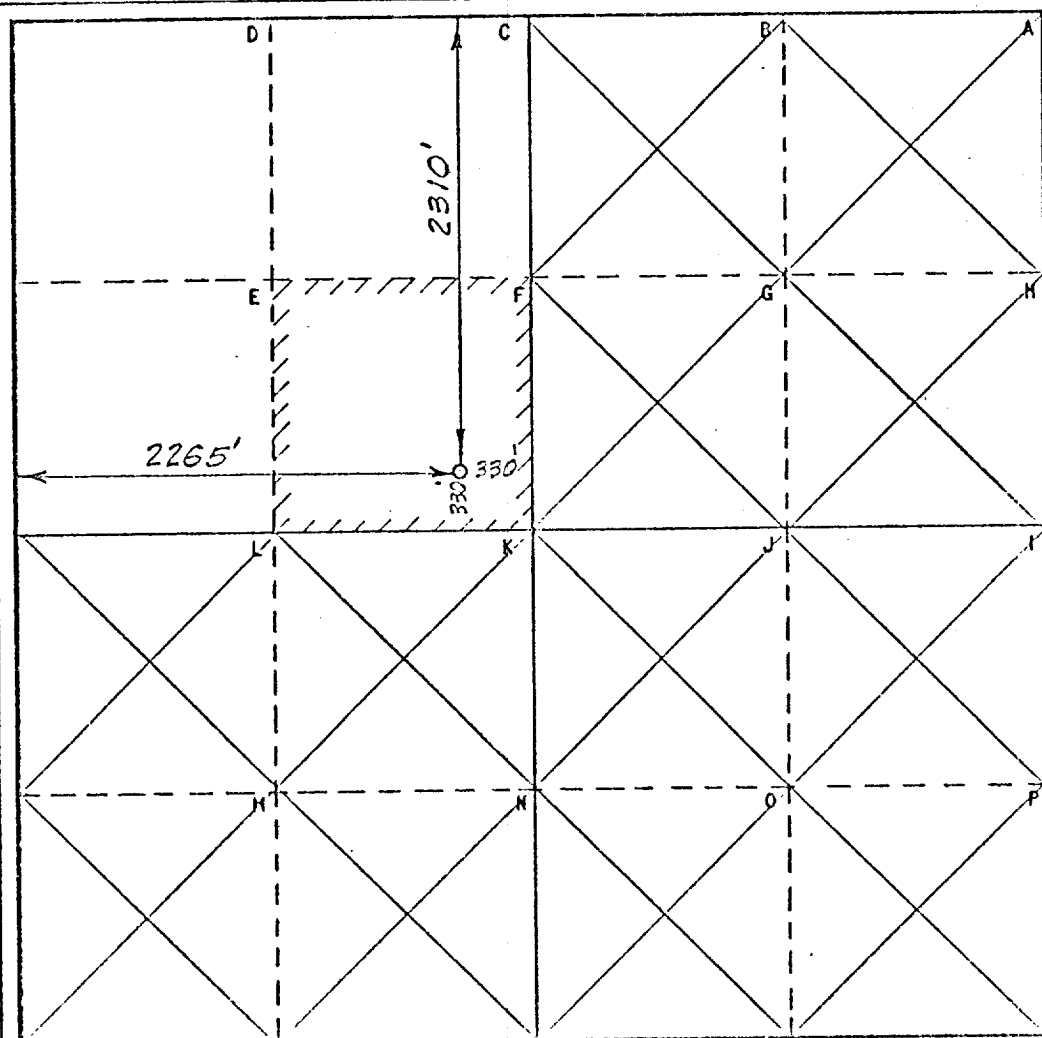

## CERTIFICATION

I hereby certify that the information contained herein is true and complete to the best of my knowledge and belief.

Name A. L. Clemmer  
Position Unit Head  
Company Humble Oil & Refining Co.  
Box 1600 Midland, Texas  
Date \_\_\_\_\_

I hereby certify that the well location shown on this plat was plotted from field notes of actual surveys made by me or under my supervision, and that the same is true and correct to the best of my knowledge and belief.

Date Surveyed April 28, 1970  
Registered Professional Engineer  
and/or Land Surveyor

A. S. Motterfield  
Certificate No. 1382