

607026

Humble Lso.No. _____ NEW MEXICO OIL CONSERVATION COMMISSION
State Lso.No. _____ WELL LOCATION AND ACREAGE DEDICATION PLAT
Federal Lso.No. _____

Form C-102
Supersedes C-128
Effective 1-1-65

CHANGE OPERATOR NAME FROM
HUMBLE OIL & REFINING COMPANY

TO EXXON CORPORATION
By: Florence B. Lusk

Well No.
4

Operator
Humble Oil & Refining Co.
Unit Letter
F
Section
6
Effective January 1, 1973
15 South
30 East
County
Chaves

Actual Footage Location of Well:

2310 feet from the North line and 2265 feet from the West line

Ground Level Elev.: Later
Producing Formation: Queen
Pool: Double L Queen (Chaves)
Dedicated Acreage: 40 Acres

1. Outline the acreage dedicated to the subject well by colored pencil or hachure marks on the plat below.
2. If more than one lease is dedicated to the well, outline each and identify the ownership thereof (both as to working interest and royalty).
3. If more than one lease of different ownership is dedicated to the well, have the interests of all owners been consolidated by communitization, unitization, force-pooling, etc?

☐ Yes ☐ No If answer is "yes," type of consolidation _____

If answer is "no," list the owners and tract descriptions which have actually been consolidated. (Use reverse side of this form if necessary.) _____

No allowable will be assigned to the well until all interests have been consolidated (by communitization, unitization, forced-pooling, or otherwise) or until a non-standard unit, eliminating such interests, has been approved by the Commission.

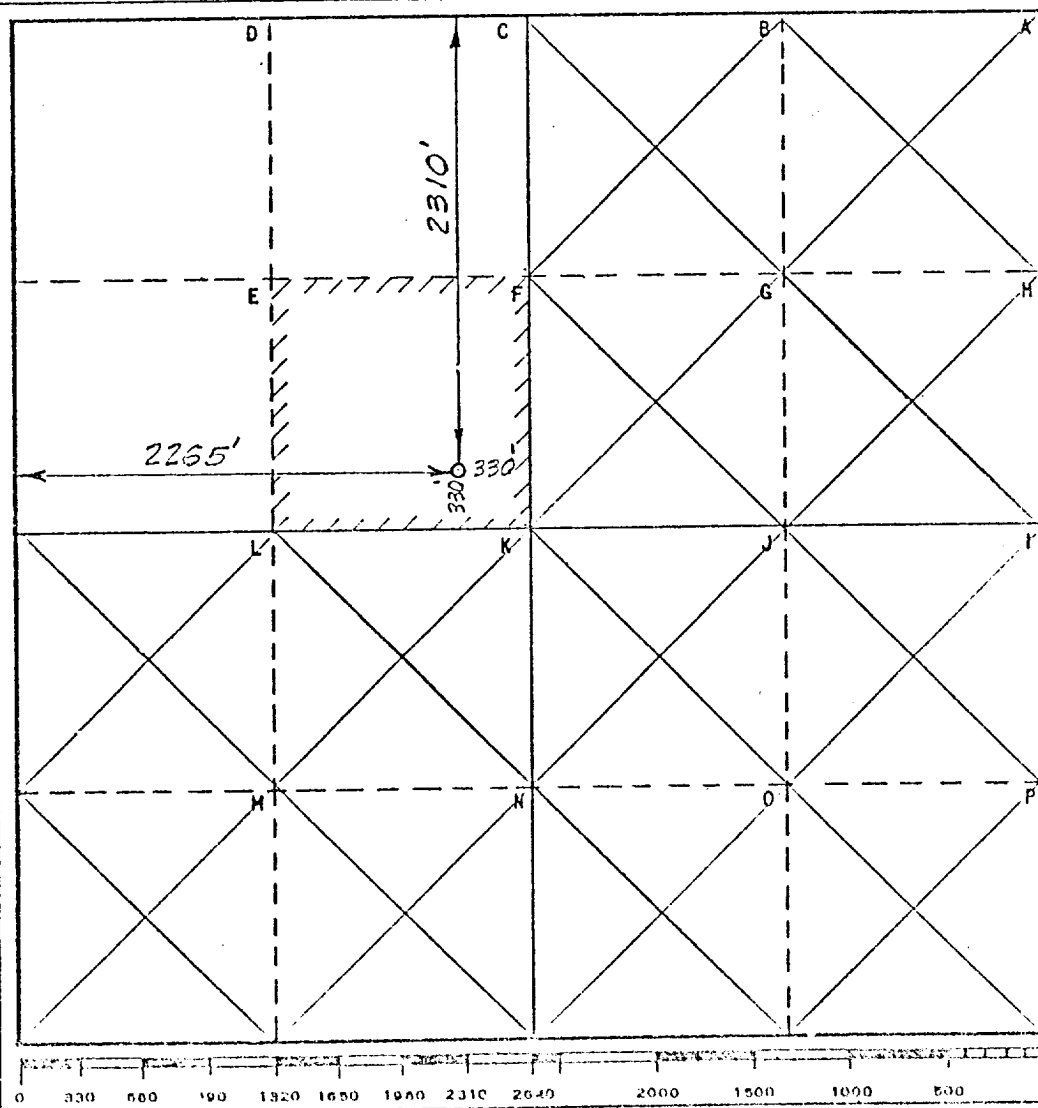

CERTIFICATION

I hereby certify that the information contained herein is true and complete to the best of my knowledge and belief.

Name: A. L. Clemmer
Position: Proration Specialist
Company: Humble Oil & Refining Co.
Box 1600 Midland, Texas
Date: 8-31-71

I hereby certify that the well location shown on this plat was plotted from field notes of actual surveys made by me or under my supervision, and that the same is true and correct to the best of my knowledge and belief.

Date Surveyed: April 28, 1970
Registered Professional Engineer and/or Land Surveyor

A. S. Hesterfeld
Certificate No. 1382