

All distances must be from the outer boundaries of the Section.

Operator Burk Royalty Co.		Lease Double "L" Queen Unit <i>Tr. 24</i>		Well No. 2405 <i>5</i>
Unit Letter F	Section 6	Township 15 South	Range 30 East	County Chaves
Actual Wellbore Location of Well 1710 feet from the West line and 1330 feet from the North line				
Ground Level Elev. 3877	Producing Formation Queen Sand	Pool Double "L" Queen Assoc.	Dedicated Acreage Waterflood <i>40</i> Acres	

1. Outline the acreage dedicated to the subject well by colored pencil or hatchure marks on the plot below.
2. If more than one lease is dedicated to the well, outline each and identify the ownership thereof (both as to working interest and royalty).
3. If more than one lease of different ownership is dedicated to the well, have the interests of all owners been consolidated by communitization, unitization, force-pooling, etc?

☐ Yes ☐ No If answer is "yes," type of consolidation _____

If answer is "no," list the owners and tract descriptions which have actually been consolidated. (Use reverse side of this form if necessary.) _____

No allowable will be assigned to the well until all interests have been consolidated (by communitization, unitization, forced-pooling, or otherwise) or until a non-standard unit, eliminating such interests, has been approved by the Division.

CERTIFICATION

I hereby certify that the information contained herein is true and complete to the best of my knowledge and belief.

Fred M. Lynch
Name

Fred M. Lynch

Position

Engineer

Company

Burk Royalty Co.

Date

September 17, 1984

I hereby certify that the well location shown on this plot was plotted from field notes of actual surveys made by me or under my supervision, and that the same is true and correct to the best of my knowledge and belief.

Date Surveyed

August 28, 1984

Registered Professional Engineer
and/or Land Surveyor

Fred M. Lynch
Fred M. Lynch, P.E. & L.S.

Certificate No.

6258

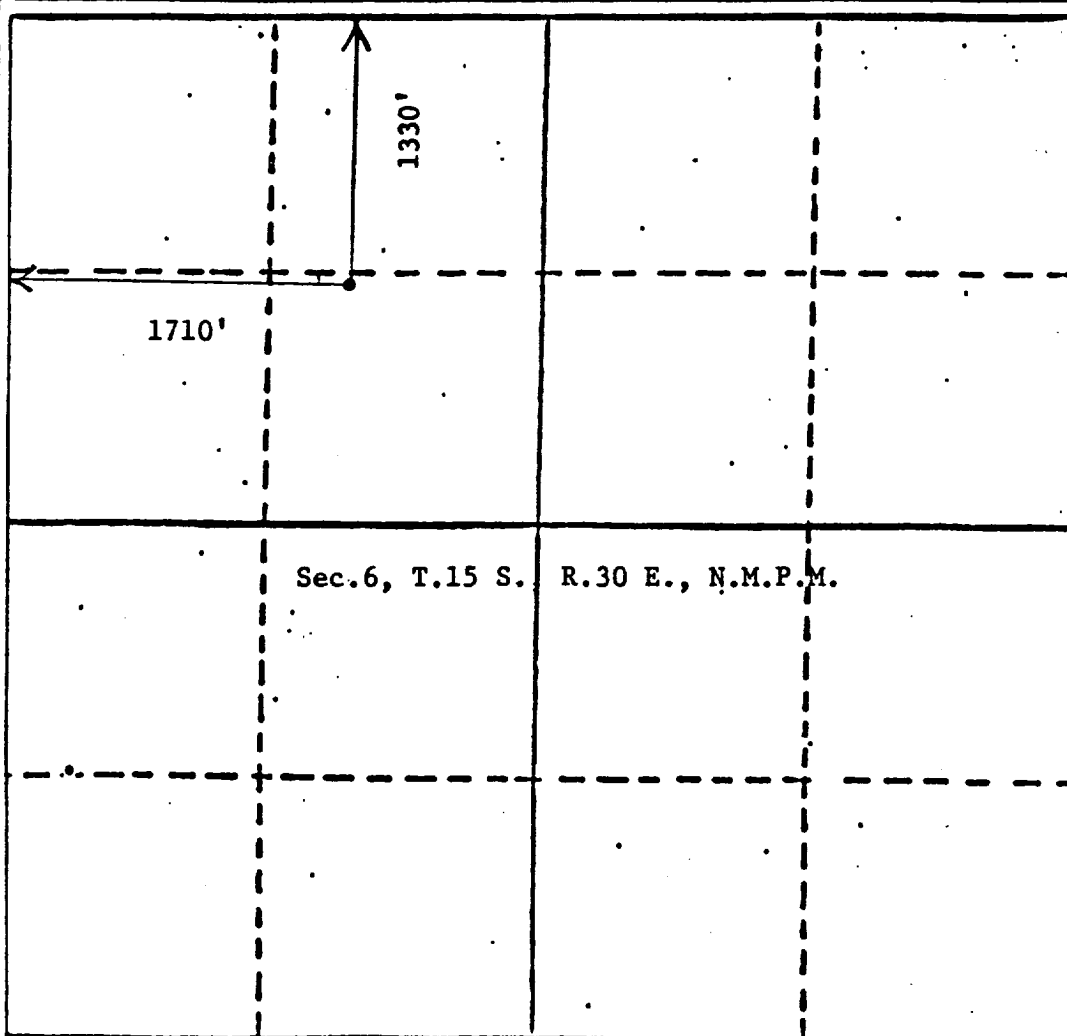

110 600 00 1270 1000 1000 2000 2000 1000 1000 000