

UNITED STATES
DEPARTMENT OF THE INTERIOR
GEOLOGICAL SURVEYCopy *ggs*30-005-60015
5. LEASE DESIGNATION AND SERIAL NO.
NM 0559078
6. IS INDIAN, ALLOTTEE OR TRIBE NAME

APPLICATION FOR PERMIT TO DRILL, DEEPEN, OR PLUG BACK

1a. TYPE OF WORK

DRILL ☒DEEPEN ☐PLUG BACK ☐

b. TYPE OF WELL

OIL
WELL ☐GAS
WELL ☐

OTHER

SINGLE
ZONE ☒MULTIPLE
ZONE ☐

2. NAME OF OPERATOR

Humble Oil & Refining Co.

3. ADDRESS OF OPERATOR

Box 1600, Midland, Texas

4. LOCATION OF WELL (Report location clearly and in accordance with any State requirements.)*

At surface

1837 FS&WL

At proposed prod. zone

same

14. DISTANCE IN MILES AND DIRECTION FROM NEAREST TOWN OR POST OFFICE*

15 miles North Dunden, NM

15. DISTANCE FROM PROPOSED*

LOCATION TO NEAREST
PROPERTY OR LEASE LINE, FT.
(Also to nearest drlg. unit line, if any)

16. NO. OF ACRES IN LEASE

2560.64

17. NO. OF ACRES ASSIGNED
TO THIS WELL

40

18. DISTANCE FROM PROPOSED LOCATION*
TO NEAREST WELL, DRILLING, COMPLETED,
OR APPLIED FOR, ON THIS LEASE, FT.

19. PROPOSED DEPTH

5500' (*Gravel*)

20. ROTARY OR CABLE TOOLS

rotary

21. ELEVATIONS (Show whether DF, RT, GR, etc.)

5406 Gr

22. APPROX. DATE WORK WILL START*

4-4-67

23.

PROPOSED CASING AND CEMENTING PROGRAM

SIZE OF HOLE	SIZE OF CASING	WEIGHT PER FOOT	SETTING DEPTH	QUANTITY OF CEMENT
13-3/4	11-3/4	42	40'	10 sx circl to surf.
11	8-5/8	24	800	200 sx circl to surf.
7-7/8	4-1/2	9.5	5500	225 sx circl back to 600' above top of uppermost pay sec.

Min. mud program for samples.
HOWCO method of cmtg to be used.

RECEIVED

APR 5 1967

D. C. C.
ARTESIA, OFFICERECEIVED
APR 4 1967
U. S. GEOLOGICAL SURVEY
ARTESIA, NEW MEXICO

IN ABOVE SPACE DESCRIBE PROPOSED PROGRAM: If proposal is to deepen or plug back, give data on present productive zone and proposed new productive zone. If proposal is to drill or deepen directionally, give pertinent data on subsurface locations and measured and true vertical depths. Give blowout preventer program, if any.

24.

SIGNED

H. H. Tipton, Jr.

TITLE

Agent

DATE

4-3-67

(This space for Federal or State office use)

PERMIT NO.

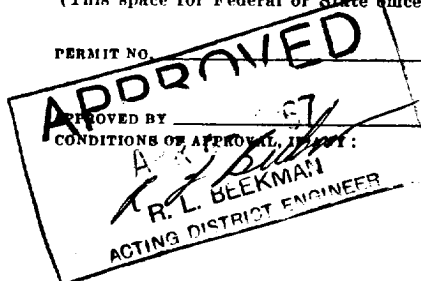
DECLARED WATER BASIN
CEMENT BEG. APR 11 1967
CASING MUST BE CIRCULATEDDATE
NOTIFY USGS IN SUFFICIENT TIME TO
WITNESS CE... CASING

*See Instructions On Reverse Side

Humble Les.No. _____

NEW MEXICO OIL CONSERVATION COMMISSION

State Les.No. _____

WELL LOCATION AND ACREAGE DEDICATION PLAT

Form C-102
Supersedes C-128
Effective 1-1-65Federal Les.No. USA 0559078

All distances must be from the outer boundaries of the Section.

Operator Humble Oil & Refining Co.			Lease HUMBLE YATES FEDERAL		Well No. 1
Unit Letter K	Section 26	Township 15 South	Range 18 East	County Chaves	
Actual Footage Location of Well: 1837 feet from the South line and 1837 feet from the West line					
Ground Level Elev: Later	Producing Formation <i>Permian</i>		Pool Wildcat	Dedicated Acreage: 40 Acres	

1. Outline the acreage dedicated to the subject well by colored pencil or hatchure marks on the plat below.
2. If more than one lease is dedicated to the well, outline each and identify the ownership thereof (both as to working interest and royalty).
3. If more than one lease of different ownership is dedicated to the well, have the interests of all owners been consolidated by communitization, unitization, force-pooling, etc?

☐ Yes ☐ No If answer is "yes," type of consolidation 1967

If answer is "no," list the owners and tract descriptions which have actually been consolidated. (Use reverse side of this form if necessary.) _____

No allowable will be assigned to the well until all interests have been consolidated (by communitization, unitization, forced-pooling, or otherwise) or until a non-standard unit, eliminating such interests, has been approved by the Commission.

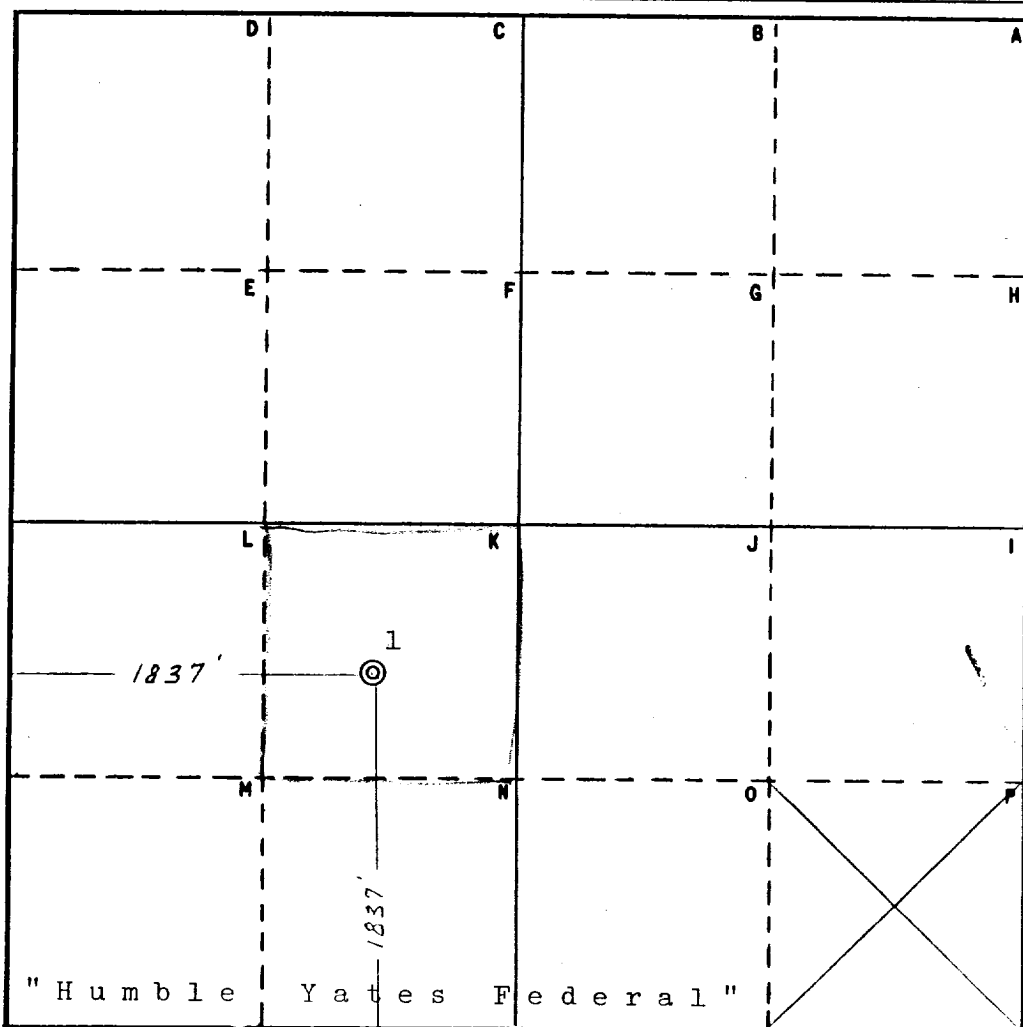

CERTIFICATION

I hereby certify that the information contained herein is true and complete to the best of my knowledge and belief.

Name MR Dallas
Position Section Head
Company Humble Oil & Refining Co.
Box 1600 Midland, Texas

Date 4-3-67

I hereby certify that the well location shown on this plat was plotted from field notes of actual surveys made by me or under my supervision, and that the same is true and correct to the best of my knowledge and belief.

Date Surveyed March 31, 1967
Registered Professional Engineer and/or Land Surveyor

H. S. Westerfield

Certificate No. 1382

Humble	Humble		Open
"State" 22	" State "		23 24 " U. S. "
27	Humble # Federal # 0559078 USA		26 25 Yates Pet.
<p>T - 15 - S R. - 18 - E</p>			
34	Yates		35 36
Yates	"State "		Humble
" U. S. "	"State "		" State "

This Application For Well No. 1

RECEIVED
APR 4 1967
 U. S. GEOLOGICAL SURVEY
 ARTESIA, NEW MEXICO
 1382 *W. S. Westerfield*

HUMBLE YATES FEDERAL # Section 26 , T - 15 - S R - 18 - E Chaves County, New Mexico		HUMBLE OIL & REFINING COMPANY SOUTHWEST REGION PRODUCTION DEPARTMENT Southwestern Division	
DRAWN <u>D. L. McKibbin</u> CHECKED _____	ENGR. SECTION <u>C & S</u> APPROVED _____	SCALE <u>1" = 1000'</u> DATE <u>April 3, 1967</u>	JOB NO. _____ FILE NO. <u>W A - 3916</u>