

NEW MEXICO OIL CONSERVATION COMMISSION
Santa Fe, New Mexico

Form G-101
Revised (12/1/55)

NOTICE OF INTENTION TO DRILL

Notice must be given to the District Office of the Oil Conservation Commission and approval obtained before drilling or recompletion begins. If changes in the proposed plan are considered advisable, a copy of this notice showing such changes will be returned to the sender. Submit this notice in **QUINTUPLICATE**. One copy will be returned following approval. See additional instructions in Rules and Regulations of the Commission. If State Land submit 6 Copies Attach Form G-128 in triplicate to first 3 copies of form G-101

Dallas, Texas

March 24th, 1969

(Place)

(Date)

OIL CONSERVATION COMMISSION
SANTA FE, NEW MEXICO

APPROVAL VALID
FOR 90 DAYS UNLESS
DRILLING COMMENCED,

Gentlemen:

You are hereby notified that it is our intention to commence the Drilling of a well to be known as

Dalport Oil Corporation

EXPIRES 6-27-69

SOMICO-State

(Company or Operator)

Well No. **1**

P

(Unit)

660'

(Lease)

South

located **660'** feet from the **East** line and **660'** feet from the

East

line of Section **24**

14-S

29-E

T. **Wildcat**, R. **Chaves**, NMPM.

(GIVE LOCATION FROM SECTION LINE)

Pool, **K-6772**

County

If State Land the Oil and Gas Lease is No.

If patented land the owner is

Address

We propose to drill well with drilling equipment as follows:

Rotary

The status of plugging bond is

Blanket Bond on File

Drilling Contractor

Cactus Drilling Company
Hobbs, New Mexico

We intend to complete this well in the

Queen

formation at an approximate depth of **2100'** feet.

CASING PROGRAM

We propose to use the following strings of Casing and to cement them as indicated:

Size of Hole	Size of Casing	Weight per Foot	New or Second Hand	Depth	Sacks Cement
11"	8 5/8"	20#	New	300'	200 SX
7 7/8"	4 1/2"	9.5#	New	2100'	200 SX

If changes in the above plans become advisable we will notify you immediately.

ADDITIONAL INFORMATION (If recompletion give full details of proposed plan of work.)

RECEIVED

MAR 27 1969

O. C. C.
ARTERIA, OFFICE

APR 4 1969

Approved....., 19.....
Except as follows:

Sincerely yours,

DALPORT OIL CORPORATION

(Company or Operator)

By

President

Position

W. L. Ford, Jr.

Name

3471 First Natl Bank Bldg Dallas

Address

Texas 75202

OIL CONSERVATION COMMISSION

By **W. A. Gressett**

OIL AND GAS INSPECTION

**NEW MEXICO OIL CONSERVATION COMMISSION
WELL LOCATION AND ACREAGE DEDICATION PLAT**

Form C-102
Supersedes C-128
Effective 1-1-65

All distances must be from the outer boundaries of the Section.

Operator DALPORT OIL CORP.			Lease SOMICO-STATE		Well No. 1
Unit Letter P	Section 24	Township 14 SOUTH	Range 29 EAST	County CHAVES	
Actual Footage Location of Well: 660 feet from the SOUTH line and 660 feet from the EAST line					
Ground Level Elev. Furnished later	Producing Formation Queen		Pool wildcat		Dedicated Acreage: 40 Acres

1. Outline the acreage dedicated to the subject well by colored pencil or hachure marks on the plat below.
2. If more than one lease is dedicated to the well, outline each and identify the ownership thereof (both as to working interest and royalty).
3. If more than one lease of different ownership is dedicated to the well, have the interests of all owners been consolidated by communitization, unitization, force-pooling, etc?

☐ Yes ☐ No If answer is "yes," type of consolidation _____

If answer is "no," list the owners and tract descriptions which have actually been consolidated. (Use reverse side of this form if necessary.) _____

No allowable will be assigned to the well until all interests have been consolidated (by communitization, unitization, forced-pooling, or otherwise) or until a non-standard unit, eliminating such interests, has been approved by the Commission.

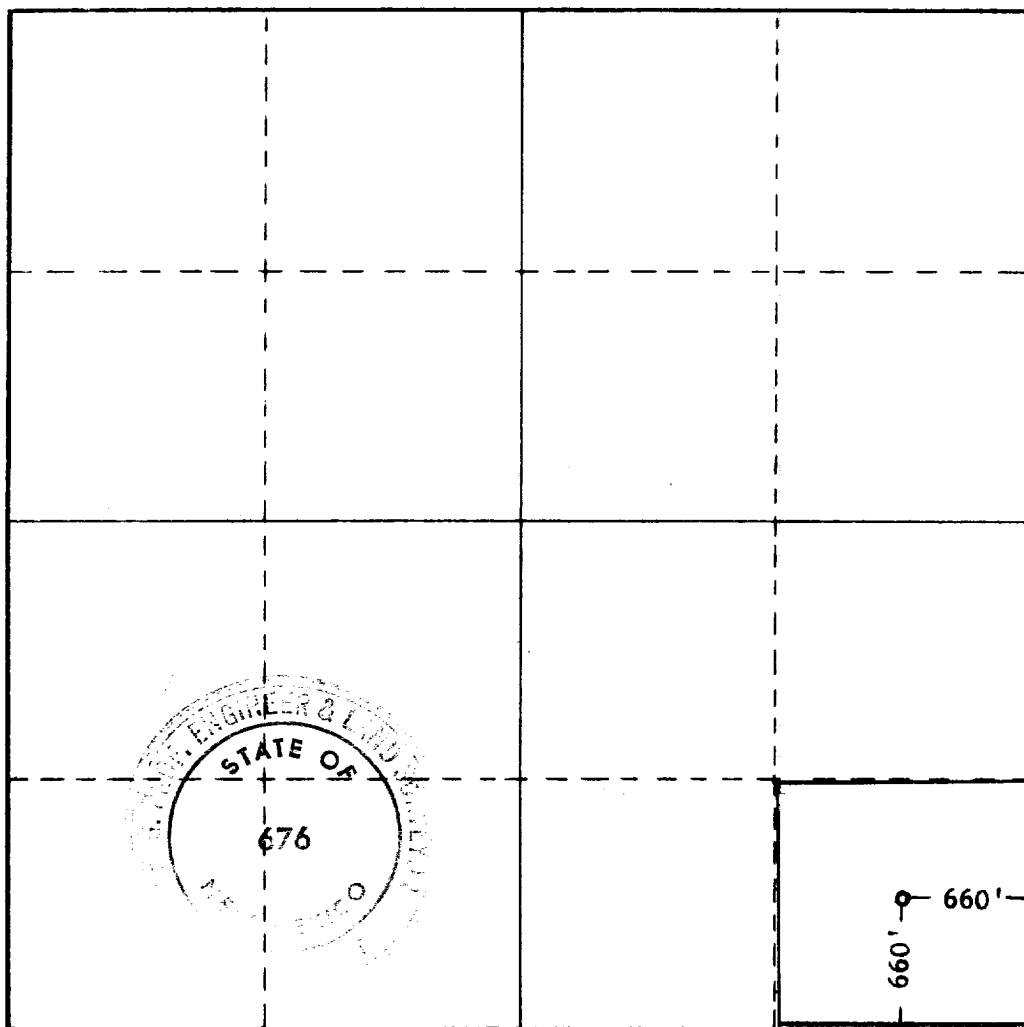

CERTIFICATION

I hereby certify that the information contained herein is true and complete to the best of my knowledge and belief.

Name *W. F. Tread Jr*
 Position **President**
 Company **DALPORT OIL CORPORATION**
 Date **March 24, 1969**

I hereby certify that the well location shown on this plat was plotted from field notes of actual surveys made by me or under my supervision, and that the same is true and correct to the best of my knowledge and belief.

Date Surveyed
MARCH 20, 1969

Registered Professional Engineer
and/or Land Surveyor

John W. Wheat
 Certificate No. **676**

