

UNITED STATES  
DEPARTMENT OF THE INTERIOR  
GEOLOGICAL SURVEY

## APPLICATION FOR PERMIT TO DRILL, DEEPEN, OR PLUG BACK

## 1a. TYPE OF WORK

DRILL ☒DEEPEN ☐PLUG BACK ☐

## b. TYPE OF WELL

OIL  
WELL ☒GAS  
WELL ☐

OTHER

SINGLE  
ZONE ☐MULTIPLE  
ZONE ☐

## 2. NAME OF OPERATOR

JACK L. MCCLELLAN

## 3. ADDRESS OF OPERATOR

Box 848, ROSWELL, NEW MEXICO 88201

## 4. LOCATION OF WELL (Report location clearly and in accordance with any State requirements.)

At surface

660' FS &amp; 1980' FWL

At proposed prod. zone

## 14. DISTANCE IN MILES AND DIRECTION FROM NEAREST TOWN OR POST OFFICE\*

20 MILES NORTH OF LOCO HILLS

## 15. DISTANCE FROM PROPOSED\*

LOCATION TO NEAREST  
PROPERTY OR LEASE LINE, FT.  
(Also to nearest drlg. unit line, if any)

660'

## 16. NO. OF ACRES IN LEASE

800

17. NO. OF ACRES ASSIGNED  
TO THIS WELL

40

18. DISTANCE FROM PROPOSED LOCATION\*  
TO NEAREST WELL, DRILLING, COMPLETED,  
OR APPLIED FOR, ON THIS LEASE, FT.

1650'

## 19. PROPOSED DEPTH

2050'

## 20. ROTARY OR CABLE TOOLS

CABLE TOOLS

## 21. ELEVATIONS (Show whether DF, RT, GR, etc.)

## 22. APPROX. DATE WORK WILL START\*

JULY 2, 1969

## 23.

## PROPOSED CASING AND CEMENTING PROGRAM

| SIZE OF HOLE | SIZE OF CASING | WEIGHT PER FOOT | SETTING DEPTH | QUANTITY OF CEMENT |
|--------------|----------------|-----------------|---------------|--------------------|
| 12-3/4"      | 8-5/8"         | 20 LB.          | 430'          | 50 SACKS           |
| 8"           | 5-1/2"         | 14 LB.          | 2050'         | 150 SACKS          |

WILL DRILL TO 2050' WITH CABLE TOOLS TO TEST QUEEN SAND SECTION. IF  
PRODUCTION IS INDICATED WILL SET PIPE, PERFORATE AND FRACTURE TREAT.

CORTEZ DRILLING CORPORATION OF ROSWELL, NEW MEXICO, WILL BE THE  
CONTRACTOR.

IN ABOVE SPACE DESCRIBE PROPOSED PROGRAM: If proposal is to deepen or plug back, give data on present productive zone and proposed new productive zone. If proposal is to drill or deepen directionally, give pertinent data on subsurface locations and measured and true vertical depths. Give blowout preventer program, if any.

## 24.

SIGNED

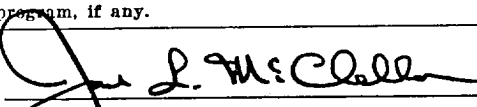

TITLE

OPERATOR

DATE

JULY 1, 1969

(This space for Federal or State office use)

PERMIT NO.

APPROVED

CONDITIONS OF APPROVAL, IF ANY:

JUL - 2 1969

H. E. BECKMAN

ACTING DIRECTOR

THIS APPROVAL IS RESCINDED IF OPERATIONS  
ARE NOT COMMENCED WITHIN 3 MONTHS.  
EXPIRES JUL - 2 1969

\*See Instructions On Reverse Side

**NEW MEXICO OIL CONSERVATION COMMISSION  
WELL LOCATION AND ACREAGE DEDICATION PLAT**

Form C-102  
Supersedes C-128  
Effective 1-1-65

All distances must be from the outer boundaries of the Section.

|   |  |                                     |                                       |                          |                      |
|---|--|-------------------------------------|---------------------------------------|--------------------------|----------------------|
| Operator<br><i>JACK L. McCLANAHAN</i>   |  |                                     | Lease<br><i>Federal</i>               |                          | Well No.<br><b>5</b> |
| Unit Letter<br><b>E</b>   | Section<br><b>24</b>                     | Township<br><i>23 N</i>             | Range<br><i>12 E</i>                  | County<br><i>De Baca</i> |                      |
| Actual Footage Location of Well:<br><div style="display: flex; justify-content: space-between;"> <span>1940 feet from the</span> <span>1340 line and</span> <span>660 feet from the</span> <span>Section line</span> </div> |  |                                     |                                       |                          |                      |
| Ground Level Elev.<br><b>3907</b>   | Producing Formation<br><i>Quaternary</i> | Pool<br><i>Unit 1 on Quaternary</i> | Dedicated Acreage:<br><b>40</b> Acres |                          |                      |

1. Outline the acreage dedicated to the subject well by colored pencil or hachure marks on the plat below.
2. If more than one lease is dedicated to the well, outline each and identify the ownership thereof (both as to working interest and royalty).
3. If more than one lease of different ownership is dedicated to the well, have the interests of all owners been consolidated by communitization, unitization, force-pooling, etc?

☐ Yes    ☐ No    If answer is "yes," type of consolidation \_\_\_\_\_

If answer is "no," list the owners and tract descriptions which have actually been consolidated. (Use reverse side of this form if necessary.) \_\_\_\_\_

No allowable will be assigned to the well until all interests have been consolidated (by communitization, unitization, forced-pooling, or otherwise) or until a non-standard unit, eliminating such interests, has been approved by the Commission.

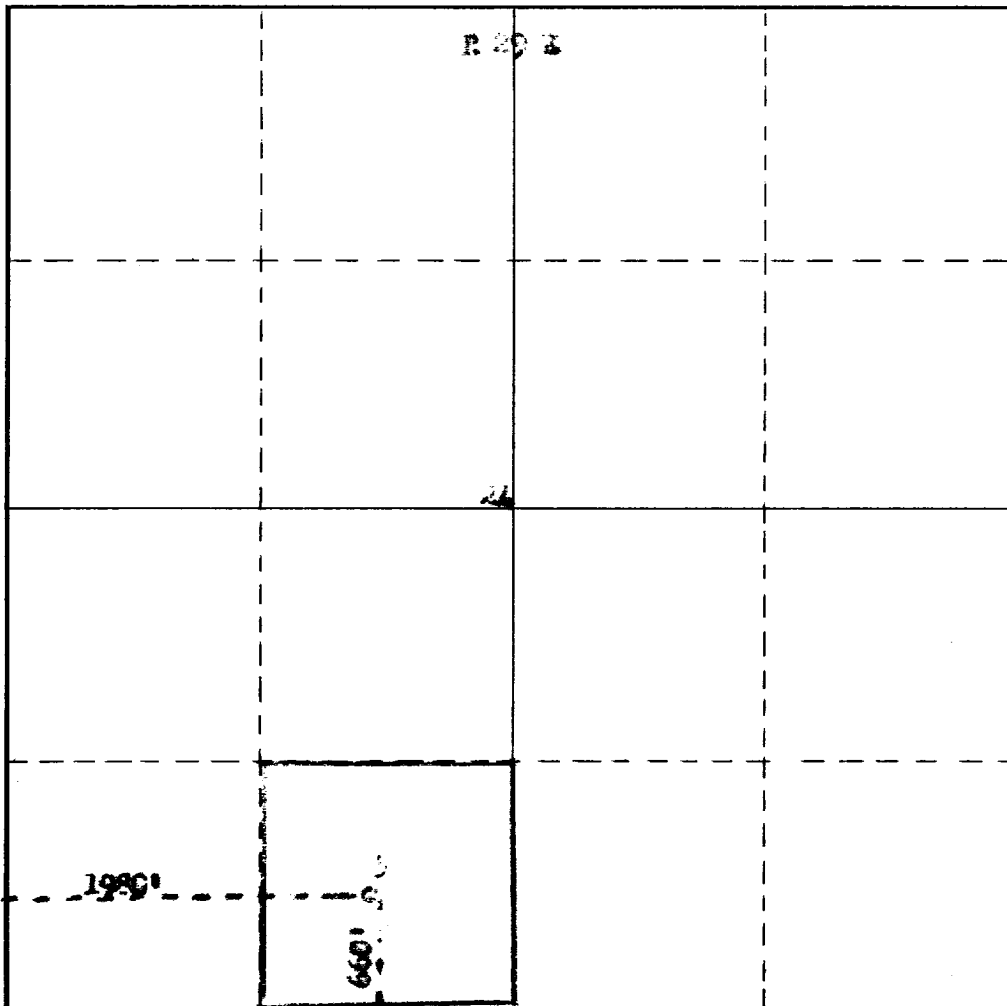

**CERTIFICATION**

I hereby certify that the information contained herein is true and complete to the best of my knowledge and belief.

Name \_\_\_\_\_  
Position \_\_\_\_\_  
Company \_\_\_\_\_  
Date *July 2nd, 1969*

I hereby certify that the well location shown on this plat was plotted from field notes of actual surveys made by me or under my supervision, and that the same is true and correct to the best of my knowledge and belief.

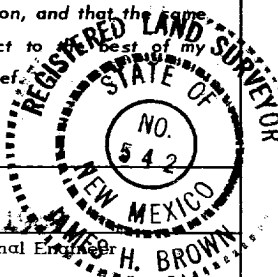

Date Surveyed \_\_\_\_\_  
Registered Professional Engineer and/or Land Surveyor  
*JAMES H. BROWN*  
Certificate No. \_\_\_\_\_

