

UNITED STATES  
DEPARTMENT OF THE INTERIOR  
GEOLOGICAL SURVEY

## APPLICATION FOR PERMIT TO DRILL, DEEPEN, OR PLUG BACK

## 1a. TYPE OF WORK

DRILL ☒DEEPEN ☐PLUG BACK ☐

## b. TYPE OF WELL

OIL  
WELL ☒GAS  
WELL ☐OTHER ☐

RECEIVED

SINGLE  
ZONE ☐MULTIPLE  
ZONE ☐

## 2. NAME OF OPERATOR

PAN AMERICAN PETROLEUM CORPORATION

AUG 1 1969

## 3. ADDRESS OF OPERATOR

BOX 68, HOBBS, N. M. 88240

## 4. LOCATION OF WELL (Report location clearly and in accordance with any State requirements.)

At surface

330' FNL x 660' FWL Sec. 25 (Unit D, NW 1/4 NW 1/4)

At proposed prod. zone

## 14. DISTANCE IN MILES AND DIRECTION FROM NEAREST TOWN OR POST OFFICE\*

## 10. DISTANCE FROM PROPOSED\*

LOCATION TO NEAREST  
PROPERTY OR LEASE LINE, FT.  
(Also to nearest drlg. unit line, if any)

## 16. NO. OF ACRES IN LEASE

18. DISTANCE FROM PROPOSED LOCATION\*  
TO NEAREST WELL, DRILLING, COMPLETED,  
OR APPLIED FOR, ON THIS LEASE, FT.

## 19. PROPOSED DEPTH.

2100

## 21. ELEVATIONS (Show whether DF, RT, GR, etc.)

17. NO. OF ACRES ASSIGNED  
TO THIS WELL

40

## 20. ROTARY OR CABLE TOOLS

CABLE

## 22. APPROX. DATE WORK WILL START\*

9-1-69

## 23.

## PROPOSED CASING AND CEMENTING PROGRAM

SIZE OF HOLE	SIZE OF CASING	WEIGHT PER FOOT	SETTING DEPTH	QUANTITY OF CEMENT
12 1/2"	8 5/8"	24 #	450'	Circulate
8"	4 1/2"	9.5 #	2100'	Fill 600' above pay.

After drilling well logs will be run and evaluations made, perforating and/or stimulating as necessary in attempting commercial production.

IN ABOVE SPACE DESCRIBE PROPOSED PROGRAM: If proposal is to deepen or plug back, give data on present productive zone and proposed new productive zone. If proposal is to drill or deepen directionally, give pertinent data on subsurface locations and measured and true vertical depths. NEW blowout preventer program, if any.

24.

SIGNED

TITLE

AREA SUPERINTENDENT

DATE

AUG 11 1969

(This space for Federal or State office use)

AUG 13 1969

PERMIT NO.

APPROVAL DATE

APPROVED BY

TITLE

DISTRICT ENGINEER

DATE

AUG 13 1969

CONDITIONS OF APPROVAL, IF ANY:

0-4- USGS-ARTESIA  
1- NSW  
1- SUSP  
1- RRY

\*See Instructions On Reverse Side

30-005-60087

## 5. LEASE DESIGNATION AND SERIAL NO.

NM-0518428

## 6. IF INDIAN, ALLOTTEE OR TRIBE NAME

## 7. UNIT AGREEMENT NAME

## 8. FARM OR LEASE NAME

LA RUE Federal

## 9. WELL NO.

## 10. FIELD AND POOL, OR WILDCAT

SUNMAR-QUEEN

11. SEC., T., R., M., OR BLK.  
AND SURVEY OR AREA

25-15-29 NMPM

## 12. COUNTY OR PARISH

CHAUES

## 13. STATE

NM

RECEIVED

AUG 13 1969

U.S. GEOLOGICAL SURVEY  
ARTESIA, NEW MEXICO

NEW MEXICO OIL CONSERVATION COMMISSION  
WELL LOCATION AND ACREAGE DEDICATION PLAT

Form C-102  
Supersedes C-128  
Effective 1-1-65

All distances must be from the outer boundaries of the Section.

Operator <b>PAN AMERICAN PETROLEUM CORP.</b>		Lease <b>LA RUE FEDERAL</b>		Well No. <b>1</b>
Unit Letter <b>D</b>	Section <b>25</b>	Township <b>15 SOUTH</b>	Range <b>29 EAST</b>	County <b>CHAVES</b>
Actual Footage Location of Well: <b>330</b> feet from the <b>NORTH</b> line and <b>660</b> feet from the <b>WEST</b> line				
Ground Level Elev.	Producing Formation <b>QUEEN</b>	Pool <b>SULIMAR - Queen</b>	Dedicated Acreage: <b>40</b> Acres	

1. Outline the acreage dedicated to the subject well by colored pencil or hachure marks on the plat below.
2. If more than one lease is dedicated to the well, outline each and identify the ownership thereof (both as to working interest and royalty).
3. If more than one lease of different ownership is dedicated to the well, have the interests of all owners been consolidated by communitization, unitization, force-pooling, etc?

☐ Yes ☐ No If answer is "yes," type of consolidation \_\_\_\_\_

If answer is "no," list the owners and tract descriptions which have actually been consolidated. (Use reverse side of this form if necessary.) \_\_\_\_\_

No allowable will be assigned to the well until all interests have been consolidated (by communitization, unitization, forced-pooling, or otherwise) or until a non-standard unit, eliminating such interests, has been approved by the Commission.

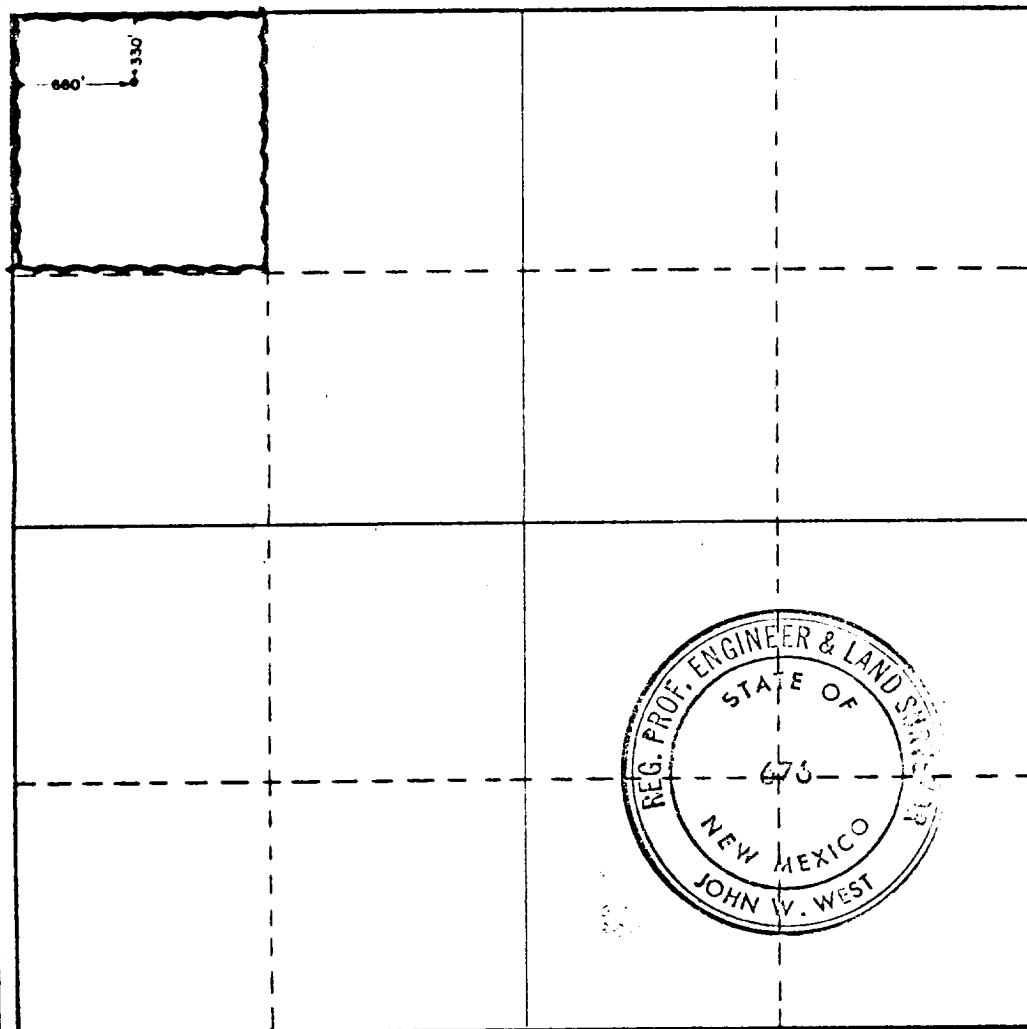

CERTIFICATION

I hereby certify that the information contained herein is true and complete to the best of my knowledge and belief.

Name  
**Area Superintendent**  
Position  
**Pan American Petroleum Corp.**  
Company  
**August 11, 1969**  
Date

**RECEIVED**  
**AUG 13 1969**

I hereby certify that the location shown on this plat was derived from field notes of previous surveys made by me or under my supervision, and that the same is true and correct to the best of my knowledge and belief.

Date Surveyed  
**AUGUST 7, 1969**

Registered Professional Engineer and/or Land Surveyor

*John W West*  
Certificate No. **676**

0 330 660 990 1320 1650 1980 2310 2640 2970 3300 3630 3960 4290 4620 4950 5280 5610 5940 6270 6600