

UNITED STATES
DEPARTMENT OF THE INTERIOR
GEOLOGICAL SURVEY

APPLICATION FOR PERMIT TO DRILL, DEEPEN, OR PLUG BACK

1a. TYPE OF WORK

DRILL ☒DEEPEN ☐PLUG BACK ☐

b. TYPE OF WELL

OIL
WELL ☒GAS
WELL ☐

OTHER

SINGLE
ZONE ☒MULTIPLE
ZONE ☐

2. NAME OF OPERATOR

JACK L. MCCLELLAN

3. ADDRESS OF OPERATOR

Box 848, ROSWELL, NEW MEXICO

4. LOCATION OF WELL (Report location clearly and in accordance with any State requirements.*)
At surface

At proposed prod. zone

660' FEL & 1980' FSL

14. DISTANCE IN MILES AND DIRECTION FROM NEAREST TOWN OR POST OFFICE*

14 MILES NORTH OF LOCO HILLS, N.M.

15. DISTANCE FROM PROPOSED*

LOCATION TO NEAREST
PROPERTY OR LEASE LINE, FT.
(Also to nearest drg. unit line, if any)

660"

16. NO. OF ACRES IN LEASE

240

17. NO. OF ACRES ASSIGNED
TO THIS WELL

40

18. DISTANCE FROM PROPOSED LOCATION*
TO NEAREST WELL, DRILLING, COMPLETED,
OR APPLIED FOR, ON THIS LEASE, FT.

1320'

19. PROPOSED DEPTH

2050'

20. ROTARY OR CABLE TOOLS

CABLE TOOLS

21. ELEVATIONS (Show whether DF, RT, GR, etc.)

3937' G.L.

22. APPROX. DATE WORK WILL START*

OCTOBER 25, 1969

23.

PROPOSED CASING AND CEMENTING PROGRAM

SIZE OF HOLE	SIZE OF CASING	WEIGHT PER FOOT	SETTING DEPTH	QUANTITY OF CEMENT
12 3/4"	8 5/8"	24 LB.	430'	50 SX
8"	5 1/2"	14 LB.	2050'	150'

WILL DRILL TO APPROXIMATELY 2050' WITH CABLE TOOLS TO TEST THE
QUEEN SAND. IF PRODUCTION IS INDICATED, WILL SET PIPE AND COMPLETE.

CORTEZ DRILLING CO. IS THE CONTRACTOR. BOX 848, ROSWELL, N.M.

RECEIVED

OCT 24 1969

O. C. C.

IN ABOVE SPACE DESCRIBE PROPOSED PROGRAM: If proposal is to deepen or plug back, ~~give pertinent data~~ on present productive zone and proposed new productive zone. If proposal is to drill or deepen directionally, give pertinent data on subsurface locations and measured and true vertical depths. Give blowout preventer program, if any.

24.

SIGNED

(This space for Federal or State office use)

TITLE OPERATOR

DATE OCTOBER 22, 1969

PERMIT NO.

APPROVED
OCT 23 1969
R. L. BECKMA
ACTING DISTRICT

THIS APPROVAL IS RESCINDED IF OPERATIONS
ARE NOT COMMENCED WITHIN 3 MONTHS.
EXPIRES JAN 23 1970

*See Instructions On Reverse Side

N. MEXICO OIL CONSERVATION COMMISS. N
WELL LOCATION AND ACREAGE DEDICATION PLAT

Form C-102
 Supersedes C-128
 Effective 1-1-65

All distances must be from the outer boundaries of the Section.

Operator Jack L. McClellan			Lease Lisa "C" J		Well No. 5
Unit Letter I	Section 24	Township 15 South	Range 29 East	County Chaves	
Actual Footage Location of Well: 1980 feet from the South line and 660 feet from the East line					
Ground Level Elev. 3957	Producing Formation Queen	Pool Sulphur Q	Dedicated Acreage: 40 Acres		

- Outline the acreage dedicated to the subject well by colored pencil or hachure marks on the plat below.
- If more than one lease is dedicated to the well, outline each and identify the ownership thereof (both as to working interest and royalty).
- If more than one lease of different ownership is dedicated to the well, have the interests of all owners been consolidated by communitization, unitization, force-pooling, etc?

☐ Yes ☐ No If answer is "yes," type of consolidation _____

If answer is "no," list the owners and tract descriptions which have actually been consolidated. (Use reverse side of this form if necessary.) _____

No allowable will be assigned to the well until all interests have been consolidated (by communitization, unitization, forced-pooling, or otherwise) or until a non-standard unit, eliminating such interests, has been approved by the Commission.

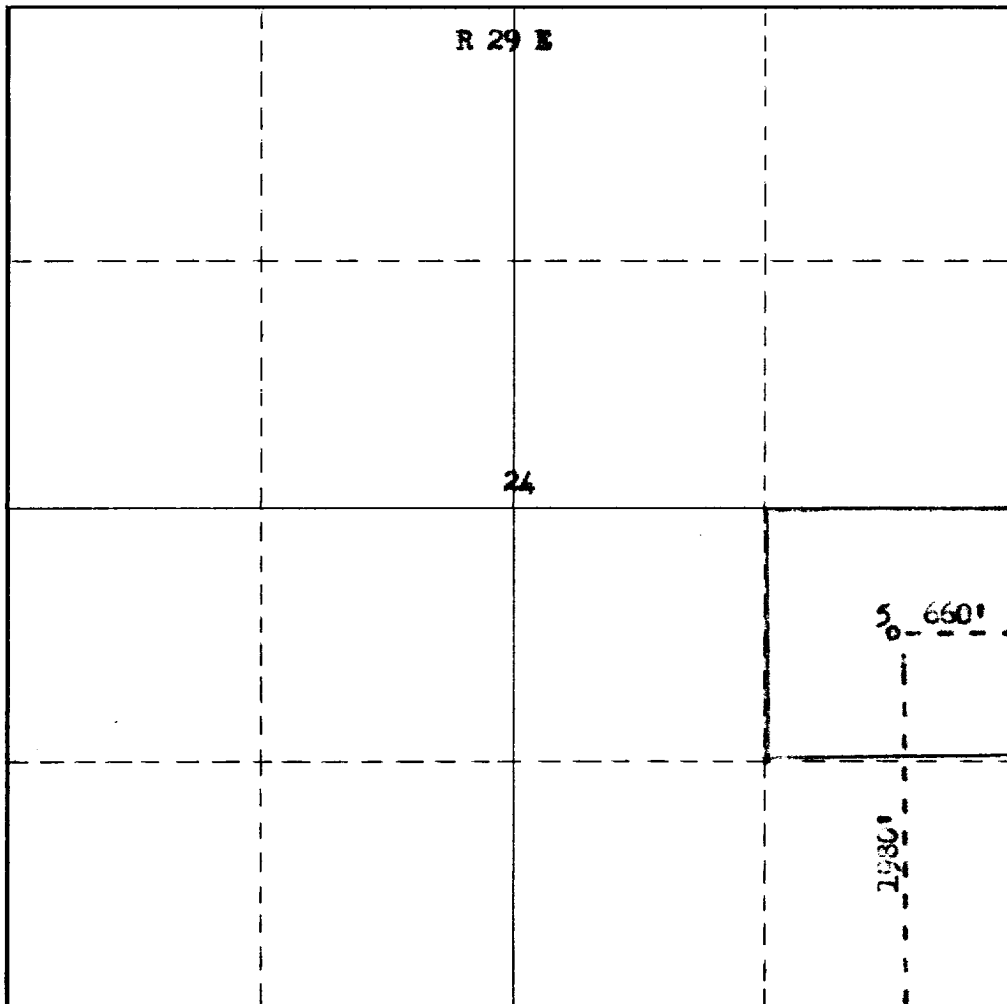

CERTIFICATION

I hereby certify that the information contained herein is true and complete to the best of my knowledge and belief.

Name
James H. Brown
 Position
Agent

Company
Jack L. McClellan

Date
October, 21, 1969

I hereby certify that the well location shown on this plat was plotted from field notes of actual surveys made by me or under my supervision, and that the same is true and correct to the best of my knowledge and belief.

Date Surveyed
October, 21, 1969

Registered Professional Engineer and/or Land Surveyor

James H. Brown
 Certificate No.

N.M.L.S. No. 542

