

UNITED STATES
DEPARTMENT OF THE INTERIOR
GEOLOGICAL SURVEY

30-005-60103

APPLICATION FOR PERMIT TO DRILL, DEEPEN, OR PLUG BACK

1a. TYPE OF WORK

DRILL ☒DEEPEN ☐PLUG BACK ☐

b. TYPE OF WELL

OIL
WELL ☐GAS
WELL ☐

OTHER

SINGLE
ZONE ☐MULTIPLE
ZONE ☐

2. NAME OF OPERATOR

JACK L. MCCLELLAN

3. ADDRESS OF OPERATOR

Box 848, ROSWELL, NEW MEXICO, 88201

4. LOCATION OF WELL (Report location clearly and in accordance with any State requirements.)*

At surface

330' FSL & 2310' FWL

At proposed prod. zone

14. DISTANCE IN MILES AND DIRECTION FROM NEAREST TOWN OR POST OFFICE*

14 MILES NORTH OF LOCO HILLS, NEW MEXICO

15. DISTANCE FROM PROPOSED*

LOCATION TO NEAREST
PROPERTY OR LEASE LINE, FT.
(Also to nearest drlg. unit line, if any)

330'

16. NO. OF ACRES IN LEASE

40

17. NO. OF ACRES ASSIGNED
TO THIS WELL

40

18. DISTANCE FROM PROPOSED LOCATION*
TO NEAREST WELL, DRILLING, COMPLETED,
OR APPLIED FOR, ON THIS LEASE, FT.

19. PROPOSED DEPTH

2050'

20. ROTARY OR CABLE TOOLS

CABLE TOOLS

21. ELEVATIONS (Show whether DF, RT, GR, etc.)

3920' G. L.

22. APPROX. DATE WORK WILL START*

NOVEMBER 27, 1969

23.

PROPOSED CASING AND CEMENTING PROGRAM

SIZE OF HOLE	SIZE OF CASING	WEIGHT PER FOOT	SETTING DEPTH	QUANTITY OF CEMENT
12-3/4"	8-5/8"	24 LB.	430'	50 SX
8"	5 1/2"	14 LB.	2050'	150 SX

WILL DRILL TO APPROXIMATELY 2050' WITH CABLE TOOLS TO TEST THE QUEEN
SAND. IF PRODUCTION IS INDICATED, WILL SET PIPE AND COMPLETE.

CORTEZ DRILLING COMPANY, Box 848, ROSWELL, NEW MEXICO, IS THE CONTRACTOR.

RECEIVED RECEIVED
DEC 1 1969 NOV 24 1969
U. S. GEOLOGICAL SURVEY
ARTESIA, N.M.

IN ABOVE SPACE DESCRIBE PROPOSED PROGRAM: If proposal is to deepen or plug back, give details of present productive zone and proposed new productive zone. If proposal is to drill or deepen directionally, give pertinent data on subsurface locations and measured and true vertical depths. Give blowout preventer program, if any.

24.

SIGNED

J. L. McClellan

TITLE

OPERATOR

DATE

11/21/69

(This space for Federal or State office use)

PERMIT NO.

APPROVAL DATE

APPROVED
NOV 24 1969
R. L. BEEKMA

THIS APPROVAL IS RESCINDED IF OPERATIONS
ARE NOT COMMENCED WITHIN 3 MONTHS.
EXPIRES FEB 24 1970

DATE

*See Instructions On Reverse Side

**N. MEXICO OIL CONSERVATION COMMISSION
WELL LOCATION AND ACREAGE DEDICATION PLAT**

Form C-102
Supersedes C-128
Effective 1-1-65

All distances must be from the outer boundaries of the Section.

Operator JACK L. MCCLELLAN			Lease GETTY FEDERAL		Well No. 1
Unit Letter A	Section 23	Township 15 South	Range 29 East	County CHAVEZ	
Actual Footage Location of Well: <div style="display: flex; justify-content: space-between;"> 2310 feet from the South line and 2310 feet from the East line </div>					
Ground Level Elev. 3920	Producing Formation Queen Sand	Pool Sulimar	Dedicated Acreage: 40 Acres		

1. Outline the acreage dedicated to the subject well by colored pencil or hachure marks on the plat below.
2. If more than one lease is dedicated to the well, outline each and identify the ownership thereof (both as to working interest and royalty).
3. If more than one lease of different ownership is dedicated to the well, have the interests of all owners been consolidated by communitization, unitization, force-pooling, etc?

☐ Yes ☐ No If answer is "yes," type of consolidation _____

If answer is "no," list the owners and tract descriptions which have actually been consolidated. (Use reverse side of this form if necessary.) _____

No allowable will be assigned to the well until all interests have been consolidated (by communitization, unitization, forced-pooling, or otherwise) or until a non-standard unit, eliminating such interests, has been approved by the Commission.

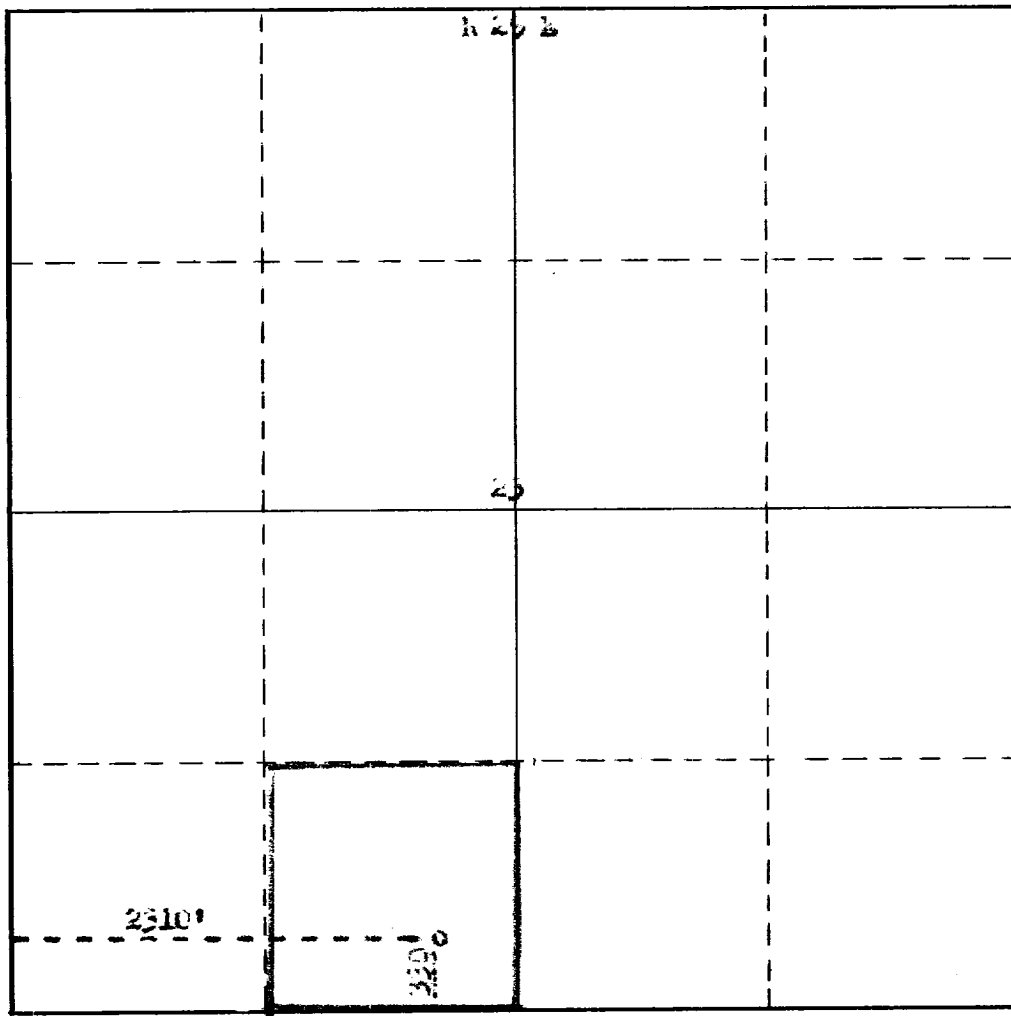

CERTIFICATION

I hereby certify that the information contained herein is true and complete to the best of my knowledge and belief.

Name
JACK L. MCCLELLAN
Position
OPERATOR

Company
JACK L. MCCLELLAN

Date
NOVEMBER 21, 1969

I hereby certify that the well location shown on this plat was plotted from field notes of **NOV 24 1969** by me or under my supervision, and that the same is true and correct to the best of my knowledge and belief.

Date Surveyed
November 20, 1969

Registered Professional Engineer and/or Land Surveyor

Certificate No.
N.M.L.S. No. 522