

COUNTY 6
 DISTRICT 1
 SANTA FE 1
 FILE 1 ✓
 DIVISION 2
 LAND OFFICE 1
 OPERATOR 1

NEW MEXICO OIL AND GAS REGULATION COMMISSION

30-005-60104

DEC 16 1969

O. C. C.
ARTEBIA, OFFICE

Form No. 1
Revised 12-68

7. Unit Agreement Name

8. Name of Lessee Name
Trobaugh

9. Well No.
1

10. Well and Prod. or Wellbore
Ordos. (Buffalo Valley)

11. Well and Prod. or Wellbore
Ordos. (Buffalo Valley)

12. County
Chaves

APPLICATION FOR PERMIT TO DRILL, DEEPEN, OR PLUG BACK

1. Type of Work
 a. To be Done
 DRILL DEEPEN PLUG BACK
 b. Other OTHER SINGLE ZONE MULTIPLE ZONE

2. Name of Operator
Reta & Stevens, Inc.

3. Address of Operator
P.O. Box 2126, Roswell, New Mexico 88201

4. Section, Township, Range, and Meridian
 SECTION LETTER J LOCATED 1650 FEET FROM THE South LINE
1650 1650 1650 1650 1650 1650 1650 1650 1650 1650

5. Proposed Depth
8400'

6. Formation
Atoka

7. Rotary or CMT
Rotary

8. Kind & Status Plug. Bond
3517.2' GL Statewide

9. Drilling Contractor
WEK

10. Approx. Date Work will start
20 Dec 69

PROPOSED CASING AND CEMENT PROGRAM

SIZE OF PIPE	SIZE OF CASING	WEIGHT PER FOOT	SETTING DEPTH	SACKS OF CEMENT	EST. TOP
17 1/2"	13 3/8"	48#	330'	350	Cir to surface
11"	8 5/8"	24#	1600'	200	T/Slaughter
7 7/8"	5 1/2"	14#, 15.5# & 17#	8300'	200	7500'

APPROVAL VALID
 FOR 90 DAYS UNLESS
 DRILLING COMMENCED,
 EXPIRES 3-18-70

IN APPROVAL OF THE ABOVE PROPOSED PROGRAM: IF PROPOSAL IS TO DEEPEN OR PLUG BACK, GIVE DATA ON PRESENT PRODUCTIVE ZONE AND PROPOSED NEW PRODUCTION. IF PLUG BACK, GIVE LOCATION, DEPTH, AND PROPOSED PROGRAM, IF ANY.

I hereby certify that the information above is true and complete to the best of my knowledge and belief.

Signature [Signature] Title Agent Date 12/15/69

(This space for State Use)

APPROVED BY W. A. Gressett TITLE OIL AND GAS INSPECTOR DATE 12/15/69

CONDITIONS OF APPROVAL, IF ANY:
 Cement must be circulated to surface behind 13 3/8" casing

NEW MEXICO OIL CONSERVATION COMMISSION
WELL LOCATION AND ACREAGE DEDICATION PLAT

Form C-102
Supersedes C-128
Effective 1-1-65

All distances must be from the outer boundaries of the Section.

Operator READ & STEVENS, INC.		Lease TROBOUGH			Well No. 1
Unit Letter J	Section 1	Township 15 SOUTH	Range 27 EAST	County CHAVES	
Actual Footage Location of Well: 1650 feet from the SOUTH line and 1650 feet from the EAST line					
Ground Level Elev. 3517.2	Producing Formation Atoka	Pool <i>Buffalo Valley Penn.</i> Undesignated	Dedicated Acreage: 320 Acres		

- Outline the acreage dedicated to the subject well by colored pencil or hachure marks on the plat below.
- If more than one lease is dedicated to the well, outline each and identify the ownership thereof (both as to working interest and royalty).
- If more than one lease of different ownership is dedicated to the well, have the interests of all owners been consolidated by communitization, unitization, force-pooling, etc?

Yes No If answer is "yes," type of consolidation _____

If answer is "no," list the owners and tract descriptions which have actually been consolidated. (Use reverse side of this form if necessary.) To be communitized if commercial

No allowable will be assigned to the well until all interests have been consolidated (by communitization, unitization, forced-pooling, or otherwise) or until a non-standard unit, eliminating such interests, has been approved by the Commission.

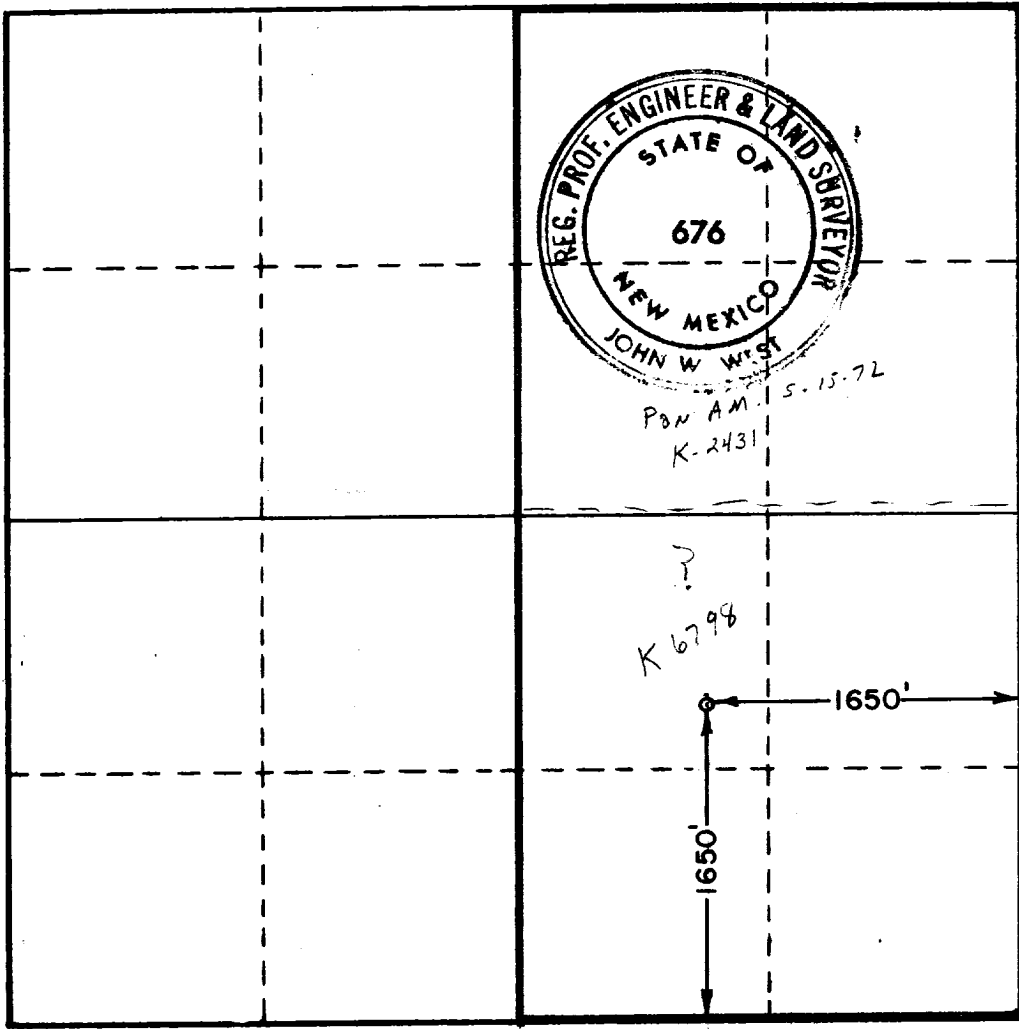

CERTIFICATION

I hereby certify that the information contained herein is true and complete to the best of my knowledge and belief.

Norman L. Stevens, Jr.

Name
Norman L. Stevens, Jr.

Position

Agent

Company

READ & STEVENS, INC.

Date

December 15, 1969

I hereby certify that the well location shown on this plat was plotted from field notes of actual surveys made by me or under my supervision, and that the same is true and correct to the best of my knowledge and belief.

Date Surveyed

DECEMBER 12, 1969

Registered Professional Engineer and/or Land Surveyor

John W. West

Certificate No.

676

