

NO. OF COPIES RECEIVED	6
DISTRIBUTION	
SANTA FE	/
FILE	/
U.S.G.S.	2
LAND OFFICE	/
OPERATOR	/

NEW MEXICO OIL CONSERVATION COMMISSION

RECEIVED

FEB 23 1970

30-005-60116

Form C-101  
Revised 1-1-65

5A. Indicate Type of Lease STATE <input checked="" type="checkbox"/> FEE <input type="checkbox"/>
5. State Oil & Gas Lease No. B-10418-78
7. Unit Agreement Name
8. Farm or Lease Name Spurck-State
9. Well No. 9
10. Field and Pool, or Wildcat Double L-Queen
12. County Chaves
19. Proposed Depth 2100
19A. Formation Queen
20. Rotary or C.T. Rotary
21. Elevations (Show whether DF, RT, etc.) 3829.4 ft.
21A. Kind & Status Plug. Bond Blanket Bond
21B. Drilling Contractor Donnelly Drlg. Co.
22. Approx. Date Work will start Immediately

APPLICATION FOR PERMIT TO DRILL, DEEPEN, OR PLUG BACK

1a. Type of Work DRILL <input checked="" type="checkbox"/> DEEPEN <input type="checkbox"/> PLUG BACK <input type="checkbox"/>
b. Type of Well OIL WELL <input checked="" type="checkbox"/> GAS WELL <input type="checkbox"/> OTHER <input type="checkbox"/> SINGLE ZONE <input checked="" type="checkbox"/> MULTIPLE ZONE <input type="checkbox"/>
2. Name of Operator Dalport Oil Corporation
3. Address of Operator 3471 First National Bank Bldg., Dallas, Texas 75202
4. Location of Well UNIT LETTER J LOCATED 1980 FEET FROM THE South LINE 1650 FEET FROM THE East LINE OF SEC. 25 TWP. 14S RGE. 29E NMPM
19. Proposed Depth 2100
19A. Formation Queen
20. Rotary or C.T. Rotary
21. Elevations (Show whether DF, RT, etc.) 3829.4 ft.
21A. Kind & Status Plug. Bond Blanket Bond
21B. Drilling Contractor Donnelly Drlg. Co.
22. Approx. Date Work will start Immediately

23.

PROPOSED CASING AND CEMENT PROGRAM

SIZE OF HOLE	SIZE OF CASING	WEIGHT PER FOOT	SETTING DEPTH	SACKS OF CEMENT	EST. TOP
11"	8-5/8	20	300	175	circulate
7-7/8	5-1/2	15.5	2100	300	700

Will drill with rotary in order to test Queen Sand. If production is indicated, will run pipe, perforate, and sand-oil fracture.

APPROVAL VALID  
FOR 90 DAYS UNLESS  
DRILLING COMMENCED,  
EXPIRES 5-25-70

IN ABOVE SPACE DESCRIBE PROPOSED PROGRAM: IF PROPOSAL IS TO DEEPEN OR PLUG BACK, GIVE DATA ON PRESENT PRODUCTIVE ZONE AND PROPOSED NEW PRODUCTIVE ZONE. GIVE BLOWOUT PREVENTER PROGRAM, IF ANY.

I hereby certify that the information above is true and complete to the best of my knowledge and belief.

Signed John M. Tangert Title Geologist Date 2/20/70

(This space for State Use)

APPROVED BY W. A. Gressett TITLE OIL AND GAS DATE FEB 24 1970

CONDITIONS OF APPROVAL, IF ANY:

NEW MEXICO OIL CONSERVATION COMMISSION  
WELL LOCATION AND ACREAGE DEDICATION PLAT

Form C-102  
Supersedes C-128  
Effective 1-1-65

All distances must be from the outer boundaries of the Section.

Operator <b>DALPORT OIL CORP.</b>			Lease <b>SPURCK STATE</b>		Well No. <b>9</b>
Unit Letter <b>J</b>	Section <b>25</b>	Township <b>14 SOUTH</b>	Range <b>29 EAST</b>	County <b>CHAVES</b>	
Actual Footage Location of Well: <b>1980</b> feet from the <b>SOUTH</b> line and <b>1650</b> feet from the <b>EAST</b> line					
Ground Level Elev. <b>3849.4</b>	Producing Formation <b>Queen</b>		Pool <b>Double L Queen unit</b>	Dedicated Acreage: <b>40</b> Acres	

1. Outline the acreage dedicated to the subject well by colored pencil or hachure marks on the plat below.
2. If more than one lease is dedicated to the well, outline each and identify the ownership thereof (both as to working interest and royalty).
3. If more than one lease of different ownership is dedicated to the well, have the interests of all owners been consolidated by communitization, unitization, force-pooling, etc?

☐ Yes ☐ No If answer is "yes," type of consolidation \_\_\_\_\_

If answer is "no," list the owners and tract descriptions which have actually been consolidated. (Use reverse side of this form if necessary.) \_\_\_\_\_

No allowable will be assigned to the well until all interests have been consolidated (by communitization, unitization, forced-pooling, or otherwise) or until a non-standard unit, eliminating such interests, has been approved by the Commission.

RECEIVED

FEB 23 1970

D. C. C.  
ARTS & OFFICE

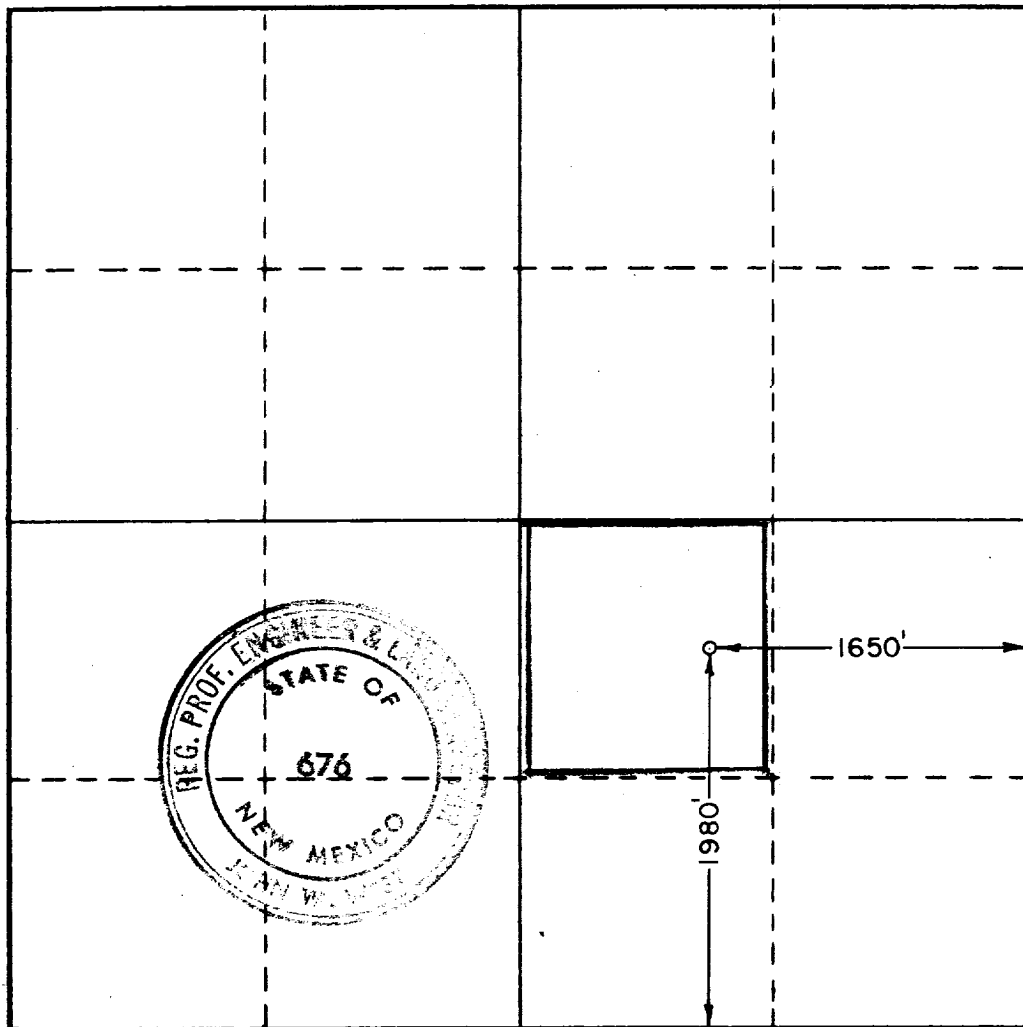

CERTIFICATION

I hereby certify that the information contained herein is true and complete to the best of my knowledge and belief.

Name *Leon M. Lampert*

Position **Geologist**

Company **Dalport Oil Corp**

Date **2-20-70**

I hereby certify that the well location shown on this plat was plotted from field notes of actual surveys made by me or under my supervision, and that the same is true and correct to the best of my knowledge and belief.

Date Surveyed **FEBRUARY 17, 1970**

Registered Professional Engineer and/or Land Surveyor

*John W. West*

Certificate No. **676**

