

UNITED STATES  
DEPARTMENT OF THE INTERIOR  
GEOLOGICAL SURVEY30-005-60621  
5. LEASE DESIGNATION AND SERIAL NO.  
LC 069280-A

## APPLICATION FOR PERMIT TO DRILL, DEEPEN, OR PLUG BACK

## 1a. TYPE OF WORK

DRILL ☒DEEPEN ☐PLUG BACK ☐

## b. TYPE OF WELL

OIL  
WELL ☒GAS  
WELL ☐OTHER ☐

APR 23 1970

SINGLE  
ZONE ☐MULTIPLE  
ZONE ☐

## 2. NAME OF OPERATOR

JACK L. McCLELLAN

O. C. C.

## 3. ADDRESS OF OPERATOR

ARTESIA, OFFICE

Box 848, ROSWELL, NEW MEXICO 88201

## 4. LOCATION OF WELL (Report location clearly and in accordance with any State laws.)

At surface

At proposed prod. zone

330' FSL &amp; 990' FWL

## 14. DISTANCE IN MILES AND DIRECTION FROM NEAREST TOWN OR POST OFFICE\*

20 MILES NORTH OF LOCO HILLS

## 15. DISTANCE FROM PROPOSED\*

LOCATION TO NEAREST  
PROPERTY OR LEASE LINE, FT.  
(Also to nearest drig. unit line, if any)

660'

## 16. NO. OF ACRES IN LEASE

800

17. NO. OF ACRES ASSIGNED  
TO THIS WELL

40 ACRES

18. DISTANCE FROM PROPOSED LOCATION\*  
TO NEAREST WELL, DRILLING, COMPLETED,  
OR APPLIED FOR, ON THIS LEASE, FT.

## 19. PROPOSED DEPTH

2050'

## 20. ROTARY OR CABLE TOOLS

CABLE TOOLS

## 21. ELEVATIONS (Show whether DF, RT, GR, etc.)

3938' GL

## 22. APPROX. DATE WORK WILL START\*

APRIL 23, 1970

## 23. PROPOSED CASING AND CEMENTING PROGRAM

| SIZE OF HOLE | SIZE OF CASING | WEIGHT PER FOOT | SETTING DEPTH | QUANTITY OF CEMENT |
|--------------|----------------|-----------------|---------------|--------------------|
| 10 1/2"      | 8 5/8"         | 20 LB.          | 420'          | 50 SX              |
| 8"           | 5 1/2"         | 14 LB.          | 2050'         | 150 SX             |

WILL DRILL TO 2050' WITH CABLE TOOLS TO TEST THE QUEEN SAND SECTION.

IF PRODUCTION IS INDICATED, WILL SET PIPE, PERFORATE AND FRACTURE  
TREAT.

CORTEZ DRILLING AND OPERATING COMPANY, Box 848, ROSWELL, N.M.

WILL BE THE CONTRACTOR.

IN ABOVE SPACE DESCRIBE PROPOSED PROGRAM: If proposal is to deepen or plug back, give data on present productive zone and proposed new productive zone. If proposal is to drill or deepen directionally, give pertinent data on subsurface locations and measured and true vertical depths. Give blowout preventer program, if any.

24.

SIGNED

(This space for Federal or State office use)

TITLE

OPERATOR

DATE

4/20/70

PERMIT NO.

APPROVAL DATE

APPROVED  
H. L. BECKMAN  
ACTING SUPERVISORTHIS APPROVAL IS RESCINDED IF OPERATIONS  
ARE NOT COMMENCED WITHIN 3 MONTHS.  
EXPIRES JUL 26 1970

\*See Instructions On Reverse Side

N MEXICO OIL CONSERVATION COMMISS.  
WELL LOCATION AND ACREAGE DEDICATION PLAT

Form C-102  
Supersedes C-128  
Effective 1-1-65

All distances must be from the outer boundaries of the Section.

|  |                                      |                             |                                       |                         |                        |
|--|--------------------------------------|-----------------------------|---------------------------------------|-------------------------|------------------------|
| Operator<br><b>Jack L. McClellan</b>   |                                      |                             | Lease<br><b>Line "A" Federal</b>      |                         | Well No.<br><b>922</b> |
| Unit Letter<br><b>M</b>  | Section<br><b>13</b>                 | Township<br><b>15 South</b> | Range<br><b>29 East</b>               | County<br><b>Quevas</b> |                        |
| Actual Footage Location of Well:<br><b>330</b> feet from the <b>South</b> line and <b>990</b> feet from the <b>West</b> line |                                      |                             |                                       |                         |                        |
| Ground Level Elev.<br><b>3922</b>  | Producing Formation<br><b>Quevas</b> | Pool<br><b>Sulmar Queen</b> | Dedicated Acreage:<br><b>40</b> Acres |                         |                        |

1. Outline the acreage dedicated to the subject well by colored pencil or hachure marks on the plat below.
2. If more than one lease is dedicated to the well, outline each and identify the ownership thereof (both as to working interest and royalty).
3. If more than one lease of different ownership is dedicated to the well, have the interests of all owners been consolidated by communitization, unitization, force-pooling, etc?

**RECEIVED**

**APR 21 1970**

☐ Yes ☐ No If answer is "yes," type of consolidation \_\_\_\_\_

If answer is "no," list the owners and tract descriptions which have actually been consolidated (Use reverse side of this form if necessary.) \_\_\_\_\_

No allowable will be assigned to the well until all interests have been consolidated (by communitization, unitization, forced-pooling, or otherwise) or until a non-standard unit, eliminating such interests, has been approved by the Commission.

**P 29 E**

**13**

**990'** **9-A**  
**330'**

**CERTIFICATION**

I hereby certify that the information contained herein is true and complete to the best of my knowledge and belief.

Name  
**James H. Brown**

Position  
**Agent**

Company  
**Jack L. McClellan**

Date  
**April 20th 1970**

I hereby certify that the well location shown on this plat was plotted from field notes of actual surveys made by me or under my supervision, and that the same is true and correct to the best of my knowledge and belief.

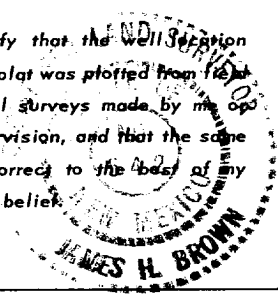

Date Surveyed  
**April 20th 1970**

Registered Professional Engineer and/or Land Surveyor

**James H. Brown**

Certificate No.  
**542**

