

NO. OF COPIES RECEIVED	6
DISTRIBUTION	
SANTA FE	1
FILE	1
U.S.G.S.	2
LAND OFFICE	1
OPERATOR	1

NEW MEXICO OIL CONSERVATION COMMISSION

30-005-60148
Form C-101
Revised 1-1-65

5A. Indicate Type of Lease	
STATE <input checked="" type="checkbox"/>	FEE <input type="checkbox"/>
5. State Oil & Gas Lease No. L-3686	

O & C
ARTESIAN OFFICE

APPLICATION FOR PERMIT TO DRILL, DEEPEN, OR PLUG BACK

1a. Type of Work		7. Unit Agreement Name	
b. Type of Well DRILL <input checked="" type="checkbox"/> DEEPEN <input type="checkbox"/> PLUG BACK <input type="checkbox"/> OIL WELL <input type="checkbox"/> GAS WELL <input checked="" type="checkbox"/> OTHER <input type="checkbox"/> SINGLE ZONE <input checked="" type="checkbox"/> MULTIPLE ZONE <input type="checkbox"/>		8. Farm or Lease Name New Mexico "V" State	
2. Name of Operator Midwest Oil Corporation		9. Well No. 1	
3. Address of Operator 1500 Wilco Bldg., Midland, Texas 79701		10. Field and Pool, or Wildcat <i>Buffalo Valley Penn.</i>	
4. Location of Well UNIT LETTER 0 LOCATED 990 FEET FROM THE South LINE 1650 FEET FROM THE East LINE OF SEC. 6 TWP. 15-S RGE. 28-E NMPM		12. County Chaves	
19. Proposed Depth 8800'		19A. Formation Atoka	
20. Rotary or C.T. Rotary		21. Elevations (Show whether DF, RT, etc.) 3536.6 GR	
21A. Kind & Status Plug. Bond Active		21B. Drilling Contractor Unknown	
22. Approx. Date Work will start 11-8-70			

23.

PROPOSED CASING AND CEMENT PROGRAM

SIZE OF HOLE	SIZE OF CASING	WEIGHT PER FOOT	SETTING DEPTH	SACKS OF CEMENT	EST. TOP
15"	11 3/4"	31.2	350	350	Circulated
11"	8 5/8"	24 & 32	1700	600	
7 7/8"	4 1/2"	10.5 & 11.6	8800	300	

APPROVAL VALID
FOR 90 DAYS UNLESS
DRILLING COMMENCED,
EXPIRES **2-9-71**

IN ABOVE SPACE DESCRIBE PROPOSED PROGRAM: IF PROPOSAL IS TO DEEPEN OR PLUG BACK, GIVE DATA ON PRESENT PRODUCTIVE ZONE AND PROPOSED NEW PRODUCTIVE ZONE. GIVE BLOWOUT PREVENTER PROGRAM, IF ANY.

I hereby certify that the information above is true and complete to the best of my knowledge and belief.

Signed Carolyn Turner Title Production Clerk Date 11-6-70
(This space for State Use)

APPROVED BY W. A. Gressett TITLE OIL AND GAS INSPECTOR DATE NOV 9 1970

CONDITIONS OF APPROVAL, IF ANY:

use adequate Blowout Preventer

Cement must be circulated
surface behind 11 3/4" casing

N MEXICO OIL CONSERVATION COMMISS
WELL LOCATION AND ACREAGE DEDICATION PLAT

Form C-102
 Supersedes C-128
 Effective 1-1-65

All distances must be from the outer boundaries of the Section.

Operator MIDWEST OIL CORP.			Lease <i>New Mexico V State Com</i> STATE <u>NV</u>		Well No. 1
Unit Letter O	Section 6	Township 15 SOUTH	Range 28 EAST	County CHAVES	
Actual Footage Location of Well: 990 feet from the SOUTH line and 1650 feet from the EAST line					
Ground Level Elev. 3536.6	Producing Formation Achoa	Pool <i>und. Buffalo Valley Penn.</i>	Dedicated Acreage: <i>321.17</i> 2/2 320 Acres		

1. Outline the acreage dedicated to the subject well by colored pencil or hatchure marks on the plat below.
2. If more than one lease is dedicated to the well, outline each and identify the ownership thereof (both as to working interest and royalty).
3. If more than one lease of different ownership is dedicated to the well, have the interests of all owners been consolidated by communitization, unitization, force-pooling, etc?

☒ Yes ☐ No If answer is "yes," type of consolidation Communitization

If answer is "no," list the owners and tract descriptions which have actually been consolidated. (Use reverse side of this form if necessary.) _____

No allowable will be assigned to the well until all interests have been consolidated (by communitization, unitization, forced-pooling, or otherwise) or until a non-standard unit, eliminating such interests, has been approved by the Commission.

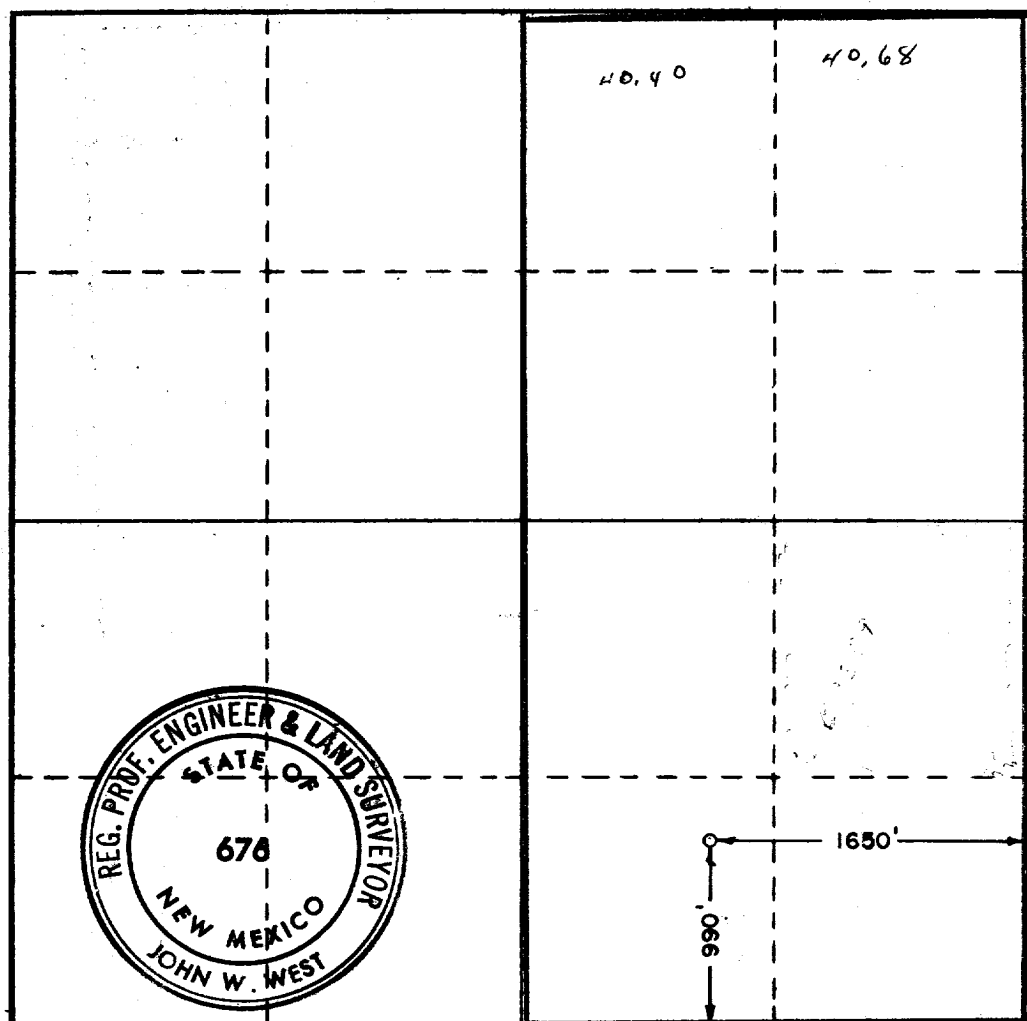

CERTIFICATION

I hereby certify that the information contained herein is true and complete to the best of my knowledge and belief.

Carolyn Turner
 Name
Carolyn Turner
 Position
Production Clerk
 Company
Midwest Oil Corporation
 Date
11-4-70

I hereby certify that the well location shown on this plat was plotted from field notes of actual surveys made by me or under my supervision, and that the same is true and correct to the best of my knowledge and belief.

Date Surveyed
Nov. 3, 1970
 Registered Professional Engineer and/or Land Surveyor
John W. West
 Certificate No. **676**

