

NO. OF COPIES RECEIVED	6
DISTRIBUTION	
SANTA FE	
FILE	
U.S.G.S.	
LAND OFFICE	
OPERATOR	

RECEIVED
NEW MEXICO OIL CONSERVATION COMMISSION
JUL 26 1971
O. C. C.
ARTESIA, OFFICE

30-CCS-60185
Form C-101
Revised 1-1-65

5A. Indicate Type of Lease STATE <input checked="" type="checkbox"/> FEE <input type="checkbox"/>
5. State Oil & Gas Lease No. L-3889

APPLICATION FOR PERMIT TO DRILL, DEEPEN, OR PLUG BACK

1a. Type of Work b. Type of Well OIL WELL <input checked="" type="checkbox"/> GAS WELL <input type="checkbox"/> OTHER <input type="checkbox"/> SINGLE ZONE <input checked="" type="checkbox"/> MULTIPLE ZONE <input type="checkbox"/>		2. Name of Operator Continental Oil Company		7. Unit Agreement Name	
3. Address of Operator Box 460 Hobbs, New Mexico		8. Farm or Lease Name State NN		9. Well No. 1	
4. Location of Well UNIT LETTER H LOCATED 23 1/2 FEET FROM THE North LINE AND 330 FEET FROM THE East LINE OF SEC. 22 TWP. 16S RGE. 18E NMPM		10. Field and Pool, or Wildcat Wildcat		12. County Chaves	
21. Elevations (Show whether DF, RT, etc.) 5100' ext. gr		21A. Kind & Status Plug. Bond Blanket Bond		19. Proposed Depth 5500'	
21B. Drilling Contractor N/A		19A. Formation Granite		20. Rotary or C.T. Rotary	
22. Approx. Date Work will start Aug 15, 1971		23. PROPOSED CASING AND CEMENT PROGRAM			

SIZE OF HOLE	SIZE OF CASING	WEIGHT PER FOOT	SETTING DEPTH	SACKS OF CEMENT	EST. TOP
15"	11 3/4"	42#	1100'	625 SKS	Circ
* 11"	8 5/8"	24#	2900'	300 SKS	1500'
7 3/8"	5 1/2"	14#	5500'	300 SKS	4000'

It is proposed to drill a straight hole to 5500' and complete if commercial shows are obtained.

* 8 5/8" casing will be run only if lost circulation occurs.

APPROVAL VALID
FOR 90 DAYS UNLESS
DRILLING COMMENCED,

EXPIRES 10-26-71

IN ABOVE SPACE DESCRIBE PROPOSED PROGRAM: IF PROPOSAL IS TO DEEPEN OR PLUG BACK, GIVE DATA ON PRESENT PRODUCTIVE ZONE AND PROPOSED NEW PRODUCTIVE ZONE. GIVE BLOWOUT PREVENTER PROGRAM, IF ANY.

I hereby certify that the information above is true and complete to the best of my knowledge and belief.

Signed [Signature] Title Admin Supervisor Date 7-23-71

(This space for State Use)

APPROVED BY W. A. Gressett TITLE OIL AND GAS DATE JUL 26 1971

CONDITIONS OF APPROVAL, IF ANY:

NMCCC - Artesia (5) File the 11 3/4" casing

Cement must be circulated to surface behind 11 3/4" casing

NEW MEXICO OIL CONSERVATION COMMISSION
WELL LOCATION AND ACREAGE DEDICATION PLAT

Form C-102
Supersedes C-128
Effective 1-1-65

All distances must be from the outer boundaries of the Section.

Operator CONTINENTAL OIL COMPANY		Lease STATE NN		Well No. 1
Unit Letter H	Section 22	Township 16 SOUTH	Range 18 EAST	County CHAVES
Actual Footage Location of Well: 2310 feet from the NORTH line and 330 feet from the EAST line				
Ground Level Elev. 5100' est	Producing Formation Phonite	Pool Wildcat	Dedicated Acreage: 40 Acres	

- Outline the acreage dedicated to the subject well by colored pencil or hachure marks on the plat below.
- If more than one lease is dedicated to the well, outline each and identify the ownership thereof (both as to working interest and royalty).
- If more than one lease of different ownership is dedicated to the well, have the interests of all owners been consolidated by communitization, unitization, force-pooling, etc?

☐ Yes ☐ No If answer is "yes," type of consolidation _____

If answer is "no," list the owners and tract descriptions which have actually been consolidated. (Use reverse side of this form if necessary.) _____

No allowable will be assigned to the well until all interests have been consolidated (by communitization, unitization, forced-pooling, or otherwise) or until a non-standard unit, eliminating such interests, has been approved by the Commission.

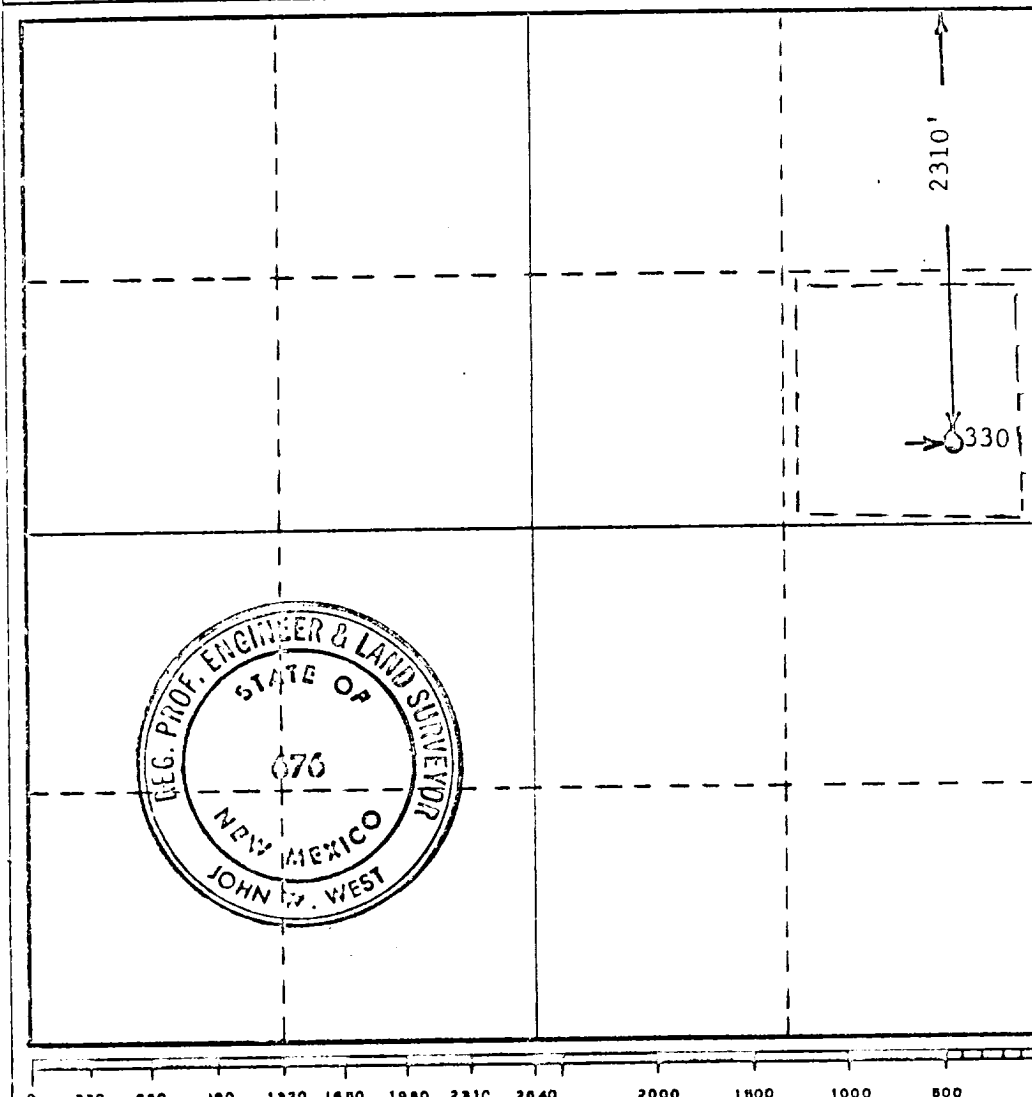

CERTIFICATION

I hereby certify that the information contained herein is true and complete to the best of my knowledge and belief.

Name John W. West
Position Admin Supervisor
Company Continental Oil Co
Date July 23, 1971

I hereby certify that the well location shown on this plat was plotted from field notes of actual surveys made by me or under my supervision, and that the same is true and correct to the best of my knowledge and belief.

Date Surveyed
7-21-1971

Registered Professional Engineer
and/or Land Surveyor

John W. West
Certificate No. **676**