

UNITED STATES
DEPARTMENT OF THE INTERIOR
BUREAU OF LAND MANAGEMENT

APPLICATION FOR PERMIT TO DRILL, DEEPEN, OR PLUG BACK

1a. TYPE OF WORK

DRILL ☐

DEEPEN ☐

PLUG BACK ☐

b. TYPE OF WELL

OIL
WELL ☐

GAS
WELL ☒

OTHER RE-ENTER

SINGLE
ZONE ☒

MULTIPLE
ZONE ☐

2. NAME OF OPERATOR

PRIMERO OPERATING, INC.

3. ADDRESS OF OPERATOR

P. O. BOX 1433, ROSWELL NM 88202-1433

4. LOCATION OF WELL (Report location clearly and in accordance with any State requirements.)*

At surface

1650' FSL & 990' FEL

At proposed prod. zone

5. LEASE DESIGNATION AND SERIAL NO.

NM-92754

6. IF INDIAN, ALLOTTEE OR TRIBE NAME

7. UNIT AGREEMENT NAME

8. FARM OR LEASE NAME

FAJITA FEDERAL COM

9. WELL NO.

1

10. FIELD AND POOL, OR WILDCAT

Buffalo Valley, Atoka

11. SEC. T. R. M., OR BLK.
AND SURVEY OR AREA

10-T15S-R27E

12. COUNTY OR PARISH

13. STATE

Chaves

NM

15. DISTANCE FROM PROPOSED*

LOCATION TO NEAREST
PROPERTY OR LEASE LINE, FT.
(Also to nearest drlg. unit line, if any)

990

16. NO. OF ACRES IN LEASE

320

17. NO. OF ACRES ASSIGNED
TO THIS WELL

320

18. DISTANCE FROM PROPOSED LOCATION*
TO NEAREST WELL, DRILLING, COMPLETED,
OR APPLIED FOR, ON THIS LEASE, FT.

None

19. PROPOSED DEPTH

8430

20. ROTARY OR CABLE TOOLS

Rotary

21. ELEVATIONS (Show whether DF, RT, GR, etc.)

3463 GR

22. APPROX. DATE WORK WILL START*

March 31, 1994

23.

PROPOSED CASING AND CEMENTING PROGRAM

| SIZE OF HOLE | SIZE OF CASING | WEIGHT PER FOOT | SETTING DEPTH | QUANTITY OF CEMENT |
|--------------|----------------|-----------------|---------------|--------------------|
| 17 1/2" | 12-3/4" | 43# | 328 | 370 sx |
| 12 1/4" | 8-5/8" | 24# | 1642-1557 | 350 sx |
| 7-7/8" | 5 1/2 or 4 1/2 | 17# or 11.6# | 8430' | 200 sx |

We propose to re-enter the dry hole drilled by BTA in August, 1981 known as the "7109 JV-D Atoka #1". We will drill out the plugs at surface, 1457, 2900, 4800, 6400 and 8000', then clean the hole out to 8430'. 4 1/2" or 5 1/2" casing will be run and cemented with enough cement to cover 1500' of casing. We then propose to perforate the Atoka pay and frac. If commercial pay is discovered, we will run a pipeline to a gathering system. If the hole is dry, we will plug and abandon the well following BLM and NMOCD rules and regulations.

Attachments:

NMOCD C-102 Form; BOP Diagram; Well Diagram; Items of pertinent information; Multiple Surface Use Plan

Former: BTA - Atoka 7109 JV-D #1
OTD-8430 PFA 9-18-71

IN ABOVE SPACE DESCRIBE PROPOSED PROGRAM: If proposal is to deepen or plug back, give data on present productive zone and proposed new productive zone. If proposal is to drill or deepen directionally, give pertinent data on subsurface locations and measured and true vertical depths. Give blowout preventer program, if any.

24.

SIGNED

TITLE

DATE

(This space for Federal or State office use)

PERMIT NO.

APPROVAL DATE

APPROVED BY

TITLE

DATE

CONDITIONS OF APPROVAL, IF ANY:

*See Instructions On Reverse Side

Title 18 U.S.C. Section 1001, makes it a crime for any person knowingly and willfully to make to any department or agency of the United States any false, fictitious or fraudulent statements or representations as to any matter within its jurisdiction.



NEW MEXICO OIL CONSERVATION COMMISSION
 WELL LOCATION AND ACREAGE DEDICATION PLAT

Form C-102
 Supersedes C-128
 Effective 1-1-65

All distances must be from the outer boundaries of the Section.

| | | | | | |
|--|-------------------------------------|----------------------------|----------------------------------|-------------------------|--|
| Operator Primero Operating, Inc. | | | Lease Fajita Fed. Com. | | Well No. 1 |
| Unit Letter I | Section 10 | Township 15-S | Range 27-E | County Chaves | |
| Actual Footage Location of Well: | | | | | |
| 1650 | | feet from the South | line and | 990 | feet from the East line |
| Ground Level Elev. 3463 | Producing Formation Atoka | | Pool Buffalo Valley | | Dedicated Acreage: 320 Acres |

1. Outline the acreage dedicated to the subject well by colored pencil or hatchure marks on the reverse side of this form.
2. If more than one lease is dedicated to the well, outline each and identify the owner, interest, and royalty.
3. If more than one lease of different ownership is dedicated to the well, have the interests consolidated by communitization, unitization, force-pooling, etc?

☒ Yes ☐ No If answer is "yes," type of consolidation Communitization

If answer is "no," list the owners and tract descriptions which have actually been consolidated (use reverse side of this form if necessary.)

No allowable will be assigned to the well until all interests have been consolidated (by communitization, unitization, forced-pooling, or otherwise) or until a non-standard unit, eliminating such interests, has been approved by the Commission.

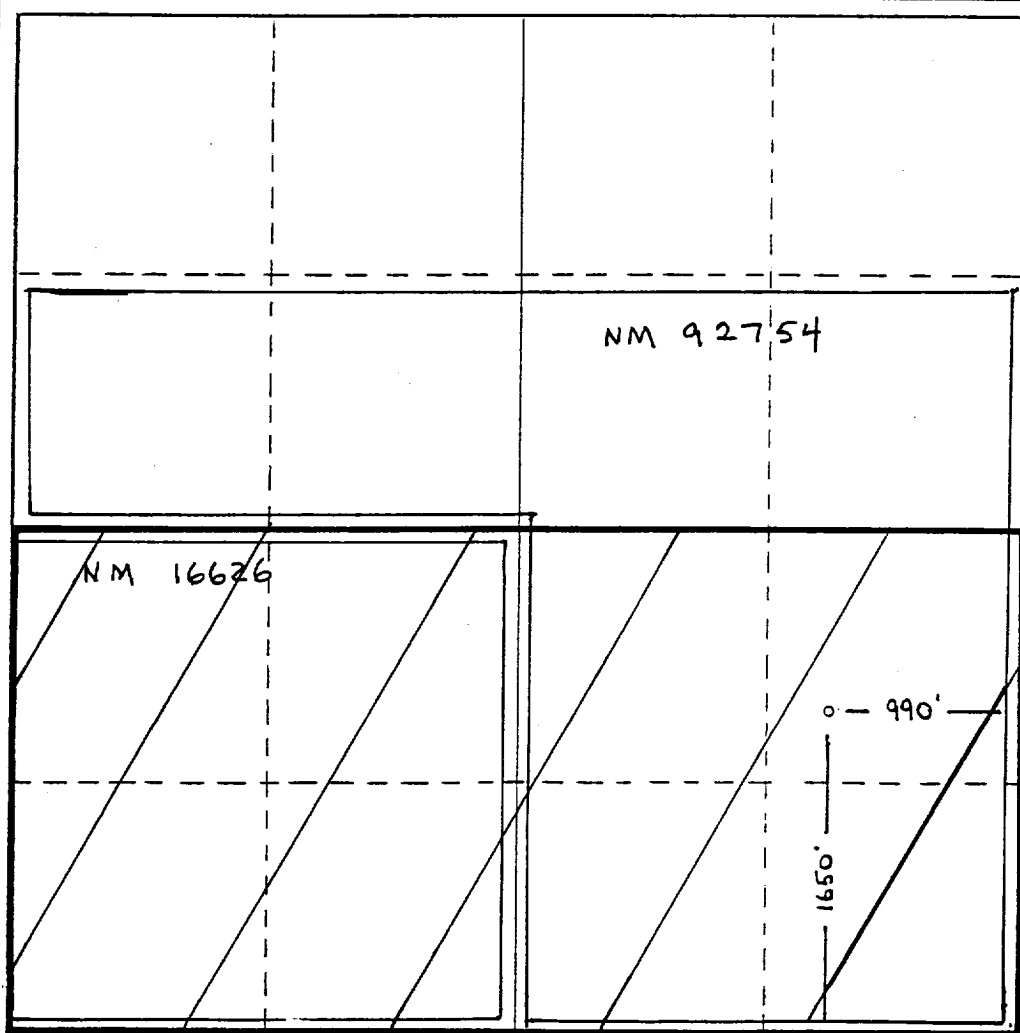
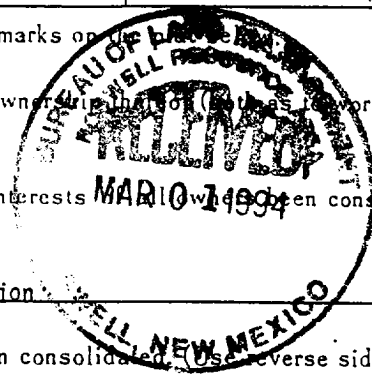

CERTIFICATION

I hereby certify that the information contained herein is true and complete to the best of my knowledge and belief.

Name
Phelps White
 Position
President
 Company
Primero Operating, Inc.
 Date
02/14/94

I hereby certify that the well location shown on this plat was plotted from field notes of actual surveys made by me or under my supervision, and that the same is true and correct to the best of my knowledge and belief.

Date Surveyed
August 4, 1971
 Registered Professional Engineer and/or Land Surveyor
 Previously Surveyed by
Max A. Schumann

Certificate No.
1510

0 330 660 990 1320 1650 1980 2310 2640 2000 1500 1000 500 0