

NO. OF COPIES RECEIVED	
DISTRIBUTION	
SANTA FE	
FILE	
U.S.G.S.	
LAND OFFICE	
OPERATOR	

**RECEIVED**  
NEW MEXICO OIL CONSERVATION COMMISSION  
OCT 18 1971

**O. C. C.**  
ARTESIA, OFFICE

30-005-60197  
Form C-101  
Revised 1-1-65

5A. Indicate Type of Lease	
STATE <input checked="" type="checkbox"/>	FEE <input type="checkbox"/>
5. State Oil & Gas Lease No.	
K-6772	

**APPLICATION FOR PERMIT TO DRILL, DEEPEN, OR PLUG BACK**

1a. Type of Work		7. Unit Agreement Name	
b. Type of Well OIL WELL <input checked="" type="checkbox"/> GAS WELL <input type="checkbox"/> OTHER <input type="checkbox"/>		8. Farm or Lease Name	
DEEPEN <input type="checkbox"/> PLUG BACK <input type="checkbox"/>		Sun - State	
2. Name of Operator		9. Well No.	
ROARK & HOOKER		1	
3. Address of Operator		10. Field and Pool, or Wildcat	
P. O. Box 2708, Abilene, Texas 79604		Double "L" (Queen)	
4. Location of Well		12. County	
UNIT LETTER <u>L</u> LOCATED <u>330</u> FEET FROM THE <u>West</u> LINE		Chaves	
AND <u>1650</u> FEET FROM THE <u>South</u> LINE OF SEC. <u>24</u> TWP. <u>14-S</u> RGE. <u>29-E</u> NMPM			
21. Elevations (Show whether DF, RT, etc.)		19. Proposed Depth	
3795.5 ft.		2050	
21A. Kind & Status Plug. Bond		19A. Formation	
1 well		Queen Sand	
21B. Drilling Contractor		20. Rotary or C.T.	
Poole Drilling Co.		C.T.	
22. Approx. Date Work will start			
Immediately			

**PROPOSED CASING AND CEMENT PROGRAM**

SIZE OF HOLE	SIZE OF CASING	WEIGHT PER FOOT	SETTING DEPTH	SACKS OF CEMENT	EST. TOP
10 1/4"	8-5/8"	24#	300'	300 sacks	Cir.
8"	5-1/2"	15.5#	2050'	150 sacks	

**APPROVAL VALID  
FOR 90 DAYS UNLESS  
DRILLING COMMENCED,  
EXPIRES 1-22-72**

IN ABOVE SPACE DESCRIBE PROPOSED PROGRAM; IF PROPOSAL IS TO DEEPEN OR PLUG BACK, GIVE DATA ON PRESENT PRODUCTIVE ZONE AND PROPOSED NEW PRODUCTIVE ZONE, GIVE BLOWOUT PREVENTER PROGRAM, IF ANY.

I hereby certify that the information above is true and complete to the best of my knowledge and belief.

Signed [Signature] Title Operator Date October 15, 1971  
(This space for State Use)

APPROVED BY W. A. Gressett TITLE OIL AND GAS INSPECTOR DATE OCT 22 1971  
CONDITIONS OF APPROVAL, IF ANY:

NEW MEXICO OIL CONSERVATION COMMISS. .1  
WELL LOCATION AND ACREAGE DEDICATION PLAT

Form C-102  
Supersedes C-128  
Effective 1-1-65

All distances must be from the outer boundaries of the Section.

Operator <b>ROARK &amp; HOOKER</b>			Lease <b>SUN STATE</b>		Well No. <b>1</b>
Unit Letter <b>L</b>	Section <b>24</b>	Township <b>14 SOUTH</b>	Range <b>29 EAST</b>	County <b>CHAVES</b>	
Actual Footage Location of Well: <b>1650</b> feet from the <b>SOUTH</b> line and <b>330</b> feet from the <b>WEST</b> line					
Ground Level Elev. <b>3795.5</b>	Producing Formation <i>Queen</i>		Pool <i>and</i> <i>Double L Queen</i>		Dedicated Acreage: <b>40</b> Acres

1. Outline the acreage dedicated to the subject well by colored pencil or hachure marks on the plat below.
2. If more than one lease is dedicated to the well, outline each and identify the ownership thereof (both as to working interest and royalty).
3. If more than one lease of different ownership is dedicated to the well, have the interests of all owners been consolidated by communitization, unitization, force-pooling, etc?

☐ Yes ☐ No If answer is "yes," type of consolidation \_\_\_\_\_

If answer is "no," list the owners and tract descriptions which have actually been consolidated. (Use reverse side of this form if necessary.) \_\_\_\_\_

No allowable will be assigned to the well until all interests have been consolidated (by communitization, unitization, forced-pooling, or otherwise) or until a non-standard unit, eliminating such interests, has been approved by the Commission.

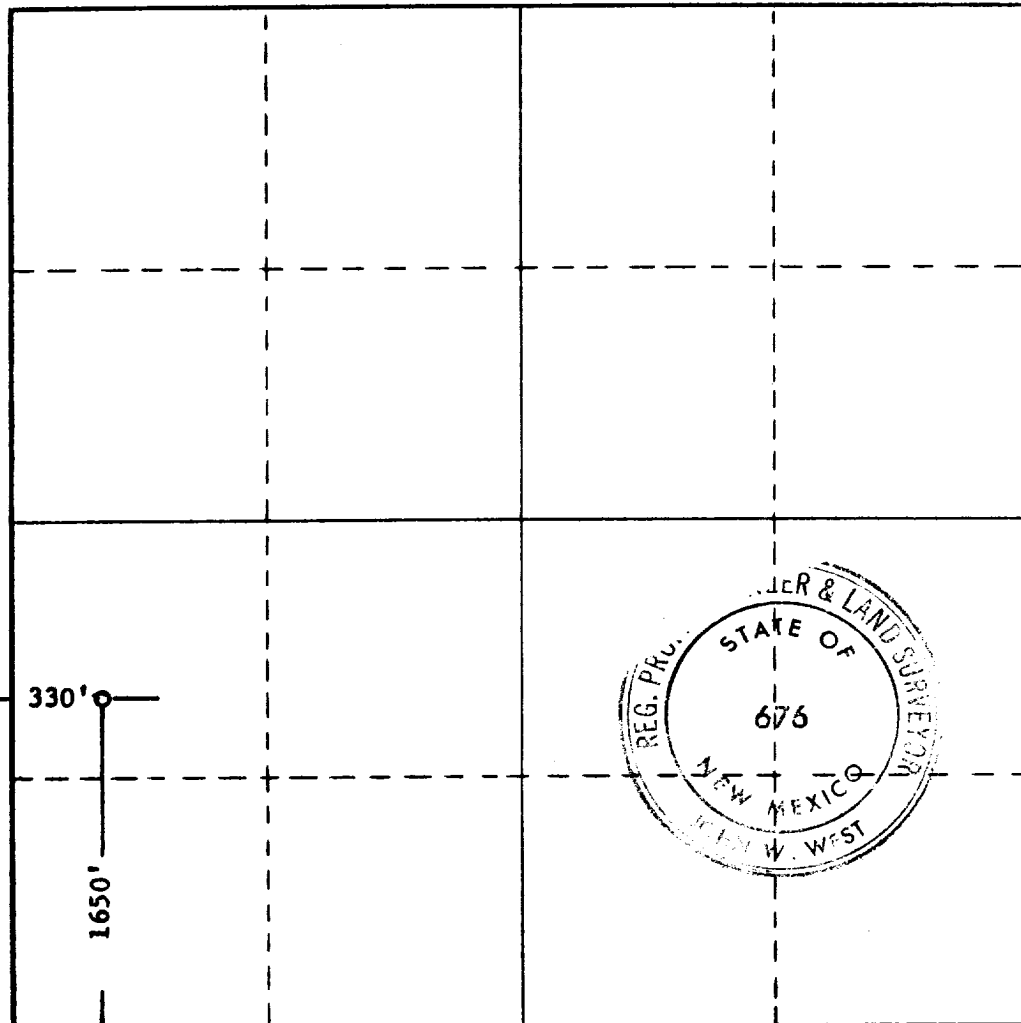

CERTIFICATION

I hereby certify that the information contained herein is true and complete to the best of my knowledge and belief.

Name *L. F. Hooker*  
**L. F. HOOKER**

Position  
**Partner**

Company  
**ROARK & HOOKER**

Date  
**October 15, 1971**

I hereby certify that the well location shown on this plat was plotted from field notes of actual surveys made by me or under my supervision, and that the same is true and correct to the best of my knowledge and belief.

Date Surveyed  
**10-13-1971**

Registered Professional Engineer and/or Land Surveyor

*John W. West*  
Certificate No. **676**