

UNITED STATES
DEPARTMENT OF THE INTERIOR
GEOLOGICAL SURVEYAPPLICATION FOR PERMIT ~~TO DRILL, DEEPEN~~ OR PLUG BACK

1a. TYPE OF WORK
DRILL ☒ DEEPEN ☐ PLUG BACK ☐
MAR 1 1972

b. TYPE OF WELL
OIL WELL ☒ GAS WELL ☐ OTHER ☐
SINGLE ZONE ☒ MULTIPLE ZONE ☐

2. NAME OF OPERATOR
Yates Petroleum Corporation

3. ADDRESS OF OPERATOR
207 South Fourth Street - Artesia, New Mexico 88210

4. LOCATION OF WELL (Report location clearly and in accordance with any State requirements.)*
At surface 330' FNL & 330' FEL of Sec. 34-15S-29E
At proposed prod. zone

14. DISTANCE IN MILES AND DIRECTION FROM NEAREST TOWN OR POST OFFICE*
23 miles east of Hagerman, N.M.

15. DISTANCE FROM PROPOSED*
LOCATION TO NEAREST
PROPERTY OR LEASE LINE, FT.
(Also to nearest drlg. unit line, if any) 330'

16. NO. OF ACRES IN LEASE
880

17. NO. OF ACRES ASSIGNED
TO THIS WELL
40

18. DISTANCE FROM PROPOSED LOCATION*
TO NEAREST WELL, DRILLING, COMPLETED,
OR APPLIED FOR, ON THIS LEASE, FT. 2330'

19. PROPOSED DEPTH
2050'

20. ROTARY OR CABLE TOOLS
Cable Tools

21. ELEVATIONS (Show whether DF, RT, GR, etc.)
3836' GR

22. APPROX. DATE WORK WILL START*
March 3, 1972

23. PROPOSED CASING AND CEMENTING PROGRAM				
SIZE OF HOLE	SIZE OF CASING	WEIGHT PER FOOT	SETTING DEPTH	QUANTITY OF CEMENT
10 1/4"	8 5/8"	20#	300'	150 SX
8"	7" & 5 1/2"	20# & 15.5#	2050'	50 SX

Propose to test the Queen Sand to a depth of approx. 2050' and if commercial to run tapered 7" and 5 1/2" casing.

IN ABOVE SPACE DESCRIBE PROPOSED PROGRAM: If proposal is to deepen or plug back, give data on present productive zone and proposed new productive zone. If proposal is to drill or deepen directionally, give pertinent data on subsurface locations and measured and true vertical depths. Give blowout preventer program, if any.

24. SIGNED William H. Hays ENGINEER DATE 2-29-72
(This space for Federal or State office use)

PERMIT NO. _____ APPROVAL DATE FEB 29 1972
APPROVED BY James R. Smith TITLE DISTRICT ENGINEER DATE FEB 29 1972
CONDITIONS OF APPROVAL, IF ANY:

N MEXICO OIL CONSERVATION COMMISSION
WELL LOCATION AND ACREAGE DEDICATION PLAT

Form C-102
Supersedes C-128
Effective 1-1-65

All distances must be from the outer boundaries of the Section.

Operator YATES PETROLEUM CORPORATION			Lease FEDERAL "CL"		Well No. 1
Unit Letter A	Section 34	Township 15 South	Range 29 East	County Chaves	
Actual Footage Location of Well: 330 feet from the North line and 330 feet from the East line					
Ground Level Elev. 3836	Producing Formation QUEEN SAND	Pool Sullimar <i>Sullimar Queen</i>		Dedicated Acreage: 40 Acres	

1. Outline the acreage dedicated to the subject well by colored pencil or hachure marks on the plat below.
2. If more than one lease is dedicated to the well, outline each and identify the ownership thereof (both as to working interest and royalty).
3. If more than one lease of different ownership is dedicated to the well, have the interests of all owners been consolidated by communitization, unitization, force-pooling, etc?

☐ Yes ☐ No If answer is "yes," type of consolidation _____

If answer is "no," list the owners and tract descriptions which have actually been consolidated. (Use reverse side of this form if necessary.) _____

No allowable will be assigned to the well until all interests have been consolidated (by communitization, unitization, forced-pooling, or otherwise) or until a non-standard unit, eliminating such interests, has been approved by the Commission.

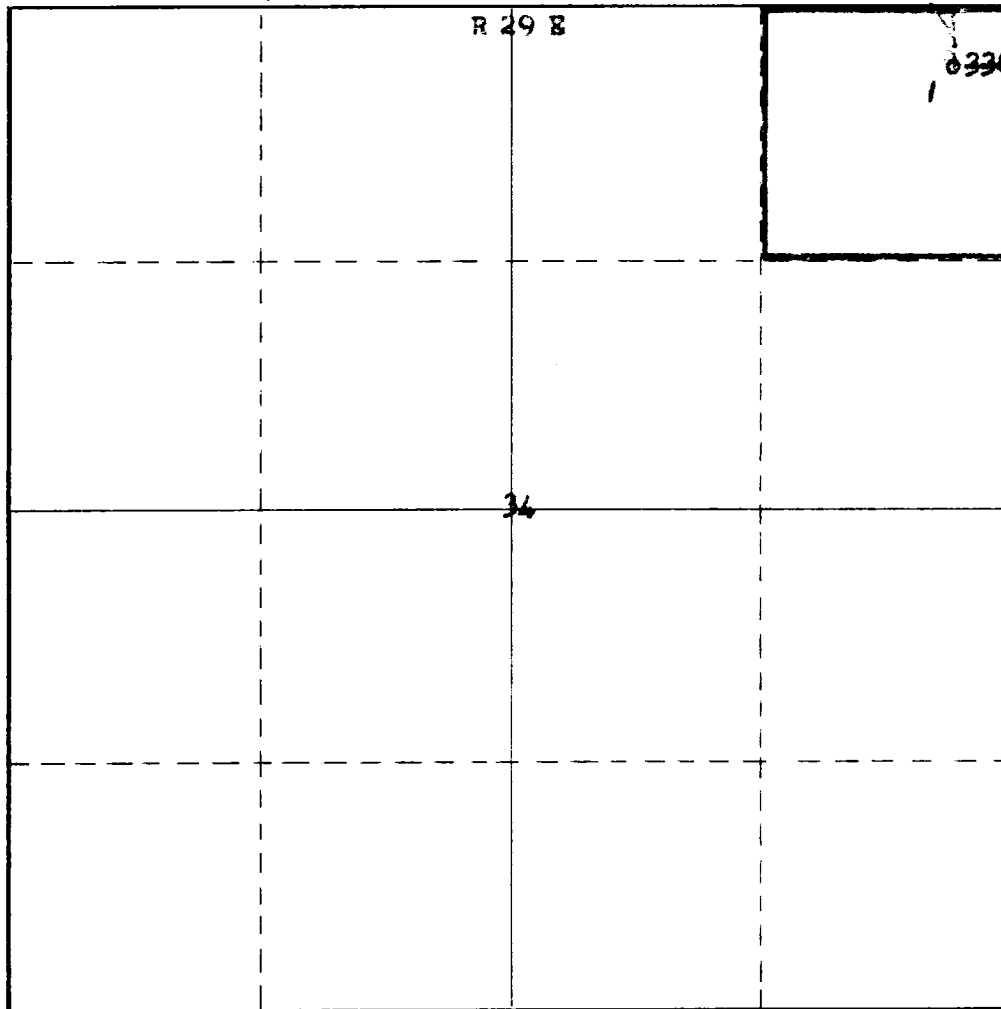

CERTIFICATION

I hereby certify that the information contained herein is true and complete to the best of my knowledge and belief.

Eddie M. Mahfood

Name

Eddie M. Mahfood

Position

Engineer

Company

Yates Pet. Corporation

Date

2-29-72

I hereby certify that the well location shown on this plat was obtained from field notes of **1968** surveys made by me or under my supervision and that the same is true and correct to the best of my knowledge and belief.

Date Surveyed

February 24th, 1972

Registered Professional Engineer and/or Land Surveyor

James H. Brown

Certificate No.

542

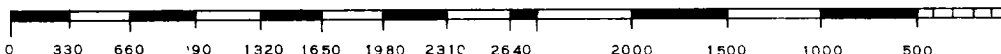

T
15
S