

UNITED STATES  
DEPARTMENT OF THE INTERIOR  
GEOLOGICAL SURVEY

## APPLICATION FOR PERMIT TO DRILL, DEEPEN, OR PLUG BACK

## 1a. TYPE OF WORK

DRILL ☒DEEPEN ☐PLUG BACK ☐

## b. TYPE OF WELL

OIL  
WELL ☒GAS  
WELL ☐

OTHER

SINGLE  
ZONE ☒MULTIPLE  
ZONE ☐

## 2. NAME OF OPERATOR

JACK L. MCCLELLAN

## 3. ADDRESS OF OPERATOR

Box 848 - ROSWELL, NEW MEXICO 88201

## 4. LOCATION OF WELL (Report location clearly and in accordance with any State requirements.)\*

At surface

2310' FSL &amp; 2310' FEL

At proposed prod. zone

## 14. DISTANCE IN MILES AND DIRECTION FROM NEAREST TOWN OR POST OFFICE\*

12.5 MILES NORTH OF LOCO HILLS

## 15. DISTANCE FROM PROPOSED\*

LOCATION TO NEAREST  
PROPERTY OR LEASE LINE, FT.  
(Also to nearest drlg. unit line, if any)

330' E

## 18. DISTANCE FROM PROPOSED LOCATION\*

TO NEAREST WELL, DRILLING, COMPLETED,  
OR APPLIED FOR, ON THIS LEASE, FT.

660 S &amp; 660 W

## 21. ELEVATIONS (Show whether DF, RT, GR, etc.)

3926.8 GR

## 23.

## PROPOSED CASING AND CEMENTING PROGRAM

SIZE OF HOLE	SIZE OF CASING	WEIGHT PER FOOT	SETTING DEPTH	QUANTITY OF CEMENT
10 1/4	8 5/8	24	350	150 SKS (CIRC)
8"	5 1/2	15 1/2	2025	150 SKS

PLAN TO DRILL TO APPROX. 2025' TO TEST THE QUEEN SAND

IF PRODUCTION IS INDICATED, WILL RUN CSG. AND ATTEMPT COMPLETE

PROPOSED OPERATIONS WILL NOT  
AFFECT ENVIRONMENT SIGNIFICANTLY

IN ABOVE SPACE DESCRIBE PROPOSED PROGRAM: If proposal is to deepen or plug back, give data on present productive zone and proposed new productive zone. If proposal is to drill or deepen directionally, give pertinent data on subsurface locations and measured and true vertical depths. Give blowout preventer program, if any.

## 24.

SIGNED

TITLE

PRODUCTION  
SUPERINTENDENT

DATE

MAY 30, 1972

(This space for Federal or State office use)

PERMIT NO.

APPROVAL DATE

JUN 5 1972

APPROVED BY

TITLE

DISTRICT ENGINEER

DATE

JUN 5 1972

CONDITIONS OF APPROVAL, IF ANY:

THIS APPROVAL IS RESCINDED IF OPERATIONS  
NOT COMMENCED WITHIN 3 MONTHS.  
9-1-72  
LAPSES

\*See Instructions On Reverse Side

30-005-60217

## 5. LEASE DESIGNATION AND SERIAL NO.

NM 0493370-A

## 6. IF INDIAN, ALLOTTEE OR TRIBE NAME

## 7. UNIT AGREEMENT NAME

SULIMAR QUEEN UNIT

## 8. FARM OR LEASE NAME

TRACT 5

## 9. WELL NO.

#3

## 10. FIELD AND POOL, OR WILDCAT

SULIMAR QUEEN X

11. SEC., T., R., M., OR BLK.  
AND SURVEY OR AREA

SEC. 26-15S-29E-NMPM

## 12. COUNTY OR PARISH

CHAVES

## 13. STATE

NEW MEXICO

17. NO. OF ACRES ASSIGNED  
TO THIS WELL

40

## 20. ROTARY OR CABLE TOOLS

CABLE TOOLS

## 22. APPROX. DATE WORK WILL START\*

JUNE 1, 1972

RECEIVED  
JUN 6 1972  
ARTESIA, NEW MEXICORECEIVED  
MAY 31 1972  
J. S. GEOLOGICAL SURVEY  
ARTESIA, NEW MEXICO

RECEIVED

NEW MEXICO OIL CONSERVATION CO. SSION  
WELL LOCATION AND ACREAGE DEDICATION PLAT

JUN 6 1972

Form C-102  
Supersedes C-128  
Effective 1-1-65

All distances must be from the outer boundaries of the Section.

Operator <b>JACK L. MCCLELLAN</b>			Lease <i>Sulimar Queen Artesia</i>		OFFICIAL No. <b>3</b>
Unit Letter <b>J</b>	Section <b>26</b>	Township <b>15 SOUTH</b>	Range <b>29 EAST</b>	County <b>CHAVES</b>	
Actual Footage Location of Well: <b>2310</b> feet from the <b>SOUTH</b> line and <b>2310</b> feet from the <b>EAST</b> line					
Ground Level Elev. <b>3926.8</b>	Producing Formation <b>QUEEN SAND</b>	Pool <b>SULIMAR QUEEN</b>		Dedicated Acreage: <b>40</b> Acres	

1. Outline the acreage dedicated to the subject well by colored pencil or hatchure marks on the plat below.
2. If more than one lease is dedicated to the well, outline each and identify the ownership thereof (both as to working interest and royalty).
3. If more than one lease of different ownership is dedicated to the well, have the interests of all owners been consolidated by communitization, unitization, force-pooling, etc?

☒ Yes ☐ No If answer is "yes," type of consolidation SULIMAR QUEEN UNIT

If answer is "no," list the owners and tract descriptions which have actually been consolidated. (Use reverse side of this form if necessary.)

No allowable will be assigned to the well until all interests have been consolidated (by communitization, unitization, forced-pooling, or otherwise) or until a non-standard unit, eliminating such interests, has been approved by the Commission.

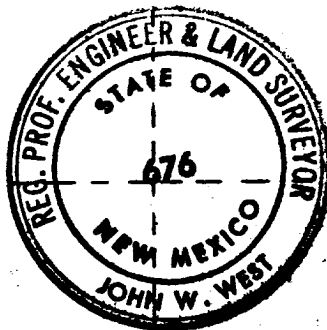

NOTE: LOCATION IS 0.8 FEET HIGHER THAN CITY SERVICE SNYDER FEDERAL NO. 2.

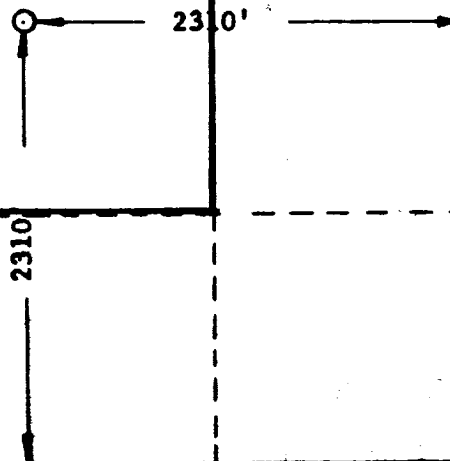

CERTIFICATION

I hereby certify that the information contained herein is true and complete to the best of my knowledge and belief.

Name  
*D. W. Gordon*  
**D. W. GORDON**  
Position  
**PRODUCTION SUPERINTENDENT**  
Company  
**JACK L. MCCLELLAN**  
Date  
**MAY 30, 1972**

**RECEIVED**  
**MAY 31 1972**  
**U.S. GEOLOGICAL SURVEY**  
**ARTESIA, NEW MEXICO**  
I hereby certify that the information shown on this plat was plotted from notes of actual survey and that the same is true to the best of my knowledge and belief.

Date Surveyed  
**MAY 26, 1972**  
Registered Professional Engineer and/or Land Surveyor  
*John W. West*  
Certificate No. **676**

0 200 400 600 800 1000 1200 1400 1600 1800 2000 2200 2400 2600 2800 3000