

UNITED STATES
DEPARTMENT OF THE INTERIOR
GEOLOGICAL SURVEY

APPLICATION FOR PERMIT TO DRILL, DEEPEN, OR PLUG BACK

1a. TYPE OF WORK DRILL <input checked="" type="checkbox"/> DEEPEN <input type="checkbox"/> PLUG BACK <input type="checkbox"/>			5. LEASE DESIGNATION AND SERIAL NO. 11.0204972
b. TYPE OF WELL OIL WELL <input checked="" type="checkbox"/> GAS WELL <input type="checkbox"/> OTHER <input type="checkbox"/> SINGLE ZONE <input type="checkbox"/> MULTIPLE ZONE <input type="checkbox"/>			6. IF INDIAN, ALLOTTEE OR TRIBE NAME
2. NAME OF OPERATOR Yates Petroleum Corporation			7. UNIT AGREEMENT NAME
3. ADDRESS OF OPERATOR 207 South 4th Street-Artesia, NM 88210			8. FARM OR LEASE NAME Federal CL
4. LOCATION OF WELL (Report location clearly and in accordance with any State requirements.)* At surface 330' FSL & 330' FSL of Sec. 27-15S-29E At proposed prod. zone			9. WELL NO. 4
14. DISTANCE IN MILES AND DIRECTION FROM NEAREST TOWN OR POST OFFICE* Approx 15 miles from Loco Hills, NM			10. FIELD AND POOL, OR WILDCAT Salinar
15. DISTANCE FROM PROPOSED* LOCATION TO NEAREST PROPERTY OR LEASE LINE, FT. (Also to nearest drlg. unit line, if any)			11. SEC., T., R., M., OR BLK. AND SURVEY OR AREA Sec. 27-15S-29E Unit F NHPM
16. NO. OF ACRES IN LEASE 880'			12. COUNTY OR PARISH Chaves
17. NO. OF ACRES ASSIGNED TO THIS WELL 130			13. STATE NM
18. DISTANCE FROM PROPOSED LOCATION* TO NEAREST WELL, DRILLING, COMPLETED, OR APPLIED FOR, ON THIS LEASE, FT.			14. DISTANCE FROM PROPOSED LOCATION* TO NEAREST WELL, DRILLING, COMPLETED, OR APPLIED FOR, ON THIS LEASE, FT.
19. PROPOSED DEPTH Approx. 2000'			20. ROTARY OR CABLE TOOLS Cable
21. ELEVATIONS (Show whether DF, RT, GR, etc.) 3872' GL			22. APPROX. DATE WORK WILL START* As soon as approved

23. PROPOSED CASING AND CEMENTING PROGRAM

SIZE OF HOLE	SIZE OF CASING	WEIGHT PER FOOT	SETTING DEPTH	QUANTITY OF CEMENT
10 3/4"	8 5/8"	20#	Approx. 300'	150 sxs
8"	5 1/2" & 7" (Tapered)	15.5 & 20#	" 2000'	100-150 sxs

Propose to test the Queen Sand to a depth of approximately 2000' and if commercial, will run a tapered string of 7" and 5 1/2" production casing. Will use Control Head.

DEVELOPMENT PLAN: See attached map.

RECEIVED
JUN 18 1972
U.S. GEOLOGICAL SURVEY
ARTESIA OFFICE

RECEIVED
JUN - 2 - 1972
U.S. GEOLOGICAL SURVEY
ARTESIA, NEW MEXICO

IN ABOVE SPACE DESCRIBE PROPOSED PROGRAM: If proposal is to deepen or plug back, give data on present productive zone and proposed new productive zone. If proposal is to drill or deepen directionally, give pertinent data on subsurface locations and measured and true vertical depths. Give blowout preventer program, if any.

24. SIGNED Edwin L. Hahlford TITLE Engineer DATE 6-2-72
(This space for Federal or State office use)

PERMIT NO. _____ APPROVAL DATE JUN 6 1972
APPROVED BY [Signature] TITLE DISTRICT ENGINEER DATE JUN 6 1972
CONDITIONS OF APPROVAL, IF ANY: _____

THIS APPROVAL IS RESCINDED IF OPERATIONS
ARE NOT COMMENCED WITHIN 3 MONTHS.
9-6-72

*See Instructions On Reverse Side

NEW MEXICO OIL AND GAS PLATON COMM. REG.
WELL LOCATION AND ACREAGE INFORMATION PLAT

RECEIVED
JUN 8 1972

Form O-103
Supersedes C-128
Effective 1-1-65

Operator Yates Petroleum Company			Well No. #1		
Unit Letter 2004	Section 27	Range 15 South	Twp. & Range 29 East Chaves		
Actual Well Location of Well: 330' East			330' South		
Ground Level Elev. 3572	Production Flow Rate 2800	Estimated Acreage 10.4		Acres	

1. Outline the acreage dedicated to the subject well on the plat below.
2. If more than one lease is dedicated to the well, list the ownership thereof (both as to working interest and royalty).
3. If more than one lease of different ownership is dedicated to the well, have the interests of all owners been consolidated by communitization, unitization, forced pooling, or otherwise?

☐ Yes ☐ No If answer is "yes" list the owners and tract here: _____

If answer is "no," list the owners and tract here: _____ (Use reverse side of this form if necessary.)

No allowable will be assigned to the well until a non-sustained application for communitization, unitization, forced pooling, or otherwise (or until a non-sustained application for a lease has been approved by the Commission.

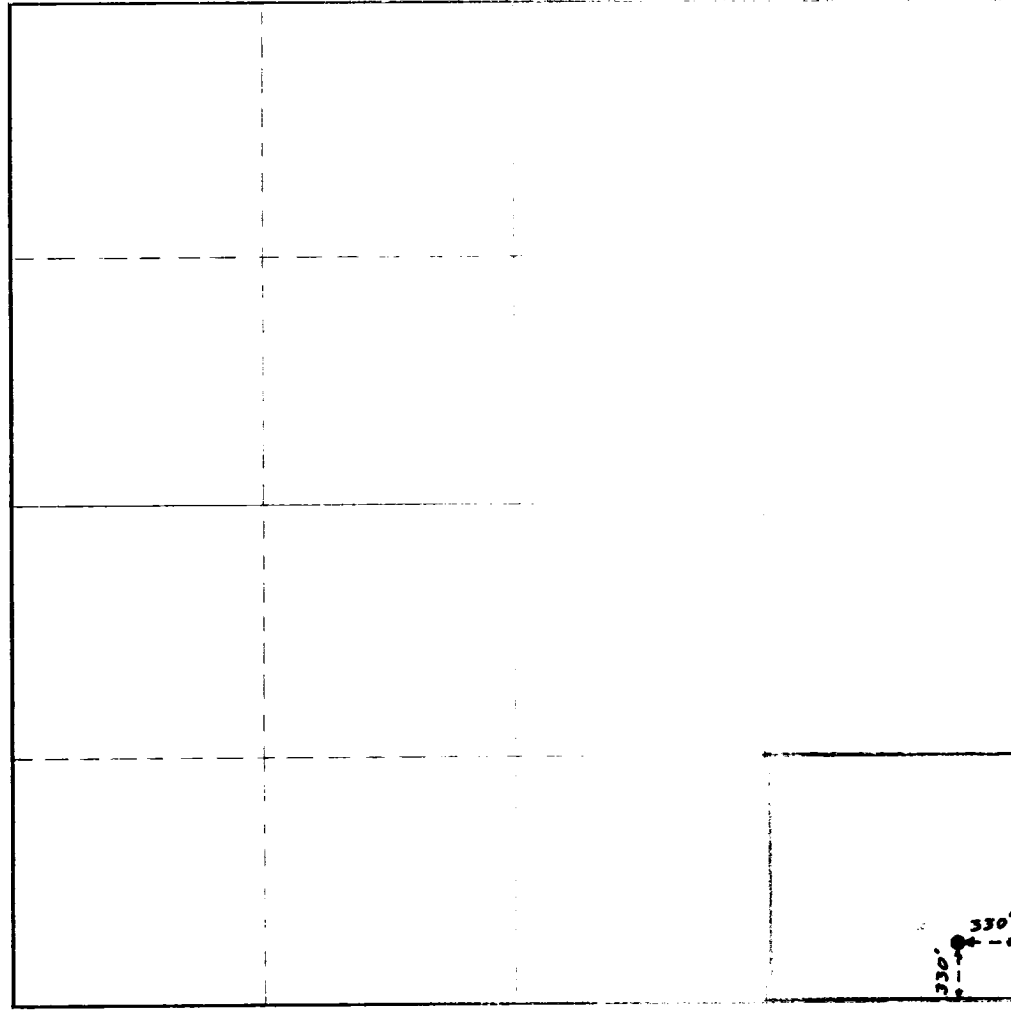

CERTIFICATION

I hereby certify that the information contained herein is true and complete to the best of my knowledge and belief.

Edmund H. Hays
Edmund H. Hays

Surveyor

Engineer

Yates Pet. Corporation

6-2-72

I hereby certify that the well location shown on this plat was plotted from field notes of actual surveys made by me or under my supervision, and that the same is true and correct to the best of my knowledge and belief.

June 1, 1972

Professional Engineer

E. B. Mintony
E. B. Mintony