

UNITED STATES
DEPARTMENT OF THE INTERIOR
GEOLOGICAL SURVEY

APPLICATION FOR PERMIT TO DRILL, DEEPEN, OR PLUG BACK

1a. TYPE OF WORK

DRILL ☒DEEPEN ☐PLUG BACK ☐

b. TYPE OF WELL

OIL
WELL ☒GAS
WELL ☐

OTHER

SINGLE
ZONE ☐MULTIPLE
ZONE ☐

2. NAME OF OPERATOR

MCCLELLAN OIL CORPORATION

3. ADDRESS OF OPERATOR

Box 848 - ROSWELL, NEW MEXICO 88201

4. LOCATION OF WELL (Report location clearly and in accordance with any State requirements.)*

At surface

330 FNL & 330 FWL

At proposed prod. zone

14. DISTANCE IN MILES AND DIRECTION FROM NEAREST TOWN OR POST OFFICE*

6.5 MILES EAST NORTHEAST OF LAKE ARTHUR

15. DISTANCE FROM PROPOSED*

LOCATION TO NEAREST
PROPERTY OR LEASE LINE, FT.
(Also to nearest drlg. unit line, if any)

660'

16. NO. OF ACRES IN LEASE

1800

18. DISTANCE FROM PROPOSED LOCATION*
TO NEAREST WELL, DRILLING, COMPLETED,
OR APPLIED FOR, ON THIS LEASE, FT.

19. PROPOSED DEPTH

800'

21. ELEVATIONS (Show whether DF, RT, GR, etc.)

3424.0' GR

23.

PROPOSED CASING AND CEMENTING PROGRAM

SIZE OF HOLE	SIZE OF CASING	WEIGHT PER FOOT	SETTING DEPTH	QUANTITY OF CEMENT
10"	8 5/8"	20 LB	250'	100 SX
8"	5 1/2"	15 1/2 LB	800'	100 SX

PROPOSE TO TEST THE QUEEN AND PENROSE SANDS AT AN APPROXIMATE DEPTH OF 800'. IF PRODUCTION INDICATED, SET OIL STRING AND ATTEMPT COMPLETION.

SURFACE CASING WILL BE RUN ONLY IF WATER IS INDICATED. IF NO WATER IS ENCOUNTERED, WILL DRILL TO TD. IF PRODUCTION IS ACHIEVED, WILL RUN SURFACE PIPE AND CEMENT WITH 1" STRING OF TUBING.

RECEIVED

JUL 26 1972

RECEIVED

JUL 24 1972

U. S. GEOLOGICAL SURVEY
ARTESIA, NEW MEXICO

IN ABOVE SPACE DESCRIBE PROPOSED PROGRAM: If proposal is to deepen or plug back, give data on present productive zone and proposed productive zone. If proposal is to drill or deepen directionally, give pertinent data on subsurface locations and measured and true vertical depths. Give blowout preventer program, if any.

24.

SIGNED

Joe L. McClellan

TITLE

OPERATOR

DATE

JULY 19, 1972

(This space for Federal or State office use)

PERMIT NO.

APPROVAL DATE

DATE

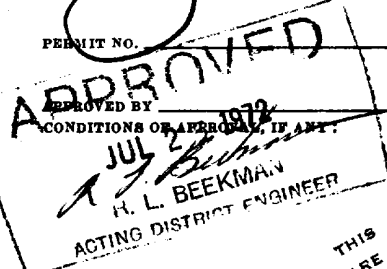

THIS APPROVAL IS RESCINDED IF OPERATIONS
ARE NOT COMMENCED WITHIN 3 MONTHS
EXPIRES OCT 25 1972

*See Instructions On Reverse Side

**NEW MEXICO OIL CONSERVATION COMMISSION
WELL LOCATION AND ACREAGE DEDICATION PLAT**

Form C-102
Supersedes C-128
Effective 1-1-65

All distances must be from the outer boundaries of the Section.

Operator MCCLELLAN OIL CORPORATION -JACK L. MCCLELLAN-			Lease TOLES FEDERAL		Well No. 1
Unit Letter D	Section 15	Township 15 SOUTH	Range 27 EAST	County CHAVEZ	
Actual Footage Location of Well: 330 feet from the NORTH line and 330 feet from the WEST line					
Ground Level Elev. 3424.0	Producing Formation QUEEN	Pool WILDCAT	Dedicated Acreage: 40 Acres		

1. Outline the acreage dedicated to the subject well by colored pencil or hatchure marks on the plat below.
2. If more than one lease is dedicated to the well, outline each and identify the ownership thereof (both as to working interest and royalty).
3. If more than one lease of different ownership is dedicated to the well, have the interests of all owners been consolidated by communitization, unitization, force-pooling, etc?

☐ Yes ☐ No If answer is "yes," type of consolidation _____

If answer is "no," list the owners and tract descriptions which have actually been consolidated. (Use reverse side of this form if necessary.) _____

No allowable will be assigned to the well until all interests have been consolidated (by communitization, unitization, forced-pooling, or otherwise) or until a non-standard unit, eliminating such interests, has been approved by the Commission.

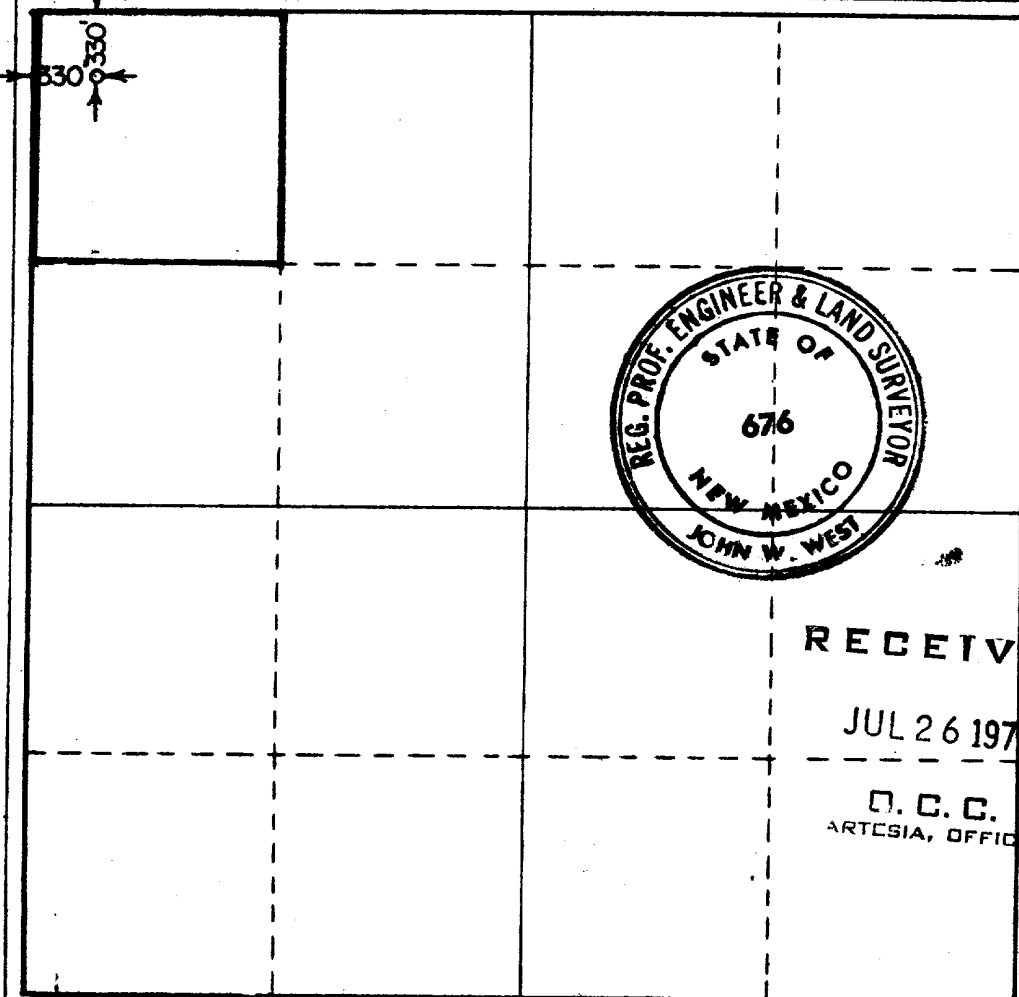

CERTIFICATION

I hereby certify that the information contained herein is true and complete to the best of my knowledge and belief.

Name *John W. West*
 Position **PRODUCTION SUPERINTENDENT**
 Company **MCCLELLAN OIL CORPORATION**
 Date **JULY 24, 1972**

RECEIVED

I hereby certify that the well location shown on this plat was taken from field notes of actual surveys made by me or under my supervision, and that the same is true and correct to the best of my knowledge and belief.

RECEIVED
JUL 26 1972
D. C. C.
ARTESIA, OFFICE

Date Surveyed **JULY 20, 1972**
 Registered Professional Engineer and/or Land Surveyor

John W. West
 Certificate No. **676**

McCLELLAN OIL CORPORATION

SUITE 814
PETROLEUM BUILDING

P. O. Box 848
ROSWELL, NEW MEXICO 88201

505 622-9200 OFFICE

EXISTING ROAD

PROPOSED ROAD

TOLES FEDERAL #1

RECEIVED

JUL 26 1972

C. C. C.
ARTESIA, OFFICE

THERE IS NO WATER ON LOCATION AND DRILLING WATER WILL BE TRUCKED.
COMBUSTIBLE MATERIAL WILL BE BURNED, NON-COMBUSTIBLE MATERIAL WILL BE
BURIED WITH PIT FILLING.
AFTER COMPLETION OR ABANDONMENT, THE PIT WILL BE FILLED AND THE LOCATION CLEANED.
PROPOSE TO BLADE NEW ROAD IN TO LOCATION.

RECEIVED

JUL 24 1972

U. S. GEOLOGICAL SURVEY
ARTESIA, NEW MEXICO

