

UNITED STATES
DEPARTMENT OF THE INTERIOR
GEOLOGICAL SURVEY

30-005-60318

APPLICATION FOR PERMIT TO DRILL, DEEPEN, OR PLUG BACK

1a. TYPE OF WORK
DRILL ☒ DEEPEN ☐ PLUG BACK ☐

b. TYPE OF WELL
OIL WELL ☒ GAS WELL ☐ OTHER ☐ SINGLE ZONE ☐ MULTIPLE ZONE ☐

2. NAME OF OPERATOR
McClellan Oil Corporation

3. ADDRESS OF OPERATOR
P. O. Box 848, Roswell, New Mexico 88201

4. LOCATION OF WELL (Report location clearly and in accordance with any State requirements)
At surface
At proposed prod. zone 990' FSL & 2310' FEL

14. DISTANCE IN MILES AND DIRECTION FROM NEAREST TOWN OR POST OFFICE*
18 miles North of Loco Hills, New Mexico

15. DISTANCE FROM PROPOSED* LOCATION TO NEAREST PROPERTY OR LEASE LINE, FT. (Also to nearest drlg. unit line, if any) 330'

16. NO. OF ACRES IN AREA, TYPE OF ACRES ASSIGNED TO THIS WELL 280

17. PROPOSED DEPTH 2000'

18. DISTANCE FROM PROPOSED LOCATION* TO NEAREST WELL, DRILLING, COMPLETED, OR APPLIED FOR, ON THIS LEASE, FT. 900'

19. PROPOSED DEPTH 2000'

20. ROTARY OR CABLE TOOLS
Cable Tools

21. ELEVATIONS (Show whether DF, RT, GR, etc.)

22. APPROX. DATE WORK WILL START*

5. LEASE DESIGNATION AND SERIAL NO.
LC 069280 - C

6. IF INDIAN, ALLOTTEE OR TRIBE NAME

7. UNIT AGREEMENT NAME
Sulimar Queen Unit

8. FARM OR LEASE NAME
Tract III

9. WELL NO.
6

10. FIELD AND POOL, OR WILDCAT
Sulimar Queen

11. SEC., T., R., M., OR BLK. AND SURVEY OR AREA
Sec. 24, T15S - R29E

12. COUNTY OR PARISH
Chaves

13. STATE
New Mexico

SEP 12 1974

O. C. C.

PROPOSED CASING AND CEMENTING PROGRAM

SIZE OF HOLE	SIZE OF CASING	WEIGHT PER FOOT	SETTING DEPTH	QUANTITY OF CEMENT
10 1/4"	8-5/8"	20 lb.	300'	100 SX
8"	5-1/2"	15 lb.	2000'	150 SX

Propose to drill a development well in the Sulimar Queen Unit to the Queen formation and test. If production is indicated, will run casing and complete.

Cortez Drilling Company, P. O. Box 848, Roswell, New Mexico will be the Contractor.

RECEIVED

SEP-3 1974

U. S. GEOLOGICAL SURVEY
ALBUQUERQUE, NEW MEXICO

IN ABOVE SPACE DESCRIBE PROPOSED PROGRAM: If proposal is to deepen or plug back, give data on present productive zone and proposed new productive zone. If proposal is to drill or deepen directionally, give pertinent data on subsurface locations and measured and true vertical depths. Give blowout preventer program, if any.

24. SIGNED Joel J. McClellan TITLE Operator DATE 8/28/74

(This space for Federal or State office use)

PERMIT NO. _____ APPROVAL DATE _____

APPROVED
SEP 11 1974
H. L. BEEKWIND
ACTING DISTRICT ENGINEER

THIS APPROVAL IS RESCINDED IF OPERATIONS ARE NOT COMMENCED WITHIN 3 MONTHS.
EXPIRES DEC 11 1974
See Instructions On Reverse Side

NEW MEXICO OIL CONSERVATION COMMISSION
WELL LOCATION AND ACREAGE DEDICATION PLAT

Form O-102
Supersedes C-128
Effective 1-1-65

All distances must be from the outer boundaries of the Section

Owner McClellan Oil Corporation			Lease Tract 3		Well No. 6
Section 0	Section 24	Township 15 South	Range 29 East	County Chaves	
Actual Well Location (if well)					
990	feet from the	South	line and	2310	feet from the
					East
Ground Level Elev.	Producing Formation Queen sand		Flow I		Dedicated Acreage 40

1. Outline the acreage dedicated to the subject well by colored pencil or hatchure marks on the plat below.
2. If more than one lease is dedicated to the well, outline each and identify the ownership thereof (both as to working interest and royalty)
3. If more than one lease of different ownership is dedicated to the well, have the interests of all owners been consolidated by communitization, unitization, force-pooling, etc?

☐ Yes ☐ No If answer is "yes," type of consolidation _____

If answer is "no," list the owners and tract descriptions which have actually been consolidated. (Use reverse side of this form if necessary.) _____

No allowable will be assigned to the well until all interests have been consolidated (by communitization, unitization, forced-pooling, or otherwise) or until a non-standard unit, eliminating such interests, has been approved by the Commission.

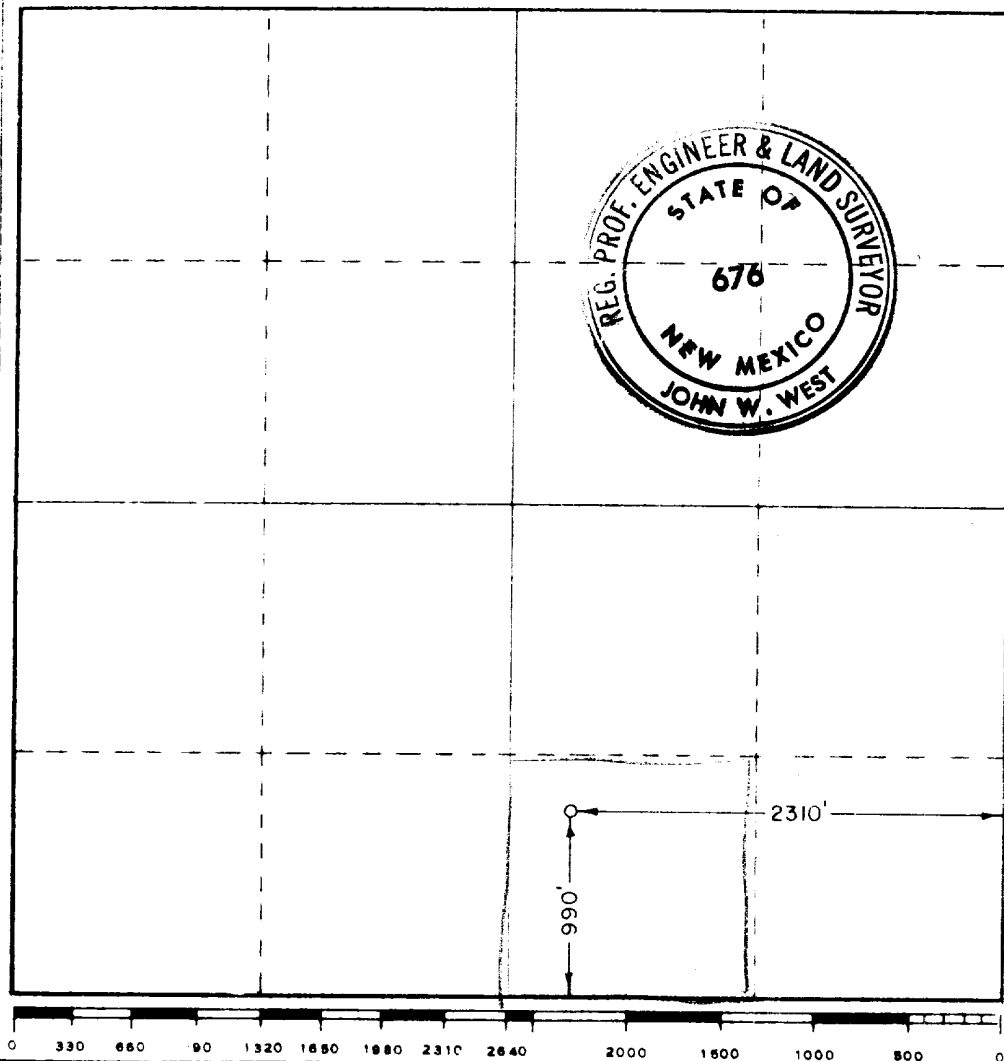

CERTIFICATION

I hereby certify that the information contained herein is true and complete to the best of my knowledge and belief.

Jack L. McClellan
Name
Jack L. McClellan
Position
Operator
Company
McClellan Oil Corporation
Date
August 30, 1974

RECEIVED

I hereby certify that the well location shown on this plat was plotted from field notes of actual surveys made by me or under my supervision, and that the same is true and correct to the best of my knowledge and belief.

Date Surveyed
August 31, 1974

Registered Professional Engineer and/or Land Surveyor

John W. West
Certificate No.

676



M MELLAN OIL CORPORATION
Box 843
ROSWELL, NEW MEXICO 89201

Tract III. No. 6

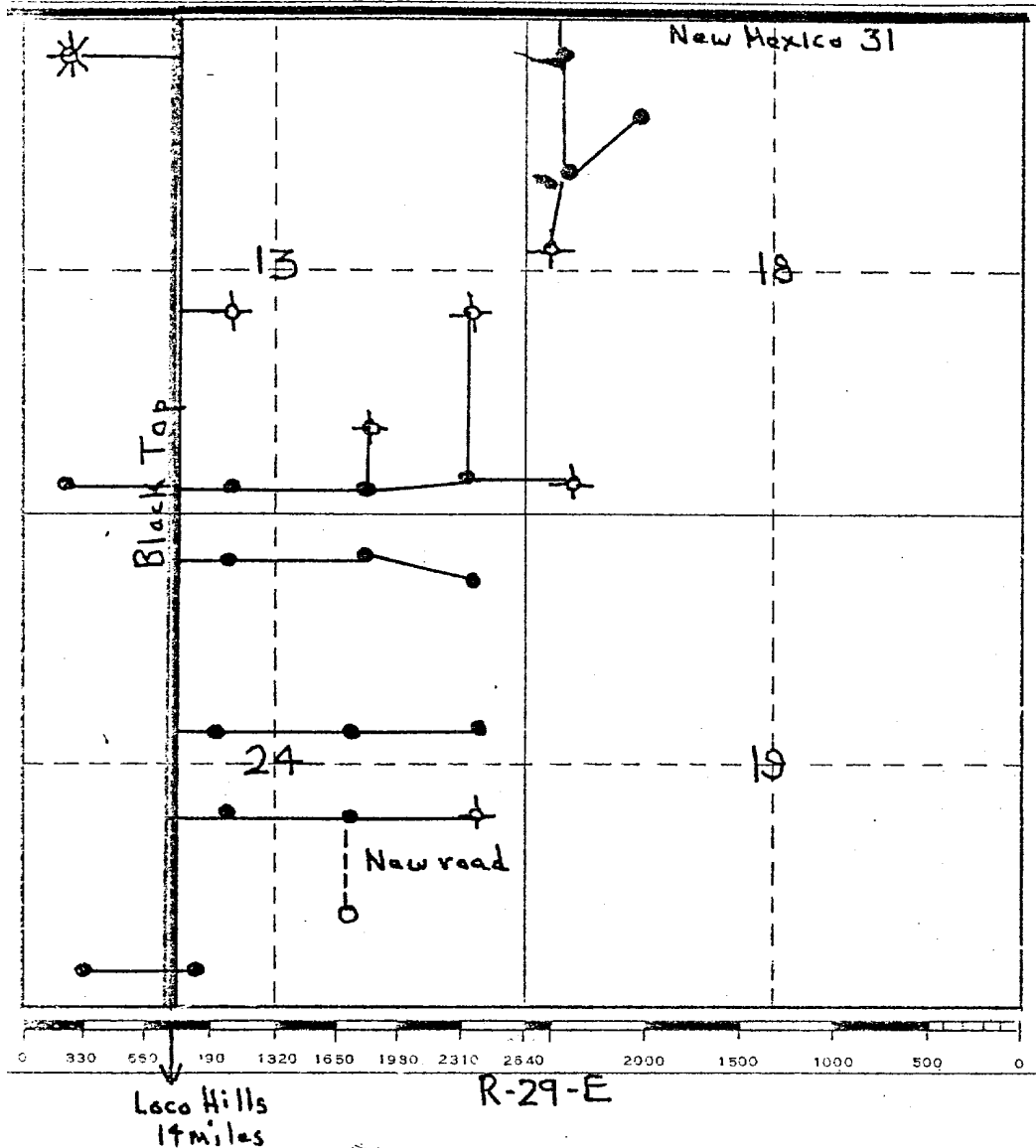

RECEIVED

SEP - 3 1974

U. S. GEOLOGICAL SURVEY
ARTESIA, NEW MEXICO

Propose to use existing roads, county and oil field, and to construct approximately 1000' of new road to the location. No water exists in this area and will have to be trucked in to location. Combustible material will be burned, noncombustible material will be buried with pit filling.

After completion or abandonment, the pit will be filled, the location cleaned, and the area restored, as much as possible, to its original state.

