

NEW MEXICO OIL CONSERVATION COMMISSION

30-005-60321

Form O-191
Revised 1-1-65

RECEIVED

NOV 15 1974

APPLICATION FOR PERMIT TO DRILL, DEEPEN, OR PLUG BACK

O. C. C.

ARTESIA, OFFICE

DRILL ☒DEEPEN ☐PLUG BACK ☐GAS WELL ☒

OTHER

SINGLE ZONE ☒MULTIPLE ZONE ☐

DEPCO, Inc. ✓

900 Central, Odessa, Texas 79761

4. Location of Well UNIT LETTER G LOCATED 1325 FEET FROM THE North LINEAND 1325 FEET FROM THE East LINE OF SEC. 3 TWP. 15s RGE. 27e NMPM

7. Unit Agreement No.

8. Farm or Lease Name

Derrick

9. Well No.

1

10. Field and Pool, or Wildcat
Buffalo Valley Penn

12. County

Chaves

19. Proposed Depth

8500

19A. Formation

Penn

20. Rotary or C.T.

Rotary

21. Elevations (Show whether DF, RT, etc.)

3408 Gr

21A. Kind & Status Plug. Bond

Blanket

21B. Drilling Contractor

Moranco

22. Approx. Date Work will start

12-1-74

23.

PROPOSED CASING AND CEMENT PROGRAM

SIZE OF HOLE	SIZE OF CASING	WEIGHT PER FOOT	SETTING DEPTH	SACKS OF CEMENT	EST. TOP
17 1/2	12 3/4	35#	350	Circ.	
11	8 5/8	24#	1900	Circ.	
7 7/8	4 1/2	11.6#	8500	250 sx.	

BOP. see attachment

NSL approved by order R-4800
6-4-74APPROVAL VALID
FOR 90 DAYS UNLESS
DRILLING COMMENCED,EXPIRES 2-20-75

IN ABOVE SPACE DESCRIBE PROPOSED PROGRAM: IF PROPOSAL IS TO DEEPEN OR PLUG BACK, GIVE DATA ON PRESENT PRODUCTIVE ZONE AND PROPOSED NEW PRODUCTIVE ZONE. GIVE BLOWOUT PREVENTER PROGRAM, IF ANY.

I hereby certify that the information above is true and complete to the best of my knowledge and belief.

Signed D. R. Mason Title Chief Clerk Date 11-12-74

(This space for State Use)

APPROVED BY W. A. Gussert TITLE OIL AND GAS INSPECTORDATE NOV 20 1974

CONDITIONS OF APPROVAL, IF ANY:

NEW MEXICO OIL CONSERVATION COMMISSION
WELL LOCATION AND ACREAGE DEDICATION PLAT

Form C-102
Supersedes C-128
Effective 1-1-65

All distances must be from the outer boundaries of the Section.

Operator DEPCO Inc.			Lease Derrick			Well No. 1		
Unit Letter G	Section 3	Township 15 South	Range 27 East	County Chaves				
Actual Portage Location of Well: 1325 feet from the North line and 1325 feet from the East line								
Ground Level Elev. 3408	Producing Formation Penn		Pool U. S. Buffalo Valley - Penn			Dedicated Acreage: 320 Acres		

1. Outline the acreage dedicated to the subject well by colored pencil or hachure marks on the plat below.
2. If more than one lease is dedicated to the well, outline each and identify the ownership thereof (both as to working interest and royalty).
3. If more than one lease of different ownership is dedicated to the well, have the interests of all owners been consolidated by communitization, unitization, force-pooling, etc?

RECEIVED
NOV 15 1974

☐ Yes ☒ No If answer is "yes," type of consolidation **E. S. C.**
If answer is "no," list the owners and tract descriptions which have actually been consolidated. (Use reverse side of this form if necessary.) **To be COMMUNITIZED UPON COMPLETION AS PRODUCER.**
No allowable will be assigned to the well until all interests have been consolidated (by communitization, unitization, forced-pooling, or otherwise) or until a non-standard unit, eliminating such interests, has been approved by the Commission.

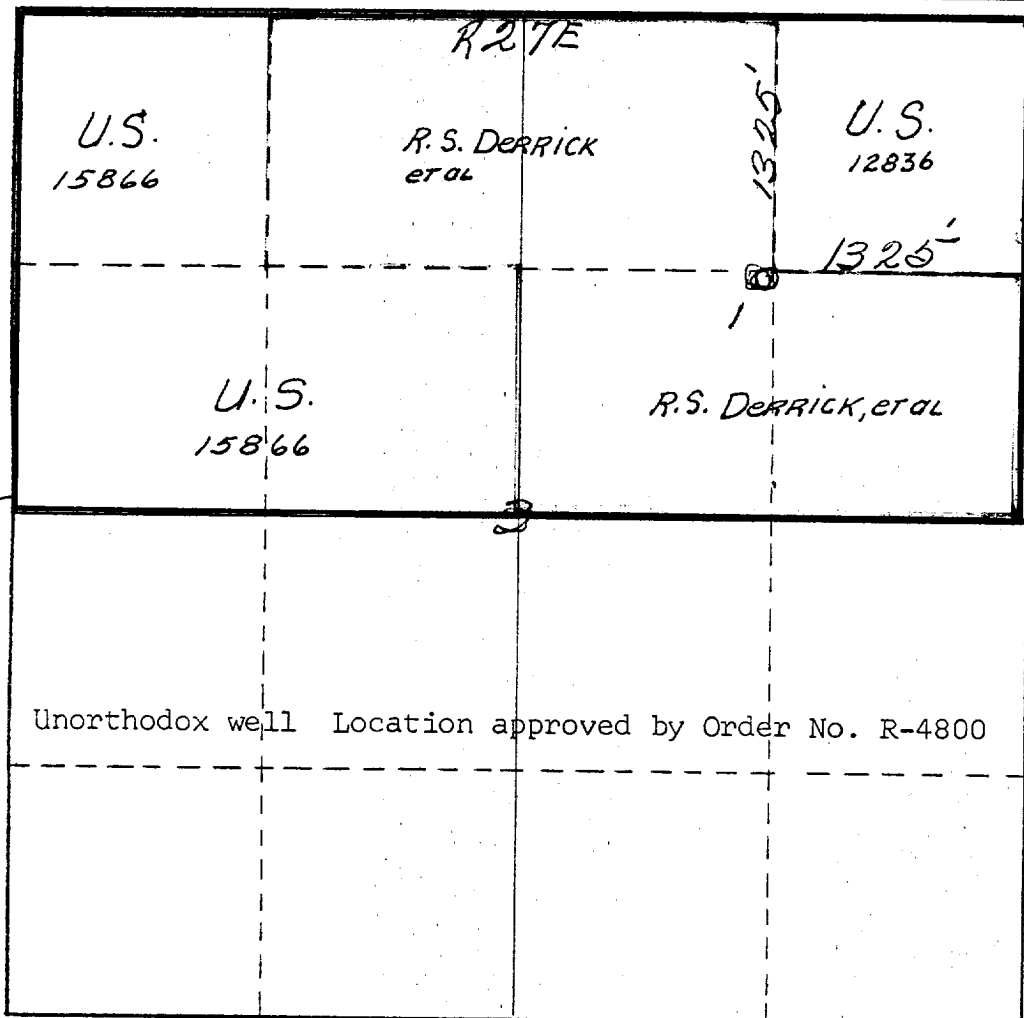

Unorthodox well Location approved by Order No. R-4800

CERTIFICATION

I hereby certify that the information contained herein is true and complete to the best of my knowledge and belief.

Name
D. R. Mason
Position
Chief Clerk
Company
DEPCO, Inc.
Date
11-12-74

I hereby certify that the well location shown on this plat was plotted from field notes of actual surveys made by me or under my supervision, and that the same is true and correct to the best of my knowledge and belief.

Date Surveyed
October 5th 1974
Registered Professional Engineer and/or Land Surveyor
James H. Brown
Certificate No.
542

0 330 660 990 1320 1650 1980 2310 2640 2970 3300

NAME: Derrick #1
 LOCATION: 1325' EN & EL Sec. 3, T-15-S, R-27-E,
Chaves Co., New Mexico

RECEIVED

NOV 19 1974

O. C. C.
 ARTESIA, OFFICE

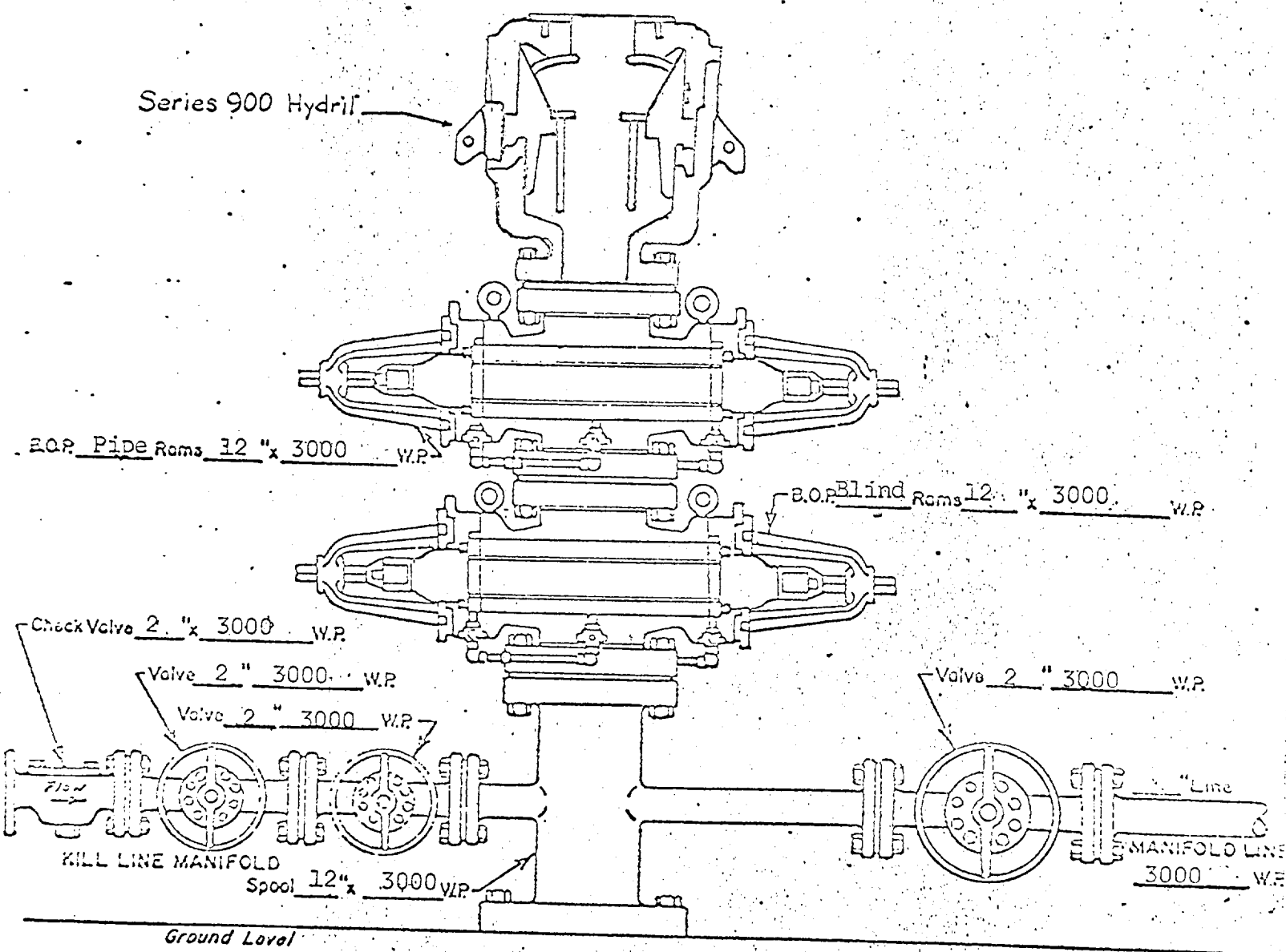

SURFACE
WELL HEAD B.O.P.
3000 W.P.

- ☐ Manual
- ☒ Hydraulic