

UNITED STATES
DEPARTMENT OF THE INTERIOR
GEOLOGICAL SURVEY

30-005-60331

APPLICATION FOR PERMIT TO DRILL, DEEPEN, OR PLUG BACK

1a. TYPE OF WORK

DRILL ☒DEEPEN ☐PLUG BACK ☐

b. TYPE OF WELL

OIL
WELL ☒GAS
WELL ☐OTHER ☐SINGLE
ZONE ☐MULTIPLE
ZONE ☐

2. NAME OF OPERATOR

McCLELLAN OIL CORPORATION

3. ADDRESS OF OPERATOR

P. O. Box 848, Roswell, New Mexico 88201

4. LOCATION OF WELL (Report location clearly and in accordance with any State requirements.)

At surface

At proposed prod. zone

50' FS & 1450' FWL

JAN 26 1975

14. DISTANCE IN MILES AND DIRECTION FROM NEAREST TOWN OR POST OFFICE*

18 MILES NORTH OF LOCO HILLS

O. C. C.

ARTESIA, OFFICE

13. DISTANCE FROM PROPOSED*

LOCATION TO NEAREST
PROPERTY OR LEASE LINE, FT.
(Also to nearest drlg. unit line, if any)

50'

16. NO. OF ACRES IN LEASE

480

17. NO. OF ACRES ASSIGNED

TO THIS WELL 40

18. DISTANCE FROM PROPOSED LOCATION*
TO NEAREST WELL, DRILLING, COMPLETED,
OR APPLIED FOR, ON THIS LEASE, FT.

600'

19. PROPOSED DEPTH

2050'

20. ROTARY OR CABLE TOOLS

CABLE TOOLS

21. ELEVATIONS (Show whether DF, RT, GR, etc.)

22. APPROX. DATE WORK WILL START*

JANUARY 25, 1975

23.

PROPOSED CASING AND CEMENTING PROGRAM

SIZE OF HOLE	SIZE OF CASING	WEIGHT PER FOOT	SETTING DEPTH	QUANTITY OF CEMENT
12"	8-5/8"*	24#	425'	100 SX (CIRC)*
8"	5-1/2"	14#	2050'	100 SX

PROPOSE TO DRILL TO 2050' TO TEST THE QUEEN SAND. IF PRODUCTION IS
INDICATED, WILL RUN 5 1/2" CASING AND ATTEMPT COMPLETION. CORTEZ
DRILLING COMPANY WILL BE THE CONTRACTOR.

*THIS CASING WILL NOT BE RUN IF WATER IS NOT ENCOUNTERED. IF NO WATER
IS ENCOUNTERED AND PRODUCTION SUBSEQUENTLY ACHIEVED, THIS CASING
WILL BE RUN AND CEMENT CIRCULATED PRIOR TO COMPLETION ATTEMPT.

IN ABOVE SPACE DESCRIBE PROPOSED PROGRAM: If proposal is to deepen or plug back, give data on present productive zone and proposed new productive zone. If proposal is to drill or deepen directionally, give pertinent data on subsurface locations and measured and true vertical depths. Give blowout preventer program, if any.

24.

SIGNED

J. L. McClellan

TITLE

OPERATOR

DATE

1/21/75

(This space for Federal or State office use)

PERMIT NO.

APPROVED BY

CONDITIONS OF APPROVAL, IF ANY:

JAN 28 1975

I. L. BEEKMAN

ACTING DISTRICT ENGINEER

APPROVAL DATE

Subject to NMOC

approval as UL

DATE

THIS APPROVAL IS RESCINDED IF OPERATIONS
ARE NOT COMMENCED WITHIN 3 MONTHS.
EXPIRES APR 27 1975

*See Instructions On Reverse Side

NEW MEXICO OIL CONSERVATION COMMISSION
WELL LOCATION AND ACREAGE DEDICATION PLAT

Form C-102
Supersedes C-128
Effective 1-1-65

All distances must be from the outer boundaries of the Section

Operator McClellan Oil Corporation		Lease Sulimar Queen Unit Tract 1		Well No. 10
Section N	Section 24	Range 15 South	Range 29 East	County Chaves
Acreage of Section Containing Well 50 feet from the South line and 1450 feet from the West line				
Ground to plat level	Producing from	Producing from	Dedicated Acreage	
	<i>Queen Land</i>	<i>Sulimar Queen</i>	40	
Acreage				

1. Outline the acreage dedicated to the subject well by colored pencil or hatchure marks on the plat below.
2. If more than one lease is dedicated to the well, outline each and identify the ownership thereof (both as to working interest and royalty).
3. If more than one lease of different ownership is dedicated to the well, have the interests of all owners been consolidated by communitization, unitization, force-pooling, etc?

☐ Yes ☐ No If answer is "yes," type of consolidation _____

If answer is "no," list the owners and tract descriptions which have actually been consolidated. (Use reverse side of this form if necessary.) _____

No allowable will be assigned to the well until all interests have been consolidated (by communitization, unitization, forced-pooling, or otherwise) or until a non-standard unit, eliminating such interests, has been approved by the Commission.

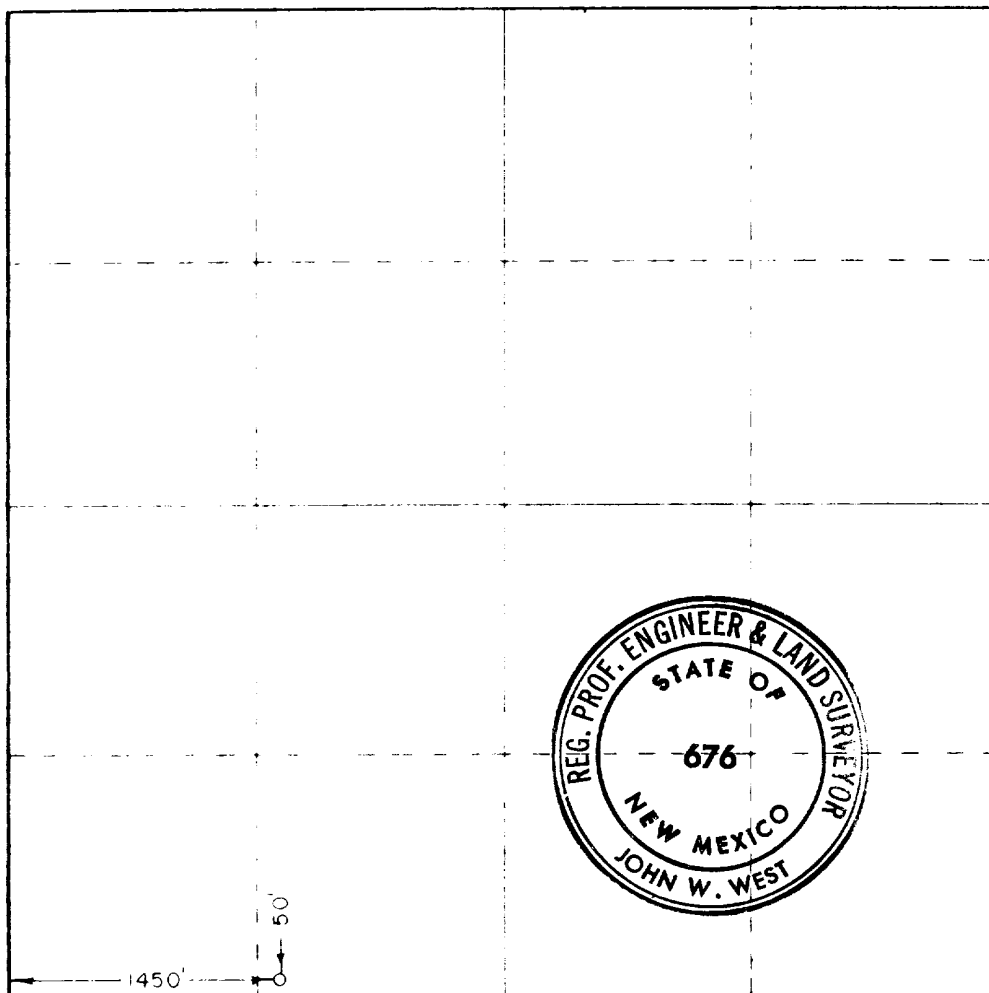

CERTIFICATION

I hereby certify that the information contained herein is true and complete to the best of my knowledge and belief

Signature: *John W. West*
Agent

McClellan Oil Corporation

January 22, 1975

I hereby certify that the well location shown on this plat was plotted from field notes of actual surveys made by me or under my supervision and that the same is true and correct to the best of my knowledge and belief

ANTHONY

Date: January 22, 1975

January 22, 1975

Registered Professional Engineer and Land Surveyor

Signature: *John W. West*
676

JME

MCLELLAN OIL CORPORATION

Box 843

ROSWELL, NEW MEXICO 88201

STATE HIGHWAY 31 - MALJAMAR CUTOFF ROAD

T-29-E

TRACT 1

TRACT 8

TRACT 3

3-A

1

1-C

TRACT 3

2-A

2-C

3-C

TRACT 1

6-A

2

4-A

4-C

5-C

6-A

7-A

1-10

PROPOSED

LOCATION

T-15-S

RECEIVED

JAN 22 1975

U. S. GEOLOGICAL SURVEY
ARTESIA, NEW MEXICO

18 MILES TO LOCO HILLS

PROPOSE TO USE EXISTING PAVED ROAD THAT RUNS FROM STATE HIGHWAY 31 SOUTH TO LOCO HILLS. WILL CONSTRUCT APPROXIMATELY 100' OF ROAD TO LOCATION. NO WATER EXISTS IN THIS AREA AND WILL HAVE TO BE TRUCKED IN TO LOCATION. COMBUSTIBLE MATERIAL WILL BE BURNED, NONCOMBUSTIBLE MATERIAL WILL BE BURIED WITH PIT FILLING.

AFTER COMPLETION OR ABANDONMENT, THE PIT WILL BE FILLED, THE LOCATION CLEANED, AND THE AREA RESTORED, AS MUCH AS POSSIBLE, TO ITS ORIGINAL STATE.

45'

5'

PIT



WATER TANK

RIG

PIPE RACKS

FLOW LINE
IF PRODUCTIVE

180'



TANK BATTERY
IF PRODUCTIVE