

NO. OF COPIES RECEIVED	6
DISTRIBUTION	
SANTA FE	
FILE	
U.S.G.S.	
LAND OFFICE	
OPERATOR	

NEW MEXICO CONSERVATION COMMISSION

30-005-60344

Form C-101
Revised 1-1-65

MAY 1 1975

O. C. C.
ARTESIA, OFFICE

5A. Indicate Type of Lease STATE <input checked="" type="checkbox"/> FEE <input type="checkbox"/>
5. State Oil & Gas Lease No. K-5110
7. Unit Agreement Name -
8. Farm or Lease Name Harris "16" State
9. Well No. 2
10. Field and Pool, or Wildcat Undesignated
12. County Chaves
19. Proposed Depth 1850'
19A. Formation Queen sand
20. Rotary or C.T. Cable tool
21. Elevations (Show whether DF, RT, etc.) 3846.4' GR - 3848' DF
21A. Kind & Status Plug. Bond Statewide
21B. Drilling Contractor Cortez Drilling Co.
22. Approx. Date Work will start May 2, 1975

APPLICATION FOR PERMIT TO DRILL, DEEPEN, OR PLUG BACK

1a. Type of Work DRILL <input checked="" type="checkbox"/> DEEPEN <input type="checkbox"/> PLUG BACK <input type="checkbox"/>
b. Type of Well OIL WELL <input checked="" type="checkbox"/> GAS WELL <input type="checkbox"/> OTHER <input type="checkbox"/>
2. Name of Operator Read & Stevens, Inc.
3. Address of Operator P. O. Box 2126, Roswell, New Mexico 88201
4. Location of Well UNIT LETTER J LOCATED 1980 FEET FROM THE South LINE AND 1980 FEET FROM THE East LINE OF SEC. 16 TWP. 15-S RGE. 29-E NMPM
19. Proposed Depth 1850'
19A. Formation Queen sand
20. Rotary or C.T. Cable tool
21. Elevations (Show whether DF, RT, etc.) 3846.4' GR - 3848' DF
21A. Kind & Status Plug. Bond Statewide
21B. Drilling Contractor Cortez Drilling Co.
22. Approx. Date Work will start May 2, 1975

PROPOSED CASING AND CEMENT PROGRAM

SIZE OF HOLE	SIZE OF CASING	WEIGHT PER FOOT	SETTING DEPTH	SACKS OF CEMENT	EST. TOP
11"	8 5/8"	24#	350'	100 sx.	Circulated
7 7/8"	4 1/2"	9.5#	1850'	100 sx.	1000'

APPROVAL VALID
FOR 90 DAYS UNLESS
DRILLING COMMENCED,

EXPIRES 8-2-75

IN ABOVE SPACE DESCRIBE PROPOSED PROGRAM: IF PROPOSAL IS TO DEEPEN OR PLUG BACK, GIVE DATA ON PRESENT PRODUCTIVE ZONE AND PROPOSED NEW PRODUCTIVE ZONE. GIVE BLOWOUT PREVENTER PROGRAM, IF ANY.

I hereby certify that the information above is true and complete to the best of my knowledge and belief.

Signed John L. Anderson Jr. Title Agent Date April 29, 1975

(This space for State Use)

APPROVED BY W. A. Grossett TITLE SUPERVISOR, DISTRICT II DATE MAY 2 1975

CONDITIONS OF APPROVAL, IF ANY:

MEXICO OIL CONSERVATION COMMISSION
WELL LOCATION AND ACREAGE DEDICATION PLAT

Form C-102
Supersedes C-128
Effective 1-1-65

All distances must be from the outer boundaries of the Section

Lessee Read & Stevens, Incorporated		Lease Harris 16 State			Well No. 2
Section J	Section 16	Township 15 South	Range 29 East	County Chaves	
Approximate Location of Well: 1980 feet from the South line and 1980 feet from the East line					
Ground Surface Elev. 3846.4	Producing Formation Queen sand	Pool Undesignated			Dedicated Acreage: NW/4SE/4-40.00 Acres

1. Outline the acreage dedicated to the subject well by colored pencil or hachure marks on the plat below.
2. If more than one lease is dedicated to the well, outline each and identify the ownership thereof (both as to working interest and royalty)
3. If more than one lease of different ownership is dedicated to the well, have the interests of all owners been consolidated by communitization, unitization, force-pooling, etc?

Yes No If answer is "yes," type of consolidation _____

If answer is "no," list the owners and tract descriptions which have actually been consolidated. (Use reverse side of this form if necessary.) _____

No allowable will be assigned to the well until all interests have been consolidated (by communitization, unitization, force-pooling, or otherwise) or until a non-standard unit, eliminating such interests, has been approved by the Commission.

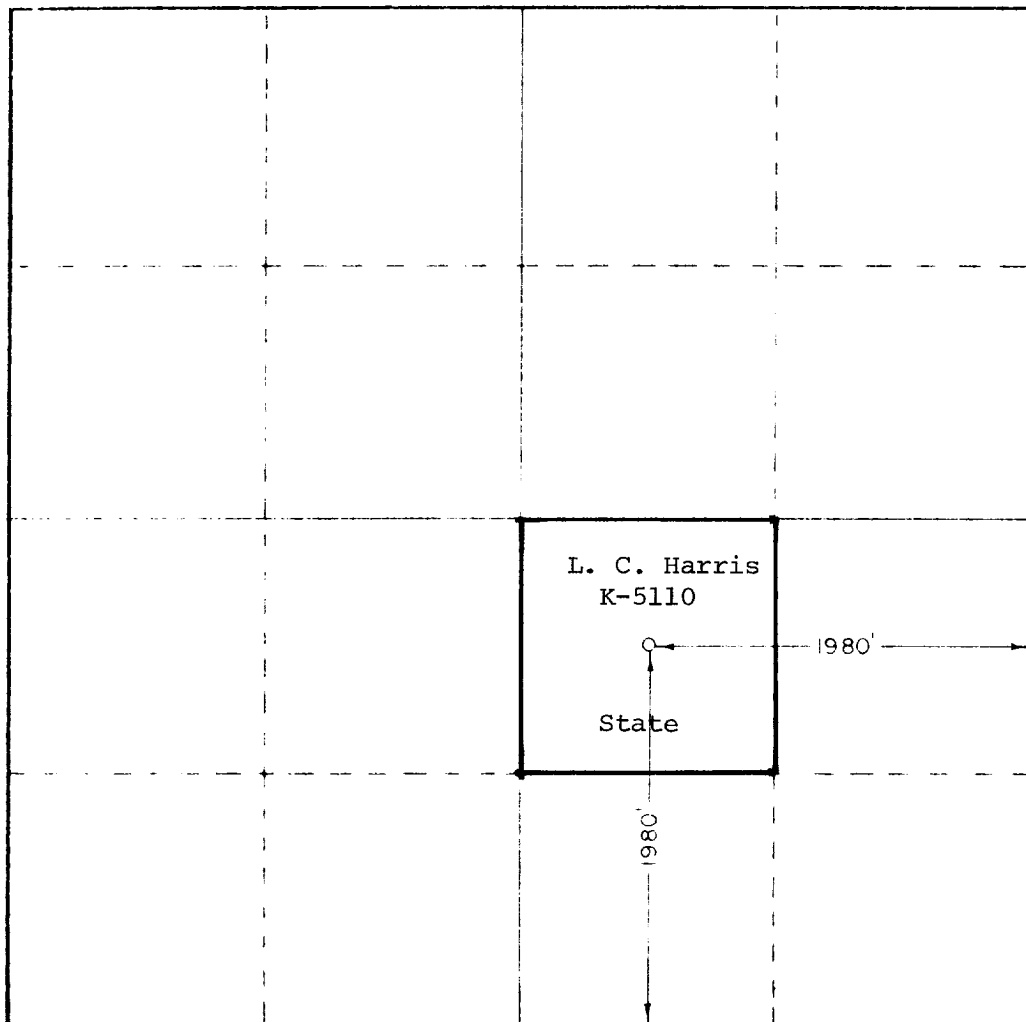

CERTIFICATION

I hereby certify that the information contained herein is true and complete to the best of my knowledge and belief

John L. Anderson, Jr.

Agent

John L. Anderson, Jr.

Position:
Agent

Company:
Read & Stevens, Inc.

Date:
April 29, 1975

I hereby certify that the well location shown on this plat was plotted from field notes of actual surveys made by me or under my supervision, and that the same is true and correct to the best of my knowledge and belief.

Date Surveyed:

Registered Professional Engineer
STATE OF NEW MEXICO
at Large, City of _____ Mayor

