

UNITED STATES
DEPARTMENT OF THE INTERIOR
GEOLOGICAL SURVEY

30-005-60370

APPLICATION FOR PERMIT TO DRILL, DEEPEN, OR PLUG BACK

1a. TYPE OF WORK

DRILL ☒DEEPEN ☐PLUG BACK ☐

b. TYPE OF WELL

OIL
WELL ☒GAS
WELL ☐

OTHER Or Injection

SINGLE
ZONE ☒MULTIPLE
ZONE ☐

2. NAME OF OPERATOR

McClellan Oil Corporation

3. ADDRESS OF OPERATOR

P O Box 848, Roswell, N M 88201

4. LOCATION OF WELL (Report location clearly and in accordance with any State requirements.)*

At surface

At proposed prod. zone

1370' FWL & 2615' FSL K

14. DISTANCE IN MILES AND DIRECTION FROM NEAREST TOWN OR POST OFFICE*

18 miles North of Loco Hills, N M

15. DISTANCE FROM PROPOSED*

LOCATION TO NEAREST
PROPERTY OR LEASE LINE, FT.
(*Also to nearest drlg. unit line, if any)

1370'

16. NO. OF ACRES IN LEASE

800

17. NO. OF ACRES ASSIGNED
TO THIS WELL

40

18. DISTANCE FROM PROPOSED LOCATION*
TO NEAREST WELL, DRILLING, COMPLETED,
OR APPLIED FOR, ON THIS LEASE, FT.

1250'

19. PROPOSED DEPTH

2025'

20. ROTARY OR CABLE TOOLS

Cable Tools

21. ELEVATIONS (Show whether DF, RT, GR, etc.)

3935.8' G.R.

22. APPROX. DATE WORK WILL START*

December 30, 1975

23.

PROPOSED CASING AND CEMENTING PROGRAM

SIZE OF HOLE	SIZE OF CASING	WEIGHT PER FOOT	SETTING DEPTH	QUANTITY OF CEMENT
12 1/2"	8-5/8"	20 lb.	390'	100 sx. circ.
8"	4 1/2"	9 1/2 lb.	2025'	150 sx.

Propose to test the Queen sand, the Sulimar Queen Unit for use as an oil well or an injection well. If production or permeability is indicated will complete as producing or water injection well.

Cortez Drilling Company, Box 848, Roswell, N M will be the drilling contractor.

RECEIVED

JAN 7 1976

O. C. C.

ARTESIA, OFFICE

RECEIVED
DEC 18 1975
U.S. GEOLOGICAL SURVEY
ARTESIA, NEW MEXICO

IN ABOVE SPACE DESCRIBE PROPOSED PROGRAM: If proposal is to deepen or plug back, give data on present productive zone and proposed new productive zone. If proposal is to drill or deepen directionally, give pertinent data on subsurface locations and measured and true vertical depths. Give blowout preventer program, if any.

24.

SIGNED

Lois Taylor

TITLE

Office Manager

DATE

12/17/75

(This space for Federal or State office use)

PERMIT NO.

APPROVAL DATE

APPROVED
JAN 6 - 1976

CONDITIONS OF APPROVAL, IF ANY:

H. L. BEEKMAN
ACTING DISTRICT ENGINEERTHIS APPROVAL IS RESCINDED IF OPERATIONS
ARE NOT COMMENCED WITHIN 3 MONTHS.
APR 05 1976
See Instructions On Reverse Side

NEW MEXICO OIL CONSERVATION COMMISSION
WELL LOCATION AND ACREAGE DEDICATION PLAT

Form C-102
Supersedes C-128
Effective 1-1-65

All distances must be from the outer boundaries of the Section

Operator McClellan Oil Corporation			Lease Sulimar Queen Unit Tract 1		Well No. 11
Grid Letter K	Section 24	Township 15 South	Range 29 East	County Chaves	
Actual Portage Location of Well: 1370 feet from the West line and 2615 feet from the South line					
Ground Level Elev. 3935.8	Producing Formation Queen sand		Pool Sulimar Queen	Dedicated Acreage 40	

1. Outline the acreage dedicated to the subject well by colored pencil or hatchure marks on the plat below.
2. If more than one lease is dedicated to the well, outline each and identify the ownership thereof (both as to working interest and royalty).
3. If more than one lease of different ownership is dedicated to the well, have the interests of all owners been consolidated by communitization, unitization, force-pooling, etc?

☐ Yes ☐ No If answer is "yes," type of consolidation _____

If answer is "no," list the owners and tract descriptions which have actually been consolidated. (Use reverse side of this form if necessary.) _____

No allowable will be assigned to the well until all interests have been consolidated (by communitization, unitization, forced-pooling, or otherwise) or until a non-standard unit, eliminating such interests, has been approved by the Commission.

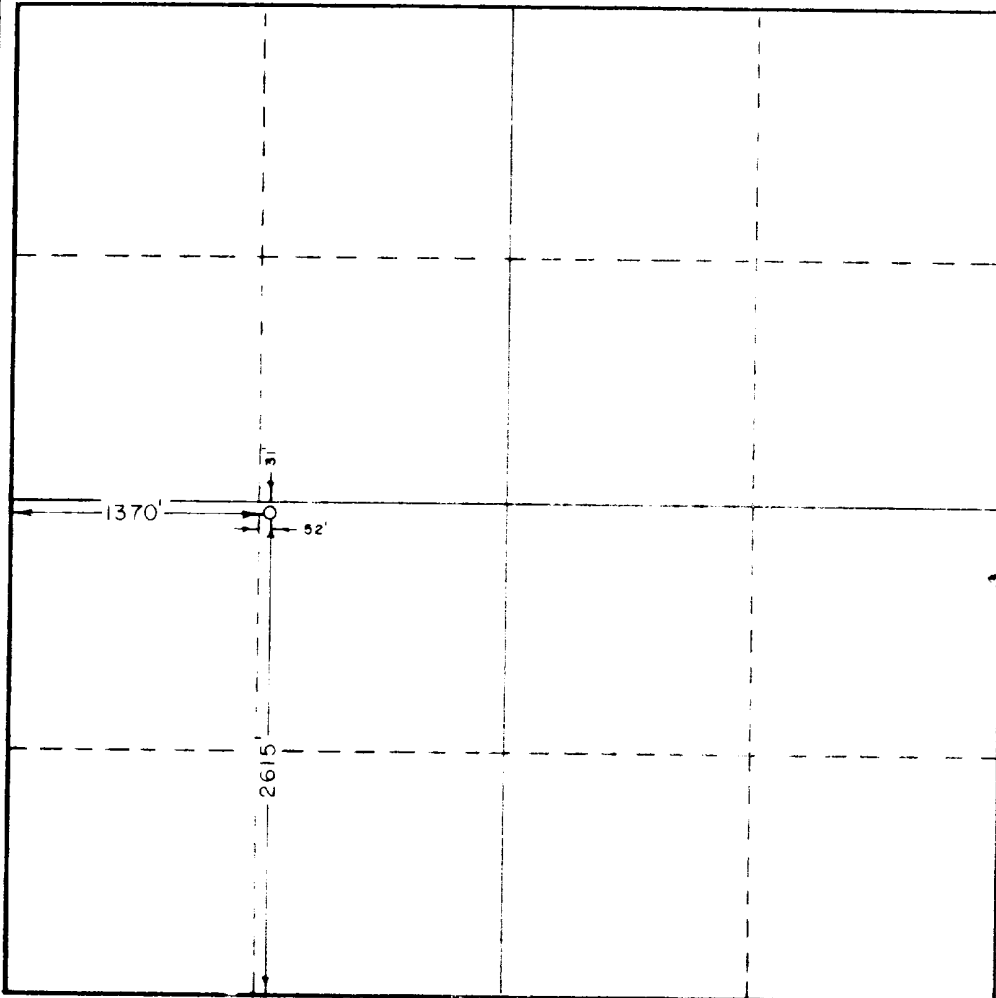

CERTIFICATION

I hereby certify that the information contained herein is true and complete to the best of my knowledge and belief.

Lois Taylor
Name

Lois Taylor

Position

Office Manager

Company

McClellan Oil Corporation

Date

12/17/75

RECEIVED
U.S. GEOLOGICAL SURVEY
ARTESIA, NEW MEXICO
I hereby certify that the well location shown on this plat was plotted from field notes of actual surveys made by me or under my supervision and that the same is true and correct to the best of my knowledge and belief.

Date surveyed

December 93, 1975

Registered Professional Engineer and Surveyor

676

JOHN W. WOOD

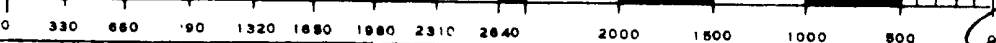



McClellan Oil Corporation

Re: McClellan Oil Corporation
Sulimar Queen Unit TRACT I-11

The following is a Plan of Development for Surface Use required to drill the proposed well attached to this application:

1. State Highway 31 is approximately $3\frac{1}{2}$ miles North of the main County road running North to South 200' East of the location.
2. The proposed road will be the only road into the proposed drillsite. 218' of new road will be constructed.
3. Wells are shown on the attached plat.
4. The production, if achieved, will be pumped into a tank battery located on TRACT I of this Unit.
5. Drilling water will have to be trucked in as there is no source of fresh water in this area.
6. After completion of drilling operations all waste will be buried in a separate pit or hauled away.
7. Any produced brine water will be removed by truck in order to prevent contamination of any possible fresh water bearing sands in this area.
8. Casinghead gas, if any, will be taken by Phillips Petroleum Company, the present purchasers of gas in the Sulimar Queen Unit.
9. Application for connection will be made immediately upon completion.
10. An attached development plat indicates location layout, rig plan, etc.
11. In the event production is not achieved, this test will be used as an injection well.
12. If production is achieved, pad and roads will remain in effect. Pits will be filled and restored, as near as possible, to their original condition.
13. This test will be drilled with cable tool drilling rig.

RECEIVED
DEC 19 1975
U. S. GEOLOGICAL SURVEY
ARTESIA, NEW MEXICO

ML

McCLELLAN OIL CORPORATION

Box 849

ROSWELL, NEW MEXICO 88201

State Highway 31 - Maljamar Cutoff Road

Sulimar Queen Unit

TRACT I-11

Unit K-Sec. 24-15S-29

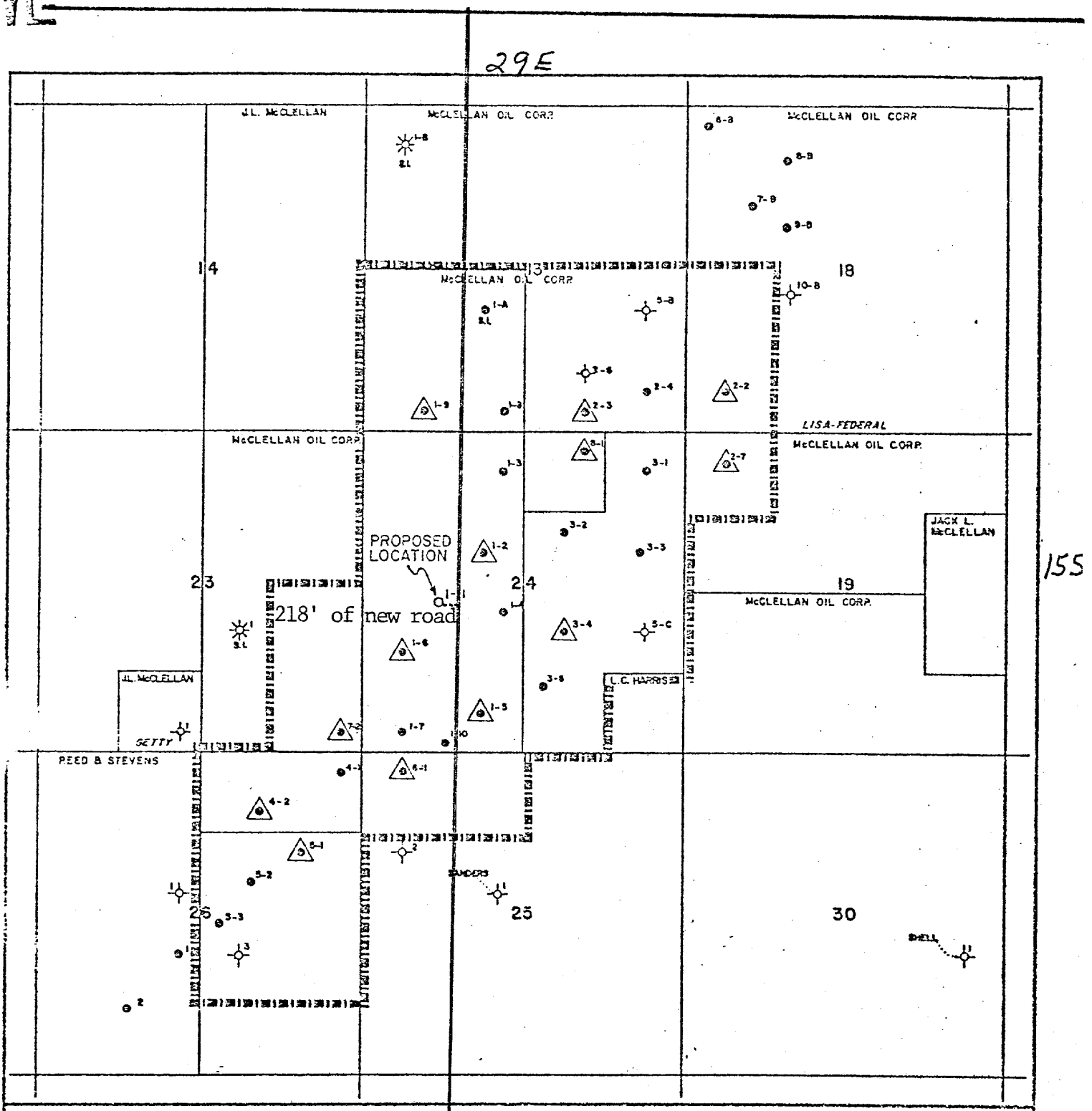

29E

155

---18 miles to Loco Hills

45'

PIT

○ WATER TANK

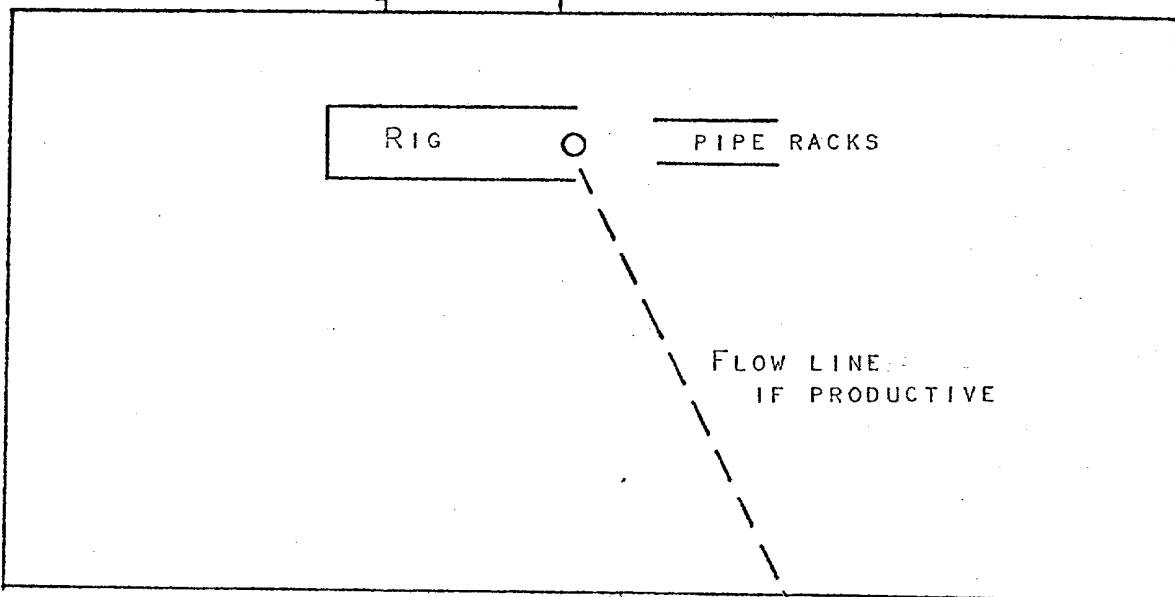

106

180'

○ TANK BATTERY IF PRODUCTIVE