

NO. OF COPIES RECEIVED	6
DISTRIBUTION	
SANTA FE	1
FILE	1
U.S.G.S.	2
LAND OFFICE	1
OPERATOR	1

NEW MEXICO OIL CONSERVATION COMMISSION
RECEIVED

30-005-60374
Form C-101
Revised 1-1-65

MAR 3 1976

O. C. C.

ARTESIA OFFICE

APPLICATION FOR PERMIT TO DRILL, DEEPEN, OR PLUG BACK

1a. Type of Work		7. Unit Agreement Name	
b. Type of Well DRILL <input checked="" type="checkbox"/> DEEPEN <input type="checkbox"/> PLUG BACK <input type="checkbox"/> OIL WELL <input checked="" type="checkbox"/> GAS WELL <input checked="" type="checkbox"/> OTHER <input type="checkbox"/> SINGLE ZONE <input type="checkbox"/> MULTIPLE ZONE <input type="checkbox"/>		Dunkin Dome Unit	
2. Name of Operator Yates Petroleum Corporation		8. Farm or Lease Name Dunkin Dome State Unit	
3. Address of Operator 207 South 4th Street - Artesia, NM		9. Well No. 1	
4. Location of Well UNIT LETTER K LOCATED 1700 FEET FROM THE West LINE AND 1980 FEET FROM THE South LINE OF SEC. 7 TWP. 17S RGE. 18E NMPM		10. Field and Pool, or Wildcat Wildcat	
		12. County Chaves	
		19. Proposed Depth Approx. 6000'	
		19A. Formation Devonian	
		20. Rotary or C.T. Rotary	
21. Elevations (Show whether DF, RT, etc.) 5392' GR		21A. Kind & Status Plug. Bond Blanket	
		21B. Drilling Contractor Ard Drilling Co.	
		22. Approx. Date Work will start As soon as approved	

PROPOSED CASING AND CEMENT PROGRAM

SIZE OF HOLE	SIZE OF CASING	WEIGHT PER FOOT	SETTING DEPTH	SACKS OF CEMENT	EST. TOP
17½"	13-3/8"	48#	120'	100 Circulate	
12½"	9-5/8"	32#	1150'	450 Circulate	
8-3/4"	7" or 5½"	20# or 15.5#			

Propose to drill to granite and test all possible hydrocarbon pays. Surface casing will be run if needed; 9-5/8" casing will be set about 150 feet below the Glorietta top. If difficulty is encountered before total depth, will consider running 7" casing or liner and finishing hole w/6½" bit.

Mud Program: - Gel and LCM to 2500', Low Fluid Loss mud to total depth.

BOP Program: - BOP's Hydril will be installed on 9-7/8" casing, tested daily.

APPROVAL VALID
FOR 90 DAYS UNLESS
DRILLING COMMENCED,

EXPIRES 6-9-76

IN ABOVE SPACE DESCRIBE PROPOSED PROGRAM: IF PROPOSAL IS TO DEEPEN OR PLUG BACK, GIVE DATA ON PRESENT PRODUCTIVE ZONE AND PROPOSED NEW PRODUCTIVE ZONE. GIVE BLOWOUT PREVENTER PROGRAM, IF ANY.

I hereby certify that the information above is true and complete to the best of my knowledge and belief.

Signed Eddie L. Gussett Title Engineer Date 3-3-76

(This space for State Use)

APPROVED BY W. A. Gussett TITLE SUPERVISOR, DISTRICT II DATE MAR 9 1976

CONDITIONS OF APPROVAL, IF ANY:

Cement must be circulated to
surface behind 13 3/8" & 9 5/8" casing

Notify N.M.O.C.C. in sufficient
time to witness cementing
the 9 5/8" casing

WELL LOCATION AND ACREAGE DEDICATION PLAT

Form C-102
Supersedes C-128
Effective 4-1-65

All distances must be from the outer boundaries of the Section.

Operator YATES PETROLEUM CORP.			Lease Dunken State Unit		Well No. 1
Unit Letter K	Section 7	Township 17 SOUTH	Range 18 EAST	County CHAVES	
Actual Footage Location of Well: 1980 feet from the SOUTH line and 1700 feet from the WEST line					
Ground Level Elev. 5392	Producing Formation Devonian		Pool Wildcat		Dedicated Acreage: 40 Acres

1. Outline the acreage dedicated to the subject well by colored pencil or hatchure marks on the plat below.
2. If more than one lease is dedicated to the well, outline each and identify the ownership thereof (both as to working interest and royalty).
3. If more than one lease of different ownership is dedicated to the well, have the interests of all owners been consolidated by communitization, unitization, force-pooling, etc?

☐ Yes ☐ No If answer is "yes," type of consolidation _____

If answer is "no," list the owners and tract descriptions which have actually been consolidated. (Use reverse side of this form if necessary.) _____

No allowable will be assigned to the well until all interests have been consolidated (by communitization, unitization, forced-pooling, or otherwise) or until a non-standard unit, eliminating such interests, has been approved by the Commission.

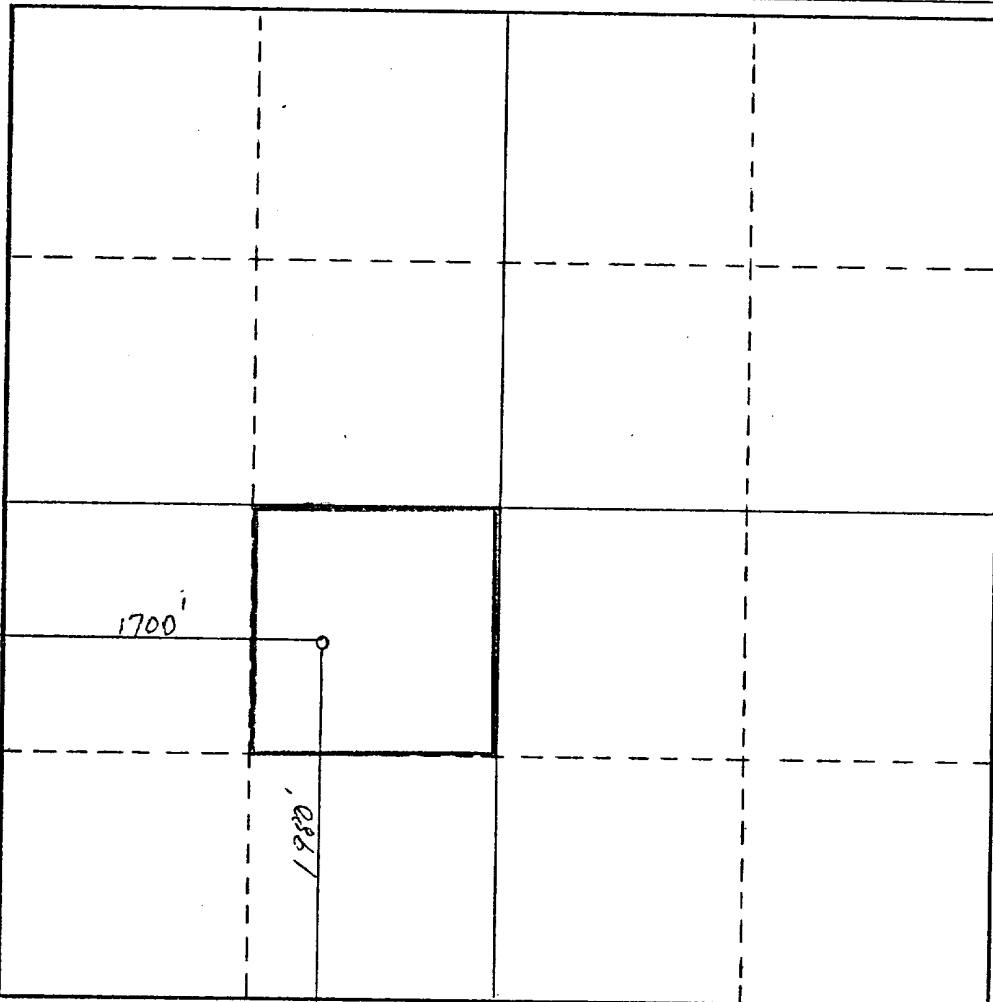

CERTIFICATION

I hereby certify that the information contained herein is true and complete to the best of my knowledge and belief.

Name

Eddie M. Mahfood

Position

Engineer

Company

Yates Petroleum Corp.

Date

3-3-76

I hereby certify that the well location shown on this plat was plotted from field notes of actual surveys made by me or under my supervision, and that the same is true and correct to the best of my knowledge and belief.

Date Surveyed

February 20, 1976

Registered Professional Engineer and/or Land Surveyor

Certificate No.

1502

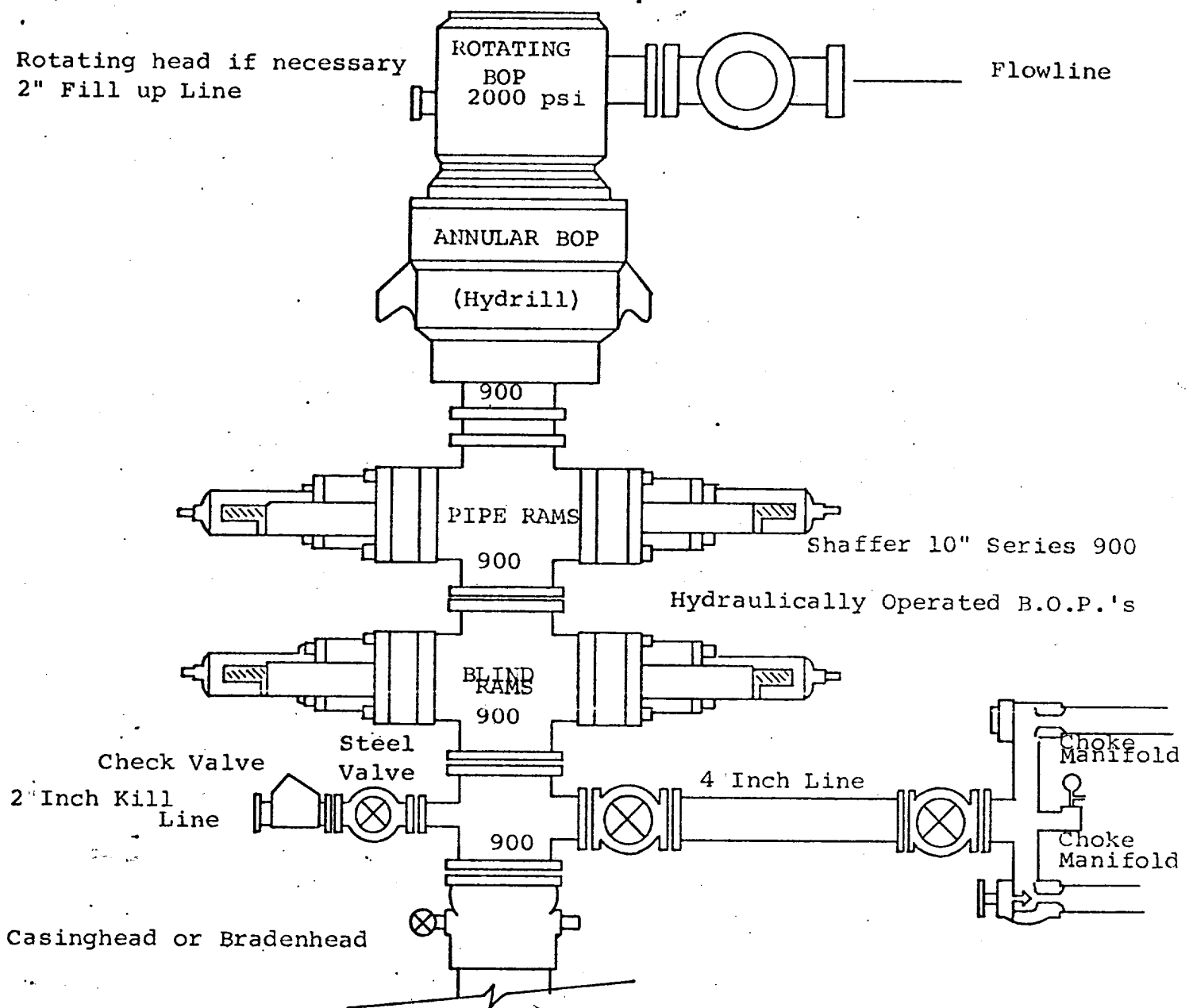

THE FOLLOWING CONSTITUTE MINIMUM BLOWOUT PREVENTER REQUIREMENTS

1. All preventers to be hydraulically operated with secondary manual controls installed prior to drilling out from under casing.
2. Choke outlet to be a minimum of 4" diameter.
3. Kill line to be of all steel construction of 2" minimum diameter.
4. All connections from operating manifolds to preventers to be all steel. hole or tube a minimum of one inch in diameter.
5. The available closing pressure shall be at least 15% in excess of that required with sufficient volume to operate the B.O.P.'s.
6. All connections to and from preventer to have a pressure rating equivalent to that of the B.O.P.'s.
7. Inside blowout preventer to be available on rig floor.
8. Operating controls located a safe distance from the rig floor.
9. Hole must be kept filled on trips below intermediate casing. Operator not responsible for blowouts resulting from not keeping hole full.
10. D. P. float must be installed and used below zone of first gas intrusion.