

NO. OF COPIES RECEIVED	5
DISTRIBUTION	
SANTA FE	1
FILE	1
U.S.G.S.	2
LAND OFFICE	1
OPERATOR	1

NEW MEXICO CONSERVATION COMMISSION

JUN 15 1976

O. C. C.
ARTESIA, OFFICE

30-005-60383

Form C-101
Revised 1-1-65

5A. Indicate Type of Lease	
STATE <input checked="" type="checkbox"/>	FEE <input type="checkbox"/>
5. State Oil & Gas Lease No. K-6138	

APPLICATION FOR PERMIT TO DRILL, DEEPEN, OR PLUG BACK

1a. Type of Work		7. Unit Agreement Name <i>Dunkan Nose Unit</i>	
b. Type of Well DRILL <input checked="" type="checkbox"/> DEEPEN <input type="checkbox"/> PLUG BACK <input type="checkbox"/> OIL WELL <input type="checkbox"/> GAS WELL <input checked="" type="checkbox"/> OTHER <input type="checkbox"/> SINGLE ZONE <input type="checkbox"/> MULTIPLE ZONE <input type="checkbox"/>		8. Farm or Lease Name Dunkan Nose Unit	
2. Name of Operator Yates Petroleum Corporation		9. Well No. 1	
3. Address of Operator 207 South 4th Street - Artesia, NM 88210		10. Field and Pool, or Wildcat Wildcat	
4. Location of Well UNIT LETTER <u>B</u> LOCATED <u>660</u> FEET FROM THE <u>North</u> LINE AND <u>1980</u> FEET FROM THE <u>East</u> LINE OF SEC. <u>10</u> TWP. <u>17S</u> RGE. <u>18E</u> NMPM		12. County <u>Madrid</u>	
19. Proposed Depth Approx 4900'		19A. Formation Penn.	20. Rotary or C.T. Rotary
21. Elevations (Show whether DF, RT, etc.) 5255 GR	21A. Kind & Status Plug. Bond Blanket	21B. Drilling Contractor Byrd Drilling Co.	22. Approx. Date Work will start June 16, 1976

23.

PROPOSED CASING AND CEMENT PROGRAM

SIZE OF HOLE	SIZE OF CASING	WEIGHT PER FOOT	SETTING DEPTH	SACKS OF CEMENT	EST. TOP
12 1/4"	9-5/8"	32.38#	Approx. 1300'	Circulate	
8-3/4"	5 1/2 or 4 1/2"	15.5-17# or 10.5-11.6#	TD		

Propose to drill 4800' and test the Pennsylvanian and intermediate horizons. 9-5/8" casing will be run thru the porosity to 1200' or 1300' and cement to the surface. If commercial pay is encountered, will run 5 1/2 or 4 1/2" casing. (If hole conditions necessitate intermediate casing before reaching total depth 7" casing will be run and cemented, then hole will be reduced to 6 1/4").
Mud Program: - Fresh water gel & LCM to 1300', flosal-driskpak mud w/LCM to total depth.

BOP Program: - BOP's will be installed on 9-5/8" casing and pipe rams tested daily, blind rams tested on trips.

Gas acreage not dedicated

APPROVAL VALID
FOR 90 DAYS UNLESS
DRILLING COMMENCED,

EXPIRES 9-16-76

IN ABOVE SPACE DESCRIBE PROPOSED PROGRAM: IF PROPOSAL IS TO DEEPEN OR PLUG BACK, GIVE DATA ON PRESENT PRODUCTIVE ZONE AND PROPOSED NEW PRODUCTIVE ZONE. GIVE BLOWOUT PREVENTER PROGRAM, IF ANY.

I hereby certify that the information above is true and complete to the best of my knowledge and belief.

Signed Christine Tomlinson Title Geol. Secty Date 6-15-76

(This space for State Use)

APPROVED BY W. A. Gressett TITLE SUPERVISOR, DISTRICT II DATE JUN 16 1976

CONDITIONS OF APPROVAL, IF ANY:

Unit name
subject to Case # 5677
D 5228 6-22-76

Cement must be circulated to
surface behind 9 5/8" casing

Notify N.M.O.C.C. in sufficient
time to witness cementing
the 9 5/8" casing

MEXICO OIL CONSERVATION COMMISSION
WELL LOCATION AND ACREAGE DEDICATION PLAT

Form C-102
Supersedes C-128
Effective 1-1-65

All distances must be from the outer boundaries of the Section.

Operator <i>Yates Petroleum Corporation</i>			Lease <i>Dunkin Nose</i>		Well No. <i>1</i>
Unit Letter <i>B</i>	Section <i>10</i>	Township <i>17 South</i>	Range <i>18 East</i>	County <i>Chaves</i>	
Actual Footage Location of Well: <i>660</i> feet from the <i>North</i> line and <i>1980</i> feet from the <i>East</i> line.					
Ground Level Elev. <i>5255</i>	Producing Formation <i>Pennsylvanian</i>		Pool <i>Wildcat</i>	Dedicated Acreage: <i>320</i> Acres	

1. Outline the acreage dedicated to the subject well by colored pencil or hachure marks on the plat below.
2. If more than one lease is dedicated to the well, outline each and identify the ownership thereof (both as to working interest and royalty).
3. If more than one lease of different ownership is dedicated to the well, have the interests of all owners been consolidated by communitization, unitization, force-pooling, etc?

☐ Yes ☐ No If answer is "yes," type of consolidation _____

If answer is "no," list the owners and tract descriptions which have actually been consolidated. (Use reverse side of this form if necessary.) _____

No allowable will be assigned to the well until all interests have been consolidated (by communitization, unitization, forced-pooling, or otherwise) or until a non-standard unit, eliminating such interests, has been approved by the Commission.

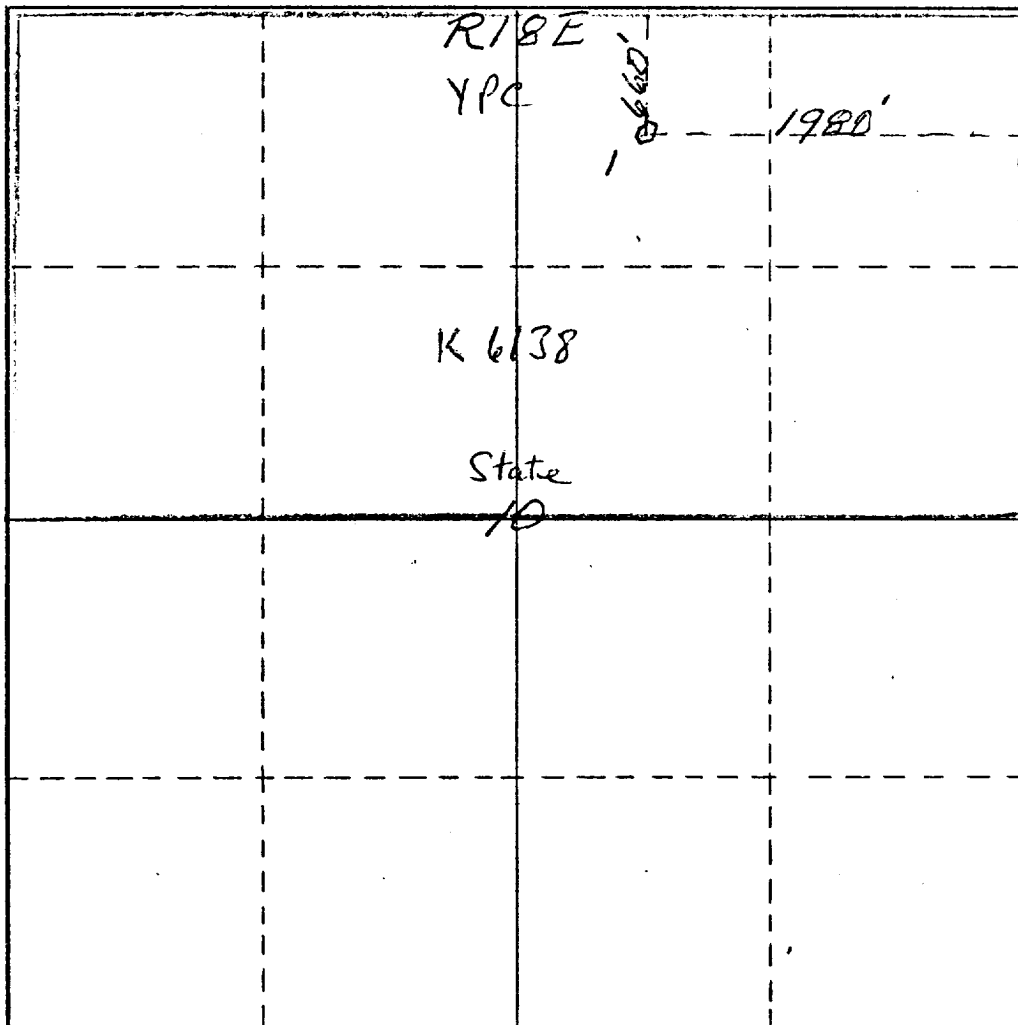

CERTIFICATION

I hereby certify that the information contained herein is true and complete to the best of my knowledge and belief.

Eddie M. Mahfood
Name

Eddie M. Mahfood
Position
Engineer

Company
Yates Petroleum Corp.

Date
6-15-76

I hereby certify that the well location shown on this plat was plotted from field notes of a legal survey made by me or under my supervision, and that the same is true and correct to the best of my knowledge and belief.

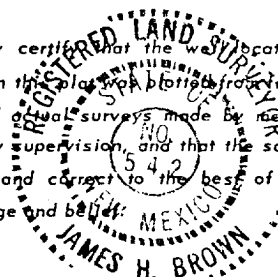

Date Surveyed
June 4th 1976
Registered Professional Engineer
and/or Land Surveyor

James H. Brown
Certificate No. *542*

0 330 660 990 1320 1650 1980 2310 2640 2000 1500 1000 500 0

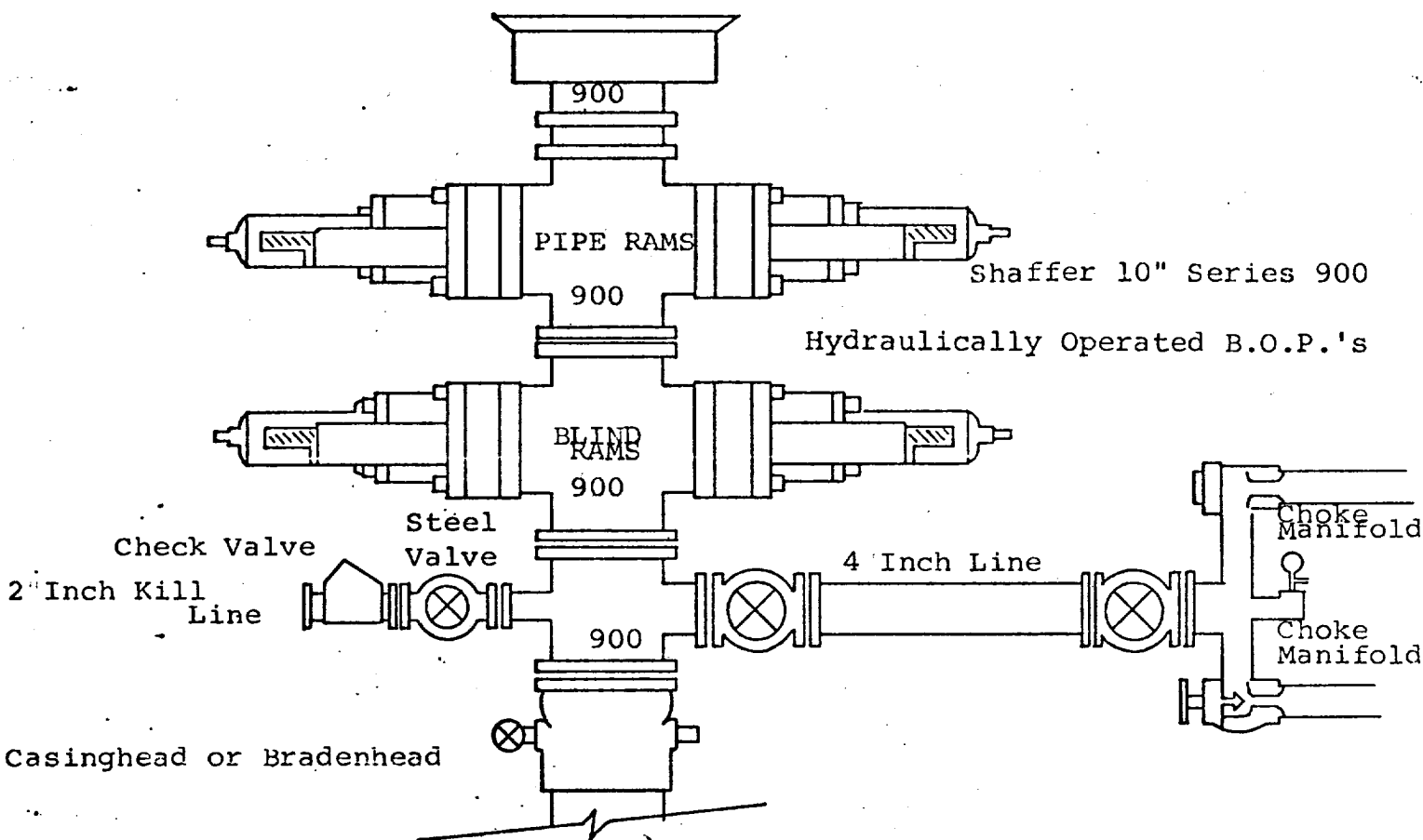

THE FOLLOWING CONSTITUTE MINIMUM BLOWOUT PREVENTER REQUIREMENTS

1. All preventers to be hydraulically operated with secondary manual controls installed prior to drilling out from under casing.
2. Choke outlet to be a minimum of 4" diameter.
3. Kill line to be of all steel construction of 2" minimum diameter.
4. All connections from operating manifolds to preventers to be all steel, hole or tube a minimum of one inch in diameter.
5. The available closing pressure shall be at least 15% in excess of that required with sufficient volume to operate the B.O.P.'s.
6. All connections to and from preventer to have a pressure rating equivalent to that of the B.O.P.'s.
7. Inside blowout preventer to be available on rig floor.
8. Operating controls located a safe distance from the rig floor.
9. Hole must be kept filled on trips below intermediate casing. Operator not responsible for blowouts resulting from not keeping hole full.
10. D. P. float must be installed and used below zone of first gas intrusion.