

N MEXICO OIL CONSERVATION COMMISS
WELL LOCATION AND ACREAGE DEDICATION PLAT

Form C-102
 Supersedes C-128
 Effective 1-1-65

All distances must be from the outer boundaries of the Section

Operator MOUNTAIN STATES PETROLEUM CORP.			Lease Brotar		Well No. 2
Unit Letter P	Section 20	Township 15 South	Range 28 East	County Chaves	
Actual Footage Location of Well: 958 feet from the south line and 958 feet from the east line					
Ground Level Elev. 3610.7	Producing Formation Queen - Premier		Pool Wildcat		Dedicated Acreage: 160 Acres

1. Outline the acreage dedicated to the subject well by colored pencil or hatchure marks on the plat below.
2. If more than one lease is dedicated to the well, outline each and identify the ownership thereof (as to working interest and royalty).
3. If more than one lease of different ownership is dedicated to the well, have the interests of all owners been consolidated by communitization, unitization, force-pooling, etc?

☐ Yes ☐ No If answer is "yes," type of consolidation _____

If answer is "no," list the owners and tract descriptions which have actually been consolidated. (Use reverse side of this form if necessary.) _____

No allowable will be assigned to the well until all interests have been consolidated (by communitization, unitization, forced-pooling, or otherwise) or until a non-standard unit, eliminating such interests, has been approved by the Commission.

RECEIVED
 MAR 30 1977
 U.S. GEOLOGICAL SURVEY
 ARTESIA, NEW MEXICO

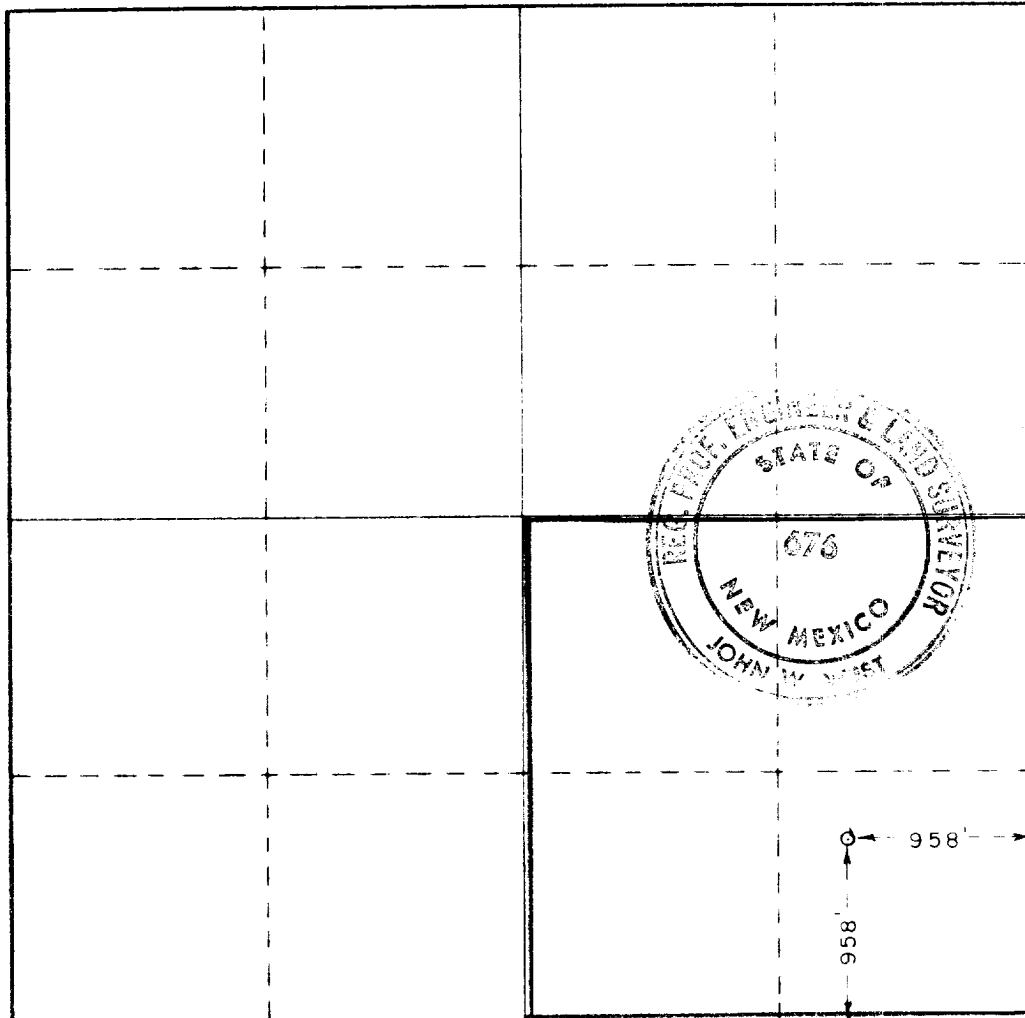

CERTIFICATION

I hereby certify that the information contained herein is true and complete to the best of my knowledge and belief.

KCHavenor

Kay C. Havenor

Geologist

Mountain States Pet. Corp.

Mar. 28, 1977

I hereby certify that the well location shown on this plat was plotted from field notes of actual surveys made by me or under my supervision, and that the same is true and correct to the best of my knowledge and belief.

Date Surveyed

Mar. 25, 1977

Registered Professional Engineer and Land Surveyor

John W. West

Certificate No. **676**

