

UNITED STATES
DEPARTMENT OF THE INTERIOR
GEOLOGICAL SURVEY

30-005-60458

APPLICATION FOR PERMIT TO DRILL, DEEPEN, OR PLUG BACK

1a. TYPE OF WORK

DRILL ☒DEEPEN ☐PLUG BACK ☐

b. TYPE OF WELL

OIL
WELL ☒GAS
WELL ☐

OTHER

SINGLE
ZONE ☐MULTIPLE
ZONE ☐

2. NAME OF OPERATOR

Harvey E. Yates Company

3. ADDRESS OF OPERATOR

P. O. Box 1933, Roswell, New Mexico 88201

4. LOCATION OF WELL (Report location clearly and in accordance with any State requirements.)*

At surface

1650' FSL & 1980' FEL

At proposed prod. zone

Same

14. DISTANCE IN MILES AND DIRECTION FROM NEAREST TOWN OR POST OFFICE*

Approximately 18 miles east of Hagerman & 2 miles north of Hwy

15. DISTANCE FROM PROPOSED*

LOCATION TO NEAREST
PROPERTY OR LEASE LINE, FT.

(Also to nearest drlg. unit line, if any)

330'

16. NO. OF ACRES IN LEASE

80

17. NO. OF ACRES ASSIGNED
TO THIS WELL

40

18. DISTANCE FROM PROPOSED LOCATION*
TO NEAREST WELL, DRILLING, COMPLETED,
OR APPLIED FOR, ON THIS LEASE, FT.

None

19. PROPOSED DEPTH

10,300'

20. ROTARY OR CABLE TOOLS

Rotary

21. ELEVATIONS (Show whether DF, RT, GR, etc.)

3854.05' GL

22. APPROX. DATE WORK WILL START*

November 15, 1977

23. PROPOSED CASING AND CEMENTING PROGRAM

SIZE OF HOLE	SIZE OF CASING	WEIGHT PER FOOT	SETTING DEPTH	QUANTITY OF CEMENT
17"	13 3/8"	48#	300'	300 Sx Circulate
12 1/4"	8 5/8"	2500' - 24# & 1500' - 32#	4000'	450 Sx
7 7/8"	5 1/2"	17#	10,300'	Sufficient cement to cover producing horizons

Mud Program: Fresh water system from surface to 5500'
Cut brine and mud system from 5500' to TD

BOP Program: One Shaffer LWS hydraulic double 10" X 1500 series. One Hydril
10" X 1500 series. Choke manifold 4" X 1500 series flanged
connections.
Payne 4 valve accumulator closing unit.

RECEIVED

OCT 3 1977

U. S. GEOLOGICAL SURVEY

ARTESIA, N.M.

IN ABOVE SPACE DESCRIBE PROPOSED PROGRAM: If proposal is to deepen or plug back, give data on present productive zone. If proposal is to drill or deepen directionally, give pertinent data on subsurface locations and measured and true vertical depths. Give blowout preventer program, if any.

24.

SIGNED

Ind. Yates

TITLE Vice President

DATE 10-1-77

(This space for Federal or State office use)

PERMIT NO.

APPROVAL DATE

APPROVED BY

CONDITIONS OF APPROVAL, IF ANY:

THIS APPROVAL IS RESCINDED IF OPERATIONS
ARE NOT COMMENCED WITHIN 2 MONTHS.

DATE

0012-101
R. L. ...
ACTING DISTRICT ENGINEER

JAN 21 1978
*See Instructions On Reverse Side

N MEXICO OIL CONSERVATION COMMISS
WELL LOCATION AND ACREAGE DEDICATION PLAT

Form C-102
Supersedes C-128
Effective 1-1-65

All distances must be from the outer boundaries of the Section.

Operator Harvey E. Yates Company			Lease King Camp Deep 8		Well No. #1
Unit Letter J	Section 28	Township 14 S	Range 29 E	County Chaves	
Actual Footage Location of Well: 1650 feet from the south line and 1980 feet from the east line					
Ground Level Elev. 3854.05	Producing Formation Devonian		Pool King Camp Deep Wildcat	Dedicated Acreage 40 Acres	

1. Outline the acreage dedicated to the subject well by colored pencil or hachure marks on the plat below.
2. If more than one lease is dedicated to the well, outline each and identify the ownership thereof (both as to working interest and royalty).
3. If more than one lease of different ownership is dedicated to the well, have the interests of all owners been consolidated by communitization, unitization, force-pooling, etc?

RECEIVED

OCT 3 1977

**U. S. GEOLOGICAL SURVEY
ARTESIA, NEW MEXICO**

☐ Yes ☐ No If answer is "yes," type of consolidation _____

If answer is "no," list the owners and tract descriptions which have actually been consolidated. (Use reverse side of this form if necessary.) _____

No allowable will be assigned to the well until all interests have been consolidated (by communitization, unitization, forced-pooling, or otherwise) or until a non-standard unit, eliminating such interests, has been approved by the Commission.

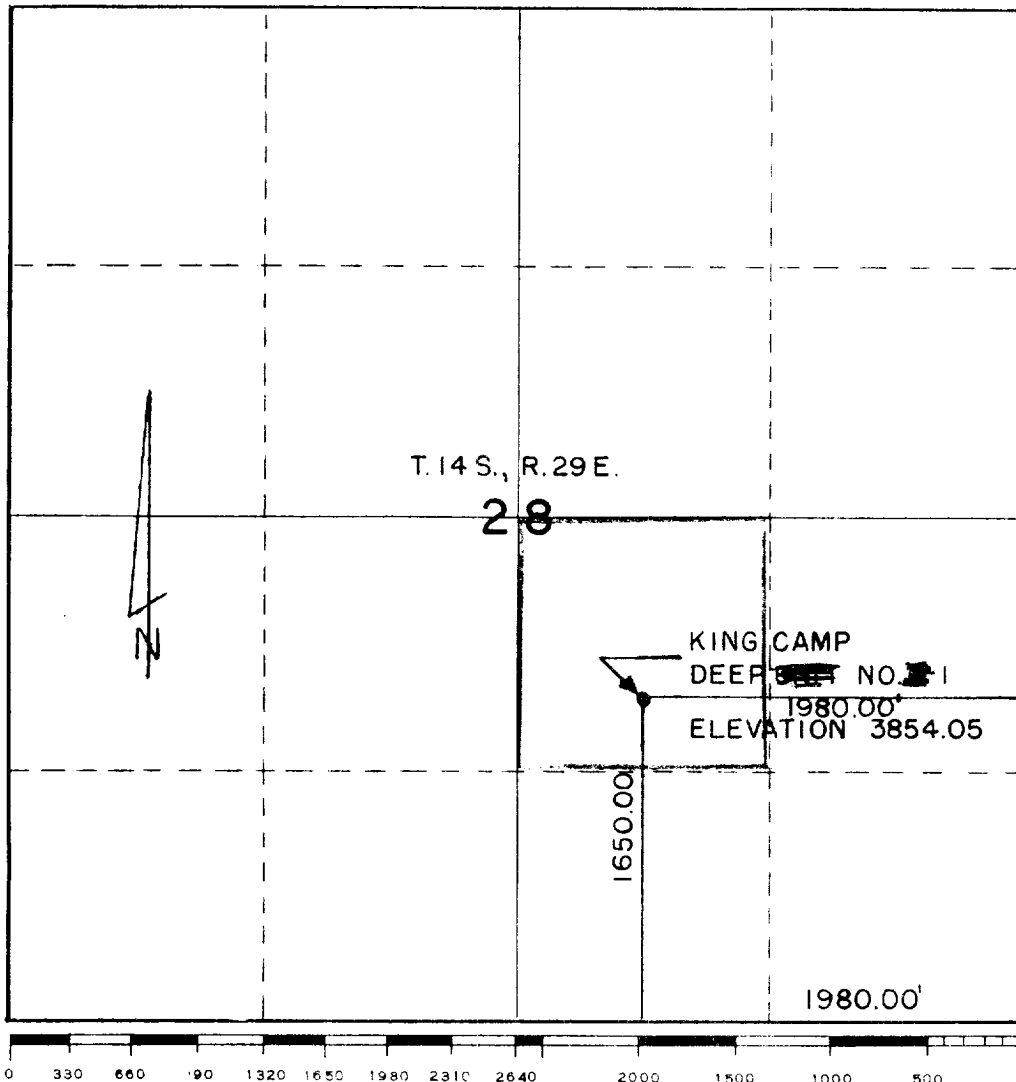

CERTIFICATION

I hereby certify that the information contained herein is true and complete to the best of my knowledge and belief.

Paul G. Yates

Position
Vice President

Company
Harvey E. Yates Company

Date
October 1, 1977

I hereby certify that the well location shown on this plat was plotted from field notes of actual surveys made by me or under my supervision, and that the same is true and correct to the best of my knowledge and belief.

Date Surveyed
9-23-77

Registered Professional Engineer
and/or Land Surveyor

Thomas L. Mann

Certificate No.

NM 277

CHOKE MANIFOLD

1500 SERIES

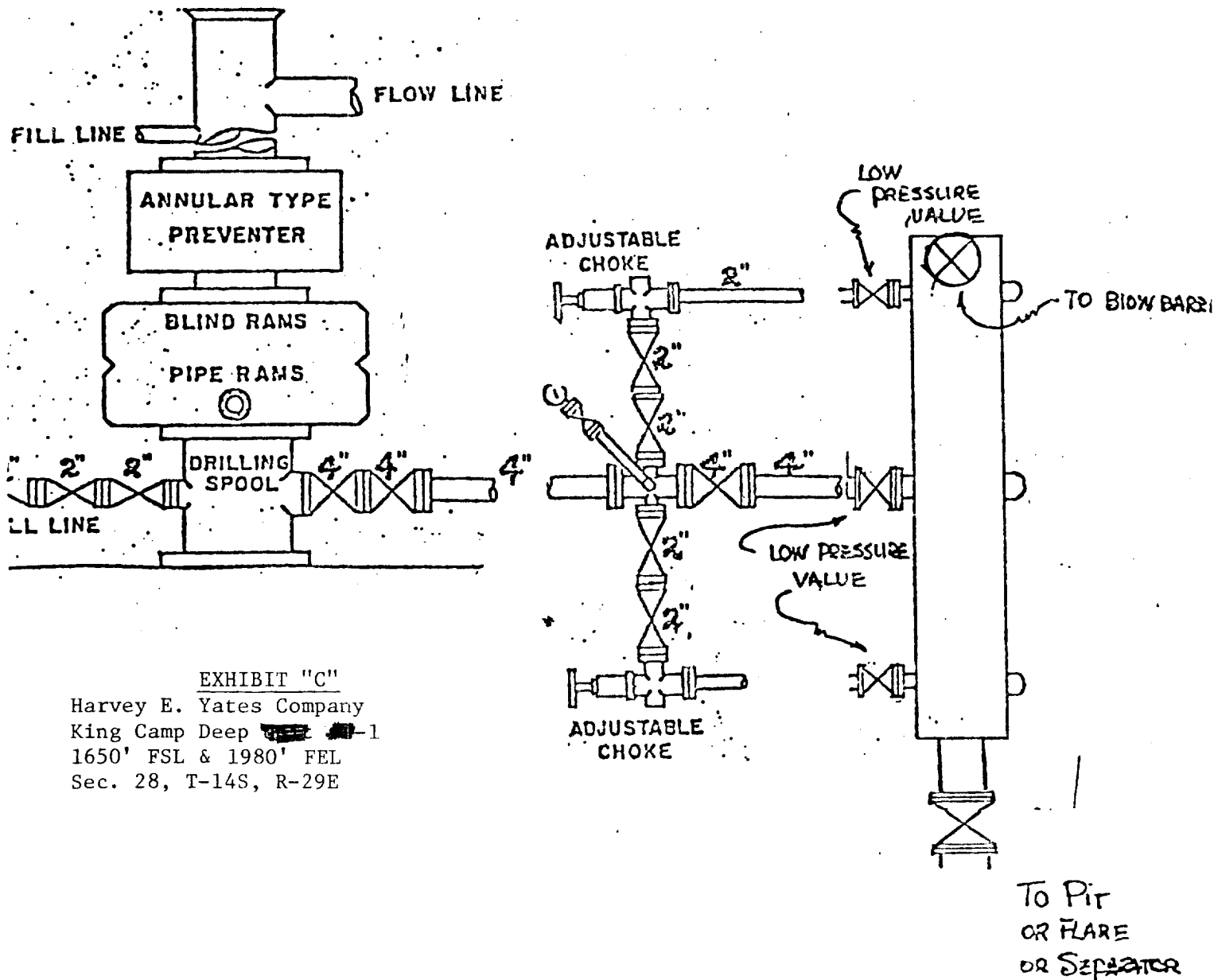
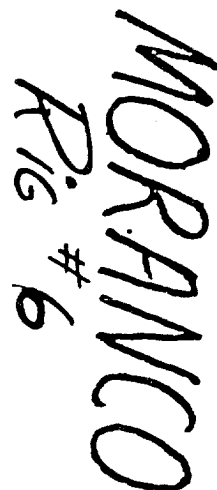

EXHIBIT "C"

Harvey E. Yates Company
 King Camp Deep ~~1650'~~ 1650' FSL & 1980' FEL
 Sec. 28, T-14S, R-29E



Harvey E. Yates Company
King Camp Deep ~~XXXX~~ ~~XXXX~~-1
1650' FSL & 1980' FEL
Sec. 28, T-14S, R-29E

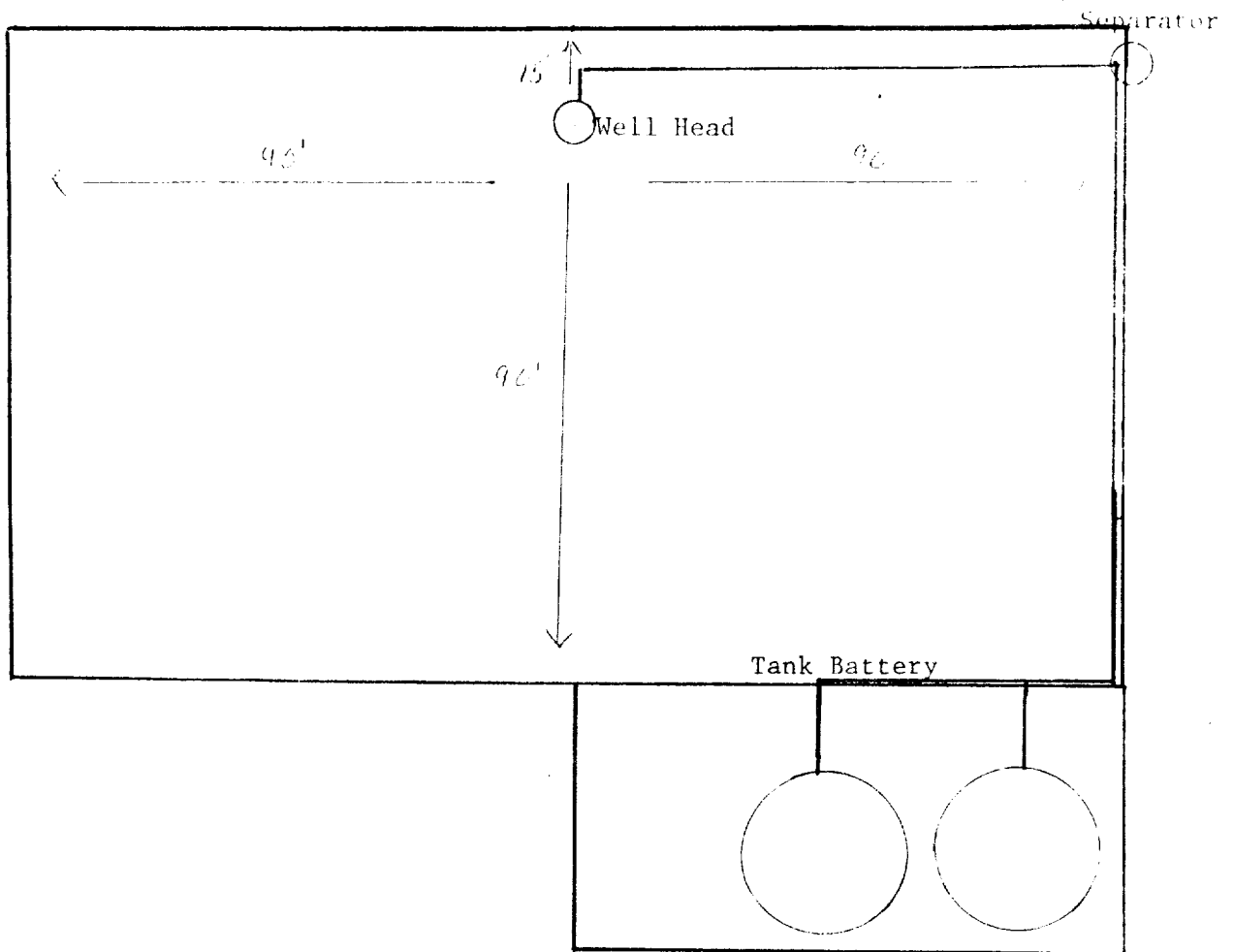

EXHIBIT "E"

Harvey E. Yates Company
 King Camp Deep ~~1650'~~ -1
 1650' FSL & 1980' FEL
 Sec. 28, T-14S, R-29E

APPLICATION FOR DRILLING

Harvey E. Yates Company
King Camp Deep ~~Well~~ #1
Chaves County, New Mexico

In conjunction with Form 9-331C, Application for Permit Drill subject well in Section 28, Township 14S, Range 29E, Chaves County, New Mexico, Harvey E. Yates Company submits the following ten items of pertinent information in accordance with the U.S.G.S requirements:

1. The geologic surface formation is quaternary alluvium and bolson deposits and othe surficial deposits.
2. The estimated tops of geologic markers are as follows KB measurement:

Yates	1069'
Seven Rivers	1284'
Bowers	1607'
Queen	1787'
Grayburg	2107'
San Andres	2385'
Glorieta	3904'
Tubb	5162'
Abo	5942'
Wolfcamp	7154'
Bursum	7542'
Cisco	7816'
Strawn	8741'
Atoka	9099'
Chester	9471'
Lower Miss. Ls	9588'
Woodford	10,063'
Siluro-Devonian	10,122'
Total Depth	10,300'

3. We do not anticipate finding water but have listed the formations in which we anticipate finding oil or gas:

Queen at approximately 1787'
Atoka at approximately 9099'
Siluro-Devonian at approximately 10,122'
Total Depth 10,300'

4. Proposed casing program: See Form 9-331C
5. Pressure control equipment: See Form 9-331C and Exhibit C
6. Mud program: See Form 9-331C
7. Auxiliary equipment: Blowout Preventer
8. Testing, logging and coring programs: Compensated Neutron Formation Density CNL, Dual Laterolog RXO and BHC Sonic. Possible coring in the Queen formation. Possible DST's in the Atoka and Devonian formations.
9. No abnormal pressures or temperatures are anticipated.
10. Anticipated starting date: As soon as possible after approval but not later than November 15, 1977.

RECEIVED

OCT 3 1977

U. S. GEOLOGICAL SURVEY
ARTESIA, NEW MEXICO

SURFACE USE PLAN

HARVEY E. YATES COMPANY
King Camp Deep ~~73~~ 73-1
1650' FSL & 1980' FEL - Sec. 28, T-14S, R-29E
Chaves County, New Mexico

1. EXISTING ROADS:

- A. Exhibit A is a portion of a highway map showing the location of the proposed well. The location of this proposed well is approximately 20 miles east of Hagerman, New Mexico. Travel east from Hagerman on Highway 31 for approximately 18 miles. Turn north on the road that intersects Highway 31. Travel on this road for approximately 1.5 miles. At this point turn on ranch road to the west. Stay on this road for 6/10 of 1 mile; our proposed location is 2/10 of 1 mile southwest. The 6/10 of 1 mile of ranch road will have to be caliched. The balance of the existing road will have to be worked on but not caliched.
- B. Exhibit B is a plat showing all existing roads in the area, the portion of road that will have to be built and our proposed drillsite.

2. PLANNED ACCESS ROADS:

- A. We propose to build 2/10 of 1 mile of new road beginning at the existing ranch road and ending at the drillsite. This proposed road will be 12' wide and compacted caliche 6" thick will be used for both road and pad. The road has been staked.

3. LOCATION OF EXISTING WELLS:

- A. This section does not have any wells located on it.

4. LOCATION OF TANK BATTERIES, ETC:

- A. In the event that we drill a producing well, all production facilities will be located on the pad that will be built. Plat of production facilities on proposed pad are on Exhibit E.

5. LOCATION AND TYPE OF WATER SUPPLY:

- A. Water will be obtained from commercial sources.

6. SOURCE OF CONSTRUCTION MATERIALS:

- A. There is an existing caliche pit located in NE/4 of Sec. 19, T-14S, R-29E. The distance from this pit to our location is approximately 3 1/2 miles. We would like to open a new pit located in NE/SE of this section.
- B. Please contact Mr. Bill Sweatt with Sweatt Construction Company prior to the archaeological inspection so that he may accompany the Inspector to the location of the proposed new caliche pit.

7. METHODS OF HANDLING WASTE DISPOSAL:

- A. Waste will be buried in reserve pits at a depth of 24". The well site will be cleaned of all waste and this will be done within 30 days after completion of this well.

8. ANCILLARY FACILITIES:

- A. None required.

9. WELLSITE LAYOUT:

- A. Exhibit D shows the relative location and dimensions of the well pad, reserve pits and major rig components.
- B. The terrain is rolling sand hills with mesquite and creosote bushes on the surface.
- C. The location of the corners of the well site and pits have been staked.

10. PLANS FOR RESTORATION OF THE SURFACE:

- A. After finishing drilling and/or completion operations, all equipment and other material not needed for further operations will be removed. Pits will be filled and the location cleaned of all trash and junk to leave the wellsite as pleasant in appearance as possible.
- B. If the proposed well is non-productive, all restoration and/or revegetation requirements of the Bureau of Land Management and the United States Geological Survey will be complied with and will be accomplished as quickly as possible. All pits will be filled and leveled within 90 days after abandonment.

11. OTHER INFORMATION:

- A. The surface is private and belongs to Bogle Farms. We will make arrangements with the surface owner to pay for any surface damages.
- B. The topography consists of rolling sand hills with mesquite and creosote bushes. No wildlife was observed but the usual inhabitants of this area are jackrabbits, reptiles, coyotes, etc.
- C. There are no ponds, lakes, streams or rivers in the area.
- D. There are no occupied dwellings or windmills in the area of the wellsite.
- E. There is no evidence of any archeological, historical or cultural sites in the area.

12. OPERATOR'S REPRESENTATIVES:

- A. The field representatives responsible for assuring compliance with the approved surface use and operations plan are:

Drilling - Peck Hardee, Jr.
Harvey E. Yates Company
Suite 1000 Security National Bank Building
Roswell, New Mexico 88201
Office Phone: 505/623-6601
Mobile Phone: 915/683-4063

Fred G. Yates
Harvey E. Yates Company
Suite 1000 Security National Bank Building
Roswell, New Mexico 88201
Office Phone: 505/623-6601
Mobile Phone: 505/623-0989 Unit 4109
Home Phone: 505/622-5387

13. CERTIFICATION:

I hereby certify that I, or persons under my direct supervision, have inspected the proposed drillsite and access route; that I am familiar with the conditions which presently exist; that the statements made in this plan are, to the best of my knowledge true and correct; and, that the work associated with the operations proposed herein will be performed by Harvey E. Yates Company and its contractors and subcontractors in conformity with this plan and the terms and conditions under which it is approved.

Fred G. Yates
Date
10/1/77

Fred G. Yates Vice President
Name and Title

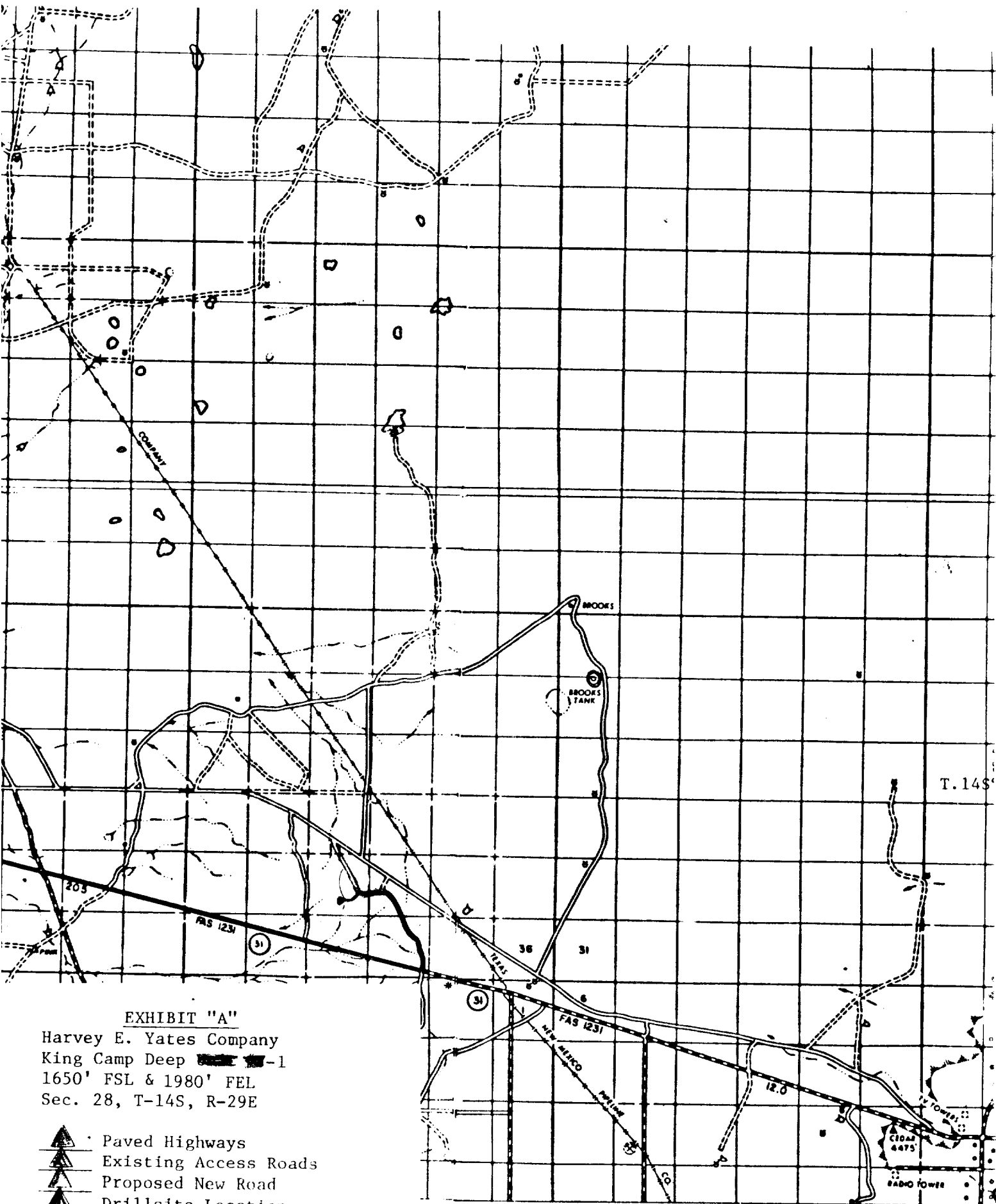

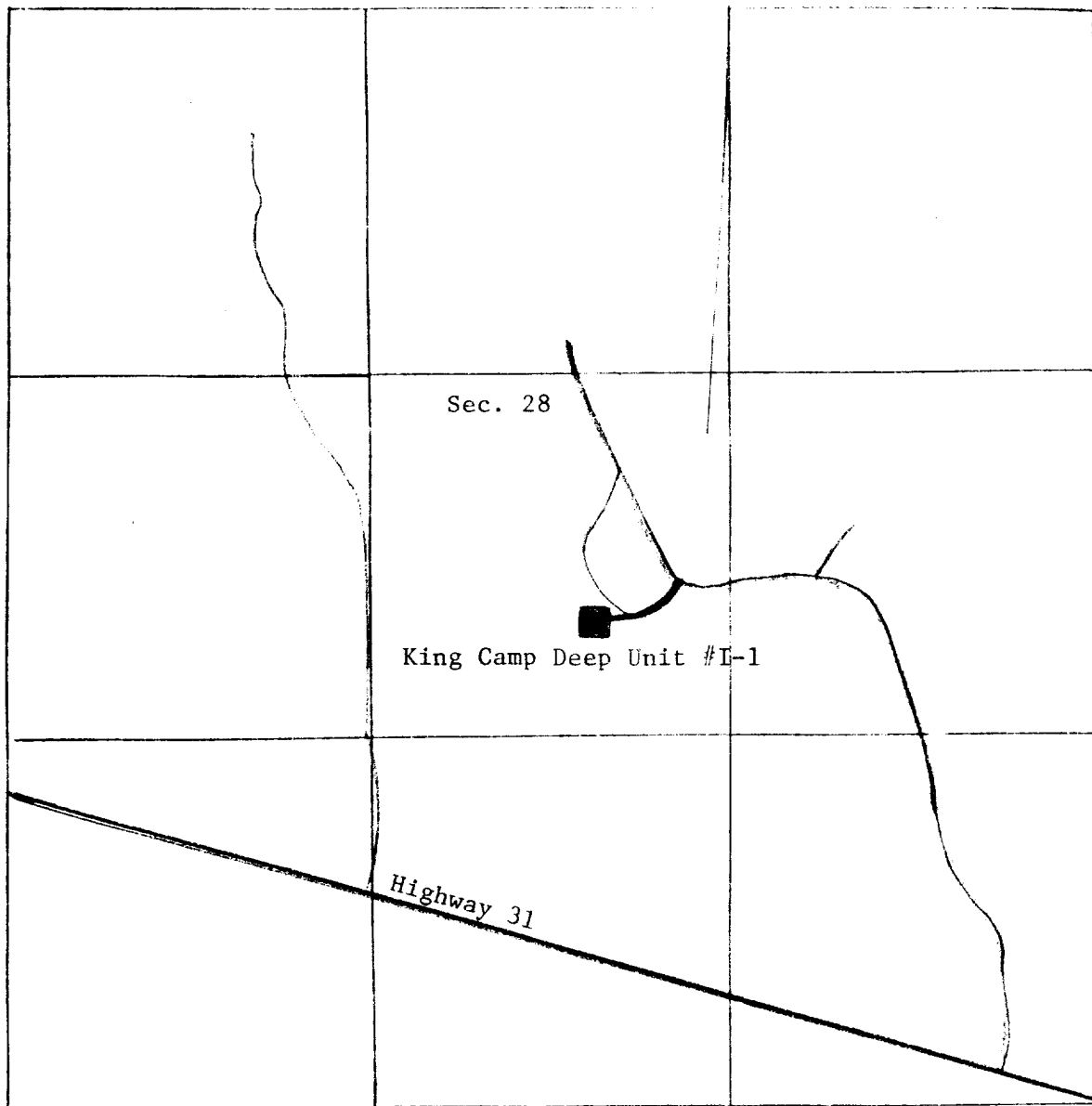







EXHIBIT "B"
 Harvey E. Yates Company
 King Camp Deep ~~Unit~~ #E-1
 1650' FSL & 1980' FEL
 Sec. 28, T-14S, R-29E

-  Paved Roads
-  Existing Access Roads
-  New Road
-  Proposed Drillsite
-  Existing access road to be improved