

**N MEXICO OIL CONSERVATION COMMISS**  
**WELL LOCATION AND ACREAGE DEDICATION PLAT**

Form 10-1  
 Supersedes 10-1-68  
 Effective 1-1-70

All distances must be from the outer boundaries of the Section

Owner <b>Reed &amp; Stevens, Inc.</b>		Lease <b>Lula</b>		Section <b>3</b>
1	7	15 South	28 East	Chaves
1650		South	990	East
3528.2	Atoka	Buffalo Valley Penn. Gas		S/2 - 327.01

- 1 Outline the acreage dedicated to the subject well by colored pencil or hatchure marks on the plat below.
- 2 If more than one lease is dedicated to the well, outline each and identify the ownership thereof (both as to working interest and royalty).
- 3 If more than one lease of different ownership is dedicated to the well, have the interests of all owners been consolidated by communitization, unitization, force-pooling, etc?

☐ Yes ☒ No If answer is "yes," type of consolidation to be communitized if productive

If answer is "no," list the owners and tract descriptions which have actually been consolidated (Use reverse side of this form if necessary) \_\_\_\_\_

No allowable will be assigned to the well until all interests have been consolidated (by communitization, unitization, forced-pooling, or otherwise) or until a non-standard unit, eliminating such interests, has been approved by the Commission.

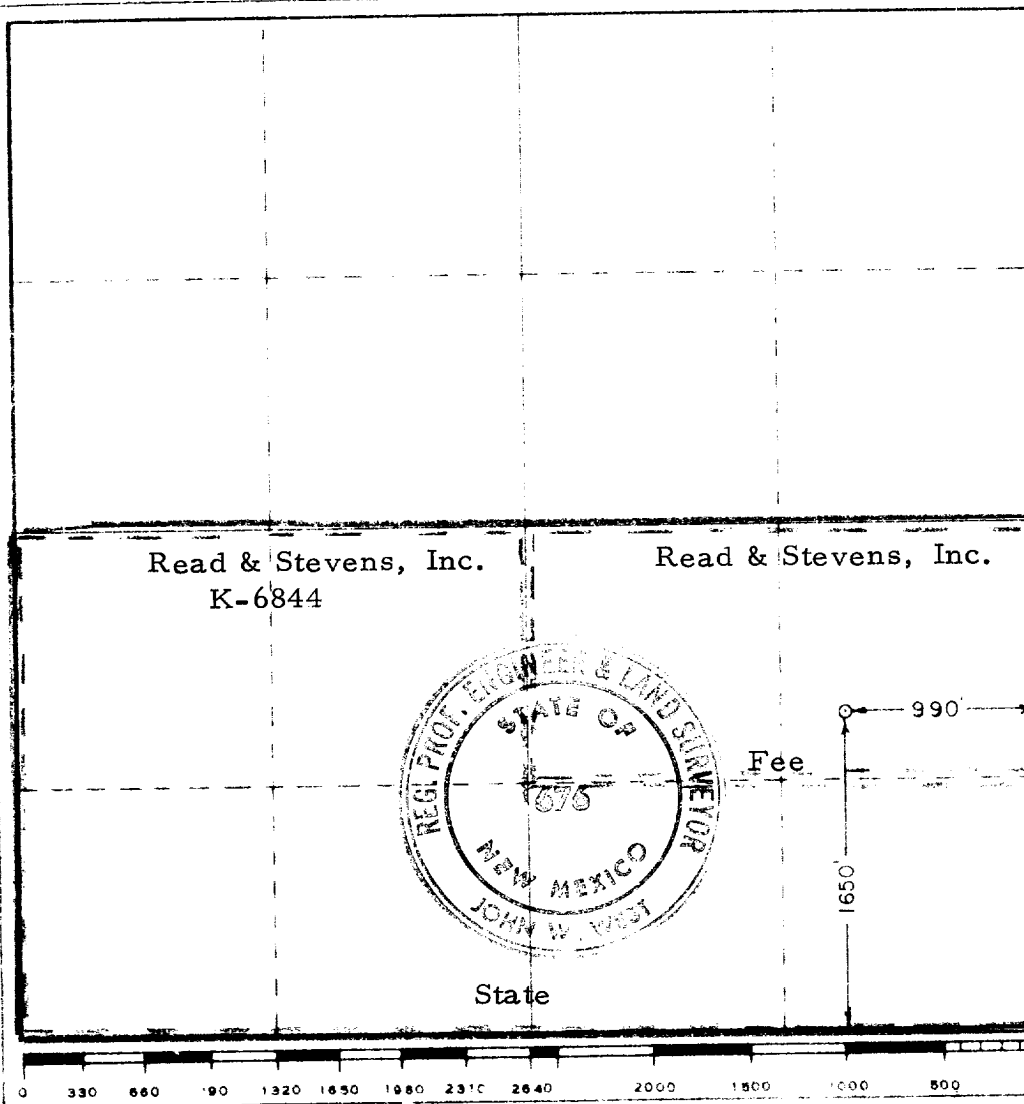

**CERTIFICATION**

I hereby certify that the information contained herein is true and complete to the best of my knowledge and belief.

*John L. Anderson, Jr.*  
 John L. Anderson, Jr.

**Agent**

**Read & Stevens, Inc.**

**December 28, 1977**

I hereby certify that the well location shown on this plat was plotted from field notes of actual surveys made by me or under my supervision, and that the same is true and correct to the best of my knowledge and belief.

**December 28, 1977**

Registered Professional Engineer and or Land Surveyor

*Chris A. West*  
 Certificate No. **676**