

NO. OF COPIES RECEIVED	6
DISTRIBUTION	
SANTA FE	/
FILE	/
U.S.G.S.	2
LAND OFFICE	/
OPERATOR	/

**RECEIVED**  
NEW MEXICO OIL CONSERVATION COMMISSION

30-005-60489  
Form C-101  
Revised 1-1-65

5A. Indicate Type of Lease	STATE <input checked="" type="checkbox"/> FEE <input type="checkbox"/>
5. State Oil & Gas Lease No.	6647

**APPLICATION FOR PERMIT TO DRILL, DEEPEN, OR PLUG BACK**

1a. Type of Work		7. Unit Agreement Name	
b. Type of Well DRILL <input checked="" type="checkbox"/> DEEPEN <input type="checkbox"/> PLUG BACK <input type="checkbox"/> OIL WELL <input checked="" type="checkbox"/> GAS WELL <input type="checkbox"/> OTHER <input type="checkbox"/> SINGLE ZONE <input type="checkbox"/> MULTIPLE ZONE <input type="checkbox"/>		8. Farm or Lease Name Double L. State	
2. Name of Operator J.B. Adamson		9. Well No. #1	
3. Address of Operator Rt.1, Box 202 J, Artesia, New Mexico 88210		10. Field and Pool, or Wildcat Double L. Queen	
4. Location of Well UNIT LETTER N LOCATED <del>888</del> 330 FEET FROM THE South LINE <del>888</del> 2296 West 1 15S 29E AND FEET FROM THE LINE OF SEC. TWP. RGE. NMPM		12. County Chaves	
19. Proposed Depth 2200'		19A. Formation Queen	
20. Rotary or C.T. C.T.		21. Elevations (Show whether DF, RT, etc.) 3888.5	
21A. Kind & Status Plug. Bond Blanket		21B. Drilling Contractor AMCO	
22. Approx. Date Work will start Feb. 20, 1978			

**PROPOSED CASING AND CEMENT PROGRAM**

SIZE OF HOLE	SIZE OF CASING	WEIGHT PER FOOT	SETTING DEPTH	SACKS OF CEMENT	EST. TOP
10 inch.	8 5/8	24 lb.	350 ft.	Circulate	surface
8 inch	4 1/2"	9.5 lb.	2000 ft.	Circulate	surface

Intention is to drill well to the queen formation. Set 350 feet 8 5/8, 24 lb. Surface and circulate cement to surface. Run 4 1/2 inch 9.5 lb. oil string to approx. 2000 feet and circulate cement to surface.

APPROVAL VALID  
FOR 90 DAYS UNLESS  
DRILLING COMMENCED,  
EXPIRES 5-21-78

IN ABOVE SPACE DESCRIBE PROPOSED PROGRAM: IF PROPOSAL IS TO DEEPEN OR PLUG BACK, GIVE DATA ON PRESENT PRODUCTIVE ZONE AND PROPOSED NEW PRODUCTIVE ZONE. GIVE BLOWOUT PREVENTER PROGRAM, IF ANY.

I hereby certify that the information above is true and complete to the best of my knowledge and belief.

Signed J.B. Adamson Title Owner-Operator Date 2-16-78

(This space for State Use)

APPROVED BY W.A. Gressett TITLE SUPERVISOR, DISTRICT II DATE FEB 21 1978

CONDITIONS OF APPROVAL, IF ANY:

**NEW MEXICO OIL CONSERVATION COMMISSION**  
**WELL LOCATION AND ACREAGE DEDICATION PLAT**

Form C-102  
 Supersedes C-128  
 Effective 1-1-65

All distances must be from the outer boundaries of the Section

Operator <b>J. B. Adamson</b>			Lease <b>Double L State</b>		Well No. <b>1</b>
Unit Letter <b>N</b>	Section <b>1</b>	Township <b>15 South</b>	Range <b>29 East</b>	County <b>Chaves</b>	
Actual Well Location of Well: <b>330</b> feet from the <b>South</b> line and <b>2296</b> feet from the <b>West</b> line					
Ground Level Elev. <b>3888.5</b>	Producing Formation <i>Green</i>		Pool <i>Double L State</i>		Dedicated Acreage: <b>1.00</b> Acres

1. Outline the acreage dedicated to the subject well by colored pencil or hatchure marks on the plat below.
2. If more than one lease is dedicated to the well, outline each and identify the ownership thereof (both as to working interest and royalty).
3. If more than one lease of different ownership is dedicated to the well, have the interests of all owners been consolidated by communitization, unitization, force-pooling, etc?

☐ Yes ☒ No If answer is "yes," type of consolidation \_\_\_\_\_

If answer is "no," list the owners and tract descriptions which have actually been consolidated. (Use reverse side of this form if necessary.) \_\_\_\_\_

No allowable will be assigned to the well until all interests have been consolidated (by communitization, unitization, forced-pooling, or otherwise) or until a non-standard unit, eliminating such interests, has been approved by the Commission.

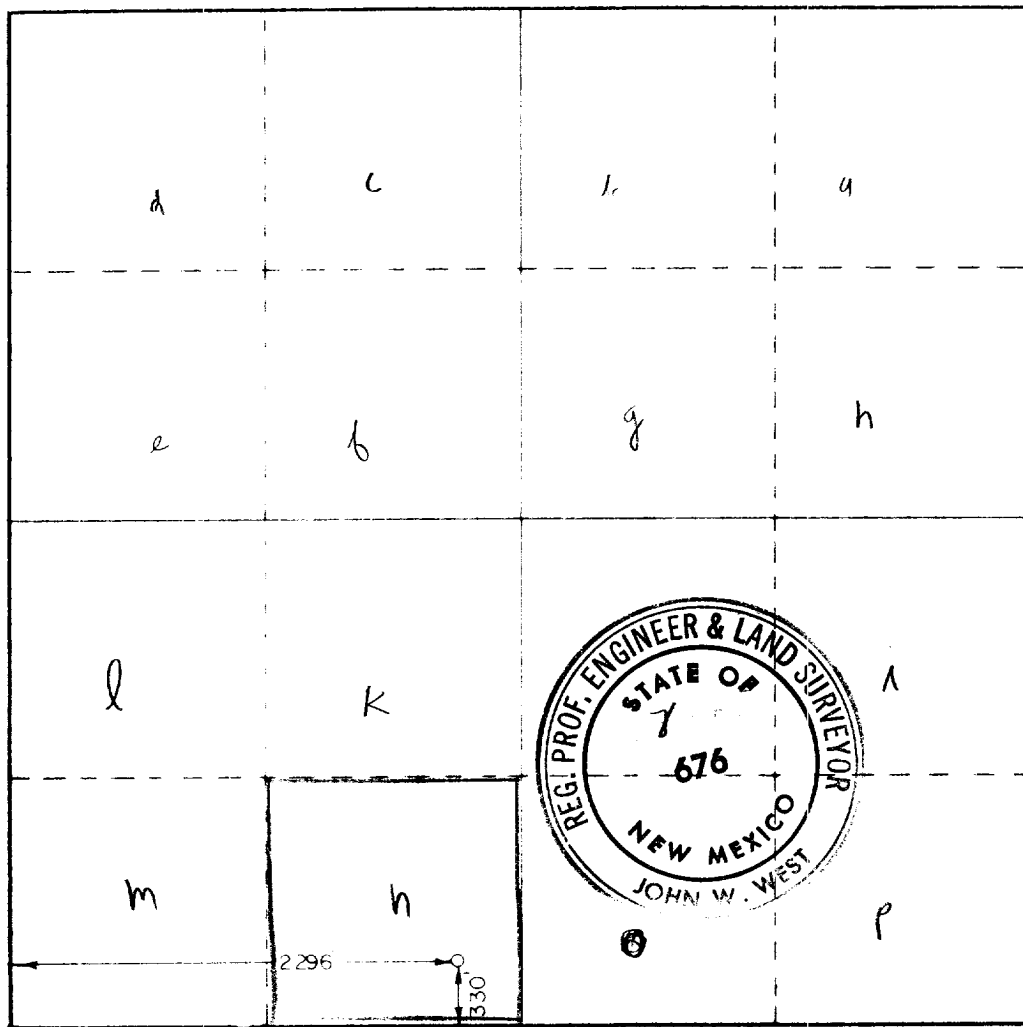

**CERTIFICATION**

I hereby certify that the information contained herein is true and complete to the best of my knowledge and belief.

*J. B. Adamson*

Name

*operator*

Position

*J. B. Adamson*

Company

Date

*2-18-78*

I hereby certify that the well location shown on this plat was plotted from field notes of actual surveys made by me or under my supervision, and that the same is true and correct to the best of my knowledge and belief.

Date Surveyed

*2/18/78*

Registered Professional Engineer and/or Land Surveyor

*John W. West*

Certificate No.

*John W. West*

**676**

*Ronald J. Eidson*

**3239**

