

NO. OF COPIES RECEIVED	6
DISTRIBUTION	
SANTA FE	1
FILE	1
U.S.G.S.	2
LAND OFFICE	1
OPERATOR	1

RECEIVED
NEW MEXICO OIL CONSERVATION COMMISSION

JAN 30 1979

O. C. C.
ARTESIA, OFFICE

30-005-60545
Form C-101
Revised 1-1-65

5A. Indicate Type of Lease	
STATE <input checked="" type="checkbox"/>	FEE <input type="checkbox"/>
5. State Oil & Gas Lease No.	
K - 6772	

APPLICATION FOR PERMIT TO DRILL, DEEPEN, OR PLUG BACK

1a. Type of Work			7. Unit Agreement Name		
b. Type of Well OIL WELL <input checked="" type="checkbox"/> GAS WELL <input type="checkbox"/> OTHER <input type="checkbox"/>			8. Farm or Lease Name		
2. Name of Operator McClellan Oil Corporation ✓			9. Well No. 3		
3. Address of Operator P. O. Box 848, Roswell, New Mexico 88201			10. Field and Pool, or Wildcat Assc. X Undesq. Double L Queen		
4. Location of Well UNIT LETTER C LOCATED 1155 FEET FROM THE North LINE AND 1485 FEET FROM THE West LINE OF SEC. 24 TWP. 14-S RGE. 29-E NMPM			12. County Chaves		
19. Proposed Depth 1950'			19A. Formation Queen Sand		20. Rotary or C.T. Cable Tool
21. Elevations (Show whether DF, RT, etc.)	21A. Kind & Status Plug. Bond Statewide	21B. Drilling Contractor Cortez Drilling Co.	22. Approx. Date Work will start February 1, 1979		

PROPOSED CASING AND CEMENT PROGRAM

SIZE OF HOLE	SIZE OF CASING	WEIGHT PER FOOT	SETTING DEPTH	SACKS OF CEMENT	EST. TOP
10"	8 5/8"	20lb.	450'	200sx	Surface
8"	4 1/2"	9 1/2lb.	1950'	150sx	1200'

Propose to drill to a depth of 1950' to test the Queen Sand. If production is indicated, will run casing & attempt completion. Cortez Drilling Company, P. O. Box 848, Roswell, New Mexico 88201, will be the contractor.

APPROVAL PAID
FOR 90 DAYS UNLESS
DRILLING COMMENCED,

EXPIRES 5-1-79

IN ABOVE SPACE DESCRIBE PROPOSED PROGRAM: IF PROPOSAL IS TO DEEPEN OR PLUG BACK, GIVE DATA ON PRESENT PRODUCTIVE ZONE AND PROPOSED NEW PRODUCTIVE ZONE. GIVE BLOWOUT PREVENTER PROGRAM, IF ANY.

I hereby certify that the information above is true and complete to the best of my knowledge and belief.

Signed J. J. McClellan Title Operator Date 1/26/79

(This space for State Use)

APPROVED BY W. A. Gressett TITLE SUPERVISOR, DISTRICT II DATE FEB 1 1979

CONDITIONS OF APPROVAL, IF ANY:

Subject to NSL Hearing on docket for 2-28-79

NEW MEXICO OIL CONSERVATION COMMISSION
WELL LOCATION AND ACREAGE DEDICATION PLAT

Form O-1
Supersedes O-128
Effective 1-1-65

All distances must be from the outer boundaries of the Section

McClellan Oil Company		lease <u>Marlaine</u> Marissa State		3
C	24	14 South	29 East	Chaves
1155	North	1485	West	
3790.3	Queen Sand	Undesg. Double "L" Assoc.	40	

On the acreage dedicated to the subject well by colored pencil or hatchure marks on the plat below

If more than one lease is dedicated to the well, outline each and identify the ownership thereof (share as to working interest and royalty)

If more than one lease of different ownership is dedicated to the well, have the interests of all owners been consolidated by communitization, unitization, force-pooling, etc.?

Yes ☐ No ☐ If answer is "yes," type of consolidation _____

If answer is "no," list the owners and tract descriptions which have actually been consolidated (Use reverse side of this form if necessary) _____

No allowable will be assigned to the well until all interests have been consolidated by communitization, unitization, force-pooling, or otherwise or until a non-standard unit, eliminating such interests, has been approved by the Commission.

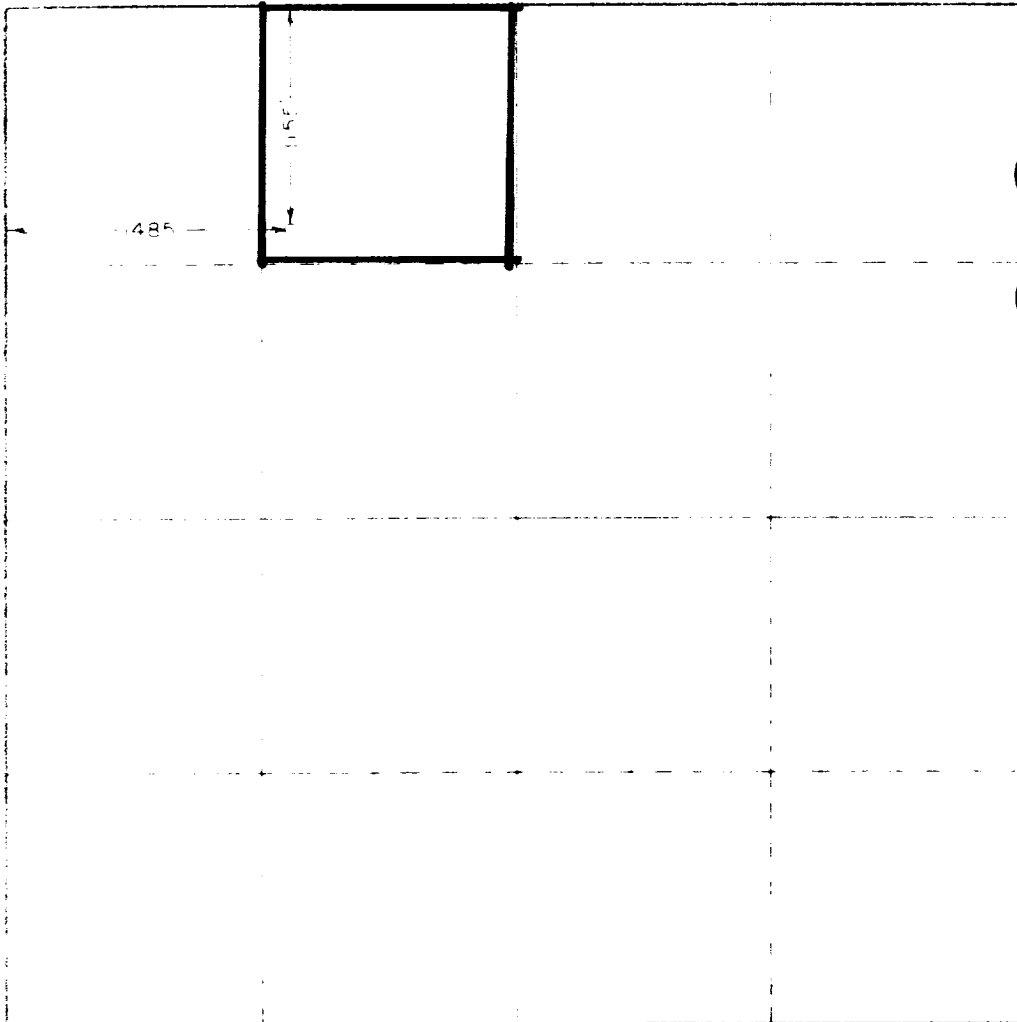

CERTIFICATION

I hereby certify that the information contained herein is true and complete to the best of my knowledge and belief.

Jack L. McClellan
Jack L. McClellan
President

McClellan Oil Corporation

1/30/79

I hereby certify that the well location shown on this plat was plotted from field notes of actual surveys made by me or under my supervision, and that the same is true and correct to the best of my knowledge.

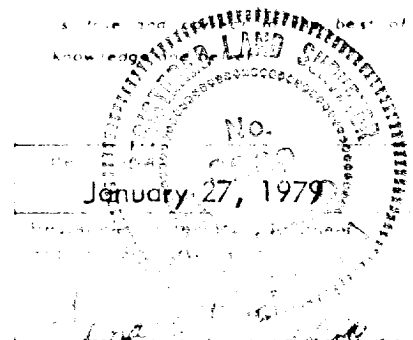

Certified by John W. West 676
Ronald J. Eldson 3239



McClellan Oil Corporation

RECEIVED

JAN 31 1979

O. C. C.
ARTERIA, OFFICE

January 26, 1979

Energy and Minerals Department
Oil Conservation Division
Post Office Box 2088
Santa Fe, New Mexico 87501

Re: McClellan Oil Corporation
Marlisue State No. 3
1155' FNL & 1485' FWL
Section 24-T14S-R29E
Chaves County, New Mexico

Gentlemen:

This letter is to request a hearing before this Commission for a Non-Standard Location as described in the caption above. This well is located in the Undesignated Double "L" Queen Associated Pool of Chaves County, New Mexico. It is further requested that the hearing be scheduled on the February 28, 1979 Docket in order to determine the feasibility of this Non-Standard Location request. The acreage dedication to this well would be the NE $\frac{1}{4}$ NW $\frac{1}{4}$ of Section 24. Thank you for your cooperation in this matter.

Sincerely,

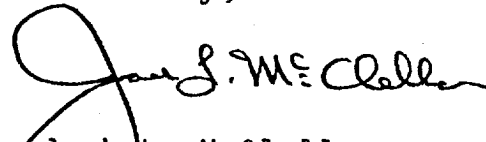

Jack L. McClellan
President