

STATE OF NEW MEXICO  
ENERGY AND MINERALS DEPARTMENT

OIL CONSERVATION DIVISION RECEIVED

P. O. BOX 2088

SANTA FE, NEW MEXICO 87501

AUG 31 1981

30-005-61103

Form C-101  
Revised 10-1-78

NO. OF COPIES RECEIVED	
DISTRIBUTION	
SANTA FE	1
FILE	1
U.S.G.S.	2
LAND OFFICE	
OPERATOR	1

- TIGHT HOLE -

O. C. D.  
ARTESIA, OFFICE

5A. Indicate Type of Lease

STATE ☐ FEE ☒

5. State Oil & Gas Lease No.

APPLICATION FOR PERMIT TO DRILL, DEEPEN, OR PLUG BACK

1a. Type of Work		7. Unit Agreement Name	
b. Type of Well DRILL <input checked="" type="checkbox"/> DEEPEN <input type="checkbox"/> PLUG BACK <input type="checkbox"/> OIL WELL <input type="checkbox"/> GAS WELL <input checked="" type="checkbox"/> OTHER <input type="checkbox"/> SINGLE ZONE <input checked="" type="checkbox"/> MULTIPLE ZONE <input type="checkbox"/>		8. Farm or Lease Name J. T. Jennings	
2. Name of Operator Sun Oil Company (Delaware) ✓		9. Well No. 1	
3. Address of Operator P. O. Box 30, Dallas, TX 75221		10. Field and Pool, or Wildcat Wildcat	
4. Location of Well UNIT LETTER <u>D</u> LOCATED <u>660</u> FEET FROM THE <u>North</u> LINE AND <u>660</u> FEET FROM THE <u>West</u> LINE OF SEC. <u>9</u> TWP. <u>17S</u> RGE. <u>18E</u> NMPM		12. County Chaves	
19. Proposed Depth 2,700'		19A. Formation Tubb	
20. Rotary or C.T. Rotary		21. Elevations (Show whether DF, RT, etc.) 5,180 GR	
21A. Kind & Status Plug. Bond Blanket-Approved		21B. Drilling Contractor Stewart Brothers	
22. Approx. Date Work will start August 30, 1981			

23. PROPOSED CASING AND CEMENT PROGRAM

SIZE OF HOLE	SIZE OF CASING	WEIGHT PER FOOT	SETTING DEPTH	SACKS OF CEMENT	EST. TOP
12-1/4"	8-5/8"	24#	1,250'	750	Circ. to Surf.
7-7/8"	4-1/2"	9.5#	2,700'	365	1,000'

160 acre drilling unit - Northwest quarter of Section 9

Primary Objective - Tubb

No dwelling within one mile of Location

Gas is not dedicated

See attached additional information

APPROVAL VALID FOR 180 DAYS  
PERMIT EXPIRES 3-1-82  
UNLESS DRILLING UNDERWAY

IN ABOVE SPACE DESCRIBE PROPOSED PROGRAM; IF PROPOSAL IS TO DEEPEN OR PLUG BACK, GIVE DATA ON PRESENT PRODUCTIVE ZONE AND PROPOSED NEW PRODUCTIVE ZONE. GIVE BLOWOUT PREVENTER PROGRAM, IF ANY.

I hereby certify that the information above is true and complete to the best of my knowledge and belief.

Signed [Signature] Title Operations Services Supervisor Date August 27, 1981

(This space for State Use)

APPROVED BY [Signature] TITLE SUPERVISOR, DISTRICT II DATE AUG 31 1981

CONDITIONS OF APPROVAL, IF ANY:

100 SX C w/ 2% cc tail in  
on 8 3/4"

Cement must be circulated to  
surface behind 8 3/4" casing

Notify N.M.O.C.C. in sufficient  
time to witness cementing  
the 8 3/4" casing

All distances must be from the outer boundaries of the Section.

Operator <b>Sun Oil of (Delaware)</b>		Lease <b>J.T. Jennings</b>		Well No. <b>#1</b>
Unit Letter <b>D</b>	Section <b>9</b>	Township <b>17 South</b>	Range <b>18 East</b>	County <b>Chaves</b>
Actual Postage Location of Well:				
660 feet from the <b>North</b> line and		660 feet from the <b>West</b> line		
Ground Level Elev. <b>5180</b>	Producing Formation <b>Tubb Sandstone</b>	Pool <b>Undesignated</b>	Dedicated Acreage: <b>160</b> Acres	

1. Outline the acreage dedicated to the subject well by colored pencil or hachure marks on the plat below.
2. If more than one lease is dedicated to the well, outline each and identify the ownership thereof (both as to working interest and royalty).
3. If more than one lease of different ownership is dedicated to the well, have the interests of all owners been consolidated by communitization, unitization, force-pooling, etc?

☐ Yes ☐ No If answer is "yes," type of consolidation \_\_\_\_\_

If answer is "no," list the owners and tract descriptions which have actually been consolidated. (Use reverse side of this form if necessary.) \_\_\_\_\_

No allowable will be assigned to the well until all interests have been consolidated (by communitization, unitization, forced-pooling, or otherwise) or until a non-standard unit, eliminating such interests, has been approved by the Division.

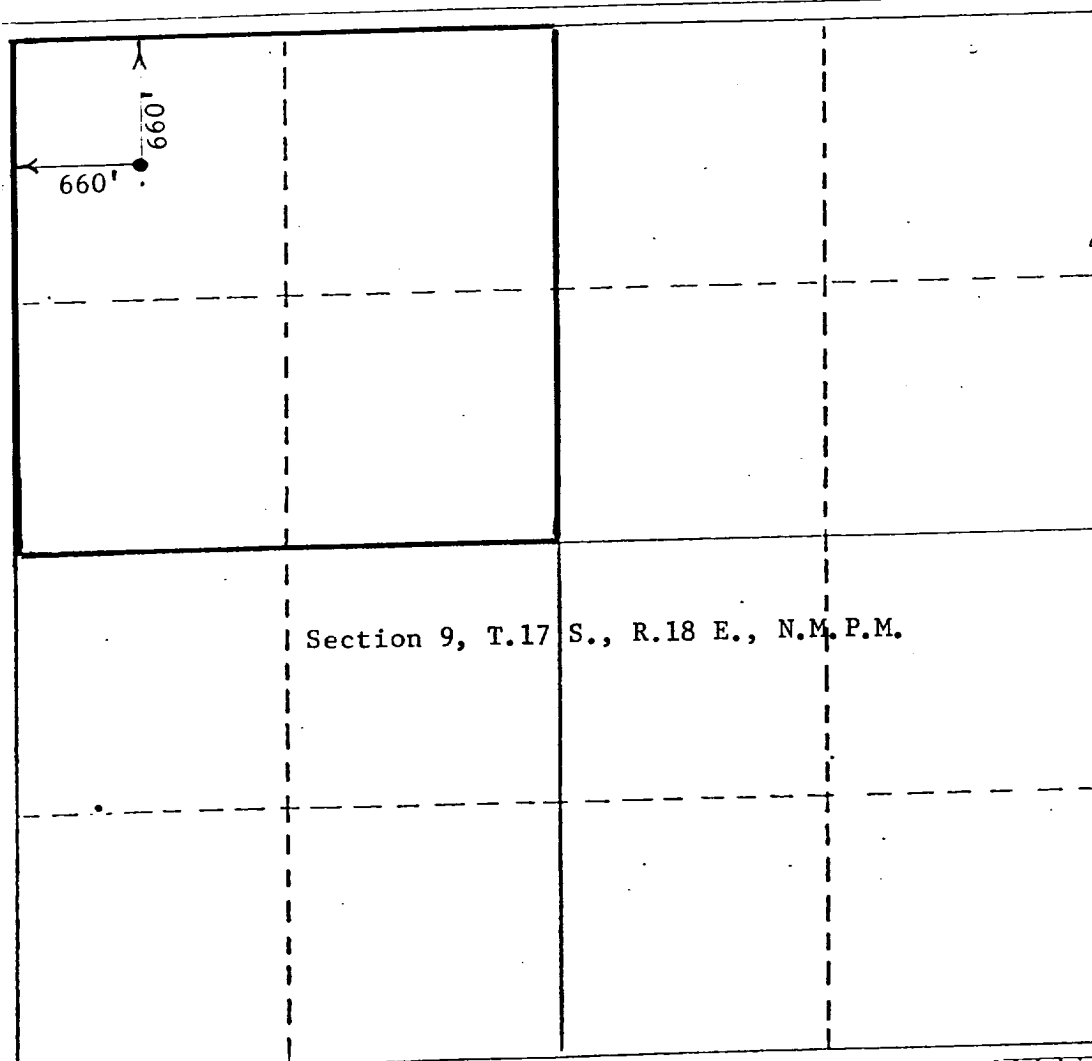

CERTIFICATION

I hereby certify that the information contained herein is true and complete to the best of my knowledge and belief.

*Linda Harris*

Name

Operations Services Supvr.  
Position

Sun Oil Company (Delaware)  
Company

August 27, 1981  
Date

I hereby certify that the well location shown on this plat was plotted from field notes of actual surveys made by me or under my supervision, and that the same is true and correct to the best of my knowledge and belief.

Date Surveyed  
August 27, 1981  
Registered Professional Engineer  
and/or Land Surveyor  
John D. Jaquess  
Certificate No. 6290

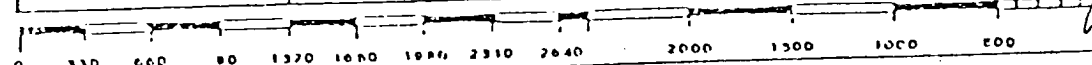
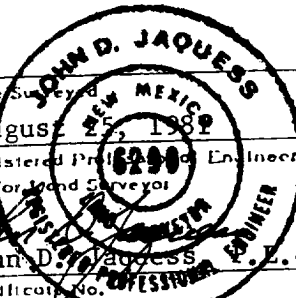

SUNMARK EXPLORATION COMPANY

LIST OF ATTACHMENTS

<u>FIGURE NO.</u>	<u>DESCRIPTION</u>
1	DETAILED WORK PROGRAM
2	SURVEY PLAT
3	HYDRAULIC BLOWOUT EQUIPMENT HOOKUP "B"

## DETAILED WORK PROGRAM

### A. GENERAL DATA

WELL NAME & NO.: J. T. Jennings #1  
STATE: New Mexico  
COUNTY: Chaves  
LOCATION: Section 9 , Township 17S , Range 18E  
COMPLETION: Single  
OBJECTIVE: GAS  
PROBABLE T.D.: 2,700'

### B. MUD PROGRAM

<u>FROM</u>	<u>TO</u>	<u>WEIGHT</u>	<u>VISCOSITY</u>	<u>TYPE MUD</u>
0	1,250	8.8-9.2	32-36	Fresh Water Spud Mud
1,250	2,700	8.8-9.2	32-36	Fresh Water Gel Mud

### C. HOLE SIZE

<u>SIZE</u>	<u>FROM/TO</u>	<u>REMARKS</u>
12-1/4"	0-1,250	
7-7/8"	1,250'-2,700'	

D. EQUIPMENT PROGRAM

WELLHEAD EQUIPMENT: 2,000 psi wellhead equipment

FRESH WATER PROTECTION TO:

<u>CSG SEAT</u>	<u>POS</u>	<u>FOOTAGE</u>	<u>SIZE</u>	<u>WEIGHT</u>	<u>GR</u>
1,250	T	1,250'	8-5/8"	24#	K-55
2,700	T	2,700	4-1/2"	9.5#	K-55
		2,700	2-3/8"	4.7#	J-55

E. CEMENTING PROGRAM

<u>CSG SIZE</u>	<u>COLLAR</u>	<u>SHOE</u>	<u>SX</u>	<u>SLURRY DESCRIPTION</u>	<u>YIELD</u>	<u>WEIGHT</u>	<u>EST TOP</u>
8-5/8"	Float	Guide	750	Class "C" w/2% CaCl <sub>2</sub> , 1/4# sx Flocele	1.32	14.8	Surface
4-1/2"	Float	Float	185	Lead: Lite Cement w/3/4 sx flocele, 1% CaCl <sub>2</sub>	1.84	12.7	1,000'
			180	Tail: Class "C" w/2% CaCl <sub>2</sub>	1.32	14.8	

F. GEOLOGICAL PROCEDURES

SAMPLES:	<u>FROM</u>	<u>TO</u>	<u>INTERVAL</u>
	Surface	TD	10'

Washed and dried to Sunmark (1), AMSTRAT (1), and  
State Commission (1).

CORES:      None Anticipated

LOGS:	<u>TYPE</u>	<u>FROM</u>	<u>TO</u>
	CNL-FDC/GR	Surface Casing	to TD
	DLL-MICRO SFL	Surface Casing	to TD

G. GEOLOGICAL OBJECTIVES

<u>FORMATION</u>	<u>TOP OF ZONE</u>
Tubb Sandstone	2,250'

SUNMARK EXPLORATION COMPANY  
DIVISION OF  
SUN OIL COMPANY

HYDRAULIC BLOWOUT EQUIPMENT HOOKUP "B"

SIZE 10" SERIES \_\_\_\_\_  
W.P. 5,000 T.P. \_\_\_\_\_

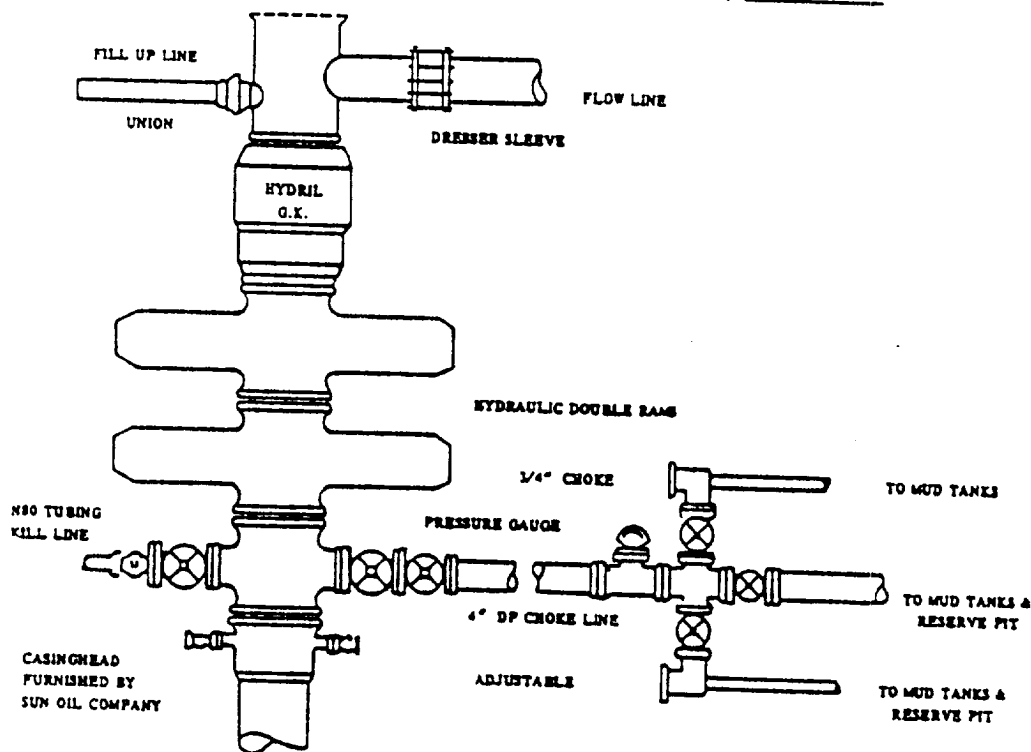

NOTE: Choke manifold shall be out from under derrick floor & raised above ground level. Extra chokes (Sizes 1/4" 1/2"-3/4"-1") shall be maintained on location at all times.

1. Blowout equipment shall be properly installed immediately after surface casing is cemented & immediately after intermediate casing is cemented, & entire assembly shall be ready for any emergency at this time.
2. All flanges, steel valves, gauges, fittings, & lines shall have a minimum working pressure of the Series or pressure rating noted.
3. All hydraulic lines used for operating blowout equipment shall be equipped with Swing joints & have a minimum working pressure of 3000 psi. Hydraulic pressure shall be supplied by a "Payne" or "Hydril" 80-gallon accumulator with hydraulic type oil as a medium.
4. Extension rods & manual operating wheels shall be installed on gates immediately & shall be plainly marked "Pipe Rams" & "Blind Rams".
5. All manifold control valves shall be clearly marked as to designation "Hydril", "Blind Rams" & "Pipe Rams". "Blind Ram" operating valve shall be pinned so that valve cannot be operated until pin or lock is removed.
6. At least two vapor-proof safety lanterns shall be maintained on rig floor at all times.
7. An inside blowout preventer of proper size & pressure rating shall be maintained on rig floor at all times.
8. Blowout equipment shall be closed & inspected each 24 hours & noted on the daily drilling report.
9. Wherever possible, mouse hole to be off-center of hole to allow choke line to run from drilling spool to manifold in a straight line.



August 27, 1981

State of New Mexico  
Energy and Minerals Department  
Oil Conservation Division  
Drawer DD  
Artesia, New Mexico 88210

Re: TIGHT HOLE  
J. T. Jennings  
Chaves County, New Mexico

Mr. Griffin:

Regarding our Application for permit to drill, enclosed is the following information:

- 1) Application for Permit to Drill - Form C-101
- 2) Form C-102

If you have any further questions, please contact me at 214/258-4565.

Sincerely,

SUNMARK EXPLORATION COMPANY

A handwritten signature in cursive script, appearing to read "Linda Harris", is written over the typed name.

Linda Harris  
Operations Service Supervisor

LH:fb