

UNITED STATES  
DEPARTMENT OF THE INTERIOR  
GEOLOGICAL SURVEY

SUBMIT IN TRIPlicate  
(Other instructions on  
Form 9-331 C)

NM OIL CONSERVATION COMMISSION  
Hagerman, NM 88210

Form approved.  
Budget Bureau No. 42-R1425.

OCT 29 1982

30-005-61825

O. C. D.  
NM 036718

ARTESIA OFFICE

APPLICATION FOR PERMIT TO DRILL, DEEPEN, OR PLUG BACK

1a. TYPE OF WORK

DRILL ☒

DEEPEN ☐

PLUG BACK ☐

b. TYPE OF WELL

OIL  
WELL ☐

GAS  
WELL ☒

OTHER ☐

SINGLE  
ZONE ☒

MULTIPLE  
ZONE ☐

2. NAME OF OPERATOR

(Ph. 623-7184)

Mountain States Petroleum Corporation

3. ADDRESS OF OPERATOR

P. O. Box 1936, Roswell, NM 88201

4. LOCATION OF WELL (Report location clearly and in accordance with any State requirements.)\*

At surface

990' FNL & 990' FEL of Sec. 19-15S-28E

At proposed prod. zone

same

14. DISTANCE IN MILES AND DIRECTION FROM NEAREST TOWN OR POST OFFICE\*

11 1/2 air miles southeast of Hagerman, NM

15. DISTANCE FROM PROPOSED\*

LOCATION TO NEAREST  
PROPERTY OR LEASE LINE, FT.  
(Also to nearest drig. unit line, if any)

990'

16. NO. OF ACRES IN LEASE

1848.49

17. NO. OF ACRES ASSIGNED  
TO THIS WELL

324.37

18. DISTANCE FROM PROPOSED LOCATION\*

TO NEAREST WELL, DRILLING, COMPLETED,  
OR APPLIED FOR, ON THIS LEASE, FT.

1380'

19. PROPOSED DEPTH

9400' Morrow

20. ROTARY OR CABLE TOOLS

Rotary

21. ELEVATIONS (Show whether DF, RT, GR, etc.)

3574' G.L.

22. APPROX. DATE WORK WILL START\*

November 1, 1982

23.

PROPOSED CASING AND CEMENTING PROGRAM

SIZE OF HOLE	SIZE OF CASING	WEIGHT PER FOOT	SETTING DEPTH	QUANTITY OF CEMENT
17 1/2"	13 3/8"	48.0 #	30'	Sufficient to circulate
11 "	8 5/8"	24.0 #	1850'	Sufficient to circulate
7 7/8"	4 1/2"	11.6 #	9400'	1000' above pay

Pay zone will be selectively perforated and stimulated as needed for optimum production.

Attached are: 1. Well Location & Acreage Dedication Plat  
2. Supplemental Drilling Data  
3. Surface Use Plan

Unorthodox location was approved by NMCCD Order No. R-7097 dated 10-7-82.

Gas is not dedicated.

IN ABOVE SPACE DESCRIBE PROPOSED PROGRAM: If proposal is to deepen or plug back, give data on present productive zone and proposed new productive zone. If proposal is to drill or deepen directionally, give pertinent data on subsurface locations and measured and true vertical depths. Give blowout preventer program, if any.

24.

SIGNED

James A. Knauer

TITLE Agent

U.S. GEOLOGICAL SURVEY  
ROSWELL, NEW MEXICO

DATE October 14, 1982

(This space for Federal or State office use)

(Orig. Sgd.) GEORGE H. STEWART

PERMIT NO.

APPROVAL DATE

APPROVED BY

TITLE

DATE

CONDITIONS OF APPROVAL, IF ANY:

JAMES A. GILHAM  
DISTRICT SUPERVISOR

OCT 22 1982

RECEIVED  
OCT 19 1982

Partial OK'd  
for info  
10-22-82

NEW MEXICO OIL CONSERVATION COMMISSION  
WELL LOCATION AND ACREAGE DEDICATION PLAT

OCT 29 1982

Form C-1  
Superseded by C-128  
Effective 1-65

All distances must be from the outer boundaries of the Section

O. C. D.

ARTESIA, OFFICE

3

MOUNTAIN STATES PETROLEUM CORP.

Lease

BROTAR FED.

Section 19 Township 15 SOUTH Range 28 EAST County CHAVES

Well Location of Wells:

990 feet from the NORTH line and 990 feet from the EAST line  
Dedicated Acreage: 324.37 Acres  
Producing Formation: Morrow  
Pool: Buffalo Valley Penn Gas  
Elev.: 3573.80

- Outline the acreage dedicated to the subject well by colored pencil or hatchure marks on the plat below.
- If more than one lease is dedicated to the well, outline each and identify the ownership thereof (both as to working interest and royalty). Federal Oil & Gas Lease NM 036718 is only lease involved..
- If more than one lease of different ownership is dedicated to the well, have the interests of all owners been consolidated by communitization, unitization, force-pooling, etc?

☐ Yes ☐ No If answer is "yes," type of consolidation \_\_\_\_\_

If answer is "no," list the owners and tract descriptions which have actually been consolidated. (Use reverse side of this form if necessary.) \_\_\_\_\_

No allowable will be assigned to the well until all interests have been consolidated (by communitization, unitization, forced-pooling, or otherwise) or until a non-standard unit, eliminating such interests, has been approved by the Commission.

CERTIFICATION

I hereby certify that the information contained herein is true and complete to the best of my knowledge and belief.

*James A. Knauf*

James A. Knauf

Position

Agent

Company

Mountain States Pet. Corp.

Date

October 14, 1982

I hereby certify that the well location shown on this plat was plotted from field notes of actual surveys made by me or under my supervision, and that the same is true and correct to the best of my knowledge and belief.

AUGUST 17, 1982

Date Surveyed

Registered Professional Engineer and/or Land Surveyor

*John W. West*

Certificate No. JOHN W. WEST 878  
PATRICK A. ROMERO 6663  
Ronald J. Edison 3239

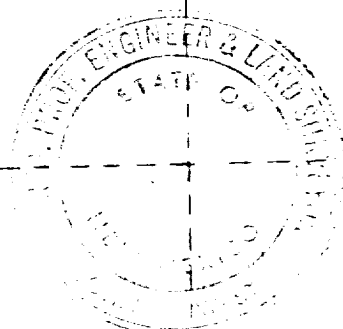

RECEIVED

OCT 29 1982

O. C. D.  
ARTESIA, OFFICE

SUPPLEMENTAL DRILLING DATA

Mountain States Petroleum Corporation  
Well #1 Brotar Federal  
990' FNL & 990' FEL Sec. 19-15S-28E  
Chaves County, New Mexico

1. SURFACE FORMATION: Alluvium of Quaternary Age.

2. ESTIMATED TOPS OF GEOLOGIC MARKERS:

Queen	1120'	Cisco	7400'
San Andres	1890'	Canyon	7900'
Glorietta	3300'	Atoka	8700'
Abo	5350'	Morrow	8900'
Wolfcamp	6550'	Mississippi	9250'

3. ANTICIPATED POROSITY ZONES:

Water: Above 100'  
Gas: Lower Penn

4. CASING DESIGN:

<u>Size</u>	<u>Interval</u>	<u>Weight</u>	<u>Grade</u>	<u>Joint</u>	<u>Condition</u>
13 3/8"	0 - 30'	48.0#	K-55	STC	New
8 5/8"	0 - 1850'	24.0#	K-55	STC	New
4 1/2"	0 - 1400'	11.6#	K-55	Butt	New
	1400 - 8600'	11.6#	K-55	STC	New
	8600 - 9400'	11.6#	N-80	LTC	New

5. SURFACE CONTROL EQUIPMENT: One annular and two ram-type 900-series preventers. BOP Sketch attached.

6. DRILLING FLUID:

0 - 30' Native mud.

30 - 8500' Fresh water with gel or lime as needed for viscosity.

8500 - TD Salt water conditioned as necessary for control of viscosity, pH, and water-loss.

RECEIVED

OCT 29 1982

O. C. D.  
ARTESIA, OFFICE

BLOWOUT PREVENTER SKETCH  
Mountain States Petroleum Corp.  
Well #3 Brotar Federal  
NE $\frac{1}{4}$ NE $\frac{1}{4}$  Sec. 19-15S-28E

900 SERIES

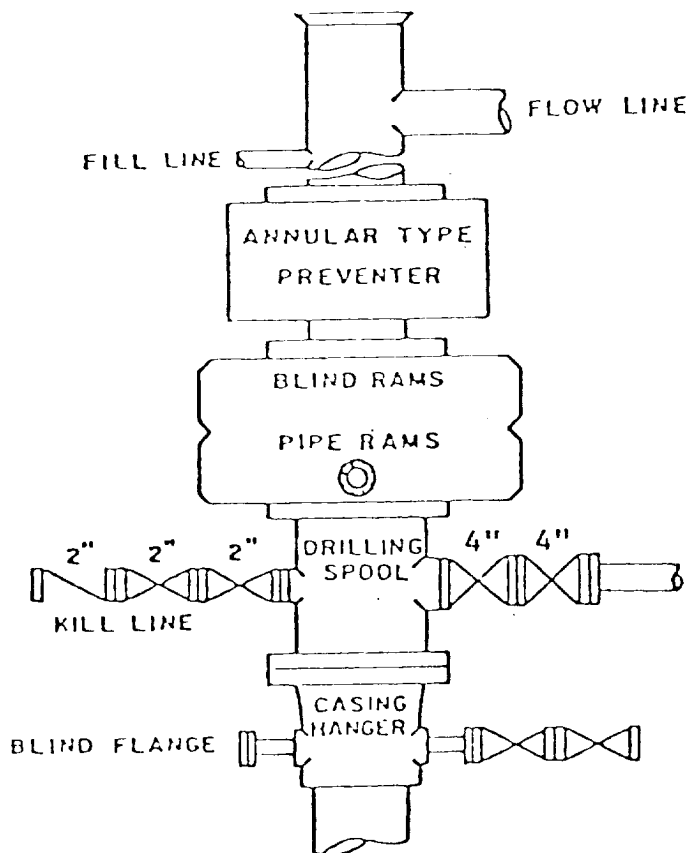

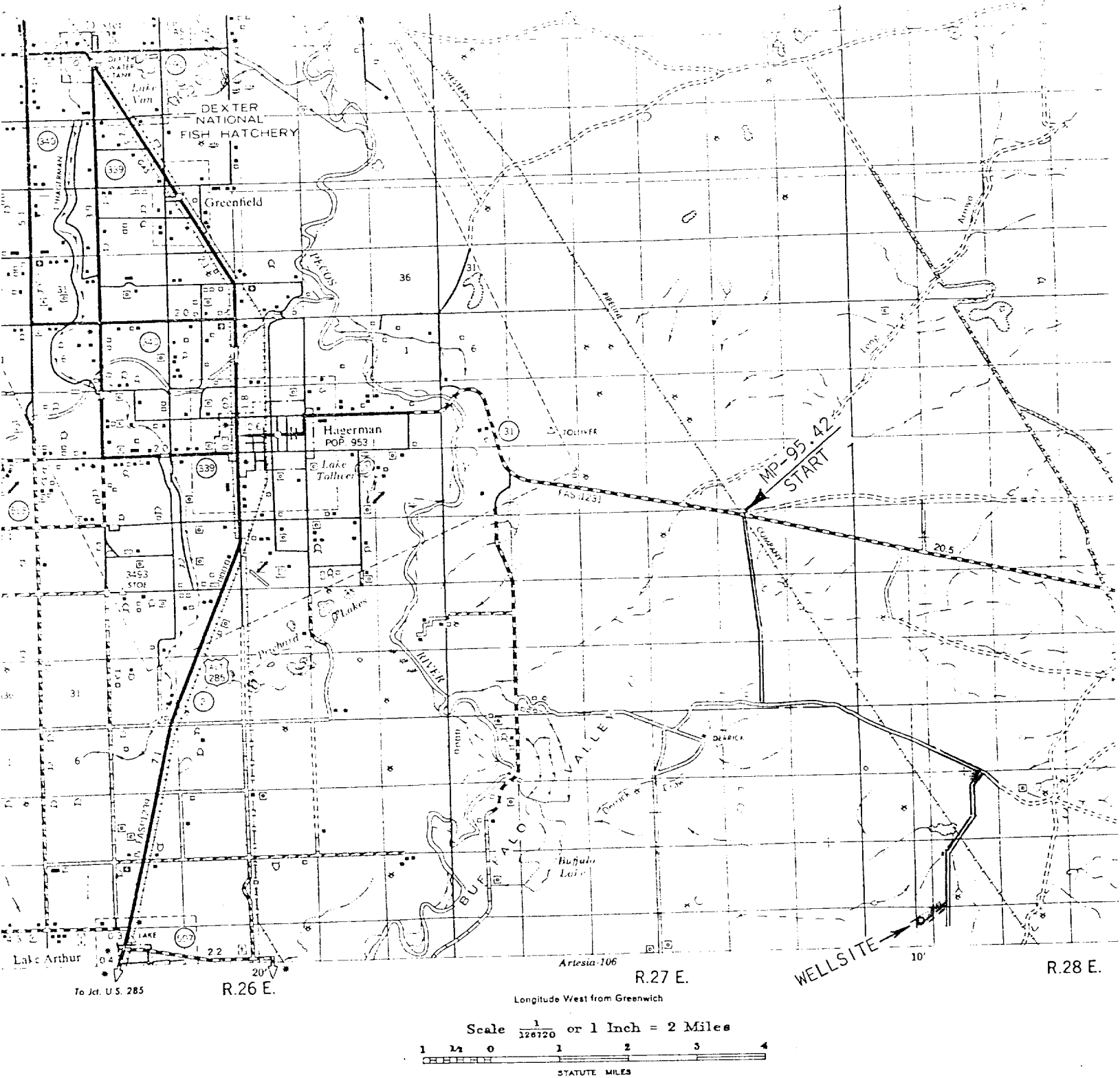

SUP Exhibit "A"

PORTION OF CHAVES COUNTY ROAD MAP

Mountain States Petroleum Corp.

Well #3 Brotar Federal

NE $\frac{1}{4}$ NE $\frac{1}{4}$  Sec. 19-15S-28E

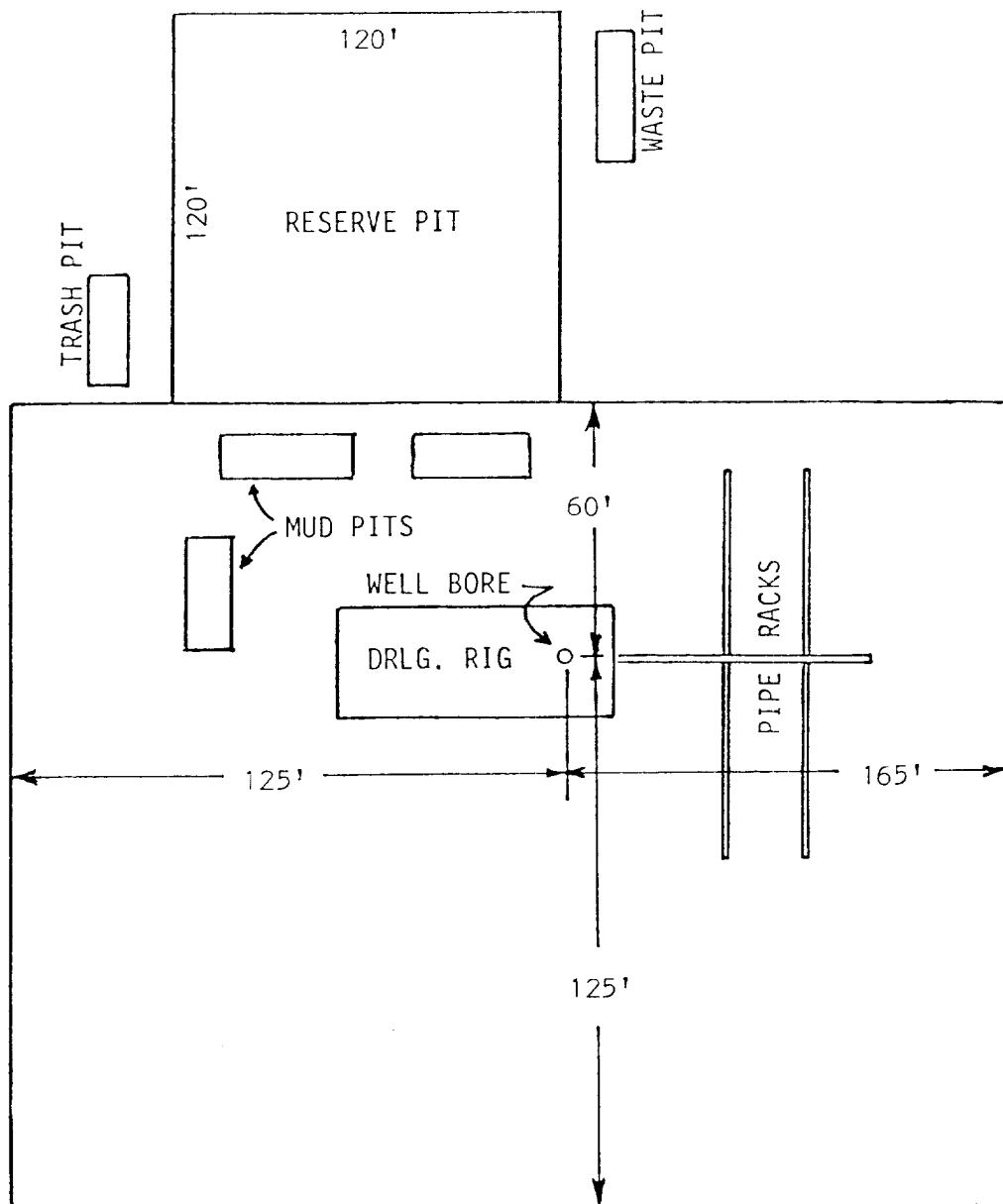

SUP Exhibit "D"  
SKETCH OF WELL PAD

Mountain States Petroleum Corp.  
Well #3 Brotar Federal  
NE $\frac{1}{4}$ NE $\frac{1}{4}$  Sec. 19-15S-28E