

STATE OF NEW MEXICO
ENERGY AND MINERALS DEPARTMENT

OIL CONSERVATION DIVISION

P. O. BOX 2088
SANTA FE, NEW MEXICO 87501

RECEIVED BY

MAR 11 1985

O. C. D.
ARTESIA, OFFICE

Form C-101

Revised 10-1-78

30-005-62255
5A. Indicate Type of Lease

STATE ☐

FEED ☒

5. State Oil & Gas Lease No.

APPLICATION FOR PERMIT TO DRILL, DEEPEN, OR PLUG BACK

1a. Type of Work DRILL <input checked="" type="checkbox"/> DEEPEN <input type="checkbox"/> PLUG BACK <input type="checkbox"/>				7. Unit Agreement Name	
b. Type of Well OIL WELL <input type="checkbox"/> GAS WELL <input type="checkbox"/> OTHER <input type="checkbox"/> SINGLE ZONE <input type="checkbox"/> MULTIPLE ZONE <input type="checkbox"/>				8. Farm or Lease Name Mesa State Com	
2. Name of Operator Mesa Petroleum Co.				9. Well No. 3	
3. Address of Operator P. O. Box 2009, Amarillo, Texas 79189				10. Field and Pool, or Wildcat Diamond Mound-Atoka-Morrow	
4. Location of Well UNIT LETTER <u>L</u> LOCATED <u>1980</u> FEET FROM THE <u>south</u> LINE AND <u>660</u> FEET FROM THE <u>west</u> LINE OF SEC. <u>31</u> TWP. <u>15S</u> RGE. <u>28E</u> NMPM				12. County Chaves	
19. Proposed Depth 9370'				19A. Formation Morrow	
20. Rotary or C.T. Rotary					
21. Elevations (Show whether DF, RT, etc.) 3621' GR		21A. Kind & Status Plug. Bond Blanket		21B. Drilling Contractor To be Determined	
				22. Approx. Date Work will start 3-20-85	

23. PROPOSED CASING AND CEMENT PROGRAM

SIZE OF HOLE	SIZE OF CASING	WEIGHT PER FOOT	SETTING DEPTH	SACKS OF CEMENT	EST. TOP
17 1/2"	13 3/8"	48#	1000'	840	surface
11 1/4"	8 5/8"	28#	1850'	650	200' circ.
7 7/8"	4 1/2"	11.6 & 13.5	9370'	1455	1200'

Prompose to drill a 17 1/2" hole with fresh water to 1000' and set 13 3/8" surface casing and circulate cement to surface. Will reduce hole to 11", install 3000 psi casinhead and double BOP and drill to 1850' to set 8 5/8" casin and cement hack to surface casin. Will reduce hole to 7 7/8" and drill to TD.

APPROVAL VALID FOR 90 DAYS
EXPIRES 7-12-85
UNLESS DRILLING UNDERWAY

XC: NMCCD (0+6) CR, Reg., HF, Midland, Hobbs

IN ABOVE SPACE DESCRIBE PROPOSED PROGRAM: IF PROPOSAL IS TO DEEPEN OR PLUG BACK, GIVE DATA ON PRESENT PRODUCTIVE ZONE AND PROPOSED NEW PRODUCTIVE ZONE. GIVE BLOWOUT PREVENTER PROGRAM, IF ANY.

I hereby certify that the information above is true and complete to the best of my knowledge and belief.

Signed Randy Nordsven Title Randy Nordsven, Regulatory Agent Date 3-8-85

(This space for State Use)

APPROVED BY Mike Williams TITLE OIL AND GAS INSPECTOR DATE MAR 12 1985

CONDITIONS OF APPROVAL, IF ANY:

NEW MEXICO OIL CONSERVATION COMMISSION
W. LOCATION AND ACREAGE DEDICATION PLAT

Form C-102
Supersedes C-128
Effective 1-1-65

All distances must be from the outer boundaries of the Section.

Operator MESA PETROLEUM CORP.			Lease MESA STATE COMM			Well No. 3		
Unit Letter L	Section 31	Township 15 S	Range 28 E	County CHAVES				
Actual Footage Location of Well: 1980 feet from the SOUTH line and 660 feet from the WEST line								
Ground Level Elev. 3621'	Producing Formation Morrow		Pool Diamond Mound Atoka-Morrow			Dedicated Acreage: W¹/₂ 320 Acres		

1. Outline the acreage dedicated to the subject well by colored pencil or hatchure marks on the plat below.
2. If more than one lease is dedicated to the well, outline each and identify the ownership thereof (both as to working interest and royalty).
3. If more than one lease of different ownership is dedicated to the well, have the interests of all owners been consolidated by communitization, unitization, force-pooling, etc?

☒ Yes ☐ No If answer is "yes," type of consolidation Communitization

If answer is "no," list the owners and tract descriptions which have actually been consolidated. (Use reverse side of this form if necessary.) _____

No allowable will be assigned to the well until all interests have been consolidated (by communitization, unitization, forced-pooling, or otherwise) or until a non-standard unit, eliminating such interests, has been approved by the Commission.

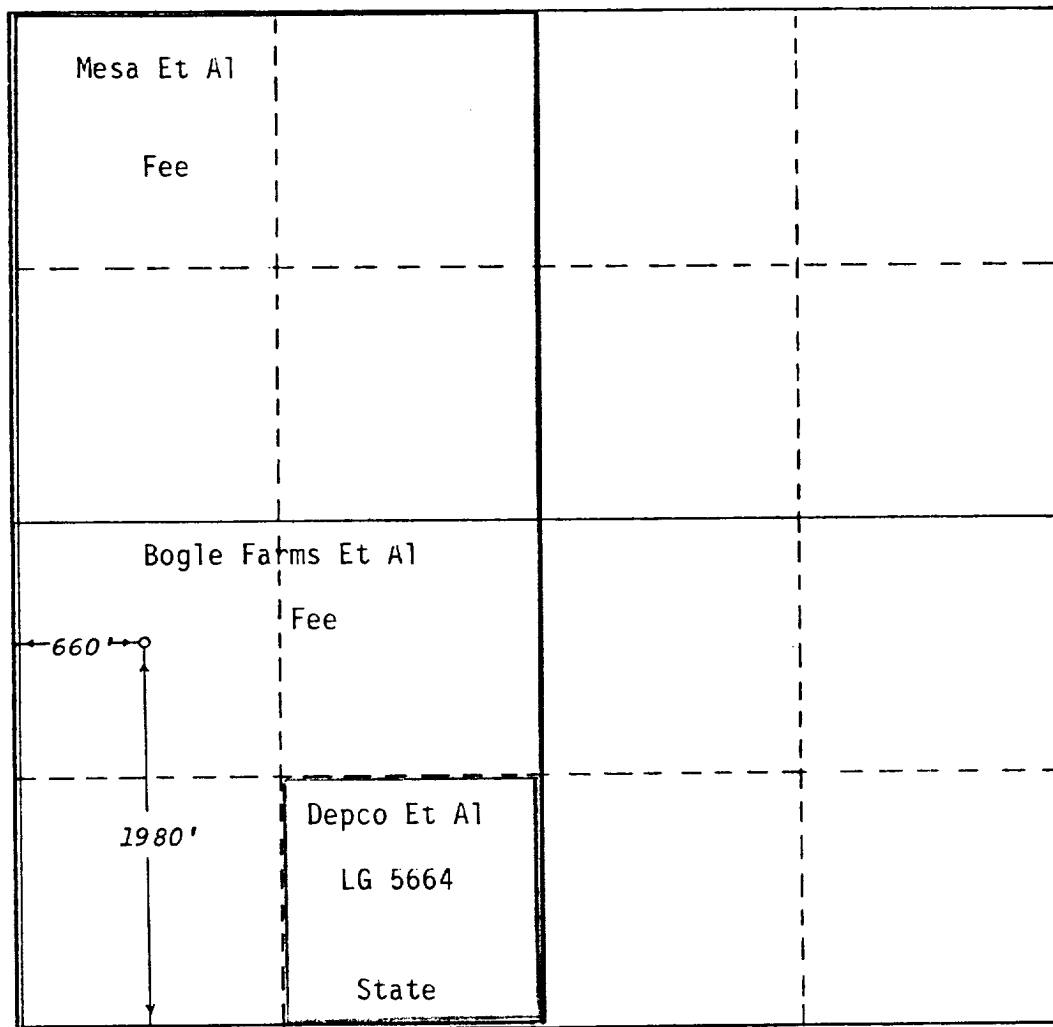

CERTIFICATION

I hereby certify that the information contained herein is true and complete to the best of my knowledge and belief.

Carolyn Cummings

Name

Regulatory Clerk

Position

Mesa Petroleum Co.

Company

March 6, 1985

Date

Carolyn Cummings

I hereby certify that the well location shown on this plat was plotted from field notes of actual surveys made by me or under my supervision, and that the same is true and correct to the best of my knowledge and belief.

GARY D. BOSWELL

Date Surveyed

NO. 266828-585

Registered Professional Engineer and Land Surveyor

Gary D. Boswell

Certificate No.

6689

0 330 660 990 1320 1650 1980 2310 2640 2000 1500 1000 500 0